

CODIGO **54044, 54045, 54046, 66675, 66676, 66677**

DESCRIPCION: **ELECTROLISIS SEL PURE V4 60, 100, 160 M3**

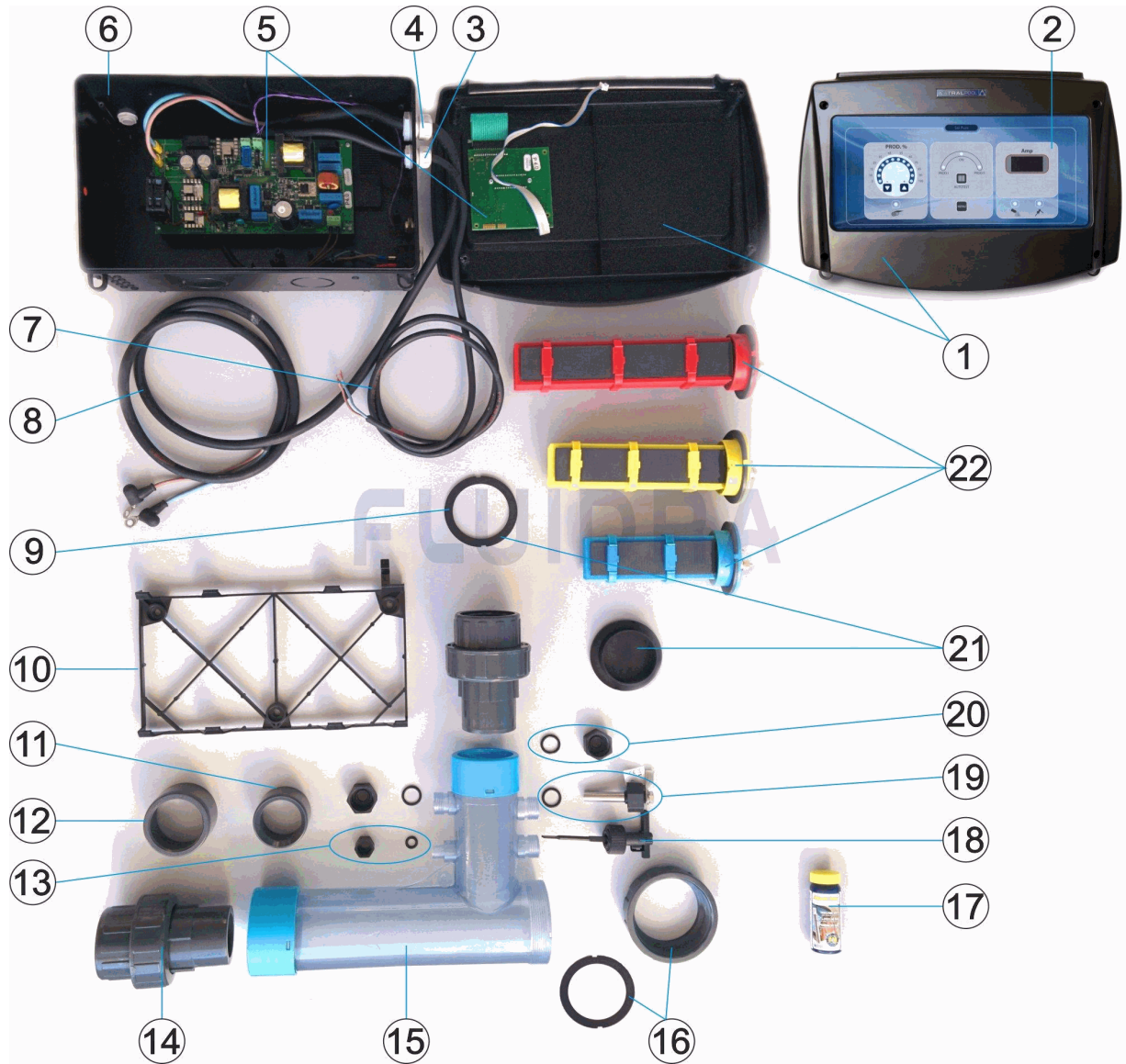

ESPAÑOL

POS	CODIGO	DESCRIPCION	CANTIDAD	POS	CODIGO	DESCRIPCION	CANTIDAD
1	4408060043	TAPA CUERPO DUAL PURE		14	4408060104	RACCOR UNION A COLLAR M/H. 63	
2	4408060030	CARATULA SEL PURE V4		15	* 4408060128	CARCASA PORTACELULAS (60 M3)	
3	4408060050	CJTO PRENSAESTOPAS PG 11		15	* 4408060129	CARCASA PORTACELULA (100 M3)	
4	4408060051	CJTO PRENSAESTOPAS PG 16		15	* 4408060101	CARCASA PORTACELULAS (40 - 160 M3)	
5	4408060044	TARJETA V4 CONEXION LARGA CON DISPI		16	4408060105	TUERCA D. 92 ELECTRODO SEL + JUNTA	
6	4408060028	CARCASA SEL PURE V4		17	4408060007	ESTUCHE ANALISIS SEL	
7	4408040040	CABLE ALIMENTACION 2X1,5MM2 2.1M		18	4408060108	FLUXOSTATO COMPLETO	
8	4408060002	CABLE ELECTRODO COMPLETO		19	4408060026	TOMA TIERRA VASO	
9	4408060106	JUNTA PLANA ELECTRODO SEL		20	4408060121	TAPON NEGRO OBTURADOR + JUNTA	
10	4408040037	SOPORTE MURAL		21	4408060122	TAPON GRANDE VASO + JUNTA	
11	4408060103	REDUCCION 63/50		22	* 54054	ELECTRODO SEL 60 - 9 PLACAS	
12	4408060102	REDUCCION 75/63		22	* 54055	ELECTRODO SEL 100 - 9 PLACAS	
13	4408040246	TAPON PEQUEÑO INYECCIÓN PARA VASO		22	* 54056	ELECTRODO SEL 160 - 9 PLACAS	

CODIGO 54044, 54045, 54046, 66675, 66676, 66677

DESCRIPCION: ELECTROLISIS SEL PURE V4 60, 100, 160 M3

OBSERVACIONES

POS	CODIGO	OBSERVACIONES
15	* 4408060128	PARA: 54044, 66675
15	* 4408060129	PARA: 54045, 66676
15	* 4408060101	PARA: 54046, 66677
22	* 54054	PARA: 54044, 54045
22	* 54055	PARA: 54045, 66676
22	* 54056	PARA: 54046, 66677

CODE 54044, 54045, 54046, 66675, 66676, 66677

DESCRIPTION: ÉLECTROLYSE SEL PURE V4 60, 100, 160 M.3

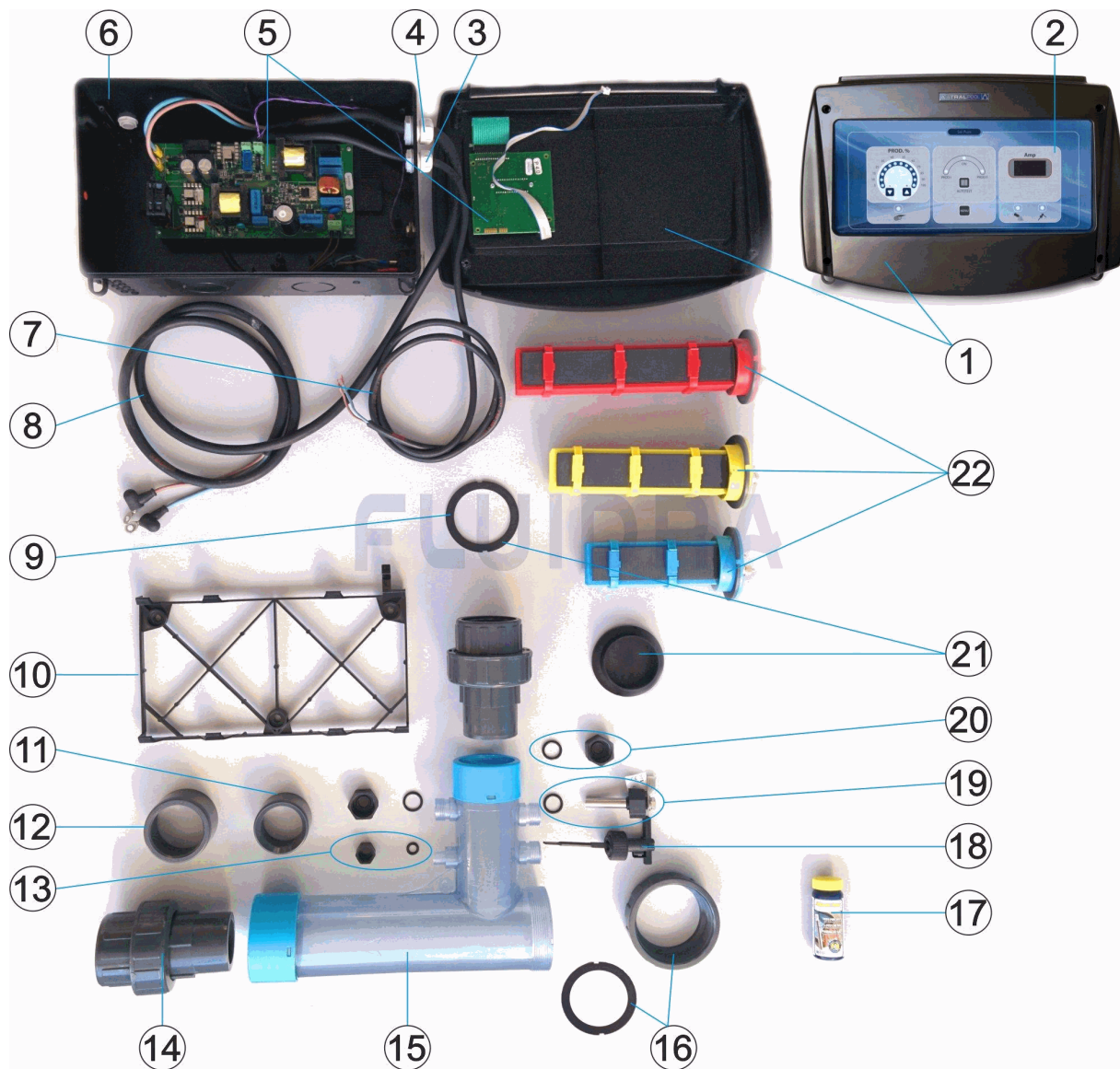

FRANCAIS

POS	CODE	DESCRIPTION	QUANTITE	POS	CODE	DESCRIPTION	QUANTITE
1	4408060043	COUVERCLE DUAL PURE		14	4408060104	RACCORD UNION À COLLER M/H 63	
2	4408060030	COUVERCLE SEL PURE V4		15	* 4408060128	PORTE-CELLULE (60 M3)	
3	4408060050	ENS. PRESSE-ÉTOUPES PG11		15	* 4408060129	PORTE-CELLULE (100 M3)	
4	4408060051	ENS. PRESSE-ÉTOUPES PG16		15	* 4408060101	PORTE-CELLULE (40 - 160 M3)	
5	4408060044	CARTE V4 CONNEXION LONGUE AVEC AFI		16	4408060105	ECROU D. 92 ELECTRODE SEL + JOINT	
6	4408060028	CARCASSE SEL PURE V4		17	4408060007	KIT ANALYSE SEL	
7	4408040040	CÂBLE ALIMENTATION 2X1,5MM2 2.1M		18	4408060108	CONTROLEUR DE DÉBIT COMPLET	
8	4408060002	CABLE ELECTRODE		19	4408060026	PRISE DE TERRE	
9	4408060106	JOINT PLAT ÉLECTRODE SEL		20	4408060121	COUVERCLE NOIR DE FERMETURE + JOI	
10	4408040037	SUPPORT MURAL		21	4408060122	COUVERCLE GRAND VASE + JOINT	
11	4408060103	RÉDUCTION 63/50		22	* 54054	ELECTRODE SEL 60 -9 PLAQUES	
12	4408060102	RÉDUCTION 75/63		22	* 54055	ELECTRODE SEL 100 -9 PLAQUES	
13	4408040246	BOUCHON PETIT INJECTION POUR VASE		22	* 54056	ELECTRODE SEL 160 -9 PLAQUES	

CODE **54044, 54045, 54046, 66675, 66676, 66677**

DESCRIPTION: **ÉLECTROLYSE SEL PURE V4 60, 100, 160 M.3**

OBSERVATIONS

POS	CODE	OBSERVATIONS
15	* 4408060128	POUR: 54044, 66675
15	* 4408060129	POUR: 54045, 66676
15	* 4408060101	POUR: 54046, 66677
22	* 54054	POUR: 54044, 54045
22	* 54055	POUR: 54045, 66676
22	* 54056	POUR: 54046, 66677

CODE **54044, 54045, 54046, 66675, 66676, 66677**

DESCRIPTION: **ELECTROLYSIS SEL PURE V4 60, 100, 160 M.3**

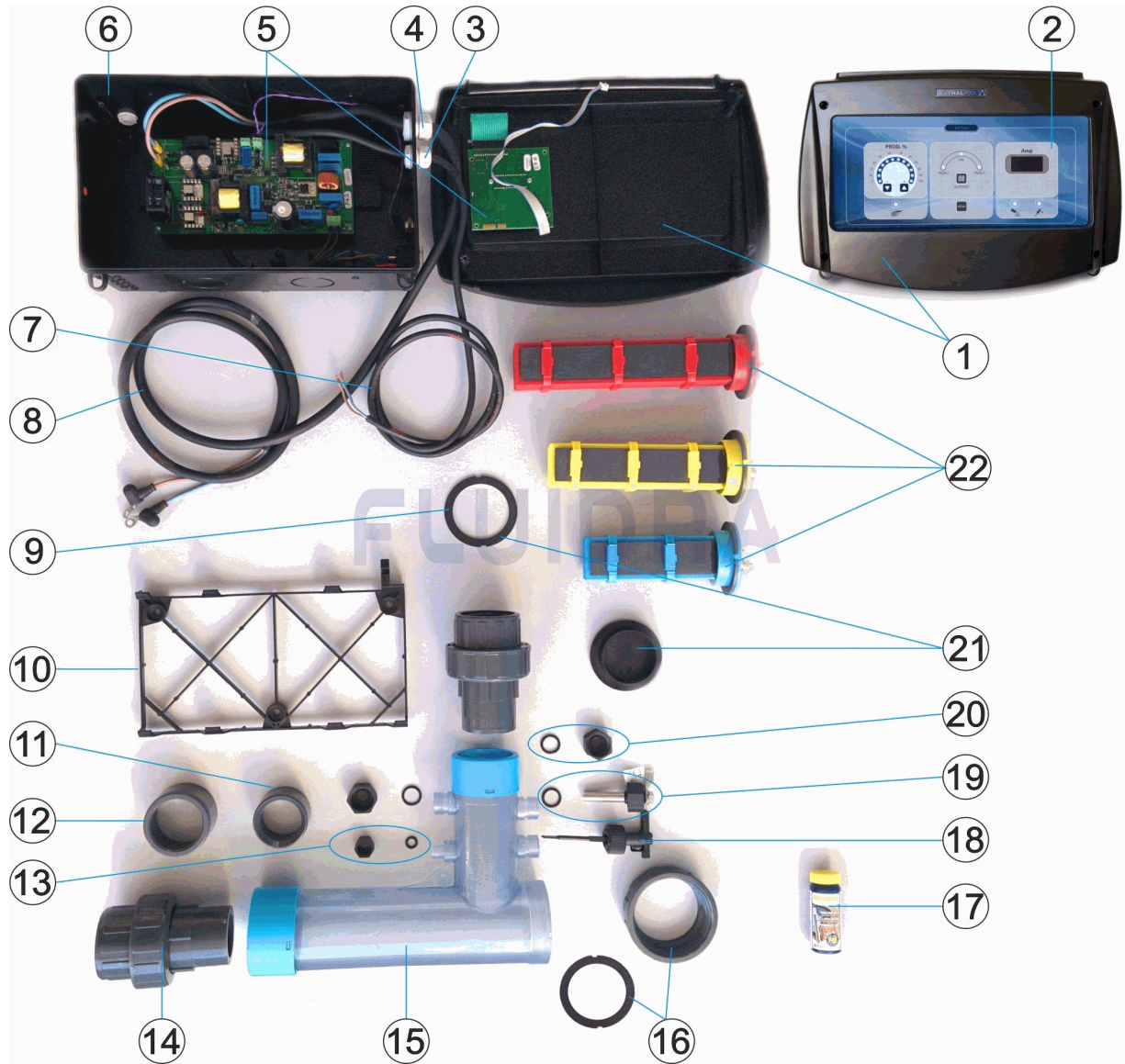

ENGLISH

POS	CODE	DESCRIPTION	QUANTITY	POS	CODE	DESCRIPTION	QUANTITY
1	4408060043	COVER DUAL PURE		14	4408060104	M/F 63 SOLVENT SOCKET UNION	
2	4408060030	COVER SEL PURE V4		15	* 4408060128	ELECTRODES HOUSING (60 M3)	
3	4408060050	PG11 PACKING GLAND UNIT		15	* 4408060129	ELECTRODES HOUSING (100 M3)	
4	4408060051	PG16 PACKING GLAND UNIT		15	* 4408060101	ELECTRODES HOUSING (40 - 160 M3)	
5	4408060044	V4 CARD LONG CONNECTOR WITH DISPL		16	4408060105	D. 92 ELECTRODE NUT + GASKET	
6	4408060028	SEL PURE V4 SHELL		17	4408060007	SEL ANALYSIS CASE	
7	4408040040	2X1,5MM2 2.1M SUPPLY CABLE		18	4408060108	COMPLETE FLOWSWITCH	
8	4408060002	ELECTRODE CABLE		19	4408060026	EARTH CONNECTION	
9	4408060106	ELECTRODE GASKET		20	4408060121	BLACK OBTURATING PLUG + GASKET	
10	4408040037	WALL BRACKET		21	4408060122	HOUSING CAP + GASKET	
11	4408060103	63/50 REDUCTION SOCKET		22	* 54054	ASTRAL SEL 60 ELECTRODE (9 PLATES)	
12	4408060102	75/63 REDUCTION SOCKET		22	* 54055	ASTRAL SEL 100 ELECTRODE (9 PLATES)	
13	4408040246	SMALL INJECTION CAP FOR RECIPIENT		22	* 54056	ASTRAL SEL 160 ELECTRODE (9 PLATES)	

CODE **54044, 54045, 54046, 66675, 66676, 66677**

DESCRIPTION: **ELECTROLYSIS SEL PURE V4 60, 100, 160 M.3**

OBSERVATIONS

POS	CODE	OBSERVATIONS
15	* 4408060128	FOR: 54044, 66675
15	* 4408060129	FOR: 54045, 66676
15	* 4408060101	FOR: 54046, 66677
22	* 54054	FOR: 54044, 54045
22	* 54055	FOR: 54045, 66676
22	* 54056	FOR: 54046, 66677

CODICE **54044, 54045, 54046, 66675, 66676, 66677**

DESCRIZIONE: **ELETTROLISI SEL PURE V4 60, 100, 160 M.3**

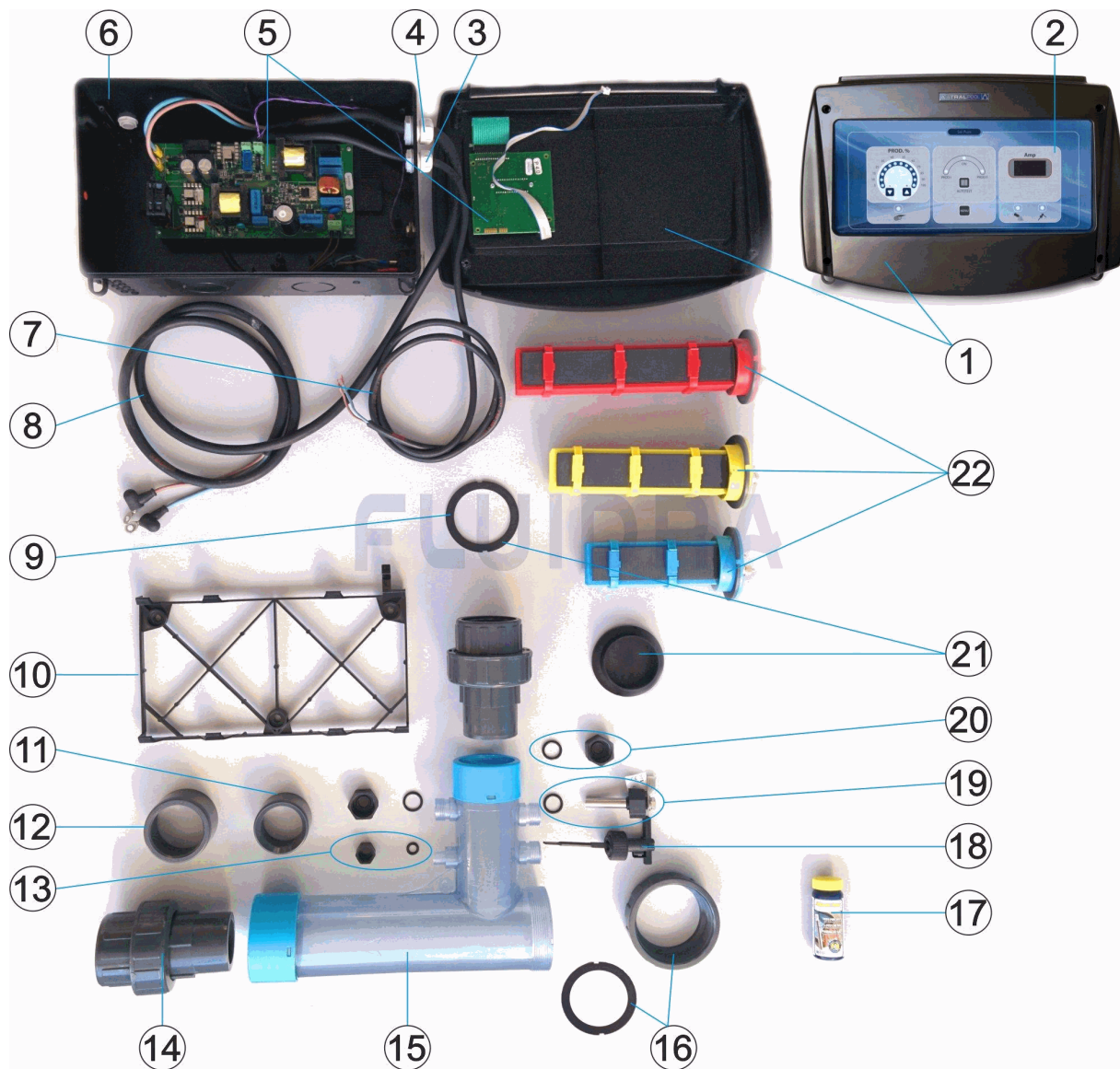

ITALIANO

POS	CODICE	DESCRIZIONE	QUANTITA'	POS	CODICE	DESCRIZIONE	QUANTITA'
1	4408060043	COPERCHIO CORPO DUAL CORE		14	4408060104	RACCORDO INCOLLAGGIO MF D.63	
2	4408060030	COPERCHIO SEL PURE V4		15	* 4408060128	PORTAELETTODI (60 M3)	
3	4408060050	GRUPPO PREMISTOPPA PG11		15	* 4408060129	PORTAELETTODI (100 M3)	
4	4408060051	GRUPPO PREMISTOPPA PG16		15	* 4408060101	PORTAELETTODI (40 - 160 M3)	
5	4408060044	SCHEDA V4 CONESSIONE LUNGA CON DI		16	4408060105	GHIERA D.92 ELETTRODO + GUARNIZIONE	
6	4408060028	SCATOLA IN SEL PURE V4		17	4408060007	ASTUCCIO ANALISI SEL	
7	4408040040	CAVO DI ALIMENTAZIONE 2X1,5MM2 2.1M		18	4408060108	FLUSOSTATO COMPLETO	
8	4408060002	CAVO ELETTRODO		19	4408060026	PRESA A TERRA	
9	4408060106	GUARNIZIONE ELETTRODO		20	4408060121	TAPPO NERO PICCOLO + GUARNIZIONE	
10	4408040037	SUPPORTO MURALE		21	4408060122	TAPPO NERO GRANDE ELETTRODO + GUA	
11	4408060103	RIDUZIONE 63/50		22	* 54054	ELETTRODO ASTRAL SEL 60 - 9 PLACHE	
12	4408060102	RIDUZIONE 75/63		22	* 54055	ELETTRODO ASTRAL SEL 100 - 9 PLACHE	
13	4408040246	TAPPO PICCOLO INIEZIONE PER VASCA		22	* 54056	ELETTRODO ASTRAL SEL 160 - 9 PLACHE	

CODICE **54044, 54045, 54046, 66675, 66676, 66677**

DESCRIZIONE: **ELETTROLISI SEL PURE V4 60, 100, 160 M.3**

OSSERVAZIONI

POS	CODICE	OSSERVAZIONI
15	* 4408060128	PER: 54044, 66675
15	* 4408060129	PER: 54045, 66676
15	* 4408060101	PER: 54046, 66677
22	* 54054	PER: 54044, 54045
22	* 54055	PER: 54045, 66676
22	* 54056	PER: 54046, 66677

CODE **54044, 54045, 54046, 66675, 66676, 66677**

BESCHREIBUNG: **ELEKTROLYSE SEL PURE V4 60, 100, 160 M.3**

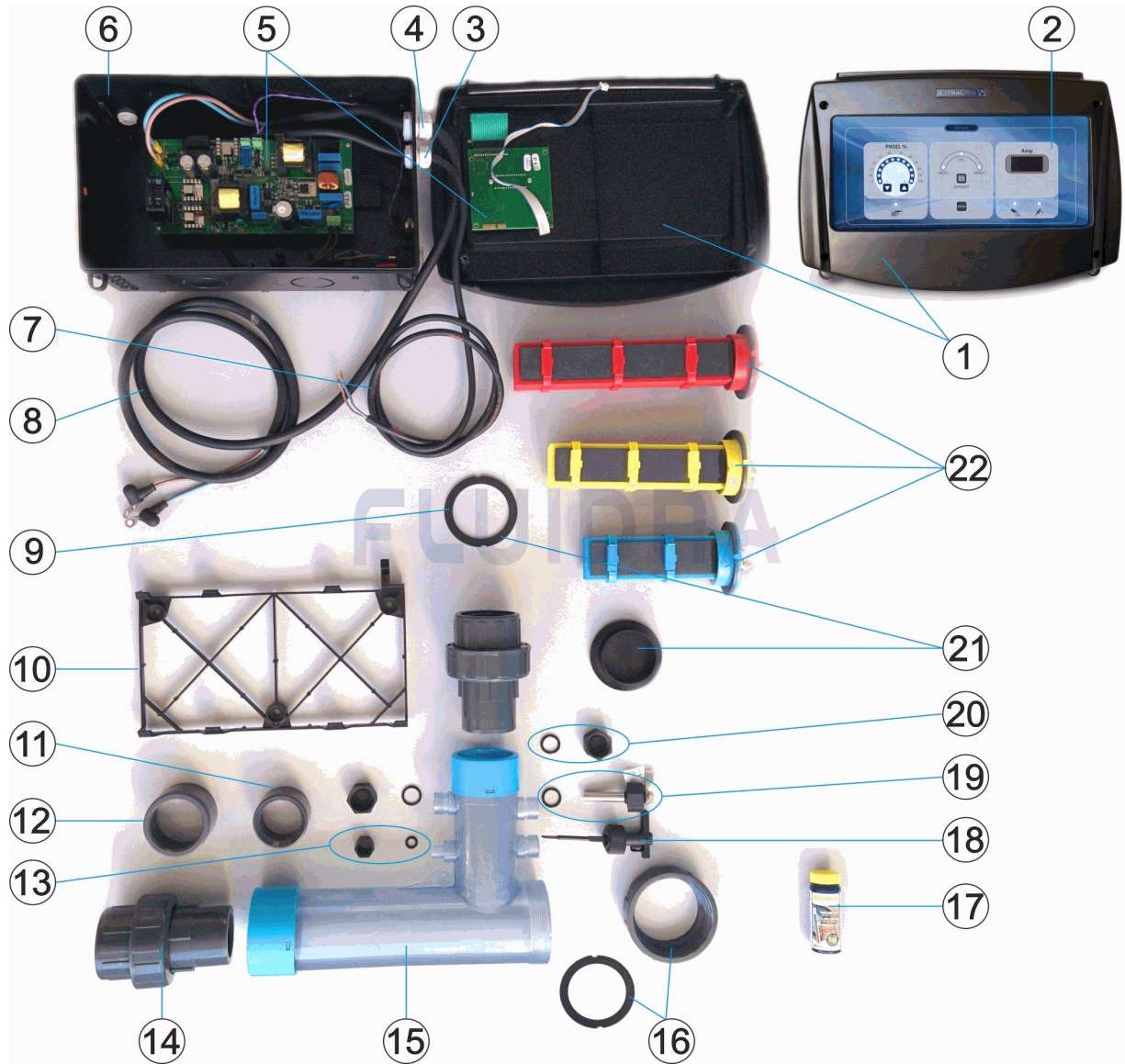

DEUTSCH

POS	CODE	BESCHREIBUNG	MENGE	POS	CODE	BESCHREIBUNG	MENGE
1	4408060043	ABDECKUNG GEHÄUSE DUAL PURE		14	4408060104	GEWINDESTÜCK VERBINDUNG - KRAGEN I	
2	4408060030	BEDIENFELD SEL PURE V4		15	* 4408060128	ZELLENGEHÄUSE (60 M3)	
3	4408060050	SET QUETSCHVERSCHRAUBUNG PG11		15	* 4408060129	ZELLENGEHÄUSE (100 M3)	
4	4408060051	SET QUETSCHVERSCHRAUBUNG PG16		15	* 4408060101	ZELLENGEHÄUSE (40 - 160 M3)	
5	4408060044	PLATINE V4 ANSCHLUSS LANG MIT DISPL		16	4408060105	MUTTER D. 92 ELEKTRODE SEL UND DICH	
6	4408060028	GEHÄUSE SEL PURE V4		17	4408060007	ANALYSEETUI SEL	
7	4408040040	VERSORGUNGSKABEL 2X1,5MM2 2.1M		18	4408060108	DURCHFLUSSMESSER KOMPLETT	
8	4408060002	ELEKTRODENKABEL KOMPLETT		19	4408060026	ERDUNG GEHÄUSE	
9	4408060106	FLACHDICHTUNG ELEKTRODE SEL		20	4408060121	STOPFEN SCHWARZ VERSCHLUSS UND D	
10	4408040037	WANDHALTERUNG		21	4408060122	STOPFEN GROSS GEHÄUSE UND DICHTU	
11	4408060103	REDUZIERSTÜCK 63/50		22	* 54054	SALZELECTRODE 60 - 9 PLATTEN	
12	4408060102	REDUZIERSTÜCK 75/63		22	* 54055	ELEKTRODE SEL 100 - 9 PLATINEN	
13	4408040246	STOPFEN KLEIN FÜR GEHÄUSE		22	* 54056	ELEKTRODE SEL 160 - 9 PLATINEN	

CODE **54044, 54045, 54046, 66675, 66676, 66677**

BESCHREIBUNG: **ELEKTROLYSE SEL PURE V4 60, 100, 160 M.3**

HINWEISE

POS	CODE	HINWEISE
15	* 4408060128	FÜR: 54044, 66675
15	* 4408060129	FÜR: 54045, 66676
15	* 4408060101	FÜR: 54046, 66677
22	* 54054	FÜR: 54044, 54045
22	* 54055	FÜR: 54045, 66676
22	* 54056	FÜR: 54046, 66677

CODIGO **54044, 54045, 54046, 66675, 66676, 66677**

DESCRIÇÃO: **ELECTRÓLISE SEL PURE V4 60, 100, 160 M.3**

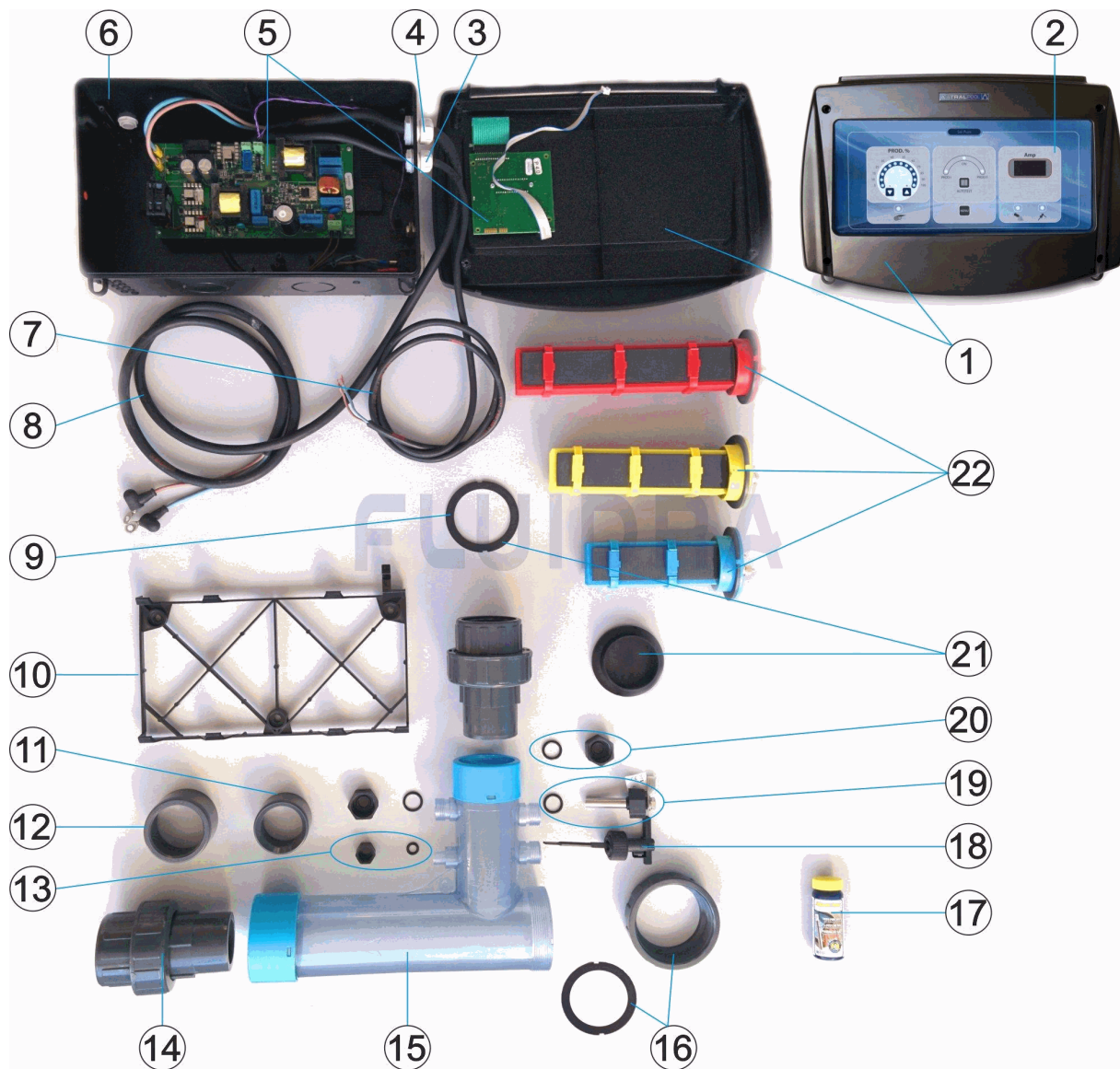

PORTUGUES

POS	CODIGO	DESCRIÇÃO	JANTIDADE	POS	CODIGO	DESCRIÇÃO	JANTIDADE
1	4408060043	TAMPA CORPO DUAL PURE		14	4408060104	RACORD DE UNIÃO A COLAR M/F. 63	
2	4408060030	COBERTA SEL PURE V4		15	* 4408060128	CARÇAÇA PORTA-CÉLULAS (60 M3)	
3	4408060050	CJTO. PRENSA-ESTOPAS PG11		15	* 4408060129	CARÇAÇA PORTA-CÉLULAS (100 M3)	
4	4408060051	CJTO. PRENSA-ESTOPAS PG16		15	* 4408060101	CARÇAÇA PORTA-CÉLULAS (40 - 160 M3)	
5	4408060044	PLACA V4 FICHA COMPRIDA COM DISPLA)		16	4408060105	PORCA D. 92 ELÉCTRODO SEL + JUNTA	
6	4408060028	CARÇAÇA SEL PURE V4		17	4408060007	ESTOJO ANÁLISE SEL	
7	4408040040	CABO ALIMENTAÇÃO 2X1,5MM2 2.1M		18	4408060108	FLUXO-ESTATO COMPLETO	
8	4408060002	CABO SONDA		19	4408060026	LIGAÇÃO A TERRA	
9	4408060106	JUNTA PLANA ELÉCTRODO SEL		20	4408060121	TAMPÃO PRETO OBTURADOR + JUNTA	
10	4408040037	SUPORTE PAREDE		21	4408060122	TAMPÃO GRANDE COPO + JUNTA	
11	4408060103	REDUÇÃO 63/50		22	* 54054	ELÉCTRODO SEL 60 - 9 PLACAS	
12	4408060102	REDUÇÃO 75/63		22	* 54055	ELÉCTRODO SEL 100 - 9 PLACAS	
13	4408040246	TAMPA PEQUENA INJEÇÃO PARA COPO		22	* 54056	ELÉCTRODO SEL 160 - 9 PLACAS	

*** VEJA A FICHA DE OBSERVAÇÕES**

CODIGO 54044, 54045, 54046, 66675, 66676, 66677

DESCRIÇÃO: ELECTRÓLISE SEL PURE V4 60, 100, 160 M.3

OBSERVAÇÕES

POS	CODIGO	OBSERVAÇÕES
15	* 4408060128	PARA: 54044, 66675
15	* 4408060129	PARA: 54045, 66676
15	* 4408060101	PARA: 54046, 66677
22	* 54054	PARA: 54044, 54045
22	* 54055	PARA: 54045, 66676
22	* 54056	PARA: 54046, 66677