

CODIGO **60238, 60239, 60240, 66678, 66679, 66680**

DESCRIPCION: **ELECTROLISIS DUAL PURE 60, 100, 160**

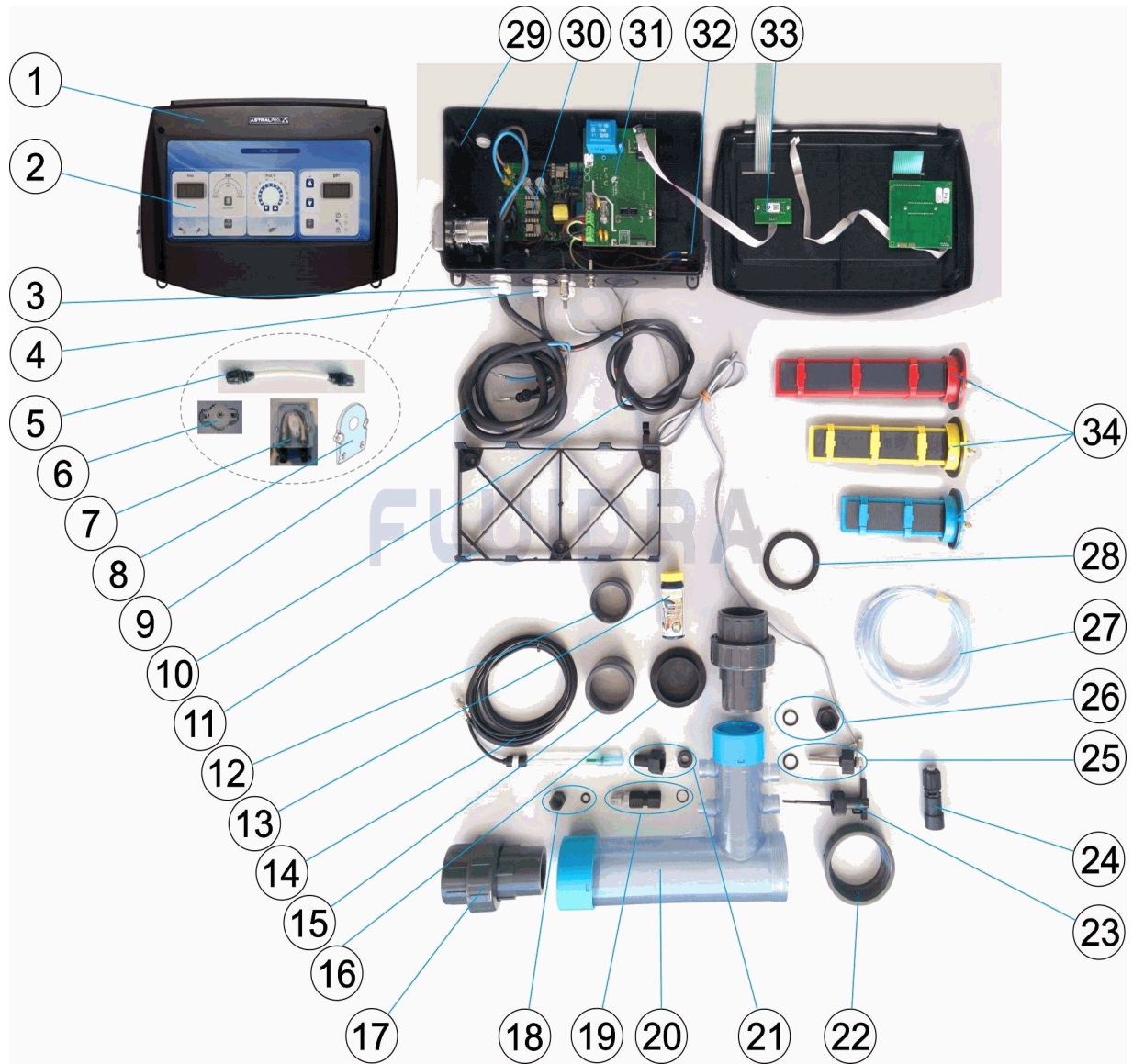

ESPAÑOL

POS	CODIGO	DESCRIPCION	CANTIDAD	POS	CODIGO	DESCRIPCION	CANTIDAD
1	4408060043	TAPA CUERPO DUAL PURE		16	4408060112	CJTO. RACORD	
2	4408060046	CARATULA DUAL PURE		17	4408060104	RACCOR UNION A COLLAR M/H. 63	
3	4408060051	CJTO PRENSAESTOPAS PG 16		18	4408060008	TAPON PEQUEÑO INYECCIÓN PARA VASO	
4	4408060050	CJTO PRENSAESTOPAS PG 11		19	4408060019	TOMA INYECCIÓN COMPLETA PARA VASO	
5	4408060022	TUBO LATEX CON RACORES		20	* 4408060128	CARCASA PORTACELULAS (60 M3)	
6	4408040049	PORTA RODILLOS PH MODELO 2 1,8-2,4		20	* 4408060129	CARCASA PORTACELULA (100 M3)	
7	4408060039	BOMBA PH 2,4 L/H.		20	* 4408060101	CARCASA PORTACELULAS (40 - 160 M3)	
8	4408060080	CUBIERTA TRANSPARENTE BOMBA L3 MO		21	4408060116	COLLARIN SENSOR + JUNTA	
9	4408060002	CABLE ELECTRODO COMPLETO		22	4408060105	TUERCA D. 92 ELECTRODO SEL + JUNTA	
10	4408060003	CABLE ALIMENTACION 3X1MM2 2.1M		23	4408060108	FLUXOSTATO COMPLETO	
11	4408040037	SOPORTE MURAL		24	4408060118	TOMA ASPIRACION COMPLETA	
12	4408060103	REDUCCION 63/50		25	4408060026	TOMA TIERRA VASO	
13	4408060007	ESTUCHE ANALISIS SEL		26	4408060121	TAPON NEGRO OBTURADOR + JUNTA	

*** NOTA OBSERVACIONES**

CODIGO 60238, 60239, 60240, 66678, 66679, 66680

DESCRIPCION: ELECTROLISIS DUAL PURE 60, 100, 160

14	4408060117	SONDA PH	27	4408040028	TUBO PVC TRANSPARENTE 4X6MM L=4M
15	4408060102	REDUCCION 75/63	28	4408060106	JUNTA PLANA ELECTRODO SEL
29	4408060028	CARCASA SEL PURE V4	33	4408060057	TARJETA PH ECCO E5 PANTALLA DEPORTE
30	4408060044	TARJETA V4 CONEXION LARGA CON DISPI	34	* 54054	ELECTRODO SEL 60 - 9 PLACAS
31	4408060144	TARJETA PH ECCO E5 SIN DISPLAY	34	* 54055	ELECTRODO SEL 100 - 9 PLACAS
32	4408060055	INTERRUPTOR CON CAPUCHON	34	* 54056	ELECTRODO SEL 160 - 9 PLACAS

CODIGO 60238, 60239, 60240, 66678, 66679, 66680

DESCRIPCION: ELECTROLISIS DUAL PURE 60, 100, 160

OBSERVACIONES

POS	CODIGO	OBSERVACIONES
20	* 4408060128	PARA: 60238, 66678
20	* 4408060129	PARA: 60239, 66679
20	* 4408060101	PARA: 60240, 66680
34	* 54054	PARA: 60238, 66678
34	* 54055	PARA: 60239, 66679
34	* 54056	PARA: 60240, 66680

CODE 60238, 60239, 60240, 66678, 66679, 66680

DESCRIPTION: ÉLECTROLYSE DUAL PURE 60, 100, 160

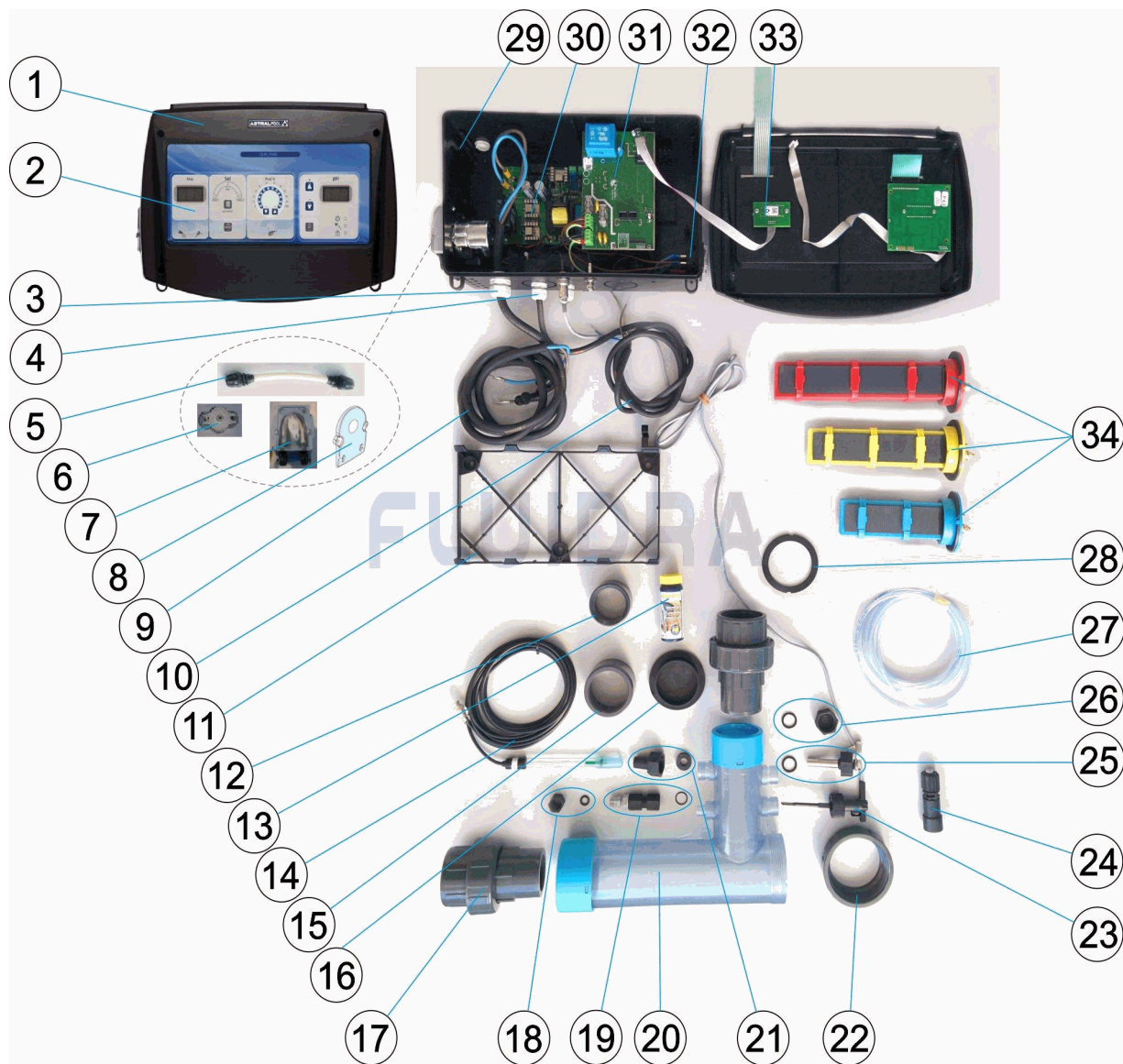

FRANCAIS

POS	CODE	DESCRIPTION	QUANTITE	POS	CODE	DESCRIPTION	QUANTITE
1	4408060043	COUVERCLE DUAL PURE		16	4408060112	ENSEMBLE RACCORD	
2	4408060046	COUVERCLE DUAL PURE		17	4408060104	RACCORD UNION À COLLER M/H 63	
3	4408060051	ENS. PRESSE-ÉTOUPES PG16		18	4408060008	BOUCHON PETIT INJECTION POUR VASE	
4	4408060050	ENS. PRESSE-ÉTOUPES PG11		19	4408060019	PRISE INJECTION COMPLÈTE POUR VASE	
5	4408060022	TUYAU EN CAOUTCHOUC		20	* 4408060128	PORTE-CELLULE (60 M3)	
6	4408040049	GALET POMPE PH MODELE 2 1,8-2,4		20	* 4408060129	PORTE-CELLULE (100 M3)	
7	4408060039	POMPE PERI-STAT 2.4 L/H MODELE		20	* 4408060101	PORTE-CELLULE (40 - 160 M3)	
8	4408060080	CAPOT TRANSPARENT POMPE L3 MODEL1		21	4408060116	BAGUE PORTE-SONDE + JOINT	
9	4408060002	CABLE ELECTRODE		22	4408060105	ECROU D. 92 ELECTRODE SEL + JOINT	
10	4408060003	CABLE ALIMENTATION 3X1MM2 2.1M		23	4408060108	CONTROLEUR DE DÉBIT COMPLET	
11	4408040037	SUPPORT MURAL		24	4408060118	COUVERCLE DE SONDÉ	
12	4408060103	RÉDUCTION 63/50		25	4408060026	PRISE DE TERRE	
13	4408060007	KIT ANALYSE SEL		26	4408060121	COUVERCLE NOIR DE FERMETURE + JOI	

CODE **60238, 60239, 60240, 66678, 66679, 66680**

DESCRIPTION: **ÉLECTROLYSE DUAL PURE 60, 100, 160**

14	4408060117	SONDE PH	27	4408040028	TUBE PVC COLIBRI TRNSPARENT COUPE 4
15	4408060102	RÉDUCTION 75/63	28	4408060106	JOINT PLAT ÉLECTRODE SEL
29	4408060028	CARCASSE SEL PURE V4	33	4408060057	CARTE PH ECCO E5 AFFI. DEPORTE
30	4408060044	CARTE V4 CONNEXION LONGUE AVEC AFI	34	* 54054	ELECTRODE SEL 60 -9 PLAQUES
31	4408060144	CARTE PH ECCO E5 SANS AFFICHEUR	34	* 54055	ELECTRODE SEL 100 -9 PLAQUES
32	4408060055	INTER DEPORTE+CAPUCHON ANALYS3	34	* 54056	ELECTRODE SEL 160 -9 PLAQUES

CODE **60238, 60239, 60240, 66678, 66679, 66680**

DESCRIPTION: **ÉLECTROLYSE DUAL PURE 60, 100, 160**

OBSERVATIONS

POS	CODE	OBSERVATIONS
20	* 4408060128	POUR: 60238, 66678
20	* 4408060129	POUR: 60239, 66679
20	* 4408060101	POUR: 60240, 66680
34	* 54054	POUR: 60238, 66678
34	* 54055	POUR: 60239, 66679
34	* 54056	POUR: 60240, 66680

CODE **60238, 60239, 60240, 66678, 66679, 66680**

DESCRIPTION: **ELECTROLYSIS DUAL PURE 60, 100, 160**

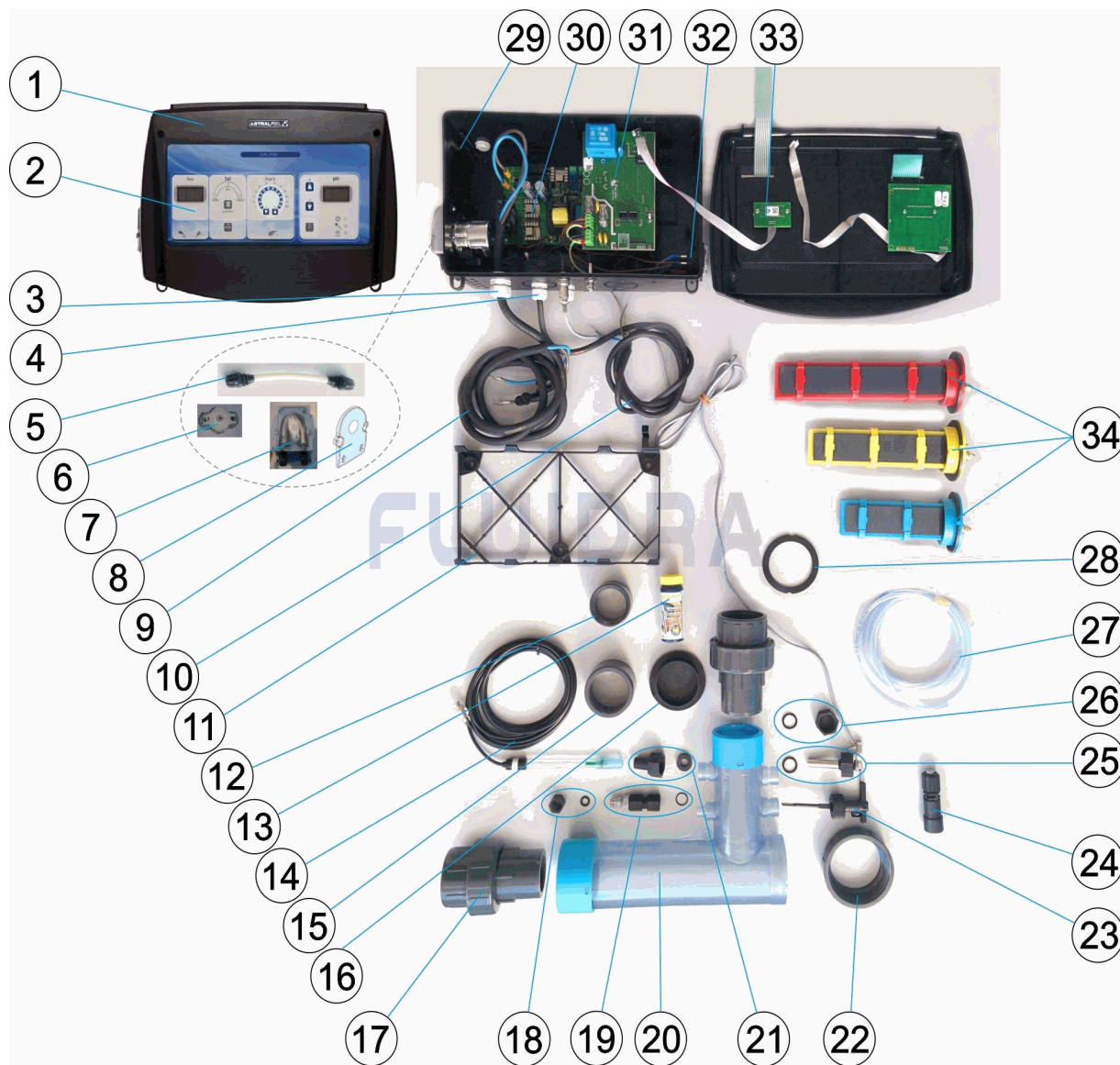

ENGLISH

POS	CODE	DESCRIPTION	QUANTITY	POS	CODE	DESCRIPTION	QUANTITY
1	4408060043	COVER DUAL PURE		16	4408060112	CONNECTOR SET	
2	4408060046	COVER DUAL PURE		17	4408060104	M/F 63 SOLVENT SOCKET UNION	
3	4408060051	PG16 PACKING GLAND UNIT		18	4408060008	SMALL INJECTION CAP FOR RECIPIENT	
4	4408060050	PG11 PACKING GLAND UNIT		19	4408060019	COMPLETE INJECTION SAMPLE FOR CUP	
5	4408060022	LATEX TUBE		20	* 4408060128	ELECTRODES HOUSING (60 M3)	
6	4408040049	MODEL 2 1.8-2.4 PH ROLLER HOLDER		20	* 4408060129	ELECTRODES HOUSING (100 M3)	
7	4408060039	2.4 L/H PERISTALTIC PUMP		20	* 4408060101	ELECTRODES HOUSING (40 - 160 M3)	
8	4408060080	L3 PUMP MOD. 2 TRANSPARENT COVER		21	4408060116	SENSOR LOCKING COLLAR + SEAL	
9	4408060002	ELECTRODE CABLE		22	4408060105	D. 92 ELECTRODE NUT + GASKET	
10	4408060003	3X1MM2 2.1M SUPPLY CABLE		23	4408060108	COMPLETE FLOWSWITCH	
11	4408040037	WALL BRACKET		24	4408060118	COMPLETE SUCTION VALVE	
12	4408060103	63/50 REDUCTION SOCKET		25	4408060026	EARTH CONNECTION	
13	4408060007	SEL ANALYSIS CASE		26	4408060121	BLACK OBTURATING PLUG + GASKET	

* SEE OBSERVATIONS SHEET

CODE **60238, 60239, 60240, 66678, 66679, 66680**

DESCRIPTION: **ELECTROLYSIS DUAL PURE 60, 100, 160**

14	4408060117	PH PROBE	27	4408040028	4X6MM L=4M TRANSPARENT PVC TUBING
15	4408060102	75/63 REDUCTION SOCKET	28	4408060106	ELECTRODE GASKET
29	4408060028	SEL PURE V4 SHELL	33	4408060057	PH CARD ECCO E5
30	4408060044	V4 CARD LONG CONNECTOR WITH DISPL	34	* 54054	ASTRAL SEL 60 ELECTRODE (9 PLATES)
31	4408060144	PH ECCO E5 CARD WITHOUT DISPLAY	34	* 54055	ASTRAL SEL 100 ELECTRODE (9 PLATES)
32	4408060055	CIRCUIT BREAKER	34	* 54056	ASTRAL SEL 160 ELECTRODE (9 PLATES)

CODE **60238, 60239, 60240, 66678, 66679, 66680**

DESCRIPTION: **ELECTROLYSIS DUAL PURE 60, 100, 160**

OBSERVATIONS

POS	CODE	OBSERVATIONS
20	* 4408060128	FOR: 60238, 66678
20	* 4408060129	FOR: 60239, 66679
20	* 4408060101	FOR: 60240, 66680
34	* 54054	FOR: 60238, 66678
34	* 54055	FOR: 60239, 66679
34	* 54056	FOR: 60240, 66680

CODICE **60238, 60239, 60240, 66678, 66679, 66680**

DESCRIZIONE: **ELETTROLISI DUAL PURE 60, 100, 160**

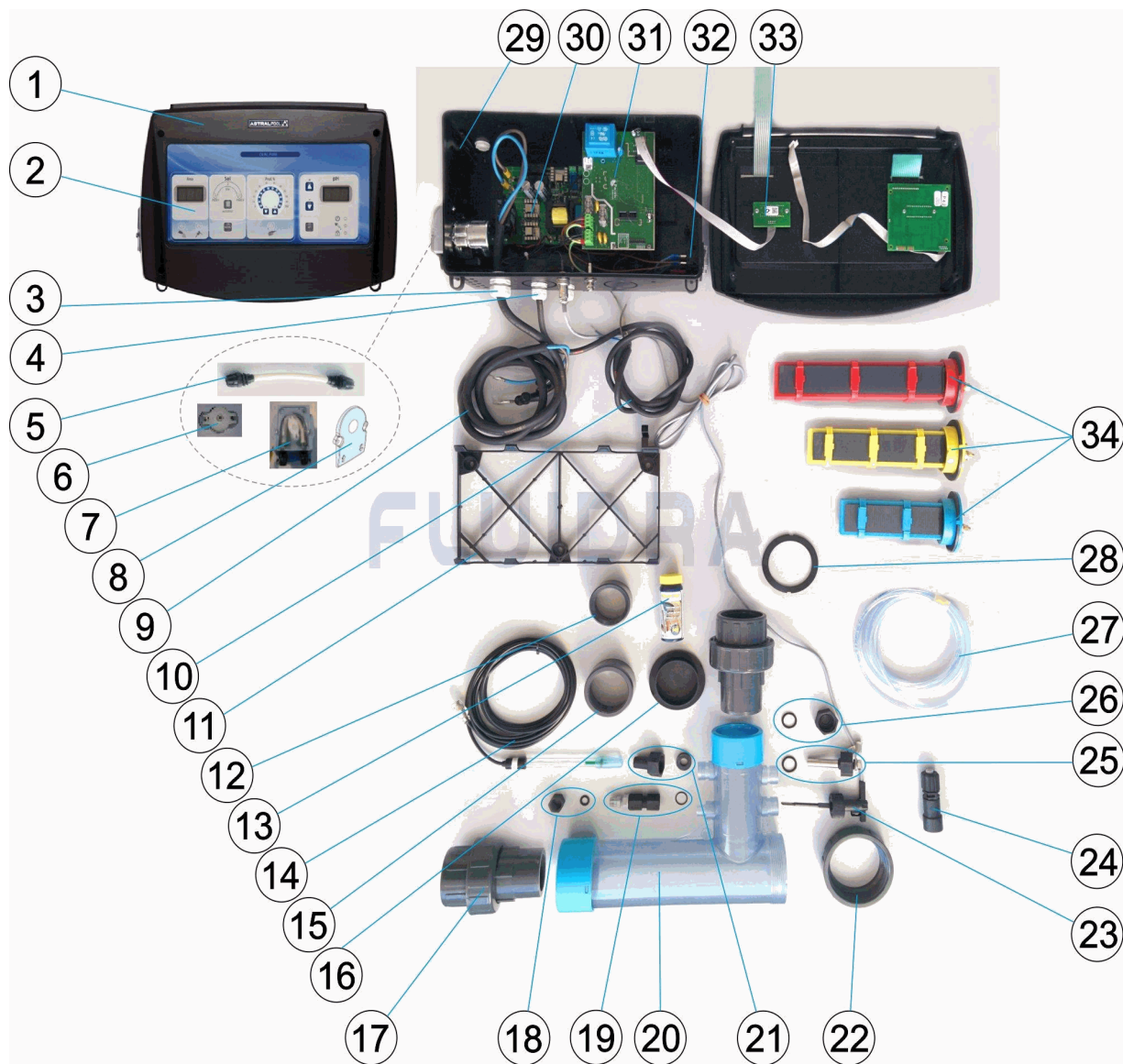

ITALIANO

POS	CODICE	DESCRIZIONE	QUANTITA'	POS	CODICE	DESCRIZIONE	QUANTITA'
1	4408060043	COPERCHIO CORPO DUAL CORE		16	4408060112	GRUPPO RACCORDO INIEZIONE PH	
2	4408060046	COPERCHIO DUAL PURE		17	4408060104	RACCORDO INCOLLAGGIO MF D.63	
3	4408060051	GRUPPO PREMISTOPPA PG16		18	4408060008	TAPPO PICCOLO INIEZIONE PER VASCA	
4	4408060050	GRUPPO PREMISTOPPA PG11		19	4408060019	PRESA DI INIEZIONE COMPLETA PER VASC	
5	4408060022	TUBO IN LATEX		20	* 4408060128	PORTAELETTODI (60 M3)	
6	4408040049	PORTA RULLI PH MODELLO 2 1,8-2,4		20	* 4408060129	PORTAELETTODI (100 M3)	
7	4408060039	POMPA PERISTALTICA 2.4 L/H		20	* 4408060101	PORTAELETTODI (40 - 160 M3)	
8	4408060080	COPERTURA TRANSPARENTA POMPA L3		21	4408060116	ANELLO BLOCCAGGIO SONDA + GUARNIZI	
9	4408060002	CAVO ELETTRODO		22	4408060105	GHIERA D.92 ELETTRODO + GUARNIZIONE	
10	4408060003	CAVO DI ALIMENTAZIONE 3X1MM2 2.1M		23	4408060108	FLUSOSTATO COMPLETO	
11	4408040037	SUPPORTO MURALE		24	4408060118	PRESA ASPIRAZIONE PH COMPLETA	
12	4408060103	RIDUZIONE 63/50		25	4408060026	PRESA A TERRA	
13	4408060007	ASTUCCIO ANALISI SEL		26	4408060121	TAPPO NERO PICCOLO + GUARNIZIONE	

*** SI FACCIA RIFERIMENTO AL FOGLIO DELLE OSSERVAZIONI**

CODICE 60238, 60239, 60240, 66678, 66679, 66680

DESCRIZIONE: ELETTROLISI DUAL PURE 60, 100, 160

14	4408060117	SONDA PH	27	4408040028	TUBO PVC TRASPARENTE 4X6MM L=4M
15	4408060102	RIDUZIONE 75/63	28	4408060106	GUARNIZIONE ELETTRODO
29	4408060028	SCATOLA IN SEL PURE V4	33	4408060057	SCHEDA PH ECCO E5
30	4408060044	SCHEDA V4 CONESSIONE LUNGA CON DIK	34	* 54054	ELETTRODO ASTRAL SEL 60 - 9 PLACHE
31	4408060144	SCHEDA PH ECCO E5 SENZA DISPLAY	34	* 54055	ELETTRODO ASTRAL SEL 100 - 9 PLACHE
32	4408060055	INTERRUTTORE	34	* 54056	ELETTRODO ASTRAL SEL 160 - 9 PLACHE

CODICE **60238, 60239, 60240, 66678, 66679, 66680**

DESCRIZIONE: ELETTROLISI DUAL PURE 60, 100, 160

OSSERVAZIONI

POS	CODICE	OSSERVAZIONI
20	* 4408060128	PER: 60238, 66678
20	* 4408060129	PER: 60239, 66679
20	* 4408060101	PER: 60240, 66680
34	* 54054	PER: 60238, 66678
34	* 54055	PER: 60239, 66679
34	* 54056	PER: 60240, 66680

CODE **60238, 60239, 60240, 66678, 66679, 66680**

BESCHREIBUNG: **ELEKTROLYSE DUAL PURE 60, 100, 160**

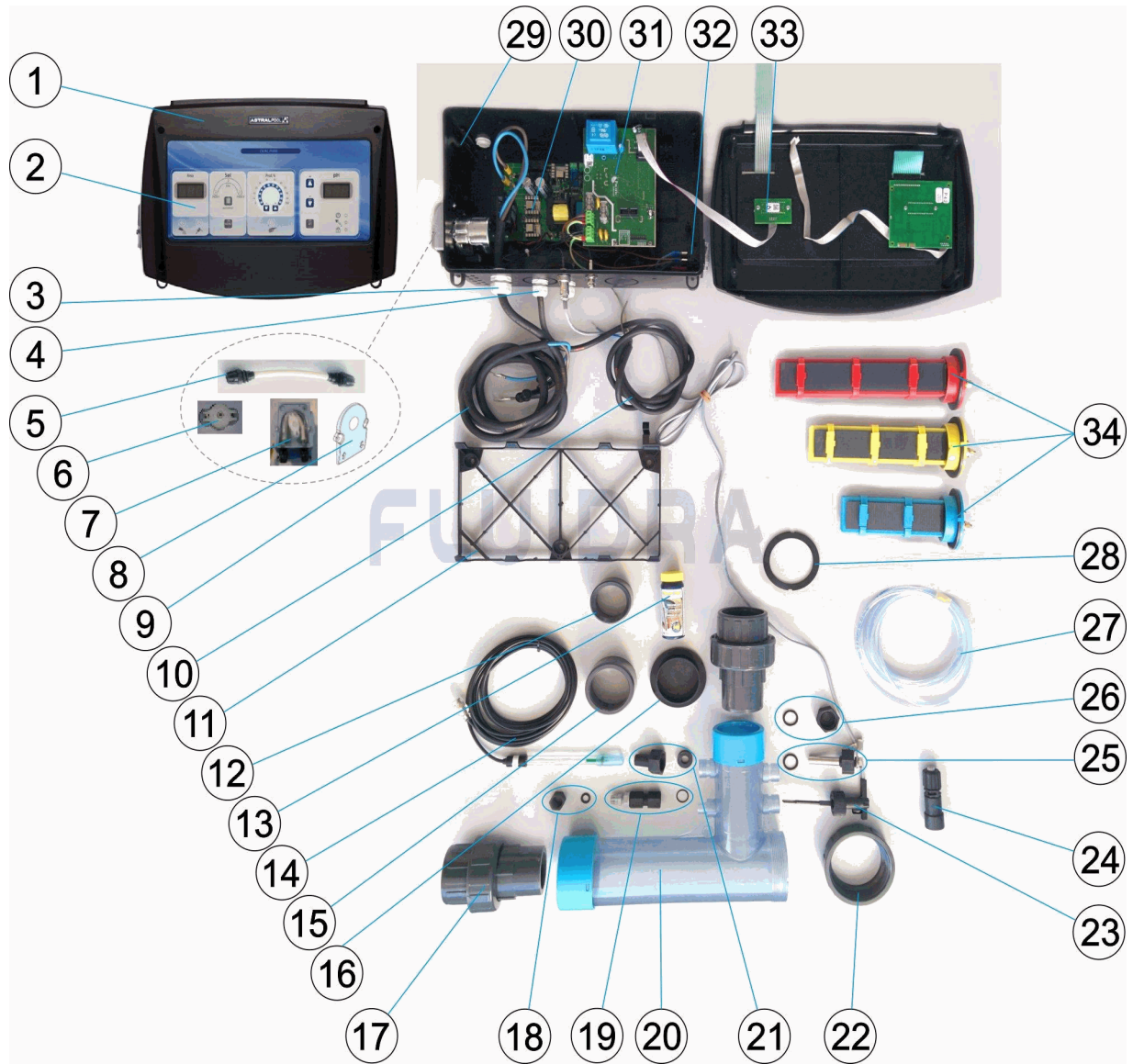

DEUTSCH

POS	CODE	BESCHREIBUNG	MENGE	POS	CODE	BESCHREIBUNG	MENGE
1	4408060043	ABDECKUNG GEHÄUSE DUAL PURE		16	4408060112	SET GEWINDESTÜCK	
2	4408060046	BEDIENFELD DUAL PURE		17	4408060104	GEWINDESTÜCK VERBINDUNG - KRAGEN	
3	4408060051	SET QUETSCHVERSCHRAUBUNG PG16		18	4408060008	STOPFEN KLEIN FÜR GEHÄUSE	
4	4408060050	SET QUETSCHVERSCHRAUBUNG PG11		19	4408060019	INJEKTIONSTEIL KOMPLETT FÜR GEHÄUSI	
5	4408060022	LATEXROHR MIT GEWINDEN		20	* 4408060128	ZELLENGEHÄUSE (60 M3)	
6	4408040049	ROLLENSITZ PH MODELL 2 1,8 - 2,4		20	* 4408060129	ZELLENGEHÄUSE (100 M3)	
7	4408060039	PUMPE PH 2,4 L/H		20	* 4408060101	ZELLENGEHÄUSE (40 - 160 M3)	
8	4408060080	ABDECKUNG TRANSPARENT PUMPE L3 M		21	4408060116	SONDENVERRIEGELUNGSRING + DICHTUNG	
9	4408060002	ELEKTRODENKABEL KOMPLETT		22	4408060105	MUTTER D. 92 ELEKTRODE SEL UND DICHTUNG	
10	4408060003	VERSORGUNGSKABEL 3X1MM2 2.1M		23	4408060108	DURCHFLUSSMESSER KOMPLETT	
11	4408040037	WANDHALTERUNG		24	4408060118	SAUGANSCHLUSS KOMPLETT	
12	4408060103	REDUZIERSTÜCK 63/50		25	4408060026	ERDUNG GEHÄUSE	
13	4408060007	ANALYSEETUI SEL		26	4408060121	STOPFEN SCHWARZ VERSCHLUSS UND DICHTUNG	

* SIEHE ANMERKUNGSBLATT

CODE **60238, 60239, 60240, 66678, 66679, 66680**

BESCHREIBUNG: **ELEKTROLYSE DUAL PURE 60, 100, 160**

14	4408060117	PH-SONDE	27	4408040028	ROHR PVC TRANSPARENT 4X6MM L=4M
15	4408060102	REDUZIERSTÜCK 75/63	28	4408060106	FLACHDICHTUNG ELEKTRODE SEL
29	4408060028	GEHÄUSE SEL PURE V4	33	4408060057	PLATINE PH ECCO E5 BILDSCHIRM SPORT
30	4408060044	PLATINE V4 ANSCHLUSS LANG MIT DISPL	34	* 54054	SALZELECTRODE 60 - 9 PLATTEN
31	4408060144	PLATINE PH ECCO E5 OHNE DISPLAY	34	* 54055	ELEKTRODE SEL 100 - 9 PLATINEN
32	4408060055	SCHALTER MIT HAUBE	34	* 54056	ELEKTRODE SEL 160 - 9 PLATINEN

CODE **60238, 60239, 60240, 66678, 66679, 66680**

BESCHREIBUNG: **ELEKTROLYSE DUAL PURE 60, 100, 160**

HINWEISE

POS	CODE	HINWEISE
20	* 4408060128	FÜR: 60238, 66678
20	* 4408060129	FÜR: 60239, 66679
20	* 4408060101	FÜR: 60240, 66680
34	* 54054	FÜR: 60238, 66678
34	* 54055	FÜR: 60239, 66679
34	* 54056	FÜR: 60240, 66680

CODIGO 60238, 60239, 60240, 66678, 66679, 66680

DESCRIÇÃO: ELECTRÓLISE DUAL PURE 60, 100, 160

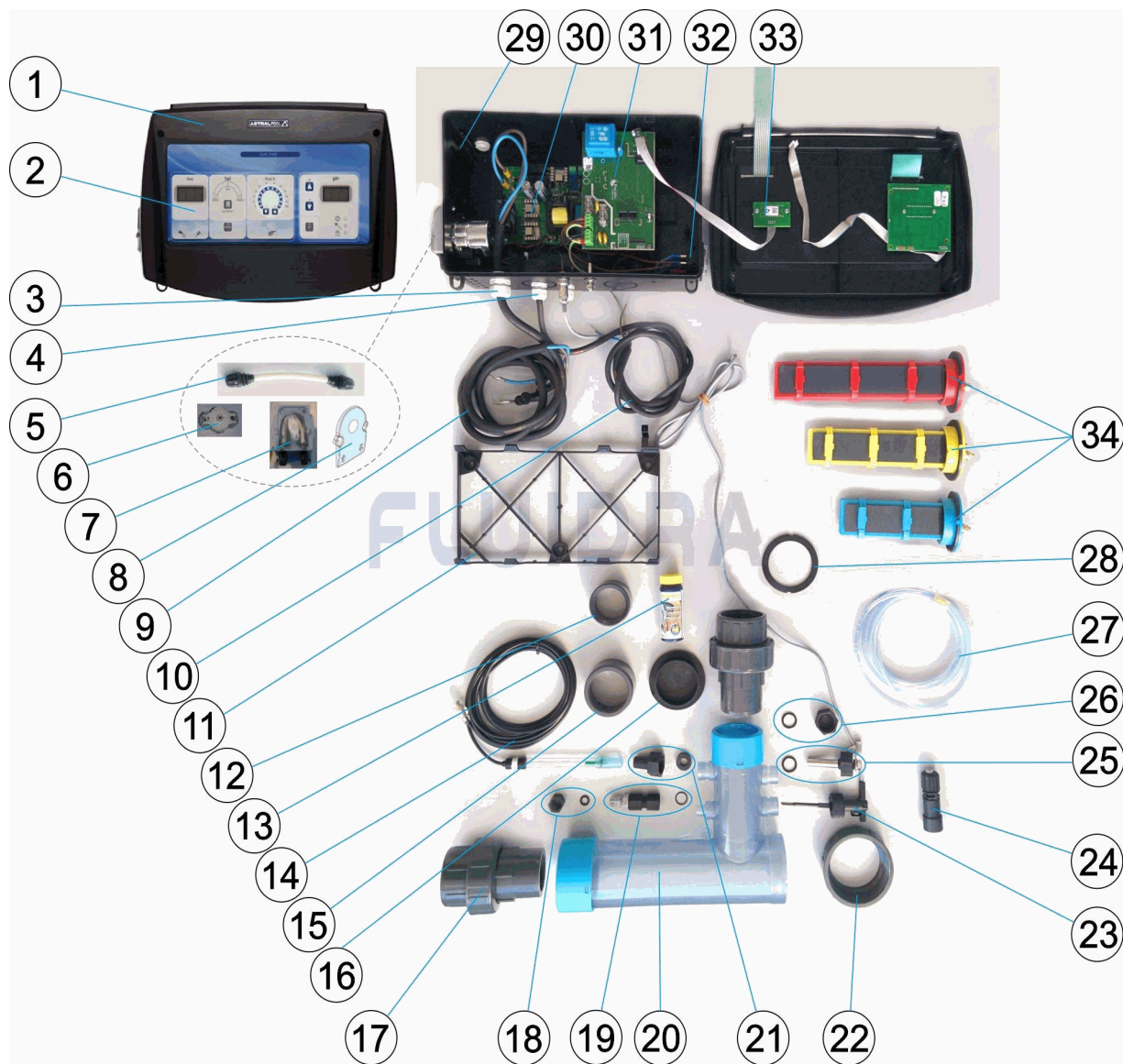

PORTUGUES

POS	CODIGO	DESCRIÇÃO	JANTIDADE	POS	CODIGO	DESCRIÇÃO	JANTIDADE
1	4408060043	TAMPA CORPO DUAL PURE		16	4408060112	CONJUNTO RACORD	
2	4408060046	COBERTA DUAL PURE		17	4408060104	RACORD DE UNIÃO A COLAR M/F. 63	
3	4408060051	CJTO. PRENSA-ESTOPAS PG16		18	4408060008	TAMPA PEQUENA INJECCÃO PARA COPO	
4	4408060050	CJTO. PRENSA-ESTOPAS PG11		19	4408060019	TOMADA INJECCÃO COMPLETA PARA VAS	
5	4408060022	TUBO DE LÁTEX		20	* 4408060128	CARÇAÇA PORTA-CÉLULAS (60 M3)	
6	4408040049	PORTA CILINDROS PH MODELO 2 1,8-2,4		20	* 4408060129	CARÇAÇA PORTA-CÉLULAS (100 M3)	
7	4408060039	BOMBA PERISTÁLTICA 2.4 L/H		20	* 4408060101	CARÇAÇA PORTA-CÉLULAS (40 - 160 M3)	
8	4408060080	COBERTURA TRANSPARENTE BOMBA L3 I		21	4408060116	ANEL DE BLOQUEIO DA SONDA + JUNTA	
9	4408060002	CABO SONDA		22	4408060105	PORCA D. 92 ELÉCTRODO SEL + JUNTA	
10	4408060003	CABO ALIMENTAÇÃO 3X1MM2 2.1M		23	4408060108	FLUXO-ESTATO COMPLETO	
11	4408040037	SUPORTE PAREDE		24	4408060118	TOMADA DE ASPIRAÇÃO COMPLETA	
12	4408060103	REDUÇÃO 63/50		25	4408060026	LIGAÇÃO A TERRA	
13	4408060007	ESTOJO ANÁLISE SEL		26	4408060121	TAMPÃO PRETO OBTURADOR + JUNTA	

*** VEJA A FICHA DE OBSERVAÇÕES**

CODIGO 60238, 60239, 60240, 66678, 66679, 66680

DESCRIÇÃO: ELECTRÓLISE DUAL PURE 60, 100, 160

14	4408060117	SONDA PH	27	4408040028	TUBO PVC TRANSPARENTE 4X6MM L=4M
15	4408060102	REDUÇÃO 75/63	28	4408060106	JUNTA PLANA ELÉCTRODO SEL
29	4408060028	CARÇA SEL PURE V4	33	4408060057	PLACA PH ECCO E5
30	4408060044	PLACA V4 FICHA COMPRIDA COM DISPLA\	34	* 54054	ELÉCTRODO SEL 60 - 9 PLACAS
31	4408060144	PLACA PH ECCO E5 SEM DISPLAY	34	* 54055	ELÉCTRODO SEL 100 - 9 PLACAS
32	4408060055	INTERRUPTOR	34	* 54056	ELÉCTRODO SEL 160 - 9 PLACAS

CODIGO 60238, 60239, 60240, 66678, 66679, 66680

DESCRIÇÃO: ELECTRÓLISE DUAL PURE 60, 100, 160

OBSERVAÇÕES

POS	CODIGO	OBSERVAÇÕES
20	* 4408060128	PARA: 60238, 66678
20	* 4408060129	PARA: 60239, 66679
20	* 4408060101	PARA: 60240, 66680
34	* 54054	PARA: 60238, 66678
34	* 54055	PARA: 60239, 66679
34	* 54056	PARA: 60240, 66680