

CODIGO **67656, 67657, 67658**

DESCRIPCION: **ESCALERA ELEVADA SEGURIDAD**

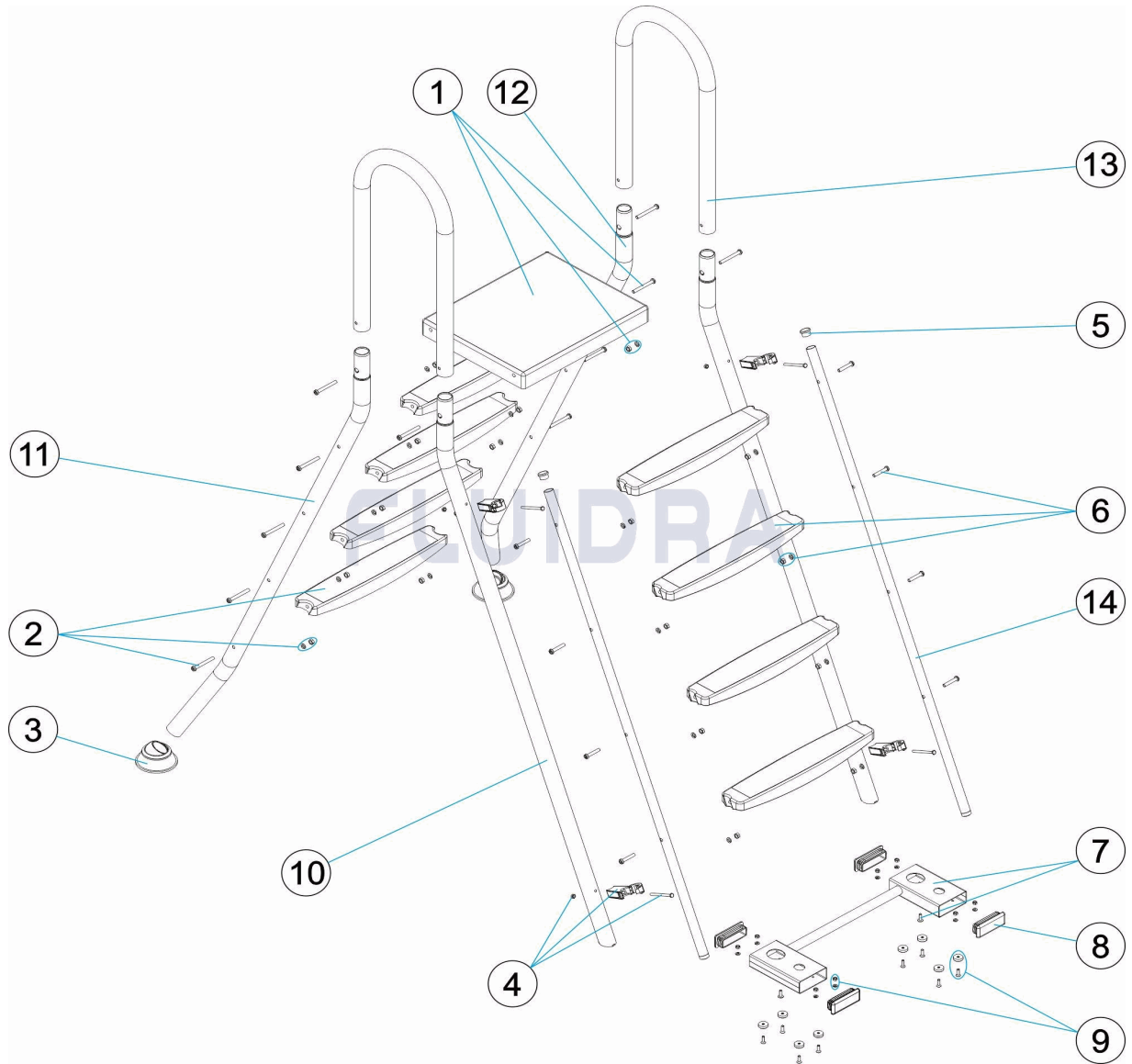

**ESPAÑOL**

POS	CODIGO	DESCRIPCION	CANTIDAD	POS	CODIGO	DESCRIPCION	CANTIDAD
1	4401011403	PELDAÑO PLASTICO		10	* M00636R0500	PASAMANO ESCALERA	
2	4401010026	PELDAÑO PLASTICO 500 INCLINADO A4		11	* M00634R0300	PASAMANO ESCALERA	
3	4401010501	TOPE ARTICULADO		11	* M00635R0300	PASAMANO ESCALERA	
4	4401010009	CJTO. PINZA CLIP		11	* M00636R0300	PASAMANO ESCALERA	
5	4401010010	TAPON PROTECTOR		12	* M00634R0200	PASAMANO ESCALERA	
6	4401010011	PELDAÑO PLASTICO D.43		12	* M00635R0200	PASAMANO ESCALERA	
7	4401010012	PIE		12	* M00636R0200	PASAMANO ESCALERA	
8	4401010013	TAPON PROTECTOR		13	05520R0200	PUENTE UNION	
9	4401010014	FIJACION PIE		14	* M00634R0400	PASAMANO ESCALERA	
10	* M00634R0500	PASAMANO ESCALERA		14	* M00635R0400	PASAMANO ESCALERA	
10	* M00635R0500	PASAMANO ESCALERA		14	* M00636R0400	PASAMANO ESCALERA	

**CODIGO 67656, 67657, 67658**

**DESCRIPCION: ESCALERA ELEVADA SEGURIDAD**

## OBSERVACIONES

POS	CODIGO	OBSERVACIONES
10	* M00634R0500	PARA: 67656
10	* M00635R0500	PARA: 67657
10	* M00636R0500	PARA: 67658
11	* M00634R0300	PARA: 67656
11	* M00635R0300	PARA: 67657
11	* M00636R0300	PARA: 67658
12	* M00634R0200	PARA: 67656
12	* M00635R0200	PARA: 67657
12	* M00636R0200	PARA: 67658
14	* M00634R0400	PARA: 67656
14	* M00635R0400	PARA: 67657
14	* M00636R0400	PARA: 67658

CODE 67656, 67657, 67658

DESCRIPTION: ÉCHELLE HORS SOL SÉCURITÉ

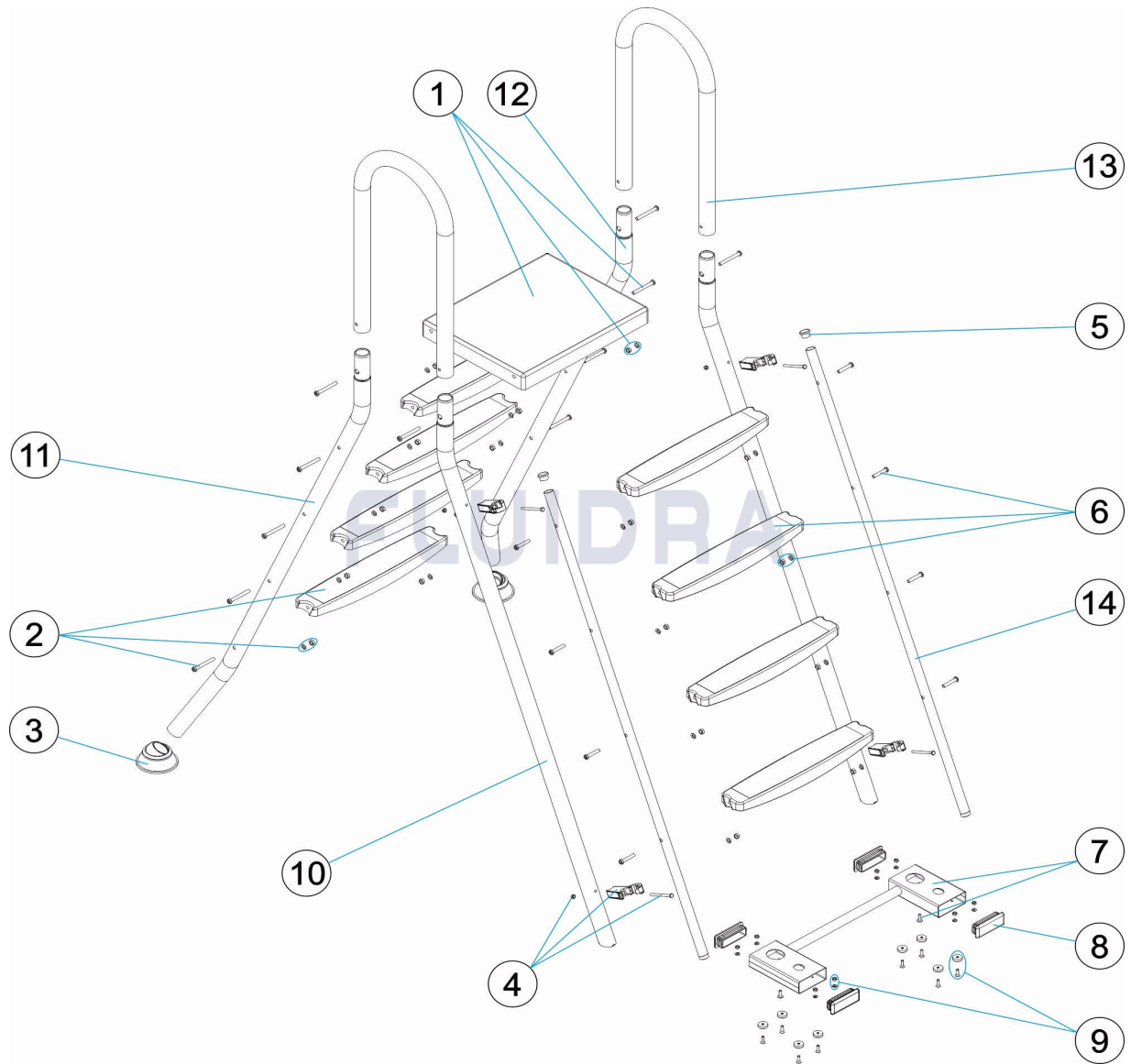

FRANCAIS

POS	CODE	DESCRIPTION	QUANTITE	POS	CODE	DESCRIPTION	QUANTITE
1	4401011403	MARCHE PLASTIQUE LARGEUR		10	* M00636R0500	MONTANT	
2	4401010026	MARCHE PLASTIQUE LARG 500 INCLINÉE		11	* M00634R0300	MONTANT	
3	4401010501	TAMPON ARTICULÉ		11	* M00635R0300	MONTANT	
4	4401010009	ENSEMBLE PINCE CLIP		11	* M00636R0300	MONTANT	
5	4401010010	BOUCHON PROTECTEUR		12	* M00634R0200	MONTANT	
6	4401010011	MARCHE PLASTIQUE D.43		12	* M00635R0200	MONTANT	
7	4401010012	SOCLE		12	* M00636R0200	MONTANT	
8	4401010013	BOUCHON PROTECTEUR		13	05520R0200	MONTANT UNION	
9	4401010014	FIXATION SOCLE		14	* M00634R0400	MONTANT	
10	* M00634R0500	MONTANT		14	* M00635R0400	MONTANT	
10	* M00635R0500	MONTANT		14	* M00636R0400	MONTANT	

CODE **67656, 67657, 67658**

DESCRIPTION: **ÉCHELLE HORS SOL SÉCURITÉ**

## OBSERVATIONS

POS	CODE	OBSERVATIONS
10	* M00634R0500	POUR: 67656
10	* M00635R0500	POUR: 67657
10	* M00636R0500	POUR: 67658
11	* M00634R0300	POUR: 67656
11	* M00635R0300	POUR: 67657
11	* M00636R0300	POUR: 67658
12	* M00634R0200	POUR: 67656
12	* M00635R0200	POUR: 67657
12	* M00636R0200	POUR: 67658
14	* M00634R0400	POUR: 67656
14	* M00635R0400	POUR: 67657
14	* M00636R0400	POUR: 67658

CODE **67656, 67657, 67658**

DESCRIPTION: **SECURITY ABOVE GROUND LADDER**

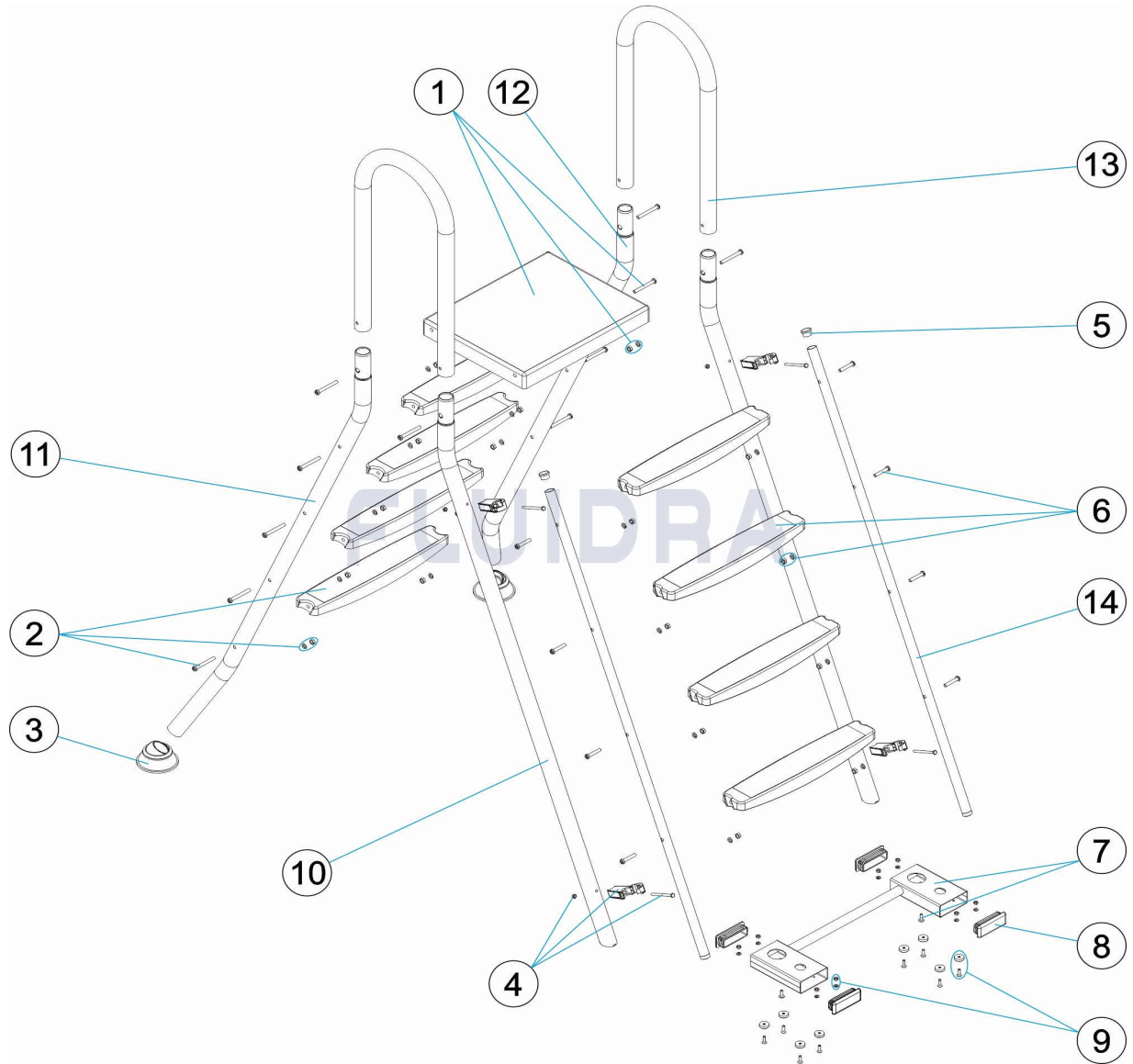

**ENGLISH**

POS	CODE	DESCRIPTION	QUANTITY	POS	CODE	DESCRIPTION	QUANTITY
1	4401011403	PLASTIC TREAD		10	* M00636R0500	HANDRAIL LADDER	
2	4401010026	ANGLED PLASTIC TREAD 500 A4		11	* M00634R0300	HANDRAIL LADDER	
3	4401010501	ARTICULATED FOOT PAD		11	* M00635R0300	HANDRAIL LADDER	
4	4401010009	PIN CLIP UNIT		11	* M00636R0300	HANDRAIL LADDER	
5	4401010010	SMALL PROTECTIVE PLUG		12	* M00634R0200	HANDRAIL LADDER	
6	4401010011	PLASTIC TREAD D.43		12	* M00635R0200	HANDRAIL LADDER	
7	4401010012	BASE		12	* M00636R0200	HANDRAIL LADDER	
8	4401010013	SMALL PROTECTIVE PLUG		13	05520R0200	JOINT BRIDGE	
9	4401010014	BASE FIXING		14	* M00634R0400	HANDRAIL LADDER	
10	* M00634R0500	HANDRAIL LADDER		14	* M00635R0400	HANDRAIL LADDER	
10	* M00635R0500	HANDRAIL LADDER		14	* M00636R0400	HANDRAIL LADDER	

CODE                    **67656, 67657, 67658**

DESCRIPTION: **SECURITY ABOVE GROUND LADDER**

## OBSERVATIONS

POS	CODE	OBSERVATIONS
10	* M00634R0500	FOR: 67656
10	* M00635R0500	FOR: 67657
10	* M00636R0500	FOR: 67658
11	* M00634R0300	FOR: 67656
11	* M00635R0300	FOR: 67657
11	* M00636R0300	FOR: 67658
12	* M00634R0200	FOR: 67656
12	* M00635R0200	FOR: 67657
12	* M00636R0200	FOR: 67658
14	* M00634R0400	FOR: 67656
14	* M00635R0400	FOR: 67657
14	* M00636R0400	FOR: 67658

CODICE 67656, 67657, 67658

DESCRIZIONE: SCALA PISCINA ELEVATA SICUREZZA

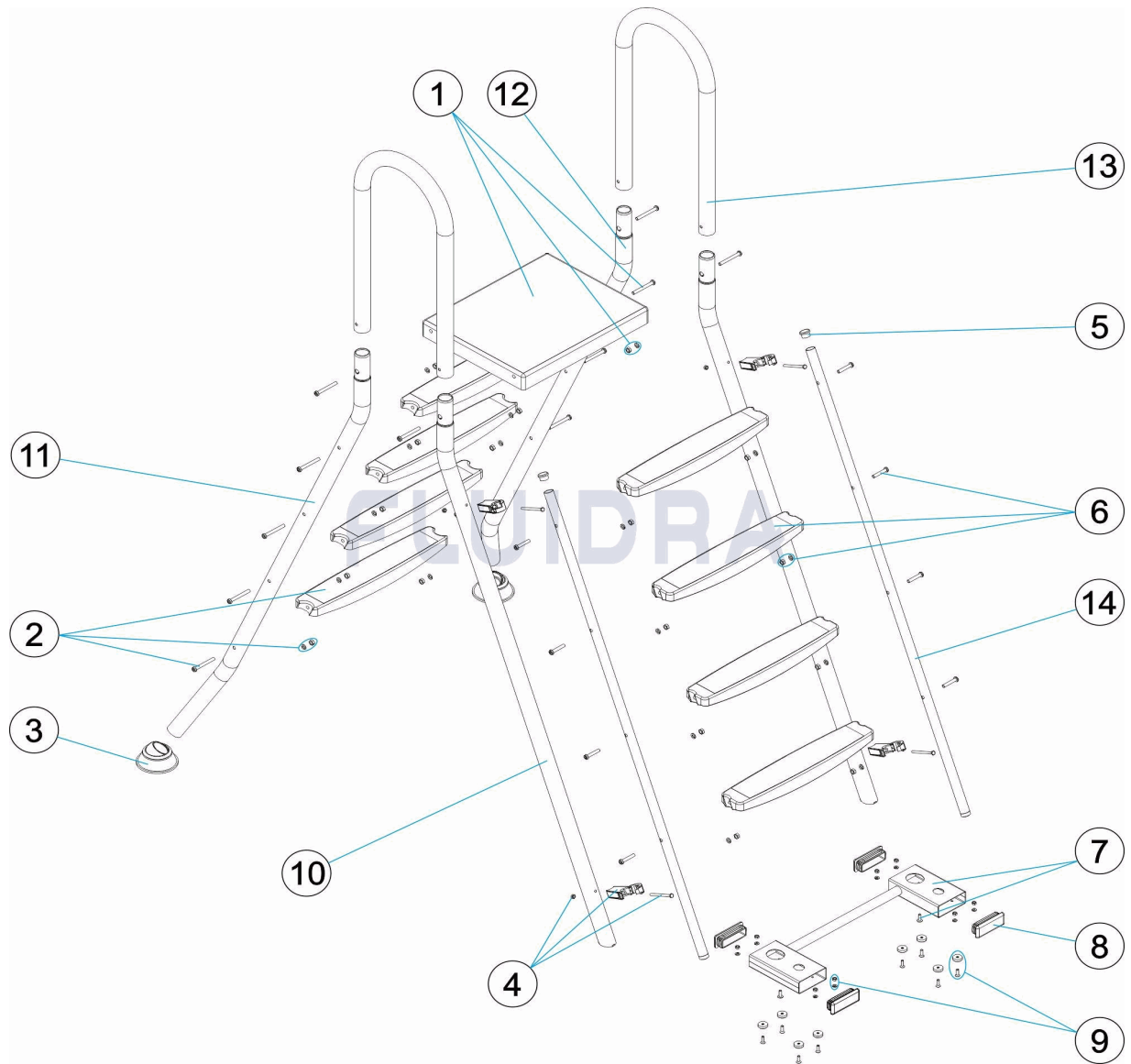

ITALIANO

POS	CODICE	DESCRIZIONE	QUANTITA'	POS	CODICE	DESCRIZIONE	QUANTITA'
1	4401011403	GRADINO IN PLASTICA		10	* M00636R0500	CORRIMANO SCALA	
2	4401010026	GRADINO IN PLASTICA DA 500 INCLINATO		11	* M00634R0300	CORRIMANO SCALA	
3	4401010501	PIEDINO SNODABILE		11	* M00635R0300	CORRIMANO SCALA	
4	4401010009	SET MORSETTI		11	* M00636R0300	CORRIMANO SCALA	
5	4401010010	TAPPO DI PROTEZIONE		12	* M00634R0200	CORRIMANO SCALA	
6	4401010011	GRADINO IN PLASTICA D.43		12	* M00635R0200	CORRIMANO SCALA	
7	4401010012	PIEDE		12	* M00636R0200	CORRIMANO SCALA	
8	4401010013	TAPPO DI PROTEZIONE		13	05520R0200	PONTE UNIONE	
9	4401010014	FISSAGGIO PIEDE		14	* M00634R0400	CORRIMANO SCALA	
10	* M00634R0500	CORRIMANO SCALA		14	* M00635R0400	CORRIMANO SCALA	
10	* M00635R0500	CORRIMANO SCALA		14	* M00636R0400	CORRIMANO SCALA	

CODICE **67656, 67657, 67658**

DESCRIZIONE: **SCALA PISCINA ELEVATA SICUREZZA**

## OSSERVAZIONI

POS	CODICE	OSSERVAZIONI
10	* M00634R0500	PER: 67656
10	* M00635R0500	PER: 67657
10	* M00636R0500	PER: 67658
11	* M00634R0300	PER: 67656
11	* M00635R0300	PER: 67657
11	* M00636R0300	PER: 67658
12	* M00634R0200	PER: 67656
12	* M00635R0200	PER: 67657
12	* M00636R0200	PER: 67658
14	* M00634R0400	PER: 67656
14	* M00635R0400	PER: 67657
14	* M00636R0400	PER: 67658



CODE 67656, 67657, 67658

BESCHREIBUNG: SICHERHEITSTREPPE AUFSTELLBECKEN

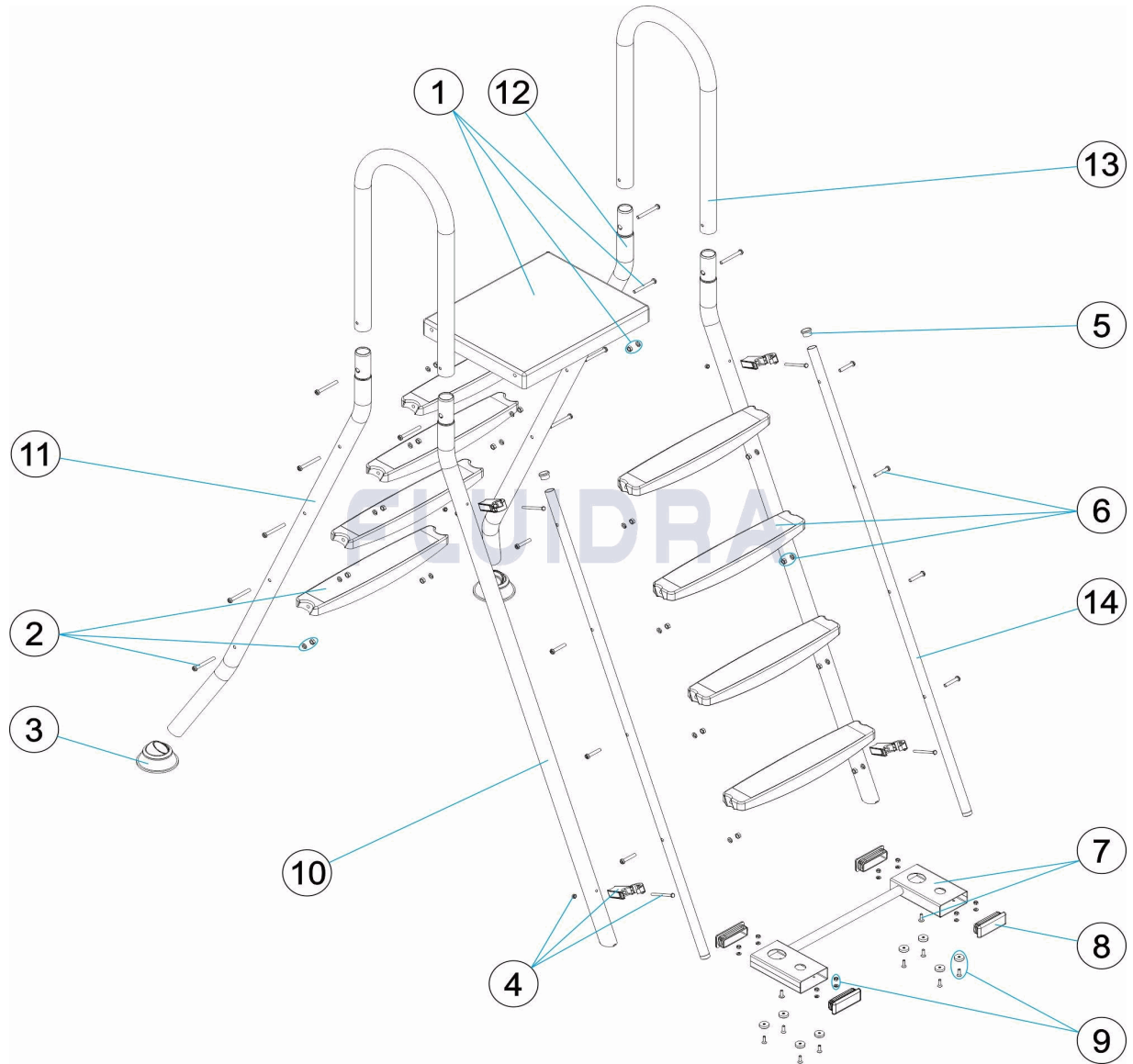

DEUTSCH

POS	CODE	BESCHREIBUNG	MENGE	POS	CODE	BESCHREIBUNG	MENGE
1	4401011403	STUFE KUNSTSTOFF		10	* M00636R0500	HANDLAUF TREPPE	
2	4401010026	STUFE KUNSTSTOFF 500 GENEIGT A4		11	* M00634R0300	HANDLAUF TREPPE	
3	4401010501	BEWEGLICHER ABSCHLUSS		11	* M00635R0300	HANDLAUF TREPPE	
4	4401010009	SET KLAMMER CLIP		11	* M00636R0300	HANDLAUF TREPPE	
5	4401010010	SCHUTZSTOPFEN		12	* M00634R0200	HANDLAUF TREPPE	
6	4401010011	STUFE KUNSTSTOFF D.43		12	* M00635R0200	HANDLAUF TREPPE	
7	4401010012	FUSS		12	* M00636R0200	HANDLAUF TREPPE	
8	4401010013	SCHUTZSTOPFEN		13	05520R0200	VERBINDUNGSBRÜCKE	
9	4401010014	FIXIE FUSS		14	* M00634R0400	HANDLAUF TREPPE	
10	* M00634R0500	HANDLAUF TREPPE		14	* M00635R0400	HANDLAUF TREPPE	
10	* M00635R0500	HANDLAUF TREPPE		14	* M00636R0400	HANDLAUF TREPPE	

CODE **67656, 67657, 67658**

BESCHREIBUNG: **SICHERHEITSTREPPE AUFSTELLBECKEN**

## HINWEISE

POS	CODE	HINWEISE
10	* M00634R0500	FÜR: 67656
10	* M00635R0500	FÜR: 67657
10	* M00636R0500	FÜR: 67658
11	* M00634R0300	FÜR: 67656
11	* M00635R0300	FÜR: 67657
11	* M00636R0300	FÜR: 67658
12	* M00634R0200	FÜR: 67656
12	* M00635R0200	FÜR: 67657
12	* M00636R0200	FÜR: 67658
14	* M00634R0400	FÜR: 67656
14	* M00635R0400	FÜR: 67657
14	* M00636R0400	FÜR: 67658

CODIGO **67656, 67657, 67658**

DESCRIÇÃO: **ESCADA ELEVADA SEGURANÇA**

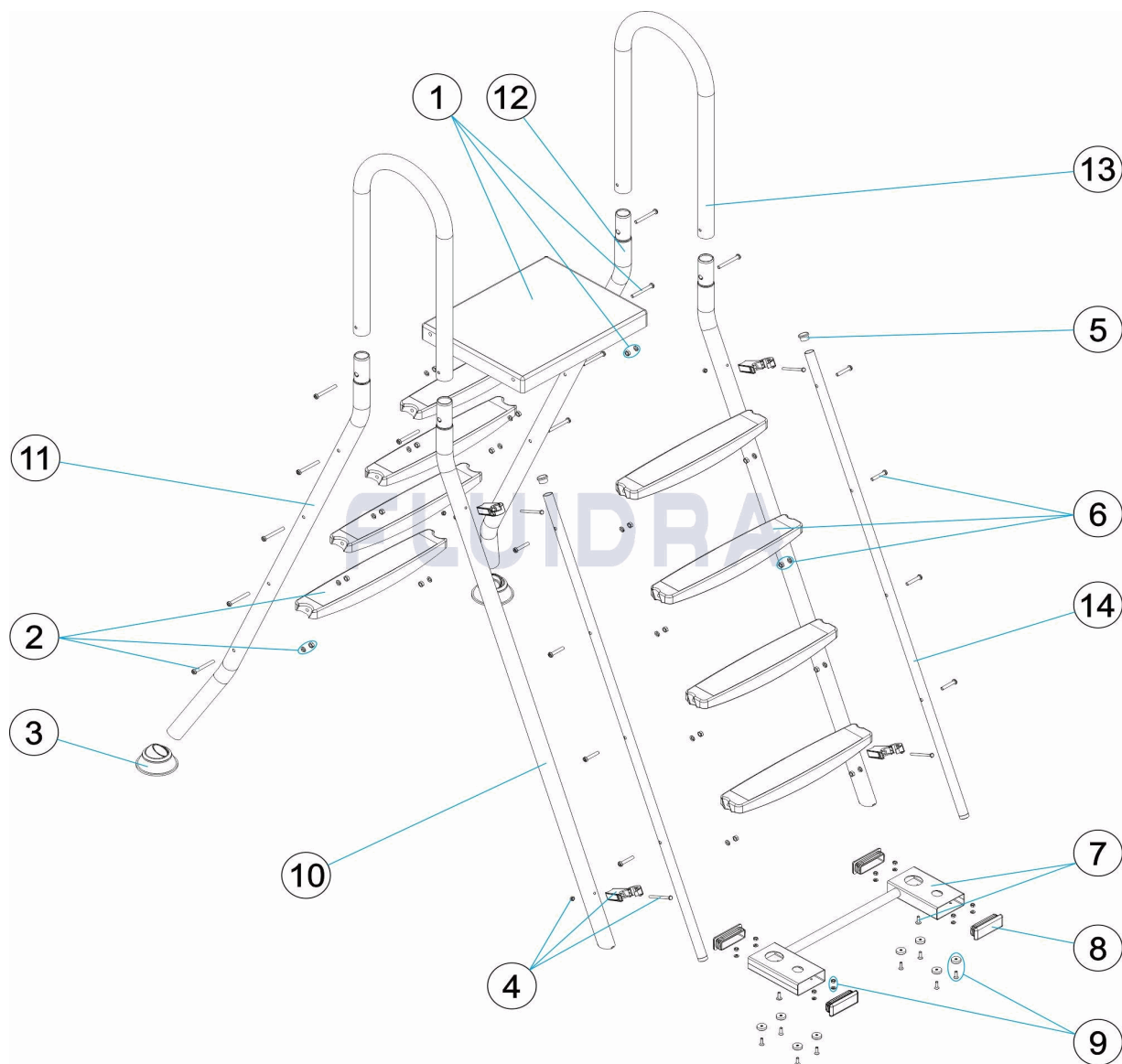

**PORTUGUES**

POS	CODIGO	DESCRIÇÃO	JANTIDADE	POS	CODIGO	DESCRIÇÃO	JANTIDADE
1	4401011403	DEGRAU PLÁSTICO		10	* M00636R0500	CORRIMÃO ESCADA	
2	4401010026	DEGRAU PLÁSTICO 500 INCLINADO A4		11	* M00634R0300	CORRIMÃO ESCADA	
3	4401010501	BATENTE ARTICULADA		11	* M00635R0300	CORRIMÃO ESCADA	
4	4401010009	CJTO. PINÇA CLIPE		11	* M00636R0300	CORRIMÃO ESCADA	
5	4401010010	TAMPÃO PROTECTOR		12	* M00634R0200	CORRIMÃO ESCADA	
6	4401010011	DEGRAU PLÁSTICO D.43		12	* M00635R0200	CORRIMÃO ESCADA	
7	4401010012	PÉ		12	* M00636R0200	CORRIMÃO ESCADA	
8	4401010013	TAMPÃO PROTECTOR		13	05520R0200	PONTE UNIÃO	
9	4401010014	FIXAÇÃO PÉ		14	* M00634R0400	CORRIMÃO ESCADA	
10	* M00634R0500	CORRIMÃO ESCADA		14	* M00635R0400	CORRIMÃO ESCADA	
10	* M00635R0500	CORRIMÃO ESCADA		14	* M00636R0400	CORRIMÃO ESCADA	

**CODIGO 67656, 67657, 67658**

**DESCRIÇÃO: ESCADA ELEVADA SEGURANÇA**

## OBSERVAÇÕES

POS	CODIGO	OBSERVAÇÕES
10	* M00634R0500	PARA: 67656
10	* M00635R0500	PARA: 67657
10	* M00636R0500	PARA: 67658
11	* M00634R0300	PARA: 67656
11	* M00635R0300	PARA: 67657
11	* M00636R0300	PARA: 67658
12	* M00634R0200	PARA: 67656
12	* M00635R0200	PARA: 67657
12	* M00636R0200	PARA: 67658
14	* M00634R0400	PARA: 67656
14	* M00635R0400	PARA: 67657
14	* M00636R0400	PARA: 67658