

CODIGO 71650, 71651, 71652

DESCRIPCION: ENERGY SEL

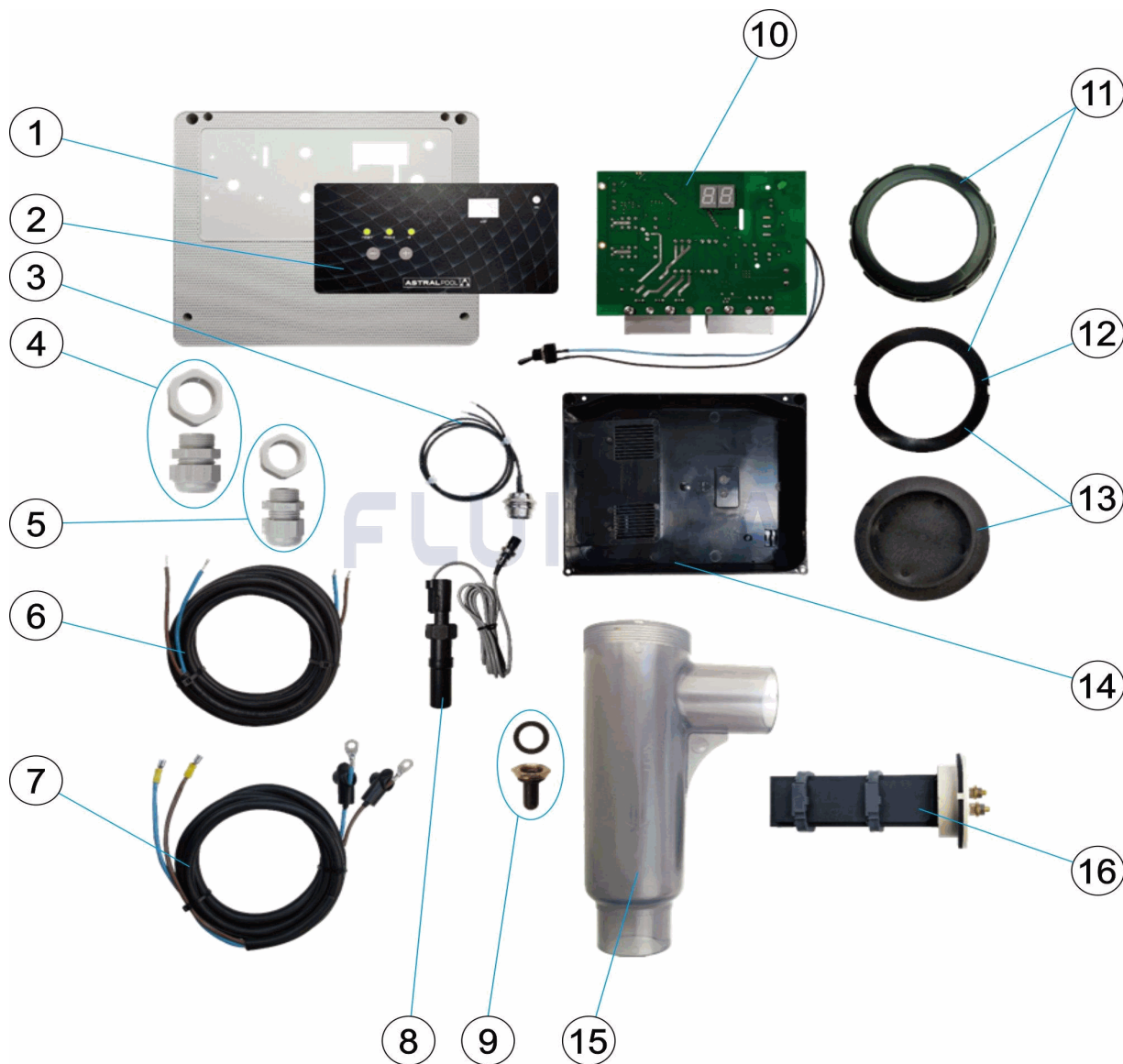

ESPAÑOL

POS	CODIGO	DESCRIPCION	CANTIDAD	POS	CODIGO	DESCRIPCION	CANTIDAD
1	4408060153	CARCASA ENERGY SEL		10	4408060154	CIRC. ELECTRONICO ENERGY SEL	
2	4408060155	CARATULA ENERGY SEL		11	4408060105	TUERCA D. 92 ELECTRODO SEL + JUNTA	
3	4408040410	CONECTOR FLUJOSTATO		12	4408060106	JUNTA PLANA ELECTRODO SEL	
4	4408060051	CJTO PRENSAESTOPAS PG 16		13	4408060122	TAPON GRANDE VASO + JUNTA	
5	4408060050	CJTO PRENSAESTOPAS PG 11		14	4408040411	CARCASA TRASERA	
6	4408040040	CABLE ALIMENTACION 2X1,5MM2 2.1M		15	4408060201	VASO SEL PEQUEÑO PARA BASIC	
7	4408060002	CABLE ELECTRODO COMPLETO		16	* 54051	ELECTRODO SEL 30 - 7 PLACAS	
8	4408060108	FLUXOSTATO COMPLETO		16	* 54052	ELECTRODO SEL 55 - 7 PLACAS	
9	4408060049	CAPUCHON INTERRUPTOR		16	* 54053	ELECTRODO SEL 95 - 7 PLACAS	

CODIGO **71650, 71651, 71652**DESCRIPCION: **ENERGY SEL****OBSERVACIONES**

POS	CODIGO	OBSERVACIONES
16	* 54051	PARA: 71650
16	* 54052	PARA: 71651
16	* 54053	PARA: 71652

CODE 71650, 71651, 71652

DESCRIPTION: ENERGY SEL

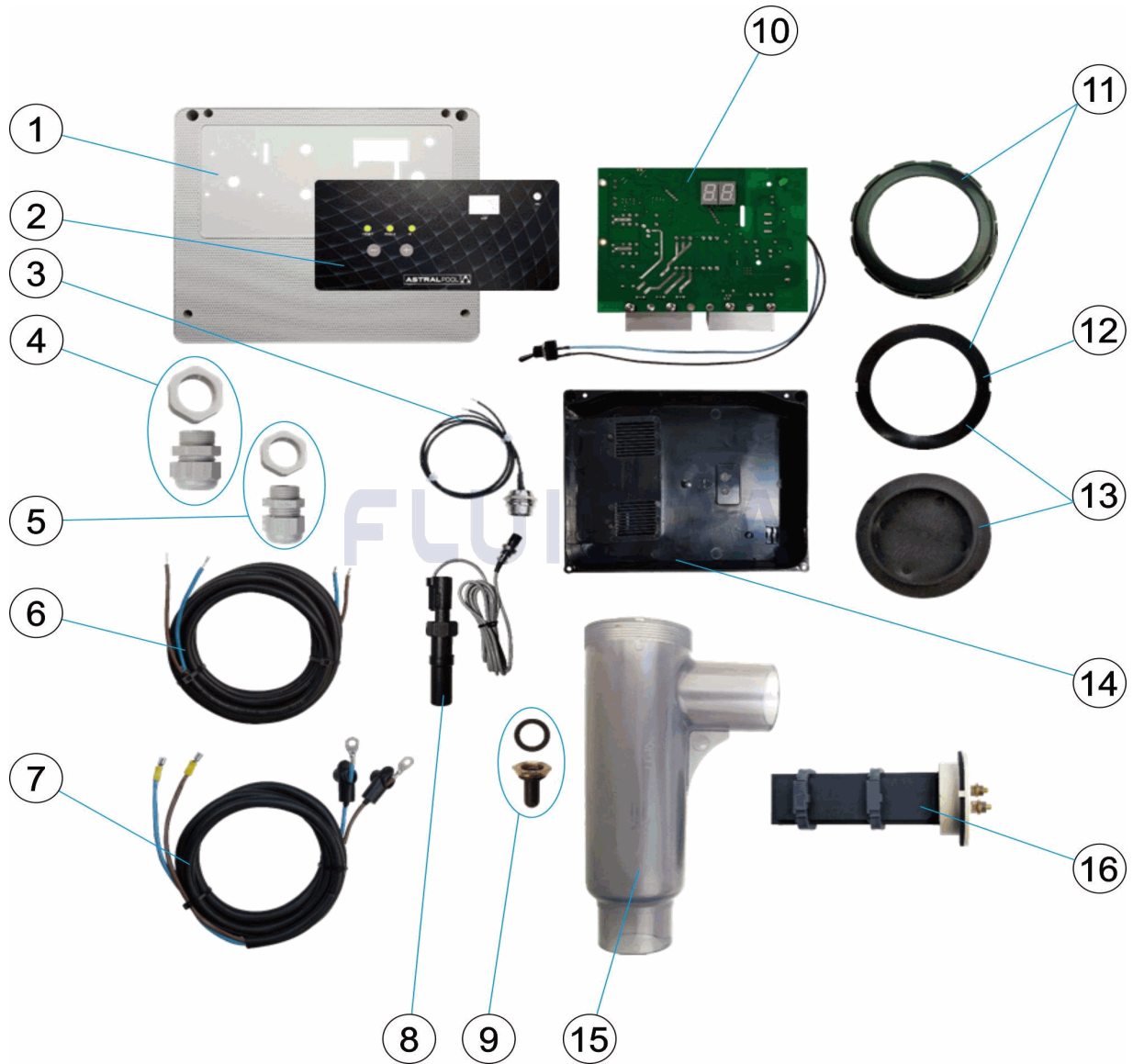

FRANCAIS

POS	CODE	DESCRIPTION	QUANTITE	POS	CODE	DESCRIPTION	QUANTITE
1	4408060153	CARCASSE ENERGY SEL		10	4408060154	CIRCUIT ELECTRONIQUE ENERGY SEL	
2	4408060155	COUVERCLE ENERGY SEL		11	4408060105	ECROU D. 92 ELECTRODE SEL + JOINT	
3	4408040410	CONNECTEUR CONTROLÉUR DE DÉBIT		12	4408060106	JOINT PLAT ÉLECTRODE SEL	
4	4408060051	ENS. PRESSE-ÉTOUPES PG16		13	4408060122	COUVERCLE GRAND VASE + JOINT	
5	4408060050	ENS. PRESSE-ÉTOUPES PG11		14	4408040411	CARCASSE ARRIÈRE	
6	4408040040	CÂBLE ALIMENTATION 2X1,5MM2 2.1M		15	4408060201	VASE SEL POUR BASIC	
7	4408060002	CABLE ELECTRODE		16	* 54051	ELECTRODE SEL 30 -7 PLAQUES	
8	4408060108	CONTROLÉUR DE DÉBIT COMPLET		16	* 54052	ELECTRODE SEL 55 -7 PLAQUES	
9	4408060049	CAPUCHON DE LEVIER		16	* 54053	ELECTRODE SEL 95 -7 PLAQUES	

CODE **71650, 71651, 71652**

DESCRIPTION: **ENERGY SEL**

OBSERVATIONS

POS	CODE	OBSERVATIONS
16	* 54051	POUR: 71650
16	* 54052	POUR: 71651
16	* 54053	POUR: 71652

CODE 71650, 71651, 71652

DESCRIPTION: ENERGY SEL

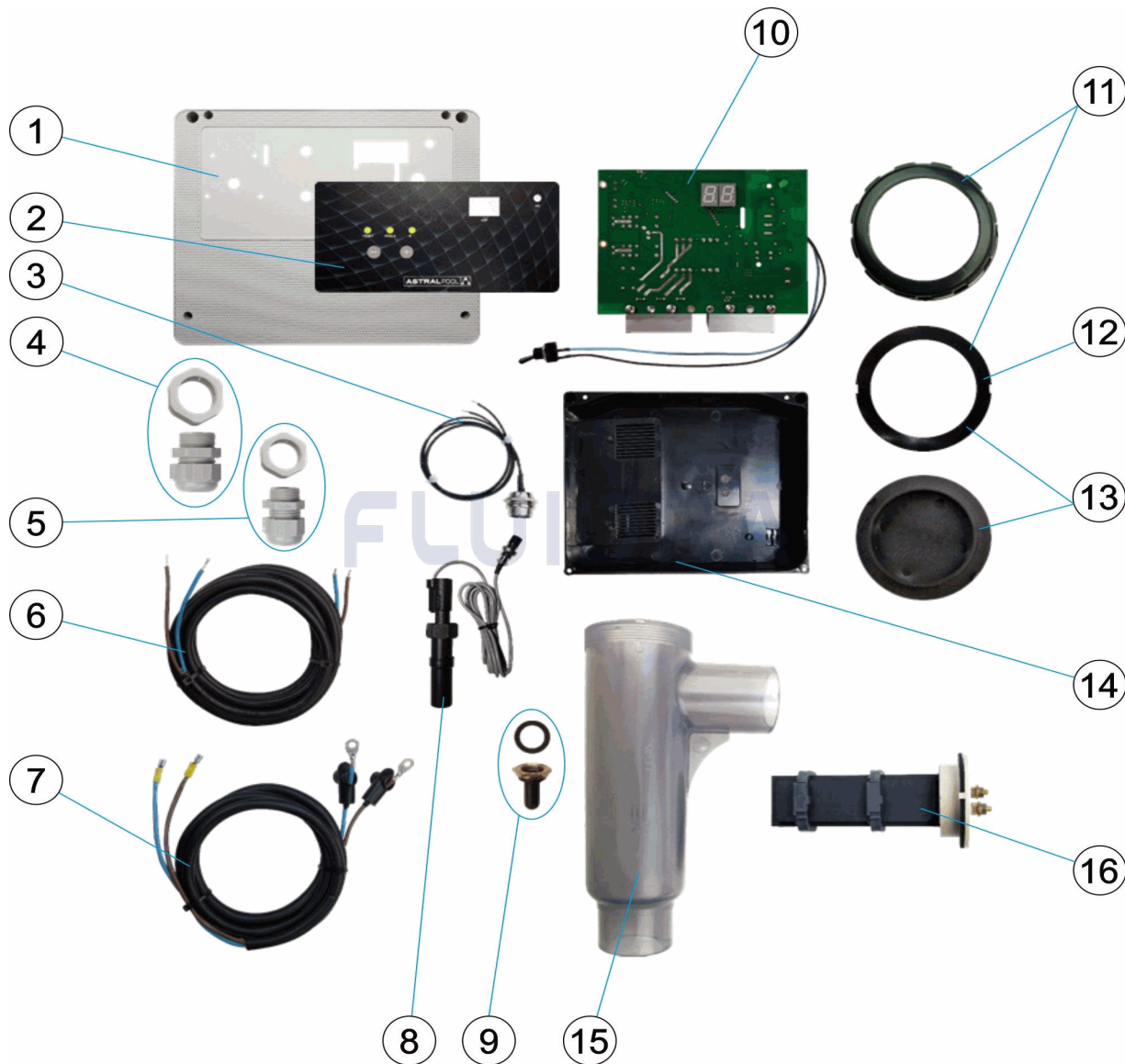

ENGLISH

POS	CODE	DESCRIPTION	QUANTITY	POS	CODE	DESCRIPTION	QUANTITY
1	4408060153	ENERGY SEL SHELL		10	4408060154	ENERGY SEL ELECTRONIC CIRCUIT	
2	4408060155	COVER ENERGY SEL		11	4408060105	D. 92 ELECTRODE NUT + GASKET	
3	4408040410	FLOWSWITCH CONNECTOR		12	4408060106	ELECTRODE GASKET	
4	4408060051	PG16 PACKING GLAND UNIT		13	4408060122	HOUSING CAP + GASKET	
5	4408060050	PG11 PACKING GLAND UNIT		14	4408040411	BACK COVER	
6	4408040040	2X1,5MM2 2.1M SUPPLY CABLE		15	4408060201	BASIC SEL CLASS	
7	4408060002	ELECTRODE CABLE		16	* 54051	ASTRAL SEL 30 ELECTRODE (7 PLATES)	
8	4408060108	COMPLETE FLOWSWITCH		16	* 54052	ASTRAL SEL 55 ELECTRODE (7 PLATES)	
9	4408060049	CIRCUIT BREAKER CAP		16	* 54053	ASTRAL SEL 95 ELECTRODE (7 PLATES)	

CODE **71650, 71651, 71652**

DESCRIPTION: **ENERGY SEL**

OBSERVATIONS

POS	CODE	OBSERVATIONS
16	* 54051	FOR: 71650
16	* 54052	FOR: 71651
16	* 54053	FOR: 71652

CODICE 71650, 71651, 71652

DESCRIZIONE: ENERGY SEL

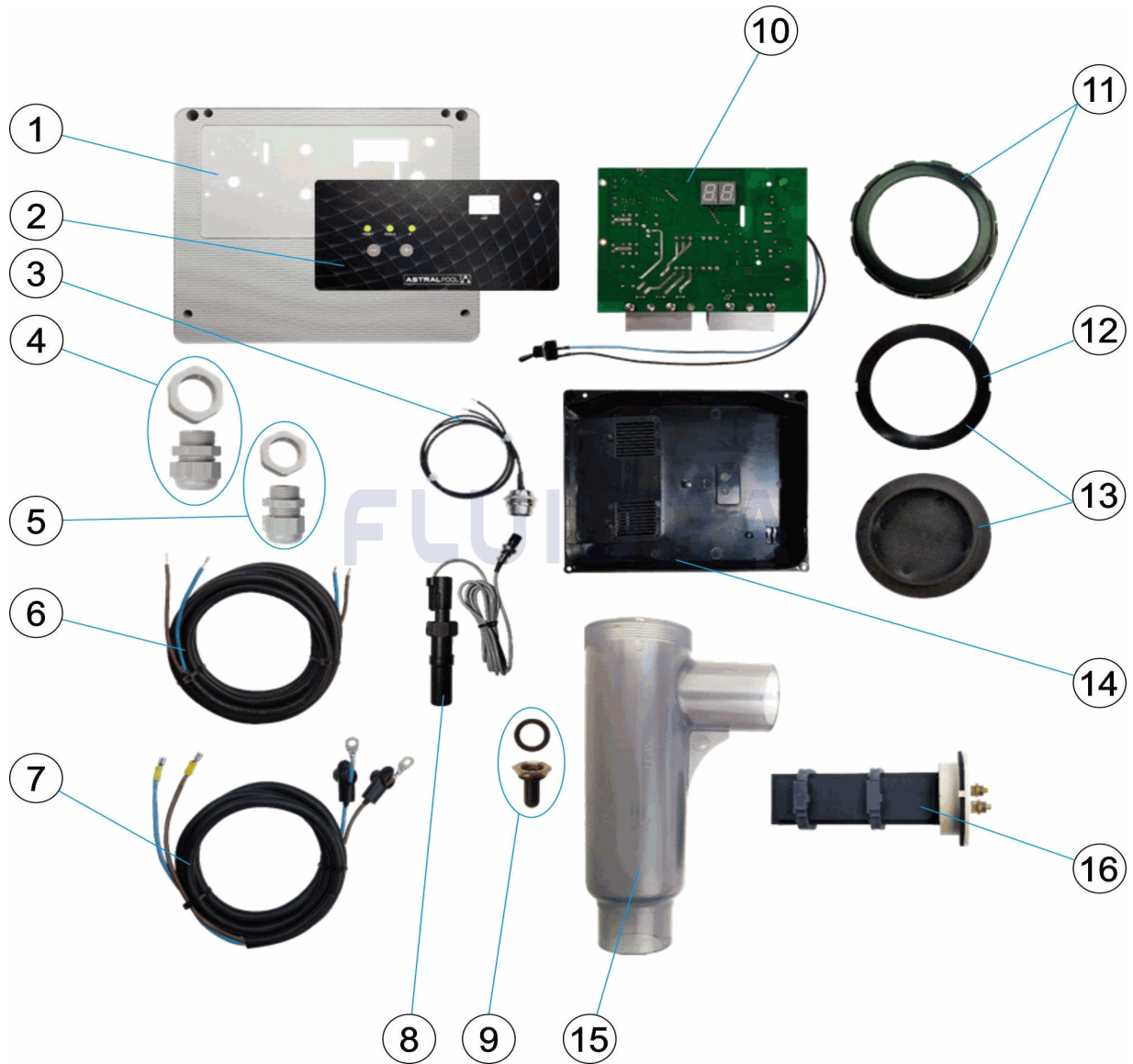

ITALIANO

POS	CODICE	DESCRIZIONE	QUANTITA'	POS	CODICE	DESCRIZIONE	QUANTITA'
1	4408060153	SCATOLA ENERGY SEL		10	4408060154	CIRCUITO ELETTRONICO ENERGY SEL	
2	4408060155	COPERCHIO ENERGY SEL		11	4408060105	GHIERA D.92 ELETTRODO + GUARNIZIONE	
3	4408040410	CONNETTORE FLUSSOSTATO		12	4408060106	GUARNIZIONE ELETTRODO	
4	4408060051	GRUPPO PREMISTOPPA PG16		13	4408060122	TAPPO NERO GRANDE ELETTRODO + GUA	
5	4408060050	GRUPPO PREMISTOPPA PG11		14	4408040411	CARCASSA POSTERIORE	
6	4408040040	CAVO DI ALIMENTAZIONE 2X1,5MM2 2.1M		15	4408060201	PORTAELETTODI SEL	
7	4408060002	CAVO ELETTRODO		16	* 54051	ELETTRODO SEL 30 - 7 PLACHE	
8	4408060108	FLUSOSTATO COMPLETO		16	* 54052	ELETTRODO SEL 55 - 7 PLACHE	
9	4408060049	CAPPUCCIO DI INTERRUETTORE		16	* 54053	ELETTRODO SEL 95 - 7 PLACHE	

CODICE **71650, 71651, 71652**

DESCRIZIONE: **ENERGY SEL**

OSSERVAZIONI

POS	CODICE	OSSERVAZIONI
16	* 54051	PER: 71650
16	* 54052	PER: 71651
16	* 54053	PER: 71652

CODE 71650, 71651, 71652

BESCHREIBUNG: ENERGY SEL

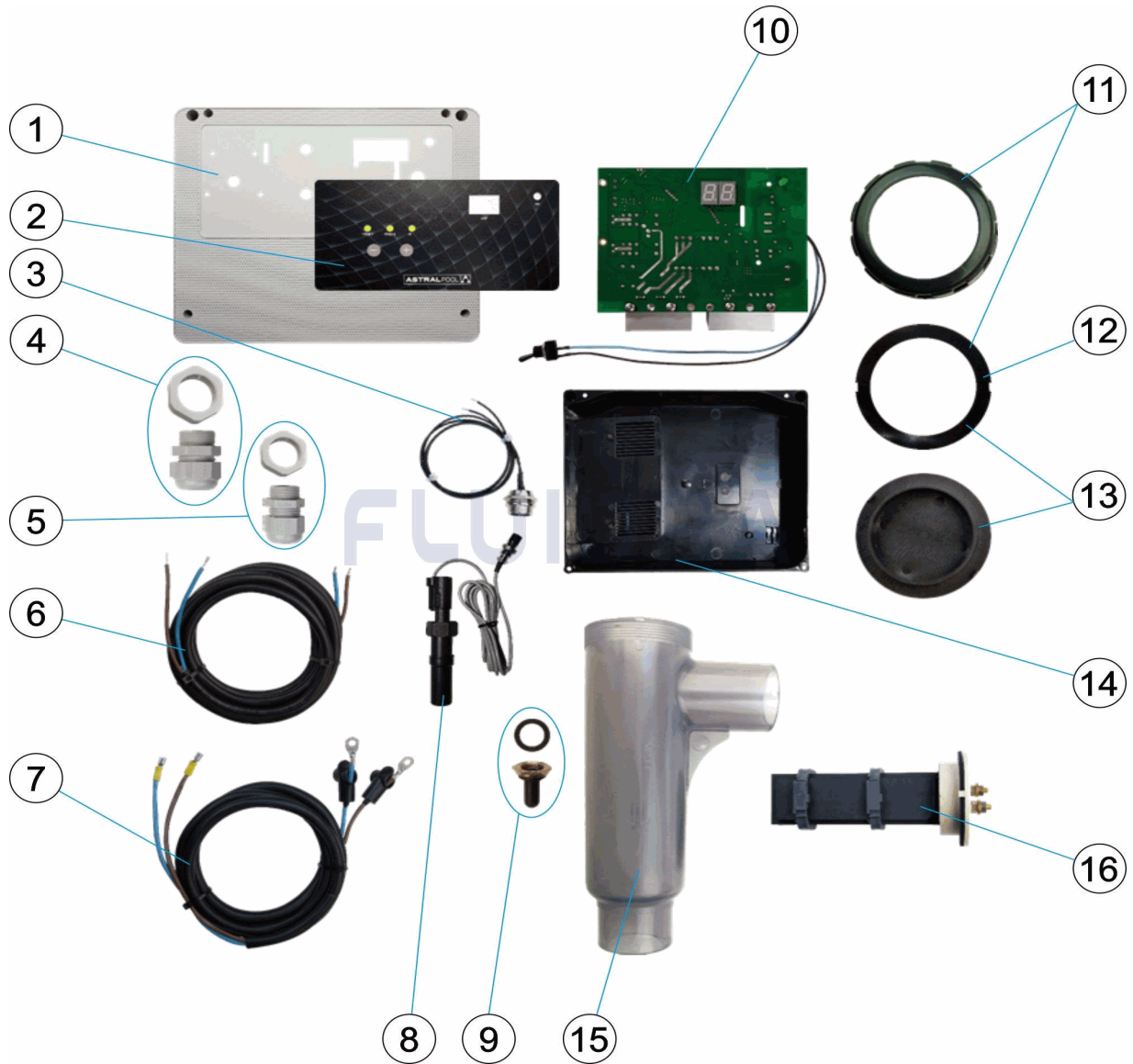

DEUTSCH

POS	CODE	BESCHREIBUNG	MENGE	POS	CODE	BESCHREIBUNG	MENGE
1	4408060153	GEHÄUSE ENERGY SEL		10	4408060154	PLATINE SCHALTKREIS ENERGY SEL	
2	4408060155	BEDIENFELD ENERGY SEL		11	4408060105	MÜTTER D. 92 ELEKTRODE SEL UND DICHT	
3	4408040410	STECKKUPPLUNG DURCHFLUSSMESSER		12	4408060106	FLACHDICHTUNG ELEKTRODE SEL	
4	4408060051	SET QUETSCHVERSCHRAUBUNG PG16		13	4408060122	STOPFEN GROSS GEHÄUSE UND DICHTUN	
5	4408060050	SET QUETSCHVERSCHRAUBUNG PG11		14	4408040411	GEHÄUSE HINTEN	
6	4408040040	VERSORGUNGSKABEL 2X1,5MM2 2.1M		15	4408060201	GEHÄUSE SEL KLEIN FÜR BASIC	
7	4408060002	ELEKTRODENKABEL KOMPLETT		16	* 54051	ELEKTRODE SEL 30 - 7 PLATINEN	
8	4408060108	DURCHFLUSSMESSER KOMPLETT		16	* 54052	ELEKTRODE SEL 55 - 7 PLATINEN	
9	4408060049	HAUBE SCHALTER		16	* 54053	ELEKTRODE SEL 95 - 7 PLATINEN	

CODE **71650, 71651, 71652**

BESCHREIBUNG: **ENERGY SEL**

HINWEISE

POS	CODE	HINWEISE
16	* 54051	FÜR: 71650
16	* 54052	FÜR: 71651
16	* 54053	FÜR: 71652

CODIGO 71650, 71651, 71652

DESCRIÇÃO: ENERGY SEL

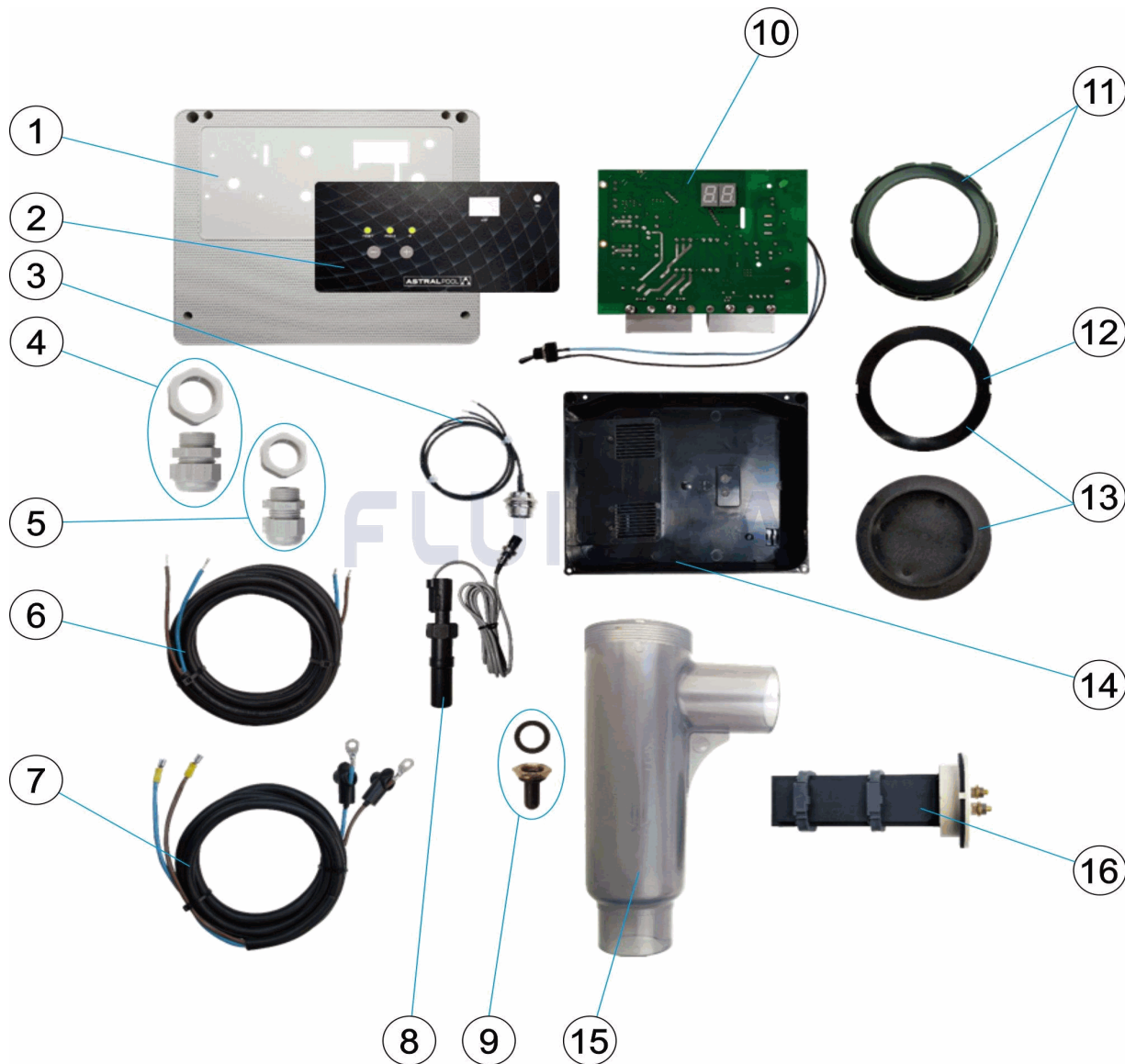

PORTUGUES

POS	CODIGO	DESCRIÇÃO	JANTIDADE	POS	CODIGO	DESCRIÇÃO	JANTIDADE
1	4408060153	CARCAÇA ENERGY SEL		10	4408060154	CIRCUITO ELECTRONICO ENERGY SEL	
2	4408060155	COBERTA ENERGY SEL		11	4408060105	PORCA D. 92 ELÉCTRODO SEL + JUNTA	
3	4408040410	LIGAÇÃO FLUXO-ESTATO		12	4408060106	JUNTA PLANA ELÉCTRODO SEL	
4	4408060051	CJTO. PRENSA-ESTOPAS PG16		13	4408060122	TAMPÃO GRANDE COPO + JUNTA	
5	4408060050	CJTO. PRENSA-ESTOPAS PG11		14	4408040411	CARCAÇA TRASEIRA	
6	4408040040	CABO ALIMENTAÇÃO 2X1,5MM2 2.1M		15	4408060201	COPO PEQUENO PARA BASIC	
7	4408060002	CABO SONDA		16	* 54051	ELÉCTRODO SEL 30 - 7 PLACAS	
8	4408060108	FLUXO-ESTATO COMPLETO		16	* 54052	ELÉCTRODO SEL 55 - 7 PLACAS	
9	4408060049	PROTEÇÃO INTERRUPTOR		16	* 54053	ELÉCTRODO SEL 95 - 7 PLACAS	

CODIGO **71650, 71651, 71652**

DESCRIÇÃO: ENERGY SEL

OBSERVACÕES

POS	CODIGO	OBSERVACÕES
16	* 54051	PARA: 71650
16	* 54052	PARA: 71651
16	* 54053	PARA: 71652