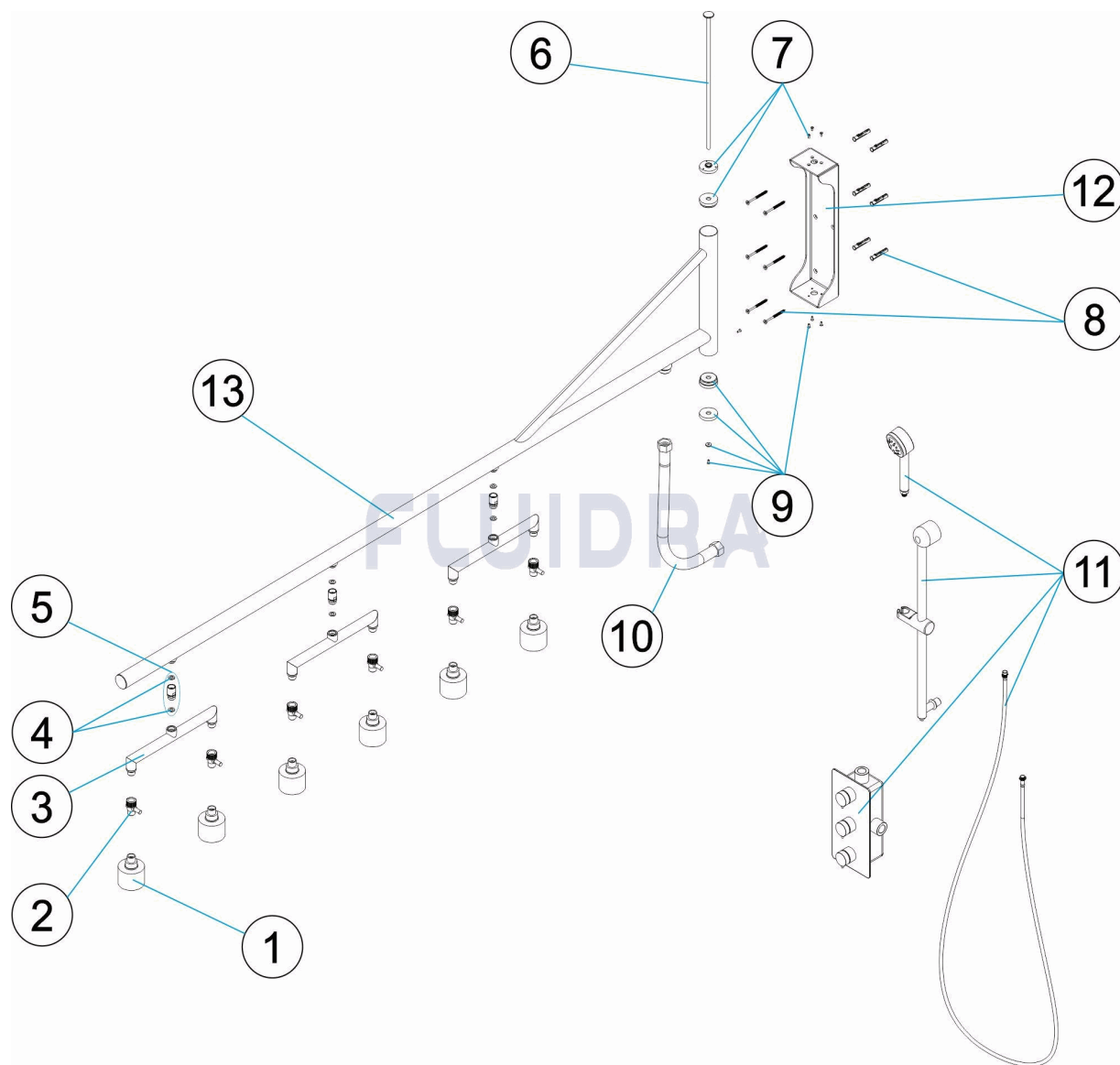

CODIGO **W-028/11**

 DESCRIPCION: **DUCHA VICHY BRAZO GIRATORIO 6 BOQUILLAS CON COMPLEMENTO DU**

**ESPAÑOL**

POS	CODIGO	DESCRIPCION	CANTIDAD	POS	CODIGO	DESCRIPCION	CANTIDAD
1	4401040007	ROCIADOR		8	4401040012	CJTO. FIJACION	
2	4401040008	VALVULA DE PASO 1/2" M-1/2" H "		9	4401040005	CJTO TAPA NYLON INFERIOR	
3	4401040009	TUBO GIRATORIO		10	4401040006	LATIGUILLO 1" H-H L=600"	
4	4401040011	JUNTA PLANA		11	4401040311	CJTO. DUCHA + TERMOSTATO	
5	4401040010	CJTO. ROTULA CROMADA 1/2" M-H "		12	46025R0300	CJTO PARED SOLDADO	
6	4401040003	BARRA EJE		13	W-028/11R0200	BRAZO DUCHA	
7	4401040004	CJTO TAPA NYLON SUPERIOR					

CODE **W-028/11**

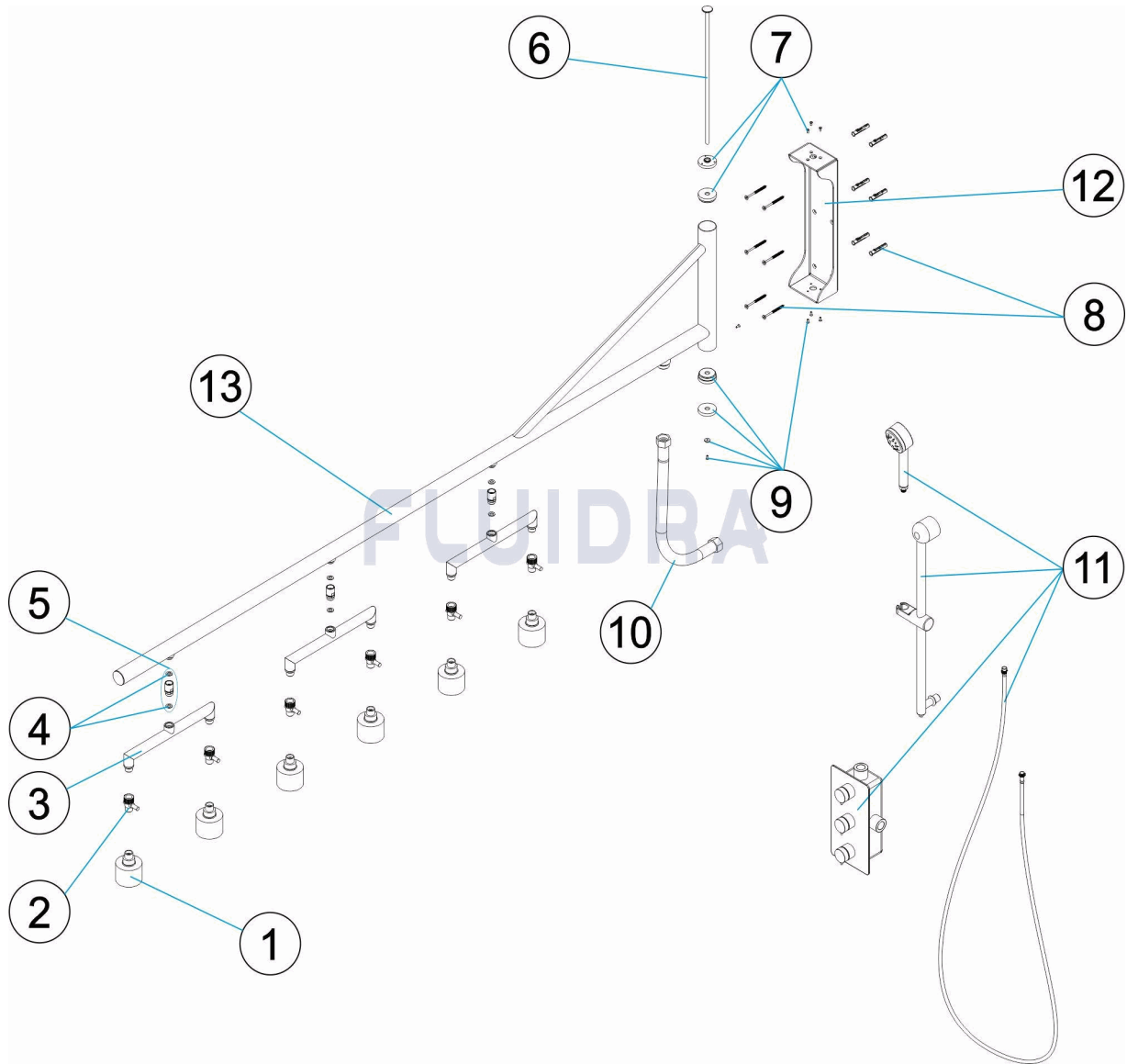
DESCRIPTION: **DOUCHE VICHY BRAS GIRATOIRE 6 JETS AVEC COMPLÉMENT DE DOUC**



**FRANCAIS**

POS	CODE	DESCRIPTION	QUANTITE	POS	CODE	DESCRIPTION	QUANTITE
1	440104007	POMME DE DOUCHE		8	4401040012	ENSEMBLE FIXATION	
2	440104008	VANNE DE RÉGLAGE 1/2" M-1/2" H "		9	4401040005	ENSEMBLE BOUCHON NYLON INFÉRIEUR	
3	440104009	TUBE GIRATOIRE		10	4401040006	TUYAU 1" H-H L=600"	
4	440104011	JOINT PLAT		11	4401040311	ENSEMBLE DOUCHE + THERMOSTAT	
5	440104010	ENSEMBLE ARTICULATION CHROMÉE 1/2"		12	46025R0300	ENSEMBLE MUR SOUDÉ	
6	440104003	BARRE AXE		13	W-028/11R0200	BRAS DOUCHE	
7	440104004	ENSEMBLE BOUCHON NYLON SUPÉRIEUR					

# PARTS BREAKDOWN

REV.: 1  
DATE: 17/03/2022  
SHEET: 3/6

1424

CODE **W-028/11**

DESCRIPTION: **VICHY ROTATING SHOWER ARM 6 NOZZLES WITH COMPLEMENT OF SHO**

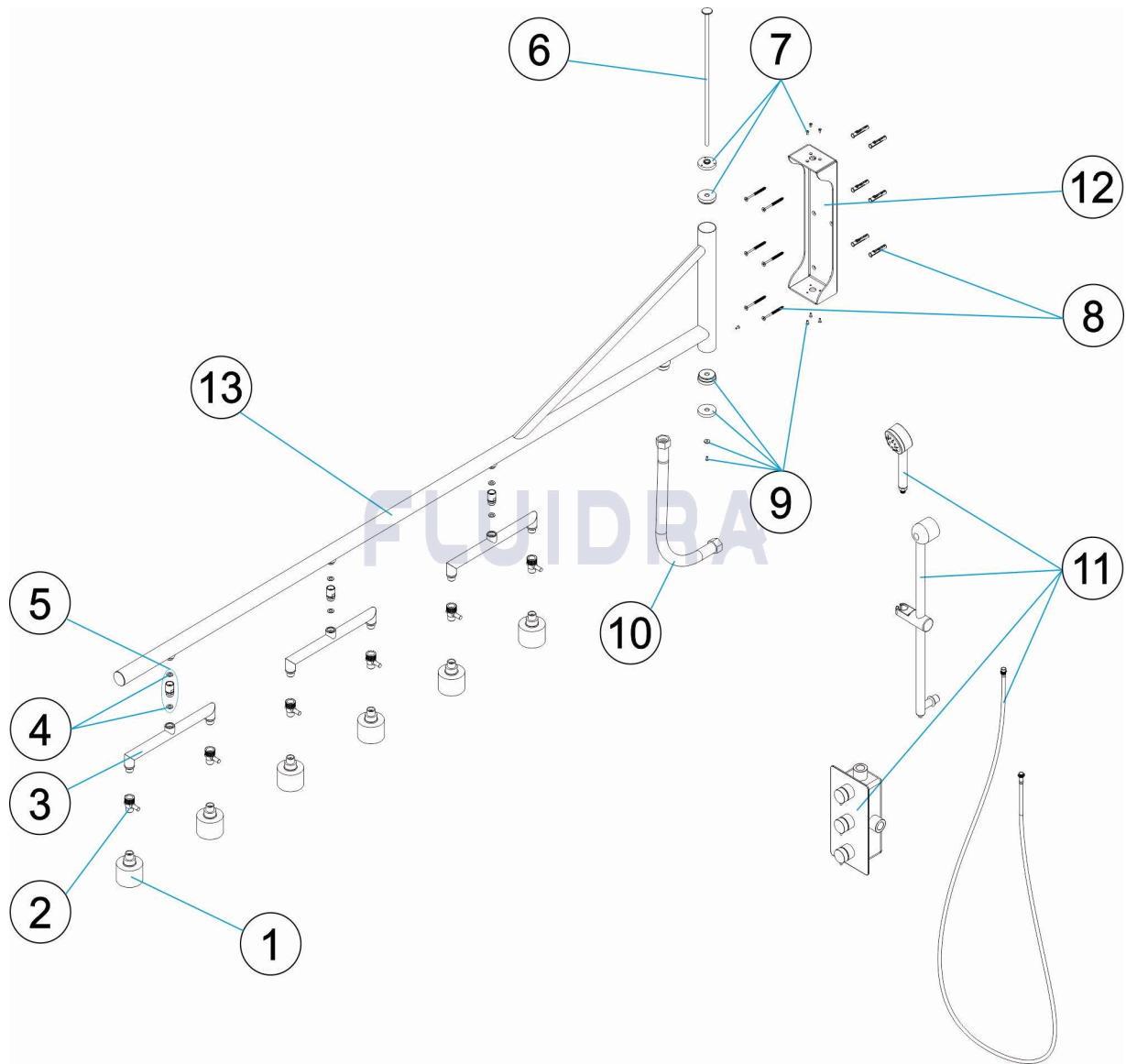

**ENGLISH**

POS	CODE	DESCRIPTION	QUANTITY	POS	CODE	DESCRIPTION	QUANTITY
1	4401040007	SPRINKLER		8	4401040012	FASTENING SET	
2	4401040008	FLOW VALVE 1/2" M-1/2" M-H "		9	4401040005	LOWER NYLON COVER SET	
3	4401040009	REVOLVING TUBE		10	4401040006	HOSE 1" H-H L=600"	
4	4401040011	FLAT GASKET		11	4401040311	SHOWER + THERMOSTAT SET	
5	4401040010	CHROME - PLATED JOINT SET 1/2" M-H "		12	46025R0300	WALL WELD SET	
6	4401040003	AXLE BAR		13	W-028/11R0200	SHOWER ARM	
7	4401040004	UPPER NYLON COVER SET					

CODICE **W-028/11**

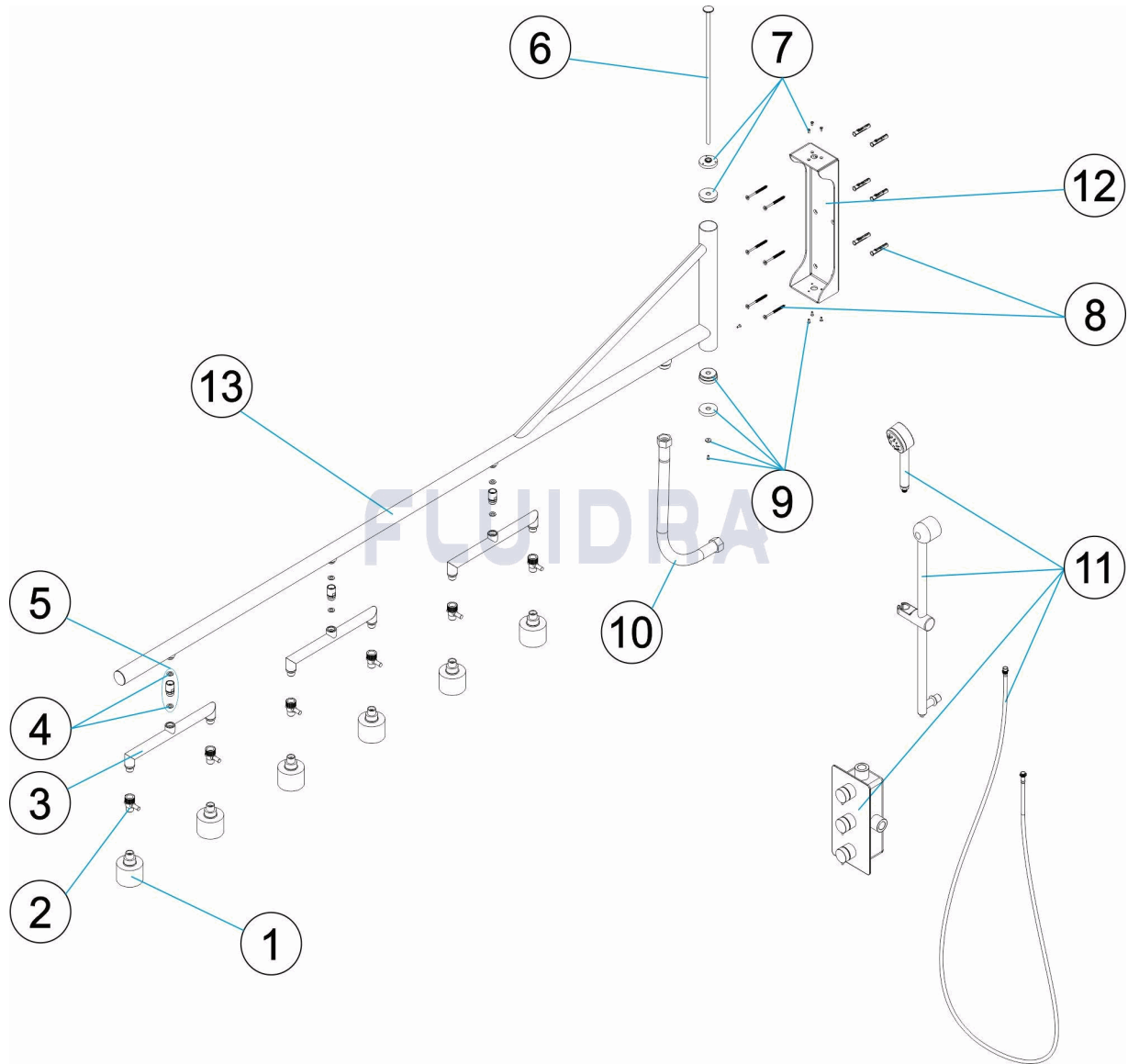
 DESCRIZIONE: **DOCCIA VICHY BRACCIO GIRATORIO 6 BOCCHETTONI COMPLETO DI D**

**ITALIANO**

POS	CODICE	DESCRIZIONE	QUANTITA'	POS	CODICE	DESCRIZIONE	QUANTITA'
1	4401040007	SPRUZZATORE		8	4401040012	CONGIUNTO FISSAGGIO	
2	4401040008	VALVOLA DI PASSO 1/2" M-1/2" H "		9	4401040005	COMPLESSO TAPPO NYLON INFERIORE	
3	4401040009	TUBO GIREVOLE		10	4401040006	SPINOTTO 1" H-H L=600"	
4	4401040011	GIUNTURA PIANA		11	4401040311	CONGIUNTO DOCCIA + TERMOSTATO	
5	4401040010	COMPLESSO CON SNODO CROMATO 1/2"		12	46025R0300	CONGIUNTO PARETE SALDATO	
6	4401040003	BARRA ASSE		13	W-028/11R0200	BRACCIO DOCCIA	
7	4401040004	COMPLESSO TAPPO NYLON SUPERIORE					

# EINZELTEILE

ÜBER.: 1

1424

DATUM: 17/03/2022

BLATT: 5/6

CODE

W-028/11

BESCHREIBUNG: DUSCHE VICHY DREHARM 6 DÜSEN MIT ERGÄNZUNG VON DUSCHE U

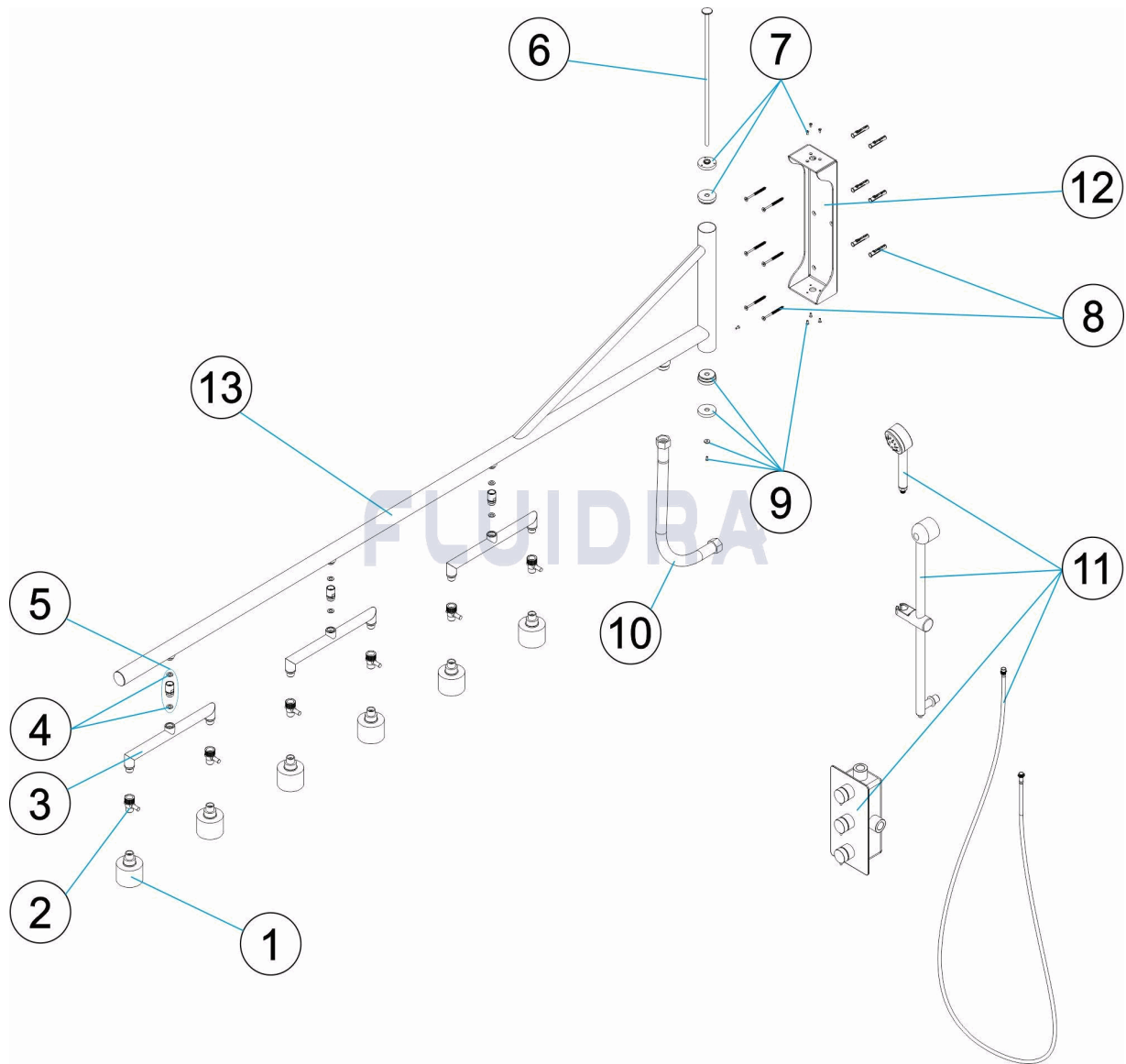

## DEUTSCH

POS	CODE	BESCHREIBUNG	MENGE	POS	CODE	BESCHREIBUNG	MENGE
1	4401040007	DUSCHKOPF		8	4401040012	FIXIERSET	
2	4401040008	SCHRITTVENTIL 1/2" M 1/2" H "		9	4401040005	SET ABDECKUNG NYLON UNTEN	
3	4401040009	ROHR SCHWENKBAR		10	4401040006	SCHLAUCHLEITUNG 1" MUFFE - MUFFE L=	
4	4401040011	FLACHDICHTUNG		11	4401040311	SET DUSCH + TERMOSTAT	
5	4401040010	SET ROTIERTEIL VERCHROMT 1/2" MUFFE		12	46025R0300	SET WAND GESCHWEISST	
6	4401040003	STANGE ACHSE		13	W-028/11R0200	DUSCHARM	
7	4401040004	SET ABDECKUNG NYLON OBEN					

CODIGO W-028/11

DESCRIÇÃO: DUCHE VICHY BRAÇO GIRATÓRIO 6 BOQUILHAS COM COMPLEMENTO DE

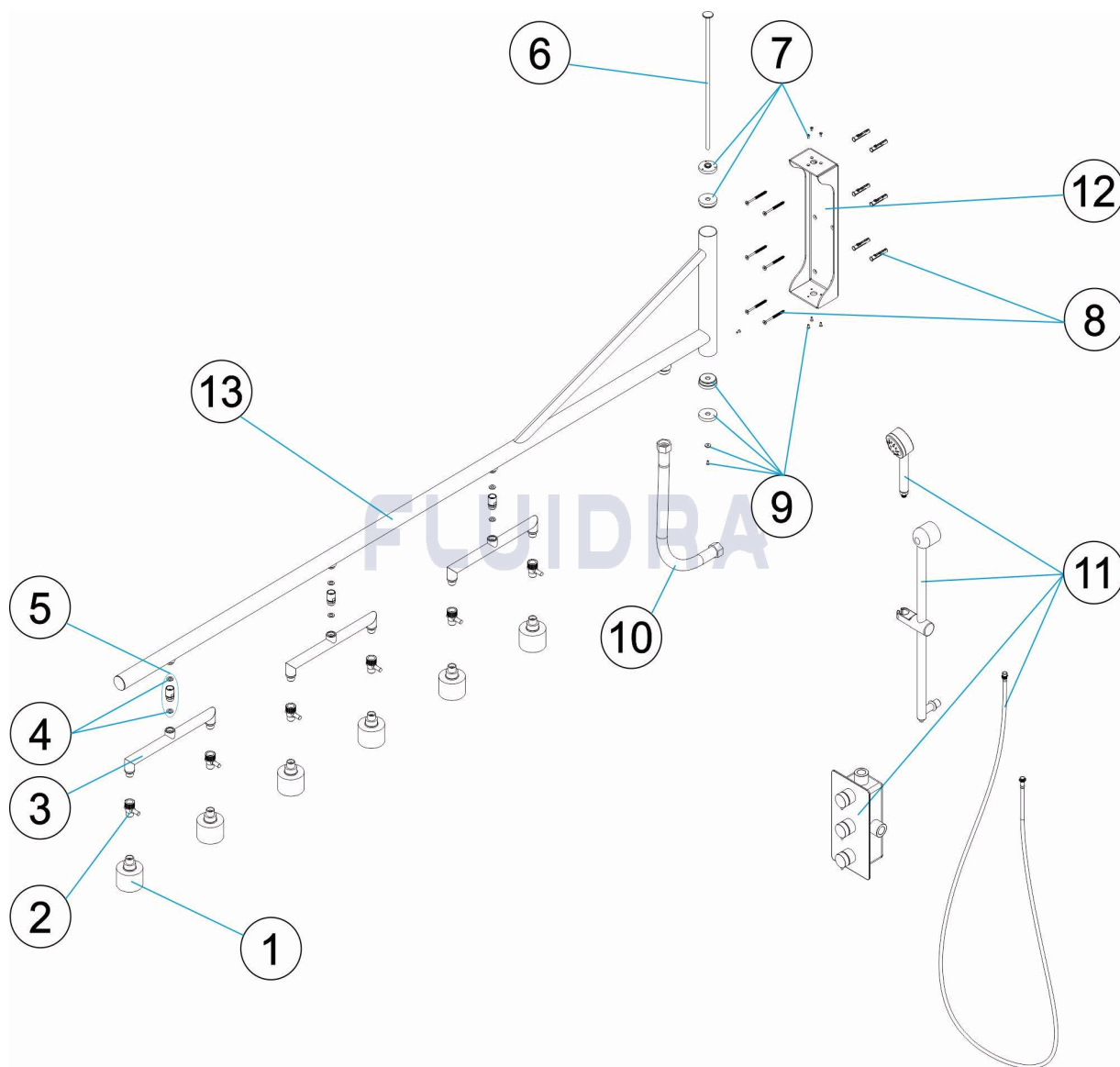

PORTUGUES

POS	CODIGO	DESCRIÇÃO	JANTIDADE	POS	CODIGO	DESCRIÇÃO	JANTIDADE
1	4401040007	DIFUSOR		8	4401040012	CJTO. FIXAÇÃO	
2	4401040008	VÁLVULA DE REGULAÇÃO 1/2" M-1/2" H "		9	4401040005	CJTO. TAMPA NYLON INFERIOR	
3	4401040009	TUBO GIRATÓRIO		10	4401040006	MANGA 1" H-H L = 600"	
4	4401040011	BUCHA BORRACHA		11	4401040311	CJTO. DUCHE + TERMOSTATO	
5	4401040010	CJTO. RÓTULA CROMADA 1/2" M-H "		12	46025R0300	CJTO. PAREDE SOLDADO	
6	4401040003	BARRA EIXO		13	W-028/11R0200	BRAÇO DUCHE	
7	4401040004	CJTO. TAMPA NYLON SUPERIOR					