

CODIGO **15387**

DESCRIPCION: **VALVULA SELECTORA 2"**

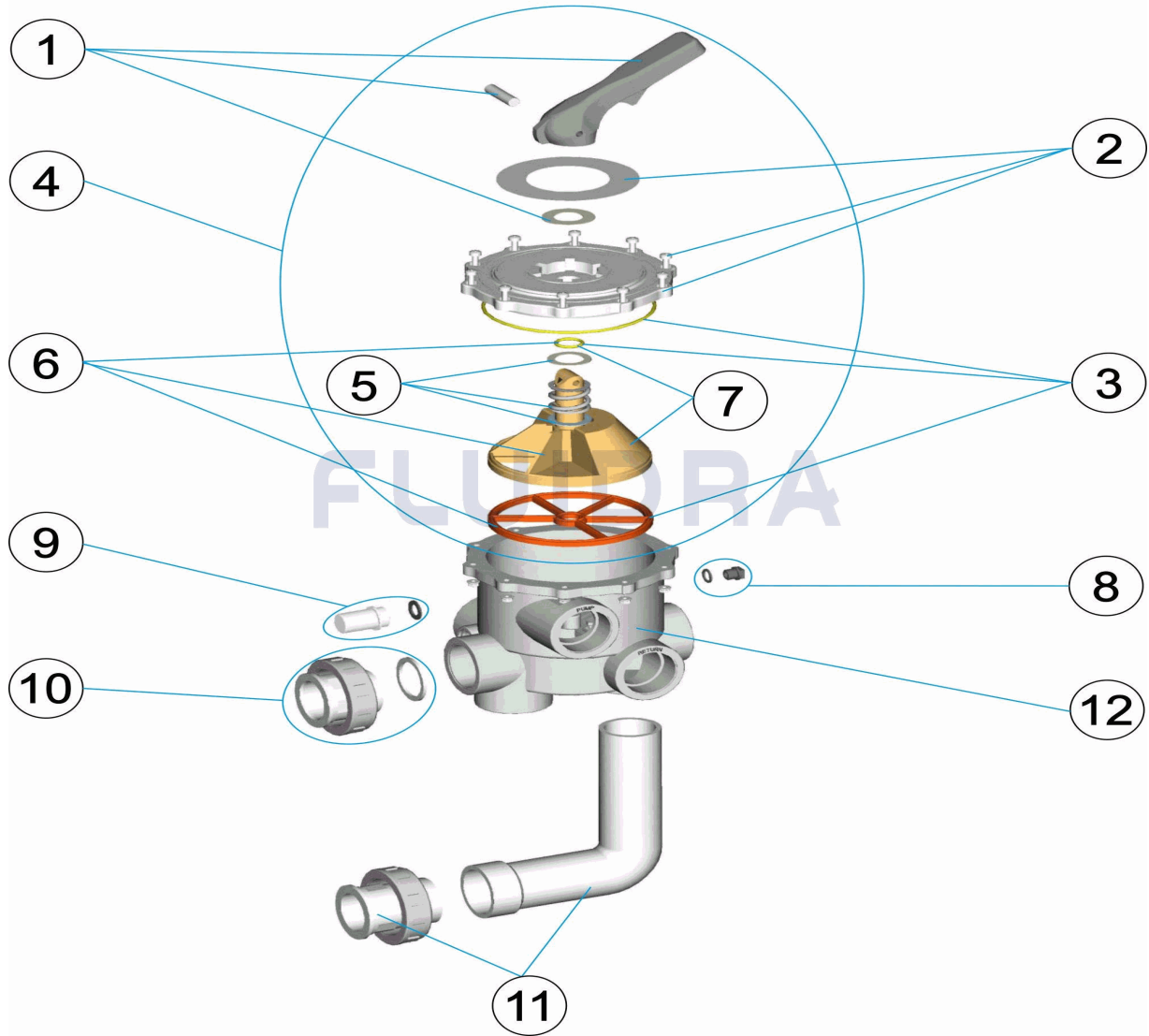

ESPAÑOL

POS	CODIGO	DESCRIPCION	CANTIDAD	POS	CODIGO	DESCRIPCION	CANTIDAD
1	4404123101	MANETA 2" MNB BLANCA NEUTR "	7	4404122710	DISTRIBUIDOR CON JUNTAS 2"		
2	4404123102	TAPA VALVULA S. 2" MNB BLANC "	8	4401043621	CJTO. TAPON PURGA		
3	4404120407	JUNTAS VALVULA 2'	9	4404120108	VISOR CON JUNTA		
4	4404123103	CJTO. SUPERIOR 2" MNB BLANCA NEUTR	10	4404120501	ENLACE RECTO BLANCO 2' NUEVO		
5	4404121103	RESORTE VALVULA	11	4404120503	ENLACE ACODADO BLANCO 2' NUEVO		
6	4404120406	DISTRIBUIDOR CON JUNTAS 2' NUEVO	12	11156R0101	CUERPO BLANCO 2"		

CODE 15387

DESCRIPTION: SÉLECTEUR 2"

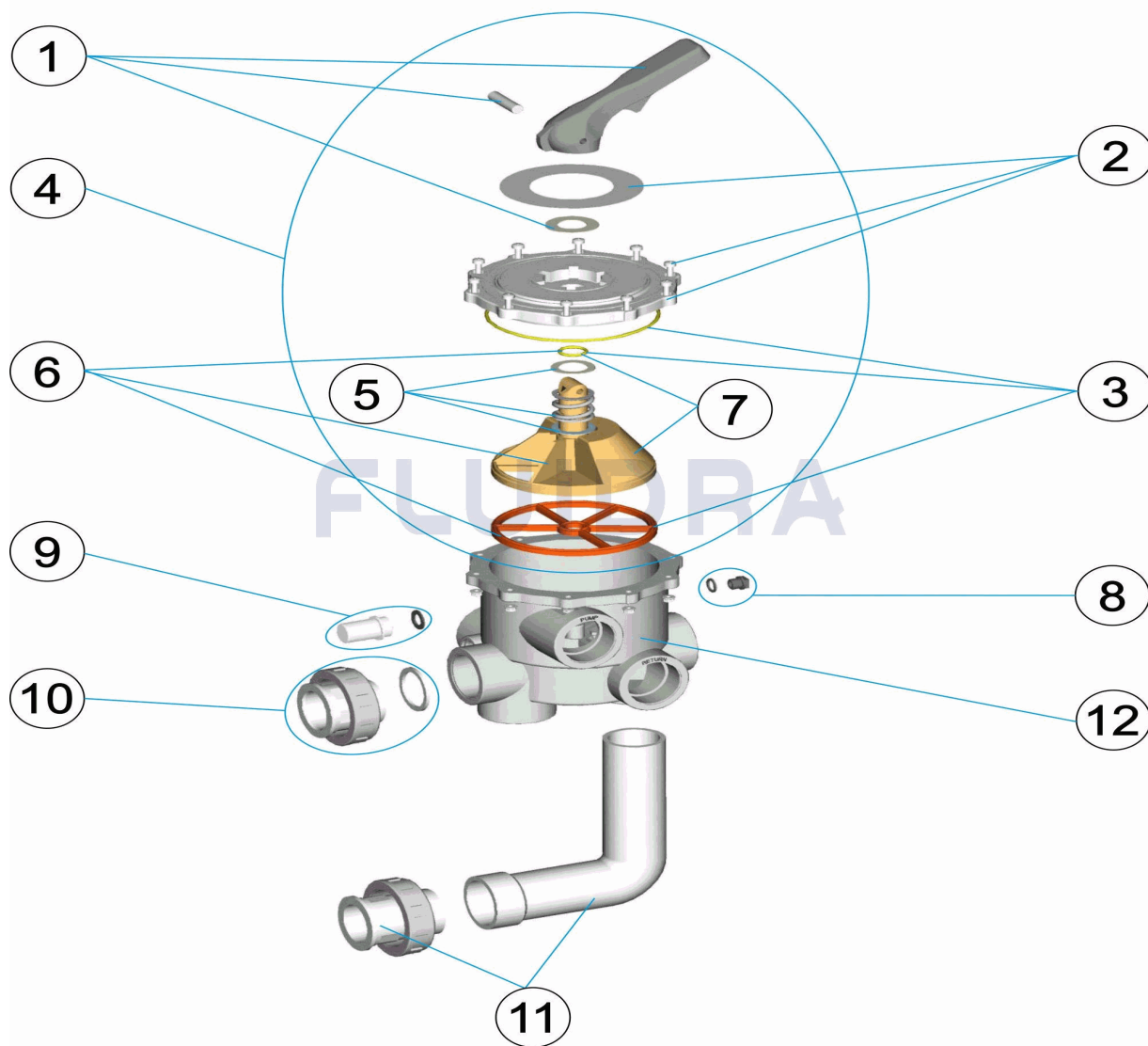

FRANCAIS

POS	CODE	DESCRIPTION	QUANTITE	POS	CODE	DESCRIPTION	QUANTITE
1	4404123101	POIGNEE BLANCHE 2"		7	4404122710	BOISSEAU AVEC JOINTS 2"	
2	4404123102	DESSUS DE VANNE 2"		8	4401043621	ENSEMBLE BOUCHON PURGE	
3	4404120407	JOINTS DE VANNE 2"		9	4404120108	VOYANT ET JOINT	
4	4404123103	ENSEMBLE SUPERIEUR 2" MN "		10	4404120501	SORTIE DROITE BLANCHE 2" NOUVEAU MC	
5	4404121103	RESSORT DE VANNE		11	4404120503	SORTIE COUDEE BLANCHE 2" NOUVEAU M	
6	4404120406	BOISSEAU AVEC JOINTS 2"		12	11156R0101	CORPS BLANC 2"	

CODE 15387

DESCRIPTION: MULTIPORT VALVE 2"

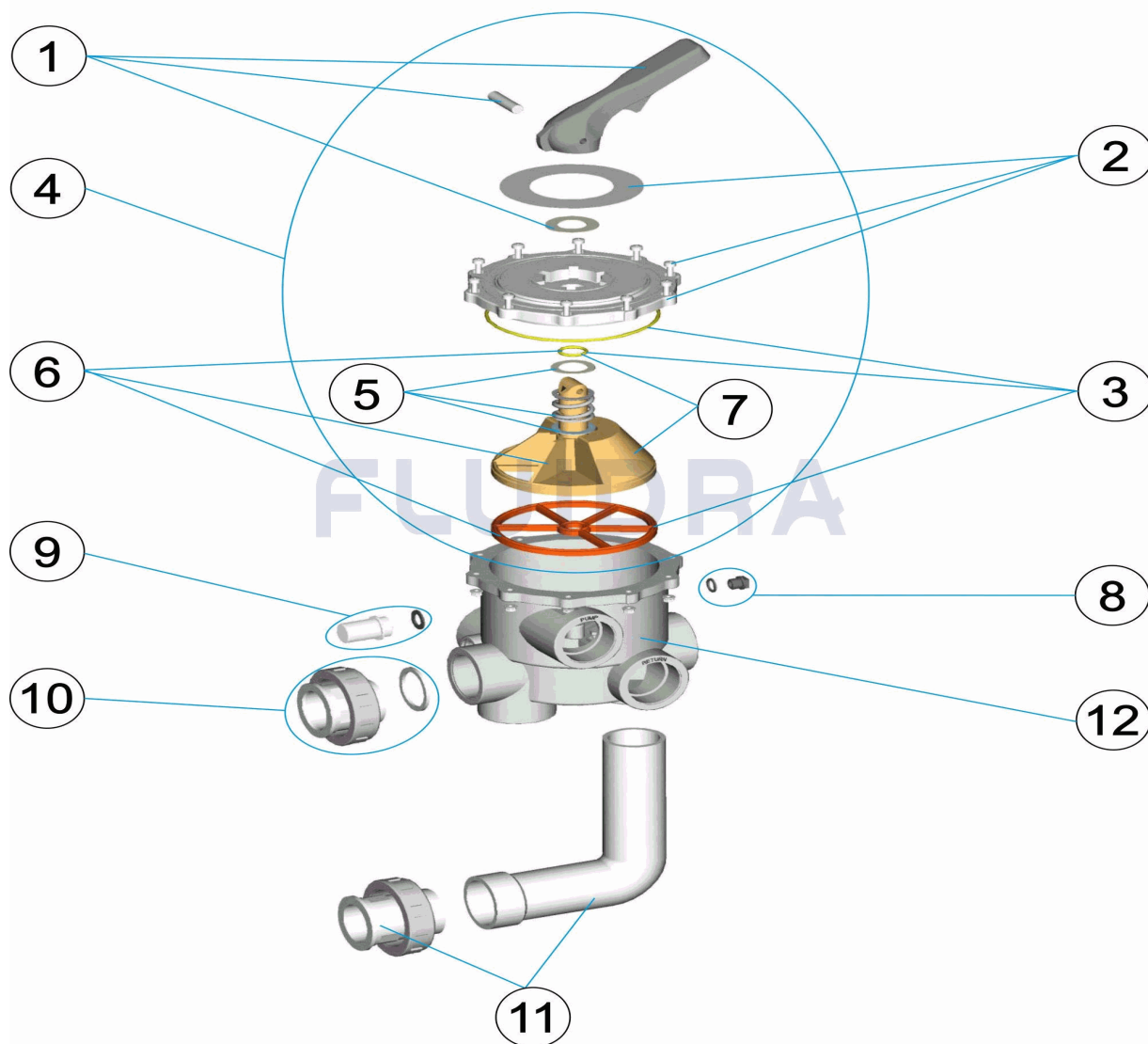

ENGLISH

POS	CODE	DESCRIPTION	QUANTITY	POS	CODE	DESCRIPTION	QUANTITY
1	4404123101	WHITE HANDLE 2"		7	4404122710	DISTRIBUTOR WITH GASKETS 2"	
2	4404123102	COVERS SELECTOR VALVE 2		8	4401043621	DRAIN CAP SET	
3	4404120407	GASKETS 2"		9	4404120108	VISOR WITH SEAL	
4	4404123103	SET. SUPERIOR 2 " MN "		10	4404120501	UNION WHITE 2' NEW	
5	4404121103	SPRING		11	4404120503	ELBOW WHITE 2' NEW	
6	4404120406	DISTRIBUTOR WITH GASKETS 2' NEW		12	11156R0101	WHITE SELECTOR VALVE BODY 2"	

CODICE 15387

DESCRIZIONE: VALVOLA SELETRICE 2"

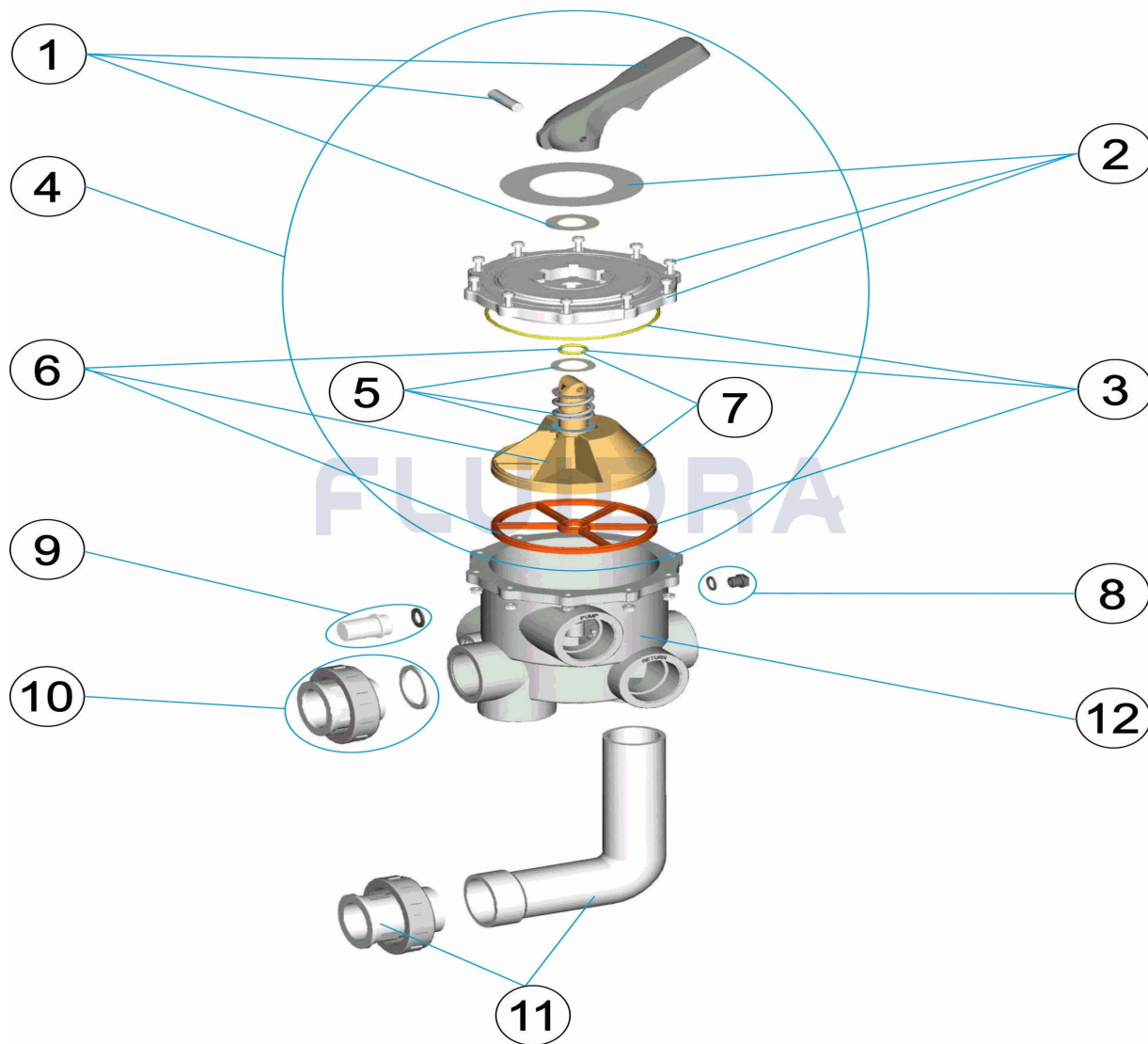

ITALIANO

POS	CODICE	DESCRIZIONE	QUANTITA'	POS	CODICE	DESCRIZIONE	QUANTITA'
1	4404123101	MANIGLIA BIANCA 2"		7	4404122710	DISTRIBUTORE CON GUARNIZIONI 2"	
2	4404123102	COPERCHIO VALVOLA 2"		8	4401043621	CONGIUNTO COPERCHIO SPURGO	
3	4404120407	GUARNIZIONI VALVOLA 2"		9	4404120108	VISORE CON GUARNIZIONE	
4	4404123103	KIT PARTE SUPERIORE SELETRICE 2" M		10	4404120501	GUARNIZIONE PER RACCORDO 2" BIANC'	
5	4404121103	MOLLA VALVOLA		11	4404120503	RACCORDO A GOMITO BIANCO 2' NUOVO	
6	4404120406	DISTRIBUTORE CON GUARNIZIONI 2" NUC		12	11156R0101	CORPO BIANCO 2"	

CODE 15387

BESCHREIBUNG: MEHRWEGVENTIL 2"

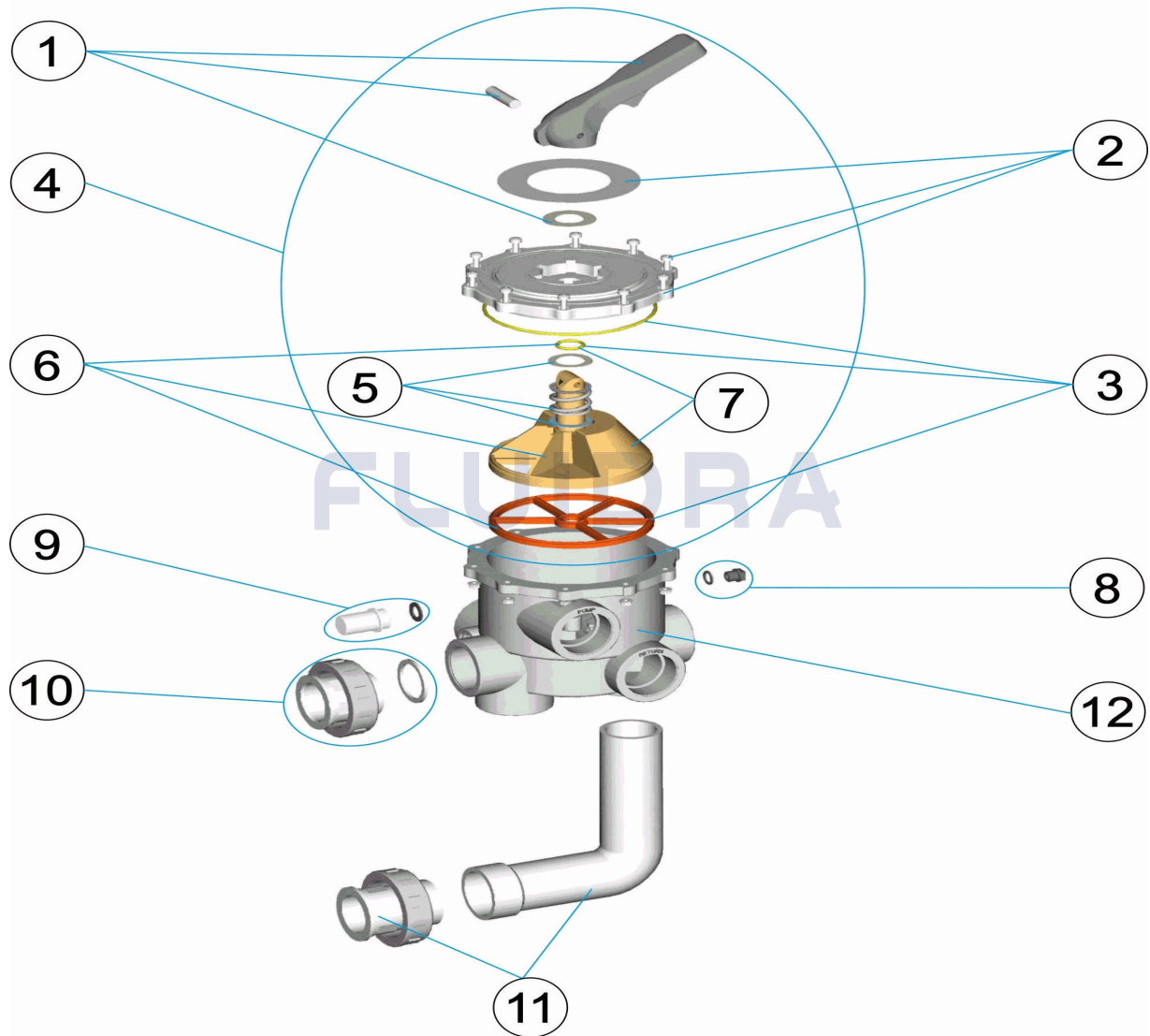

DEUTSCH

POS	CODE	BESCHREIBUNG	MENGE	POS	CODE	BESCHREIBUNG	MENGE
1	4404123101	GRIFF 2" MNB WEISS NEUTRA "		7	4404122710	VERTEILER UND DICHTUNGEN 2"	
2	4404123102	VENTILABDECKUNG S. 2" MNB WEIS "		8	4401043621	SET ABLASSSTOPFEN	
3	4404120407	VENTILDICHTUNGEN 2'		9	4404120108	SCHAUGLAS UND DICHTUNG	
4	4404123103	SET OBEN 2" MNB WEISS NEUTRA "		10	4404120501	ANSCHLUSS GERADE WEISS 2' NEUVERSI	
5	4404121103	VENTILFEDER		11	4404120503	ANSCHLUSSWINKEL WEISS 2' NEUVERSIO	
6	4404120406	VERTEILER UND DICHTUNGEN 2' NEUVER		12	11156R0101	GEHÄUSE WEISS 2"	

CODIGO **15387**

DESCRIÇÃO: **VÁLVULA SELECTORA 2"**

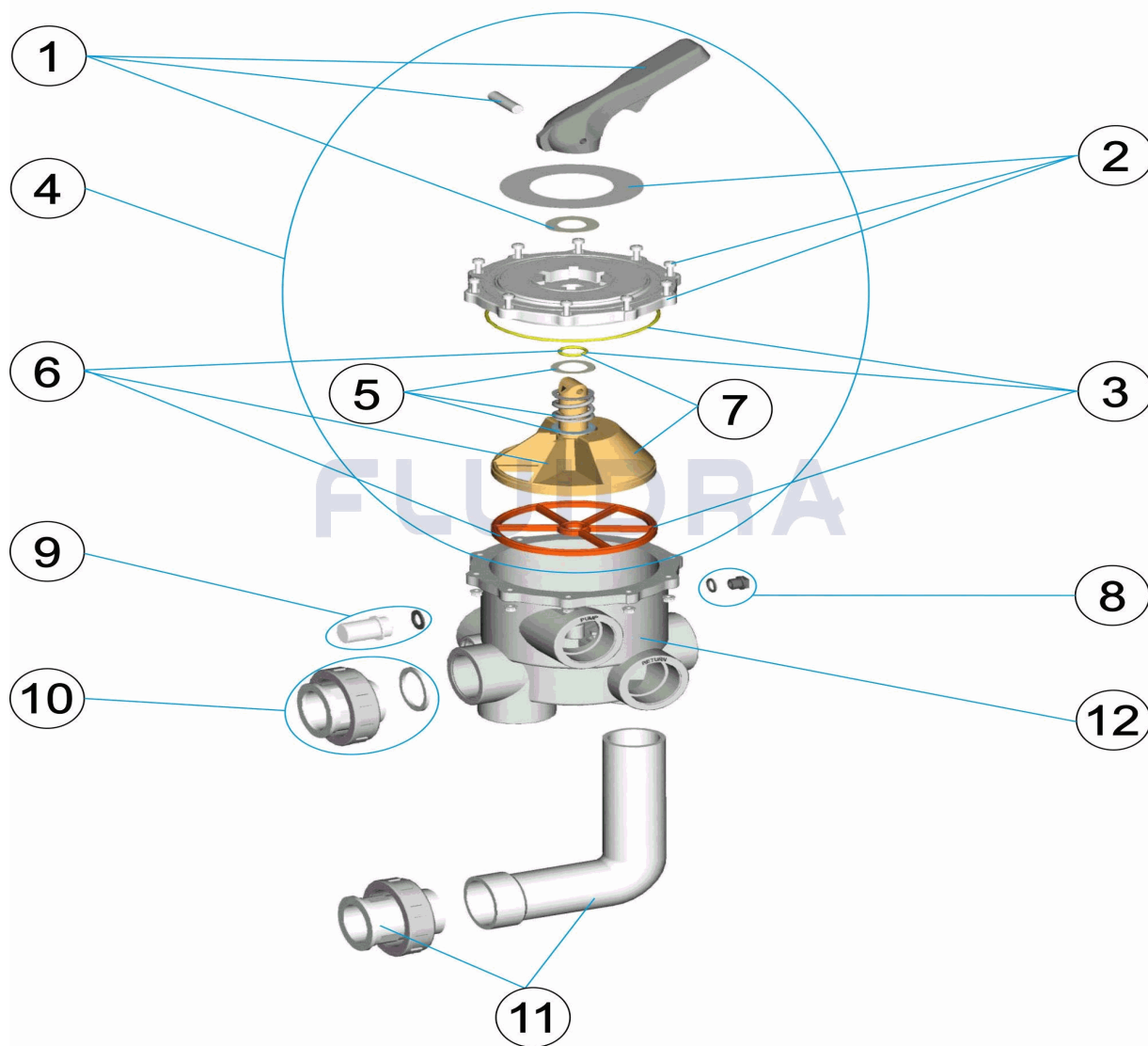

PORTUGUES

POS	CODIGO	DESCRIÇÃO	JANTIDADE	POS	CODIGO	DESCRIÇÃO	JANTIDADE
1	4404123101	MANIPULO BRANCO 2'		7	4404122710	DISTRIBUIDOR COM JUNTAS 2'	
2	4404123102	TAMPA VALVULA 2"		8	4401043621	CJTO. TAMPÃO PURGA	
3	4404120407	JUNTAS VÁLVULA 2"		9	4404120108	VISOR COM JUNTA	
4	4404123103	CONJUNTO SUPERIOR 2" MN "		10	4404120501	LIGAÇÃO RECTA BRANCA 2' NOVA	
5	4404121103	TAMPA PARAFUSOS		11	4404120503	LIGAÇÃO CURVA BRANCA 2' NOVA	
6	4404120406	DISTRIBUIDOR COM JUNTAS 2' NOVO		12	11156R0101	CORPO BRANCO 2"	