

CODIGO **33092**

DESCRIPCION: **BOQUILLA ASPIRACION LINER**

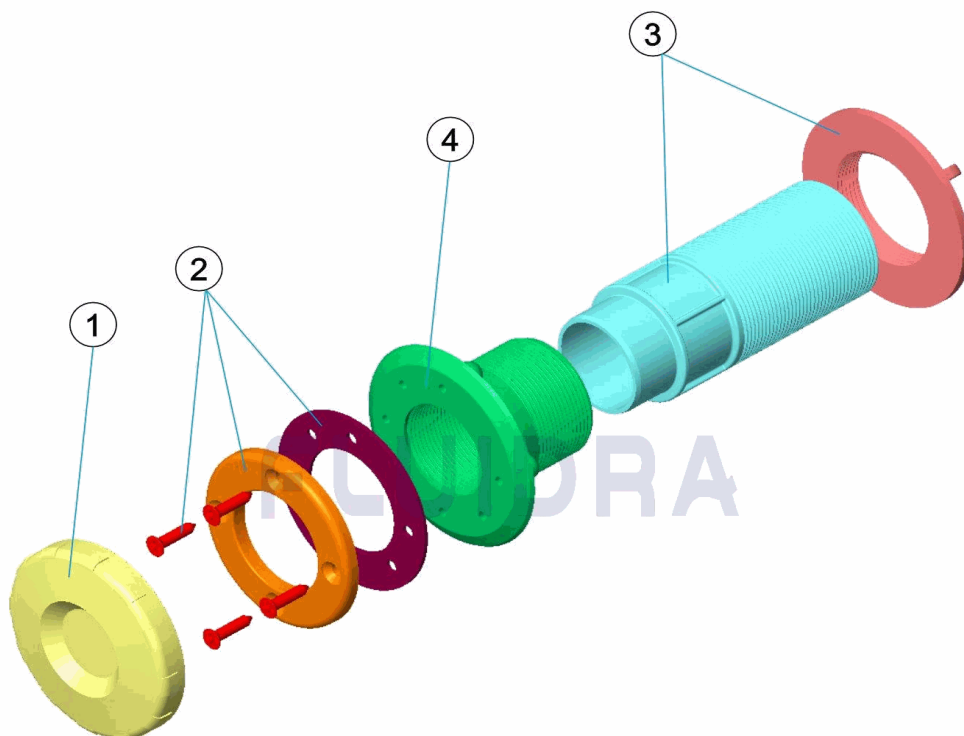

**ESPAÑOL**

POS	CODIGO	DESCRIPCION	CANTIDAD	POS	CODIGO	DESCRIPCION	CANTIDAD
1	4402046803	TAPON BOQUILLA		3	4402040171	TUBO + TUERCA	
2	4402040170	BRIDA BOQUILLA		4	00337R0001	BASE BOQUILLA	

CODE **33092**

DESCRIPTION: **BOUCHE ASPIRATION LINER**

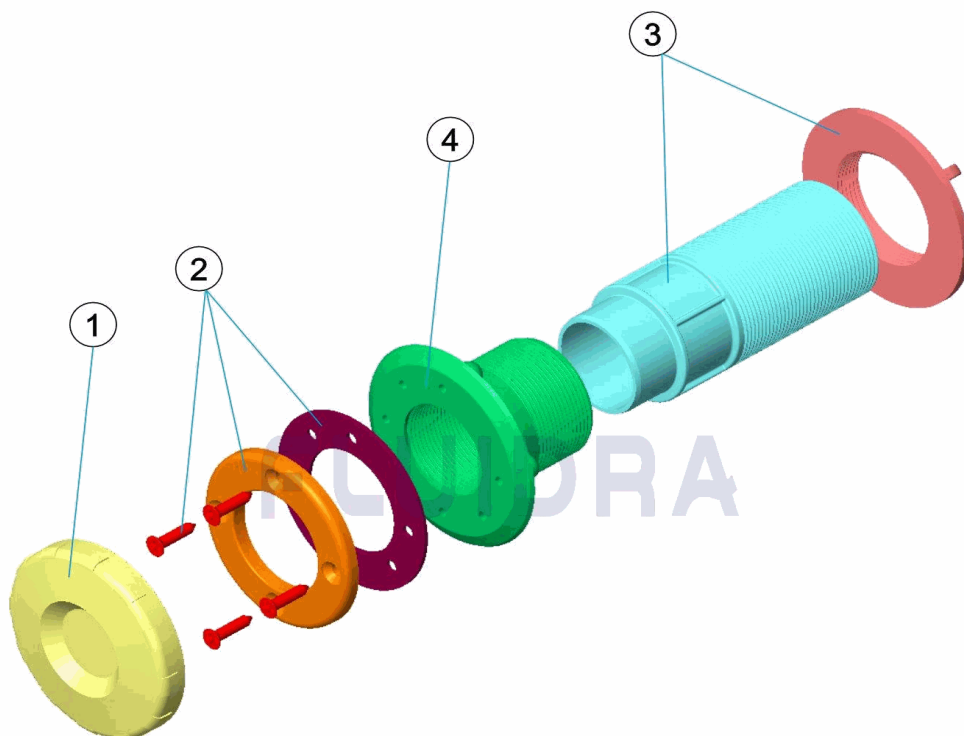

**FRANCAIS**

POS	CODE	DESCRIPTION	QUANTITE	POS	CODE	DESCRIPTION	QUANTITE
1	4402046803	BOUCHON DE BOUCHE		3	4402040171	TUBE + ÉCROU	
2	4402040170	BRIDE DE BOUCHE		4	00337R0001	CORPS DE LA BUSE	

CODE **33092**

DESCRIPTION: **SUCTION NOZZLE LINER**

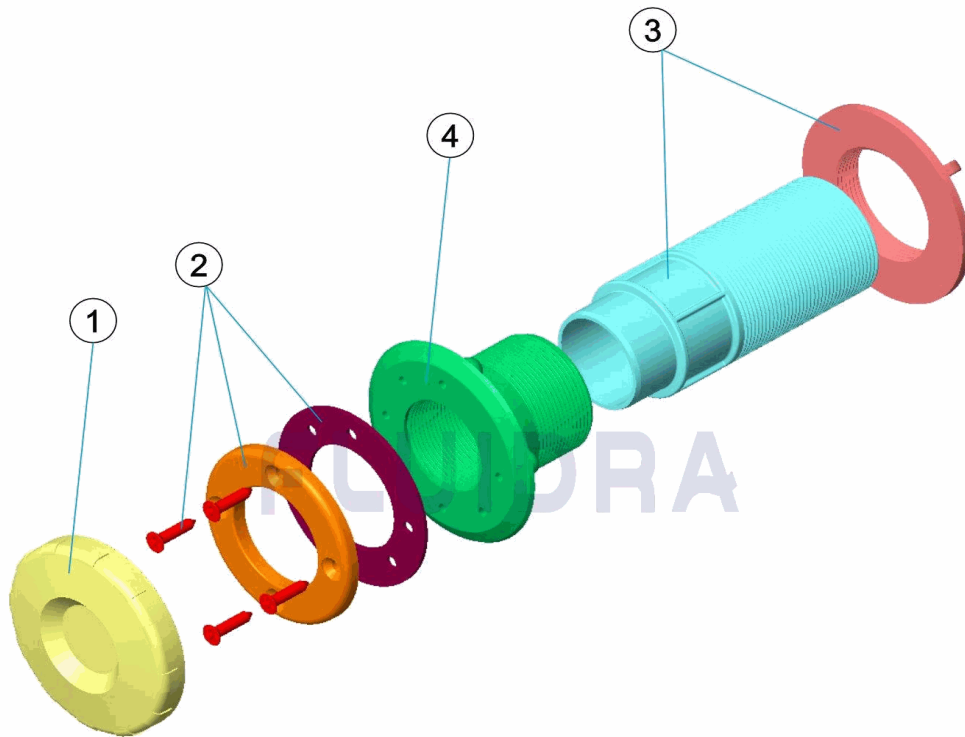

**ENGLISH**

POS	CODE	DESCRIPTION	QUANTITY	POS	CODE	DESCRIPTION	QUANTITY
1	4402046803	INLET CAP		3	4402040171	TUBE + NUT	
2	4402040170	INLET FLANGE		4	00337R0001	BASE BOCCHETTA	

CODICE **33092**

DESCRIZIONE: **BOCCHETTA ASPIRAZIONE LINER**

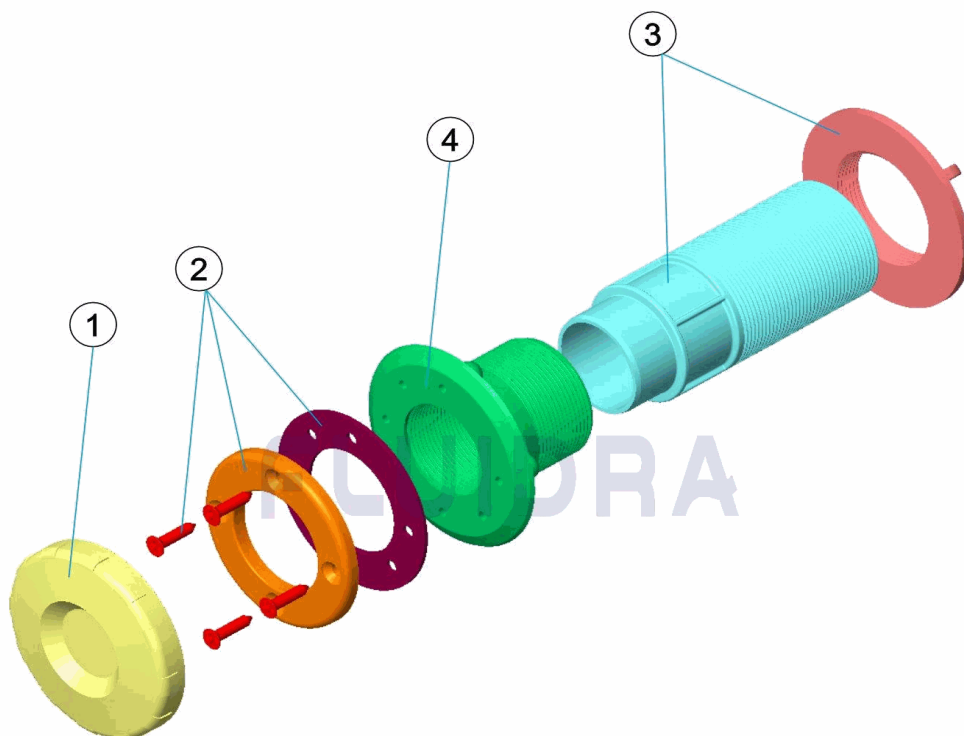

**ITALIANO**

POS	CODICE	DESCRIZIONE	QUANTITA'	POS	CODICE	DESCRIZIONE	QUANTITA'
1	4402046803	COPERCHIO BOCCHETTA		3	4402040171	TUBO + DADO	
2	4402040170	FLANGIA BOCCHETTA		4	00337R0001	BASE BOCCHETTA	

CODE **33092**

BESCHREIBUNG: **ANSAUGDÜSE FOLIE**

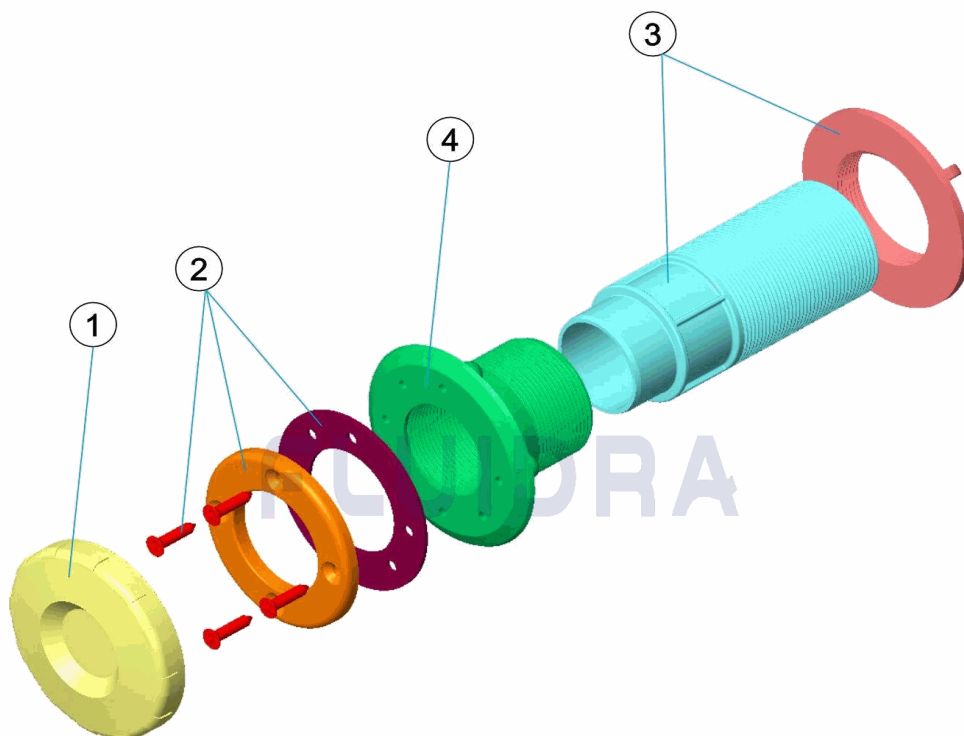

**DEUTSCH**

POS	CODE	BESCHREIBUNG	MENGE	POS	CODE	BESCHREIBUNG	MENGE
1	4402046803	STOPFEN DÜSE		3	4402040171	ROHR + SCHLISSVORRICHTUNG	
2	4402040170	DÜSENFLANSCH		4	00337R0001	DÜSENBASIS	

CODIGO **33092**

DESCRIÇÃO: **BOQUILHA ASPIRAÇÃO LINER**

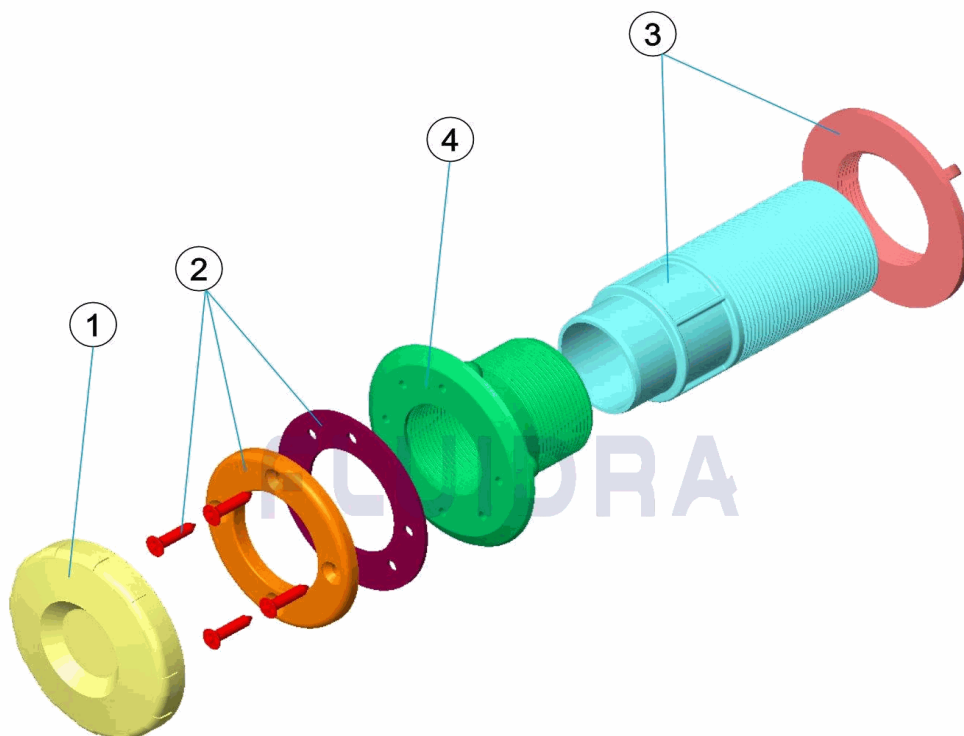

**PORTUGUES**

POS	CODIGO	DESCRIÇÃO	JANTIDADE	POS	CODIGO	DESCRIÇÃO	JANTIDADE
1	4402046803	TAMPÃO BOCA		3	4402040171	TUBO + PORCA	
2	4402040170	FLANGE BOCA		4	00337R0001	BASE BOCA	