

CODIGO **06664, 06665**

DESCRIPCION: **MANGO ALUMINIO TELESCOPICO 3,6 - 4,8 M.**

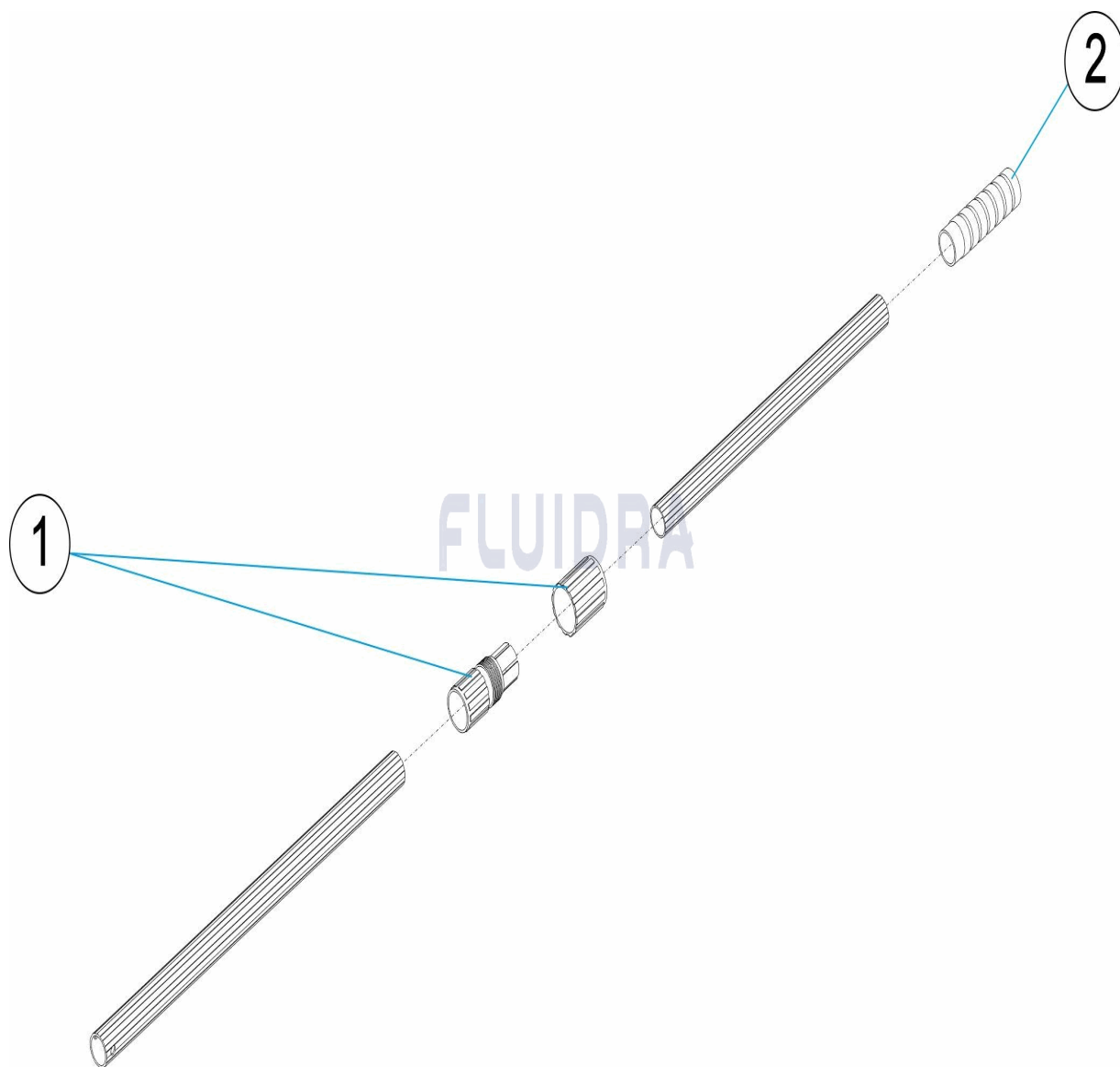

ESPAÑOL

| POS | CODIGO | DESCRIPCION | CANTIDAD | POS | CODIGO | DESCRIPCION | CANTIDAD |
|-----|------------|----------------|----------|-----|------------|------------------|----------|
| 1 | 4406030501 | PINZA Y TUERCA | | 2 | 4406030502 | EMPUÑADURA MANGO | |

CODE **06664, 06665**

DESCRIPTION: **MANCHE ALUMINIUM TÉLESCOPIQUE 3,6 - 4,8 M.**

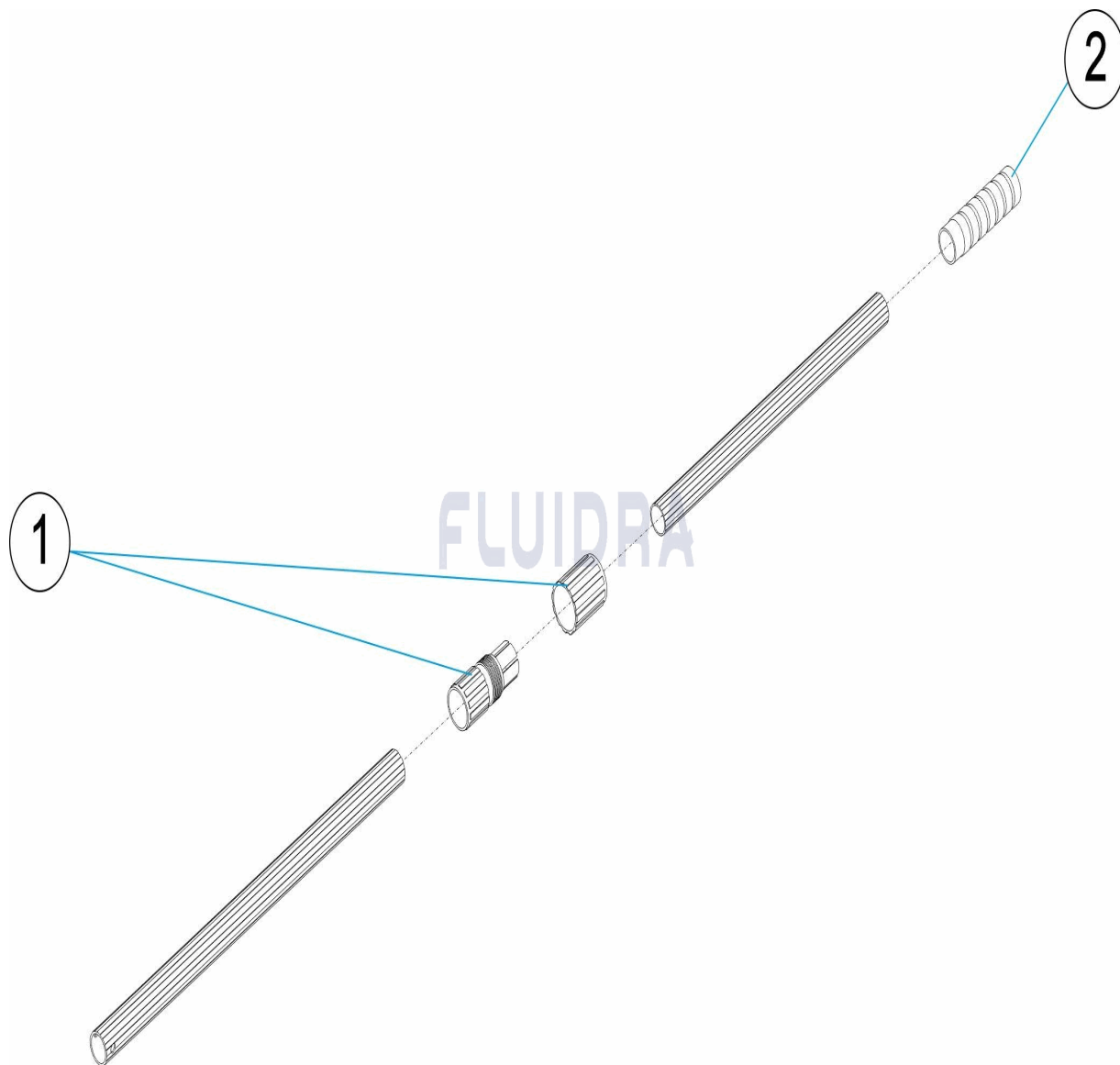

FRANCAIS

| POS | CODE | DESCRIPTION | QUANTITE | POS | CODE | DESCRIPTION | QUANTITE |
|-----|------------|----------------|----------|-----|------------|-------------------|----------|
| 1 | 4406030501 | PINCE ET ÉCROU | | 2 | 4406030502 | POIGNEE DE MANCHE | |

CODE **06664, 06665**

DESCRIPTION: **TELESCOPIC ALUMINIUM POLE 3.6 - 4.8M**

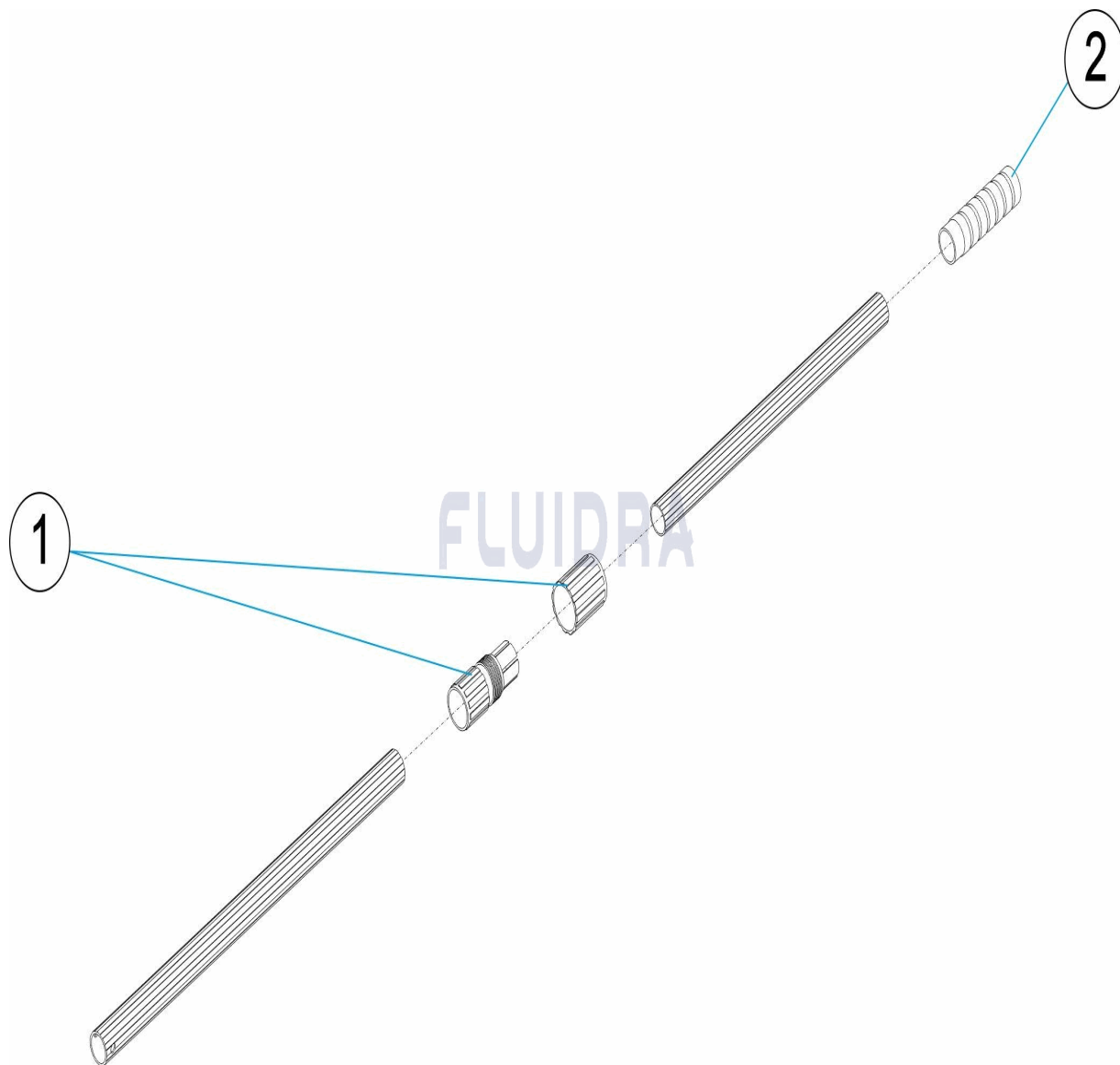

ENGLISH

| POS | CODE | DESCRIPTION | QUANTITY | POS | CODE | DESCRIPTION | QUANTITY |
|-----|------------|------------------|----------|-----|------------|-------------|----------|
| 1 | 4406030501 | PEG AND RING NUT | | 2 | 4406030502 | HANDLE GRIP | |

CODICE **06664, 06665**

DESCRIZIONE: **MANICO ALLUMINIO TELESCOPICO 3,6 - 4,8 M.**

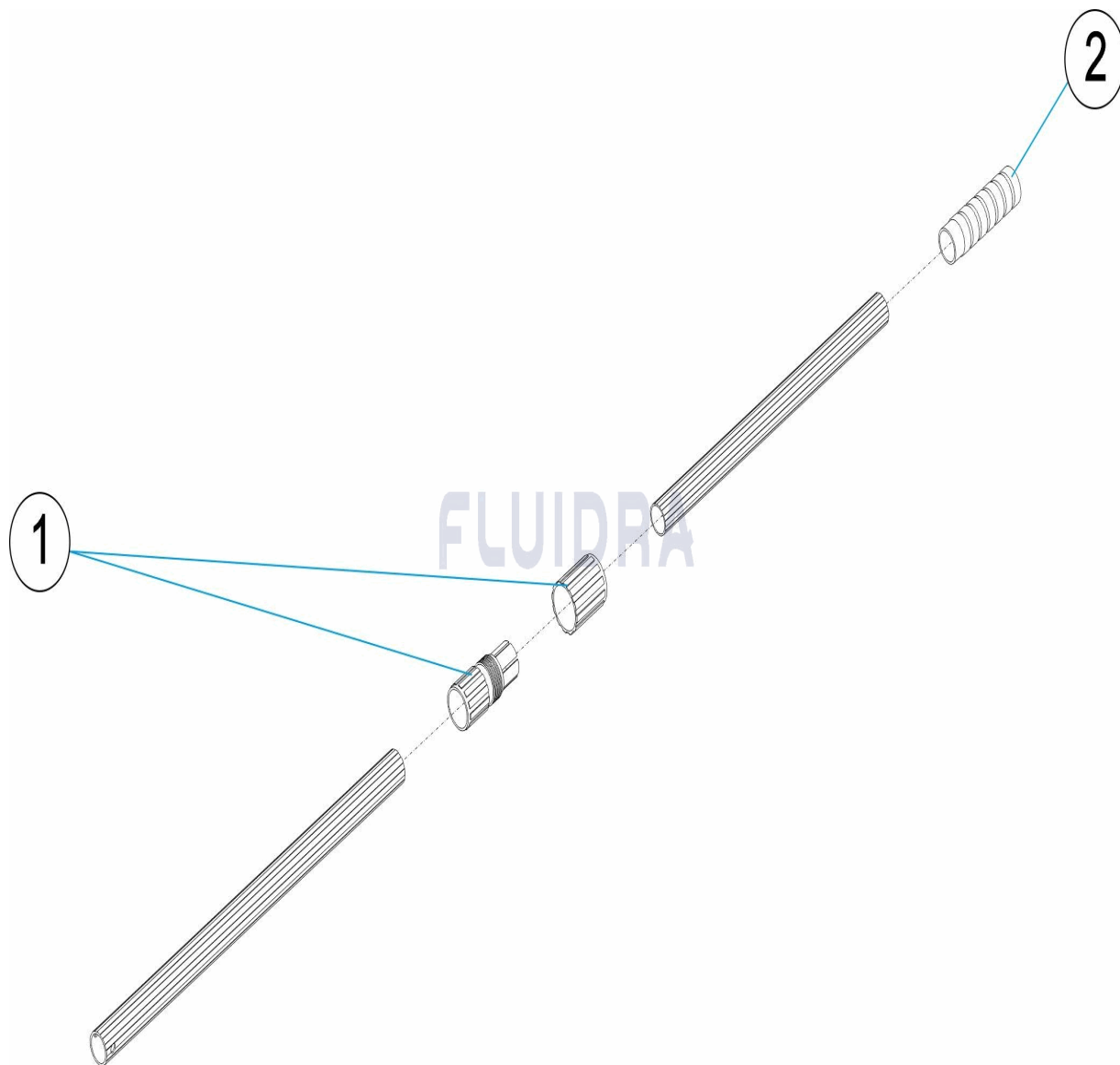

ITALIANO

| POS | CODICE | DESCRIZIONE | QUANTITA' | POS | CODICE | DESCRIZIONE | QUANTITA' |
|-----|------------|----------------|-----------|-----|------------|--------------------|-----------|
| 1 | 4406030501 | PINZA E GHIERA | | 2 | 4406030502 | IMPUGNATURA MANICO | |

CODE **06664, 06665**

BESCHREIBUNG: **GRIFF ALUMINIUM TELESKOPISCH 3,6 - 4,8 M**

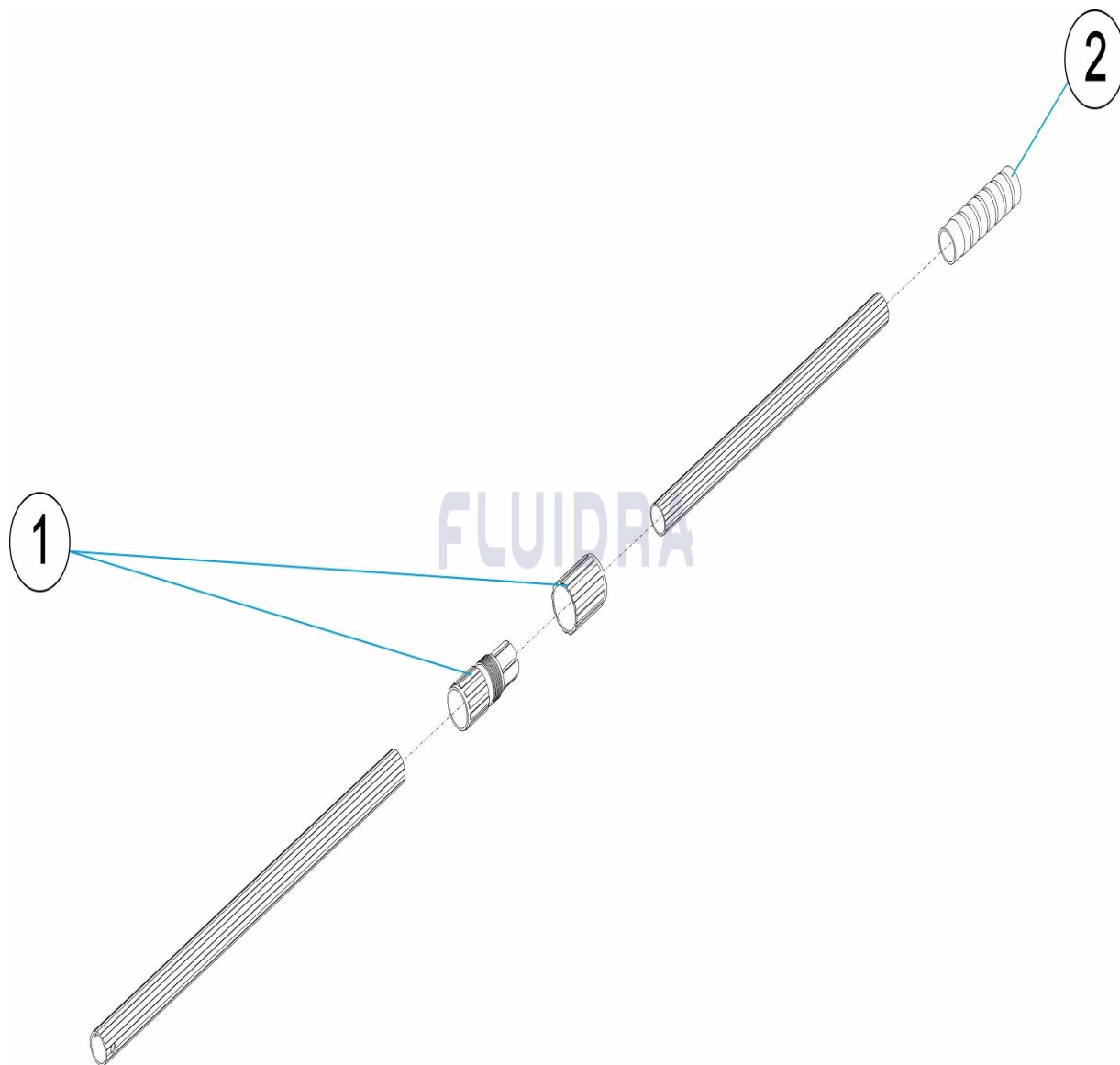

DEUTSCH

| POS | CODE | BESCHREIBUNG | MENGE | POS | CODE | BESCHREIBUNG | MENGE |
|-----|------------|------------------|-------|-----|------------|--------------|-------|
| 1 | 4406030501 | KEMME UND MUTTER | | 2 | 4406030502 | GRIFF | |

CODIGO **06664, 06665**

DESCRIÇÃO: **CABO ALUMÍNIO TELESCÓPICO 3,6 - 4,8 M.**

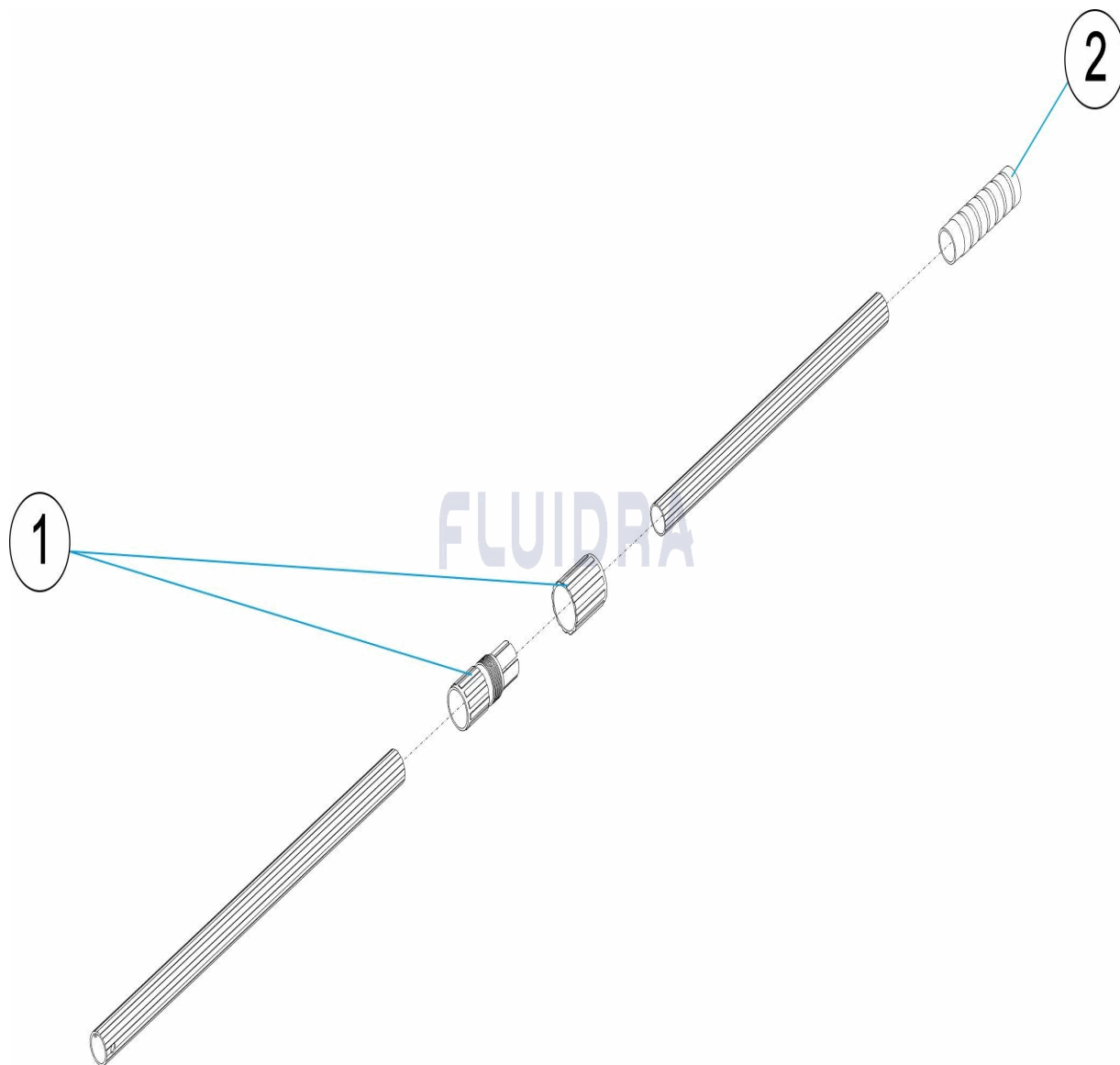

PORTUGUES

| POS | CODIGO | DESCRIÇÃO | JANTIDADE | POS | CODIGO | DESCRIÇÃO | JANTIDADE |
|-----|------------|-----------------------------|-----------|-----|------------|---------------------|-----------|
| 1 | 4406030501 | PINÇA E PORCA CABOS 2,4-4,8 | | 2 | 4406030502 | PUNHO CABOS 2,4-4,8 | |