

CODIGO **00095**

DESCRIPCION: **DUCHA 1 ROCIADOR Y 1 VALVULA TEMP. TUBO D. 63**

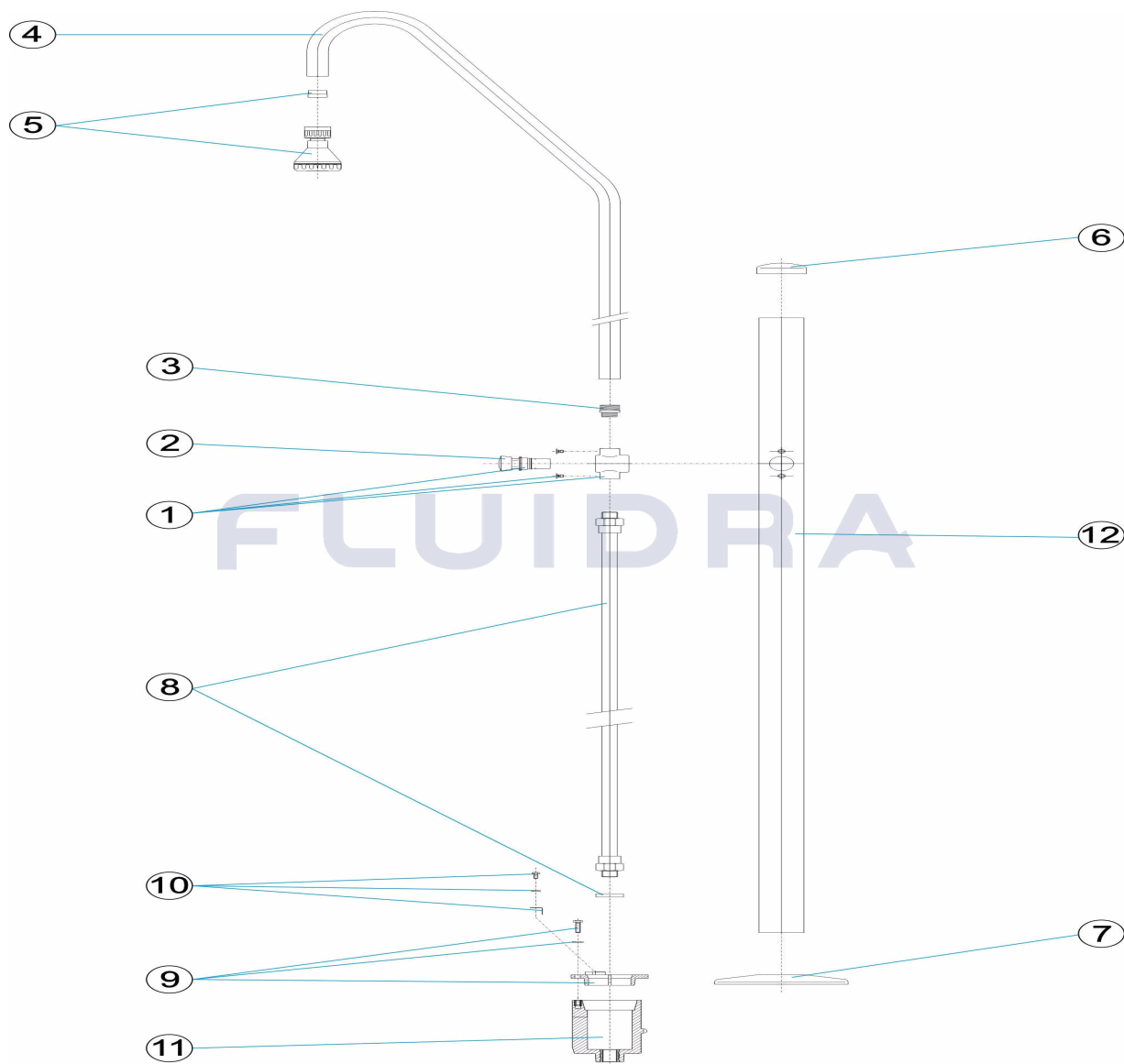

ESPAÑOL

POS	CODIGO	DESCRIPCION	CANTIDAD	POS	CODIGO	DESCRIPCION	CANTIDAD
1	4401040501	CUERPO VALVULA TEMPORIZADORA		7	4401040507	TAPETA EMBELLECEDORA INFERIOR	
2	4401040502	VALVULA TEMPORIZADORA		8	4401040110	TUBO 1/2'	
3	4401040503	MACHON 3/4'-1/2'		9	4401042810	FIJACION ANCLAJE DUCHA D 63	
4	4401040105	BRAZO DUCHA		10	4401040903	TOMA DE TIERRA	
5	4401040104	PIÑA DUCHA		11	4401042811	CUERPO ANCLAJE DUCHA	
6	4401040506	TAPETA EMBELLECEDORA SUPERIOR 63		12	00095R0007	TUBO EXTERIOR D.63	

CODE **00095**

DESCRIPTION: **DOUCHE 1 POMMEAU ET 1 ROBINET TEMP. TUBE D. 63**

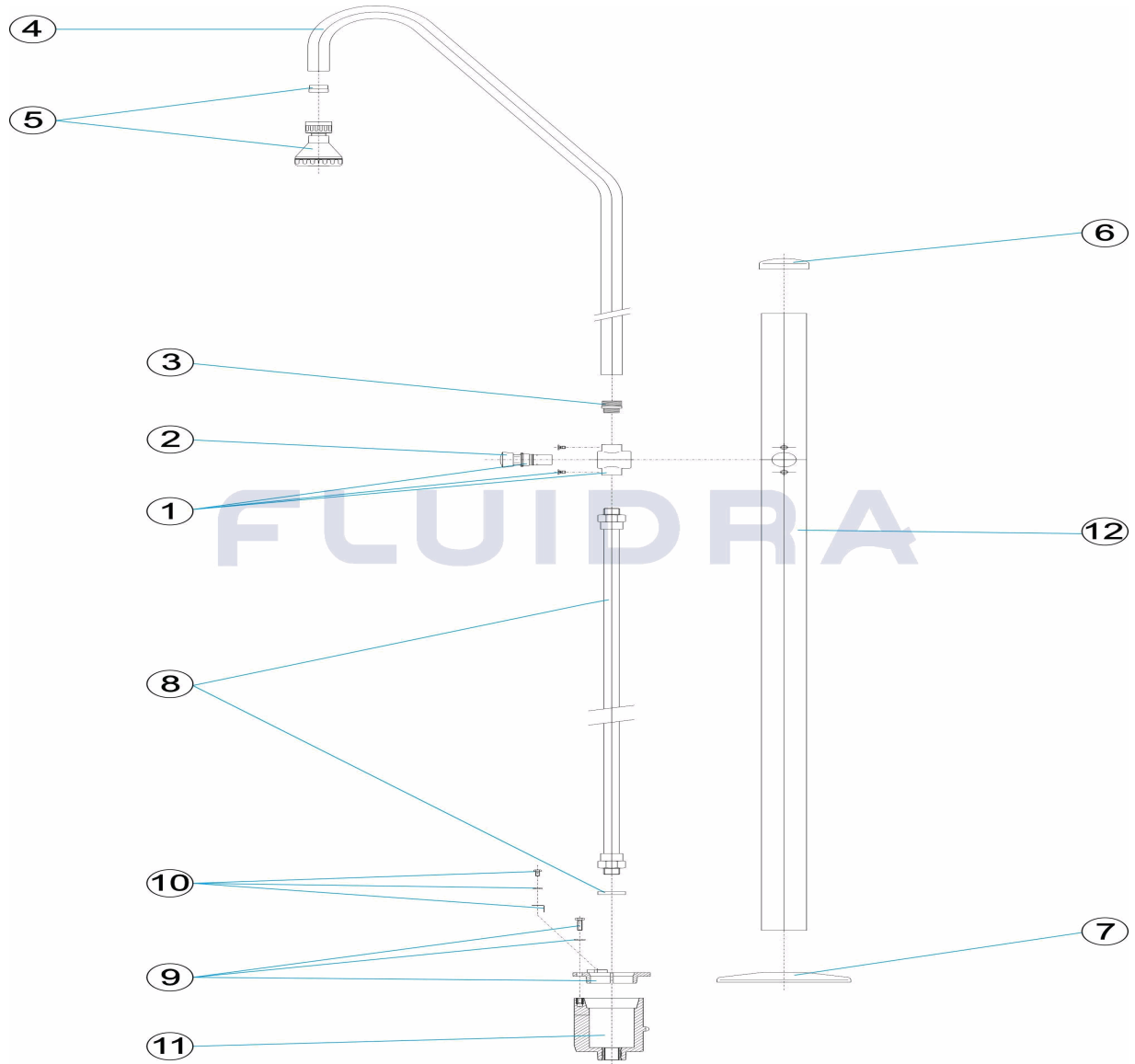

FRANCAIS

POS	CODE	DESCRIPTION	QUANTITE	POS	CODE	DESCRIPTION	QUANTITE
1	4401040501	TE ROBINET DE DOUCHE TEMPORISÉ		7	4401040507	ENJOLIEVEUR INFERIEUR	
2	4401040502	BOUTON POUSSOIR		8	4401040110	TUBE 1/2'	
3	4401040503	MANCHON 3/4'-'		9	4401042810	FIXATION ANCRAGE DOUCHE D 63	
4	4401040105	BRAS DE DOUCHE		10	4401040903	PRISE DE TERRE	
5	4401040104	POMMEAU DE DOUCHE		11	4401042811	CORPS D'ANCRAGE DE DOUCHE	
6	4401040506	ENJOLIEVEUR SUPERIEUR 63		12	00095R0007	TUBE EXTERIEUR D.63	

CODE **00095**

DESCRIPTION: **SHOWER 1 SHOWER HEAD AND 1 TIMER VALVE D.63 PIPE**

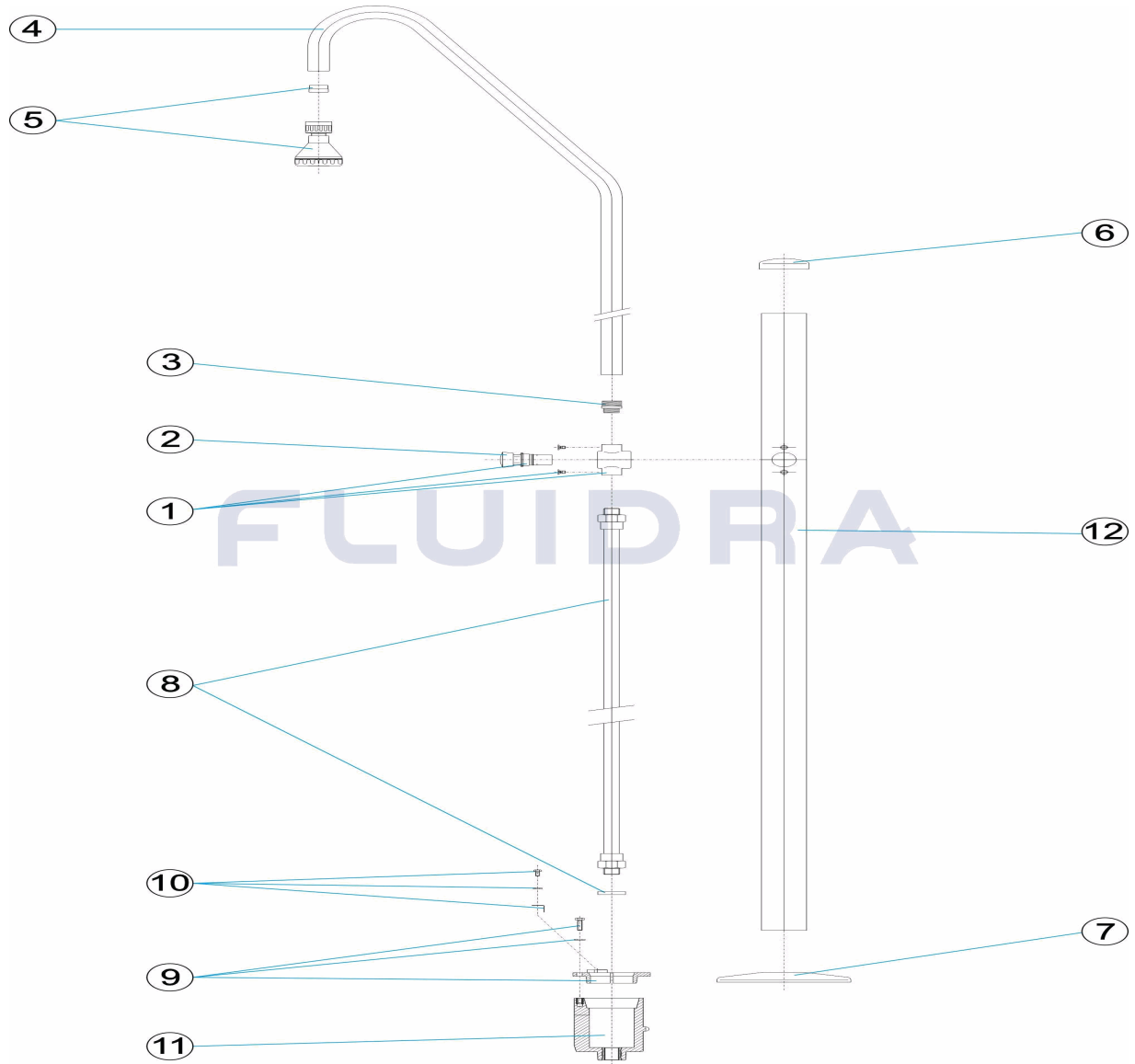

ENGLISH

POS	CODE	DESCRIPTION	QUANTITY	POS	CODE	DESCRIPTION	QUANTITY
1	4401040501	TIMER VALVE BODY		7	4401040507	BOTTOM ESCUTCHEON PLATE	
2	4401040502	TIMER VALVE		8	4401040110	1/2' PIPE	
3	4401040503	3/4-1/2' SPIGOT		9	4401042810	SHOWER ANCHOR D 63	
4	4401040105	SHOWER ARM		10	4401040903	EARTH CONNECTION	
5	4401040104	SHOWER HEAD		11	4401042811	SHOWER ANCHORING FIXTURE	
6	4401040506	TOP ESCUTCHEON PLATE 63		12	00095R0007	TUBE EXTERNAL 63MM	

CODICE 00095

DESCRIZIONE: DOCCIA 1 SPRUZZATORE E 1 VALVOLA TEMP. TUBO D. 63

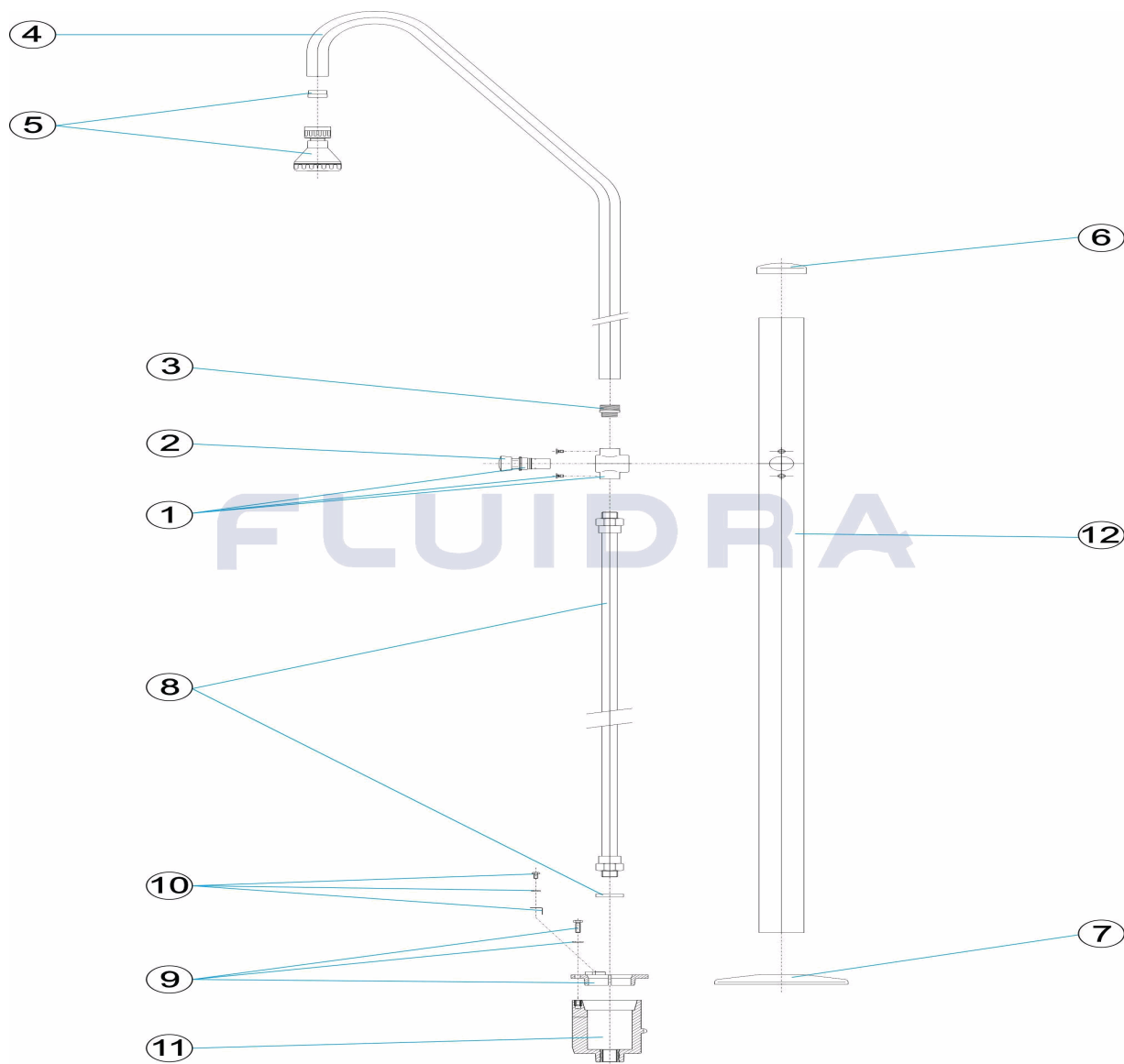

ITALIANO

POS	CODICE	DESCRIZIONE	QUANTITA'	POS	CODICE	DESCRIZIONE	QUANTITA'
1	4401040501	CORPO VALVOLA TEMPORIZZATA		7	4401040507	COPRIFLANGIA INFERIORE	
2	4401040502	VALVOLA TEMPORIZZATA		8	4401040110	TUBO 1/2'	
3	4401040503	NIPPLO 3/4" - 1"		9	4401042810	FISSAGGIO ANCORAGGIO DOCCIA D 63	
4	4401040105	BRACCIO DOCCIA		10	4401040903	PRESA A TERRA	
5	4401040104	DIFFUSORE DOCCIA		11	4401042811	CORPO ANCORAGGIO DOCCIA	
6	4401040506	COPRIFLANGIA 63		12	00095R0007	TUBO ESTERNO D.63	

CODE **00095**

BESCHREIBUNG: **DUSCHE 1 DUSCHKOPF UND 1 VENTIL REGELKNOPF ROHR D. 63**

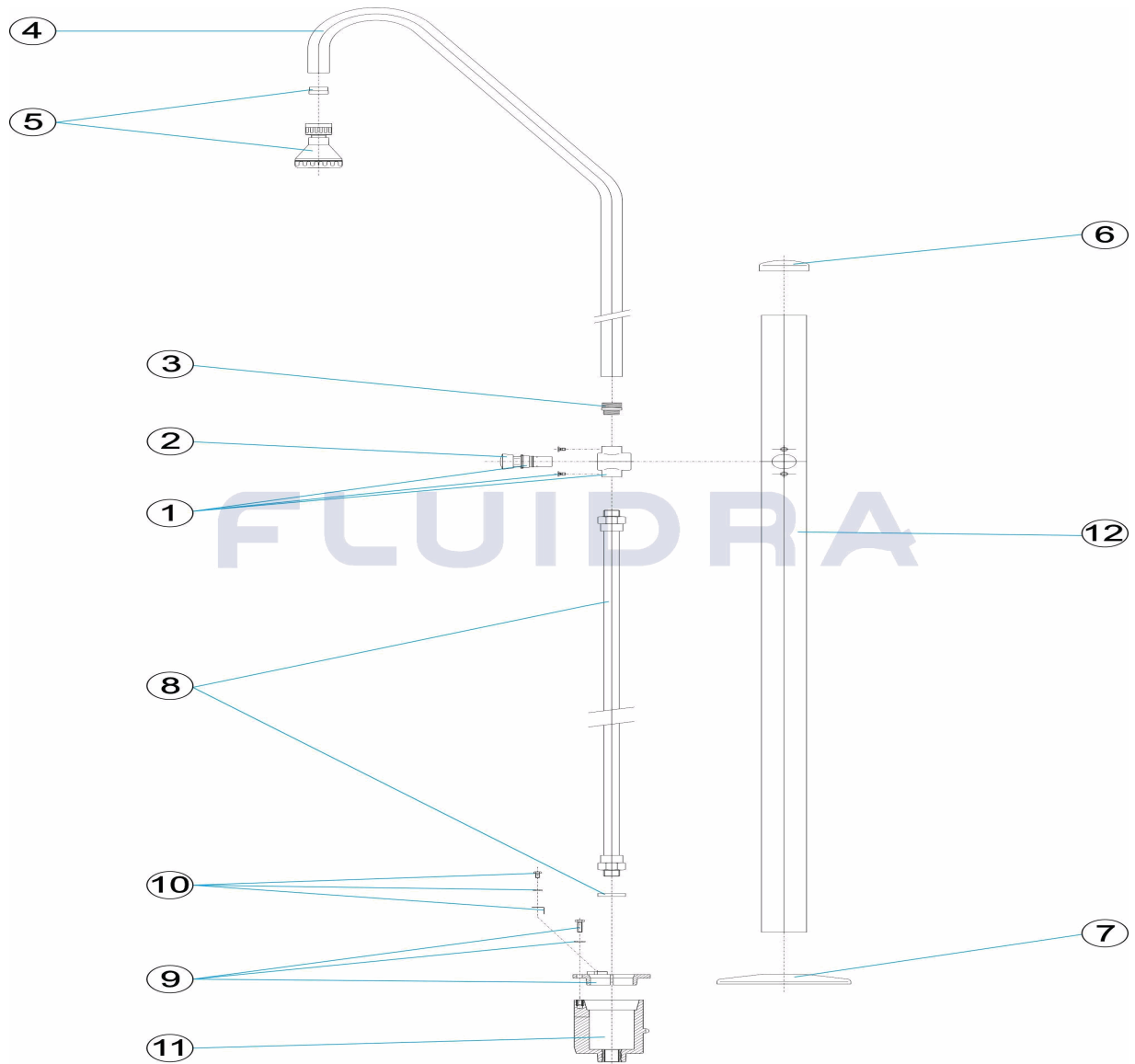

DEUTSCH

POS	CODE	BESCHREIBUNG	MENGE	POS	CODE	BESCHREIBUNG	MENGE
1	4401040501	GEHÄUSE REGLERVENTIL		7	4401040507	DEKO-ABSCHLUSSRING UNTEN	
2	4401040502	REGLERVENTIL		8	4401040110	ROHR 1/2'	
3	4401040503	SCHRAUBTEIL 3/4' - 1/2'		9	4401042810	FIXIERUNG DUSCHVERANKERUNG D. 63	
4	4401040105	DUSCHARM		10	4401040903	ERDUNG	
5	4401040104	DUSCHKOPF		11	4401042811	VERANKERUNG DUSCHHEINHEIT	
6	4401040506	DEKO-ABSCHLUSSRING OBEN 63		12	00095R0007	AUSSENROHR D. 63	

CODIGO **00095**

DESCRIÇÃO: **DUCHE 1 DIFUSOR 1 VÁLVULA TEMP. TUBO D. 63**

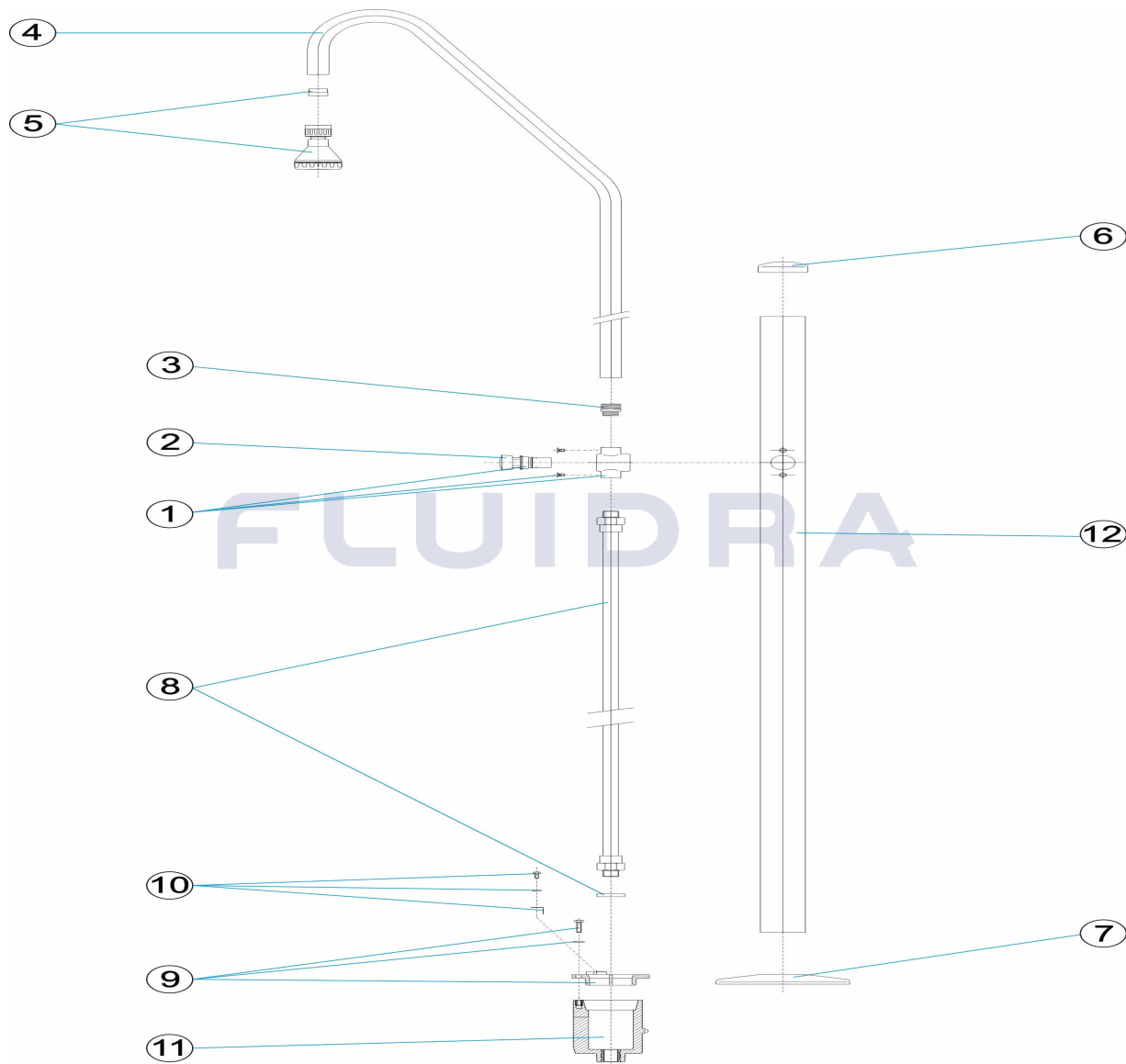

PORTUGUES

POS	CODIGO	DESCRIÇÃO	JANTIDADE	POS	CODIGO	DESCRIÇÃO	JANTIDADE
1	4401040501	CORPO VÁLVULA TEMPORIZADORA		7	4401040507	TAMPA EMBELEZADORA INFERIOR	
2	4401040502	VÁLVULA TEMPORIZADA		8	4401040110	TUBO 1/2'	
3	4401040503	MACHO 3/4" - 1"		9	4401042810	FIXAÇÃO ÂNCORA CHUVEIRO D 63	
4	4401040105	BRAÇO CHUVEIRO		10	4401040903	LIGAÇÃO A TERRA	
5	4401040104	REGADOR CHUVEIRO		11	4401042811	CORPO ÂNCORA CHUVEIRO	
6	4401040506	ANTIDERRAPANTE		12	00095R0007	TUBO EXTERIOR D.63	