

CODIGO **07610**

DESCRIPCION: **SKIMMER A-202**

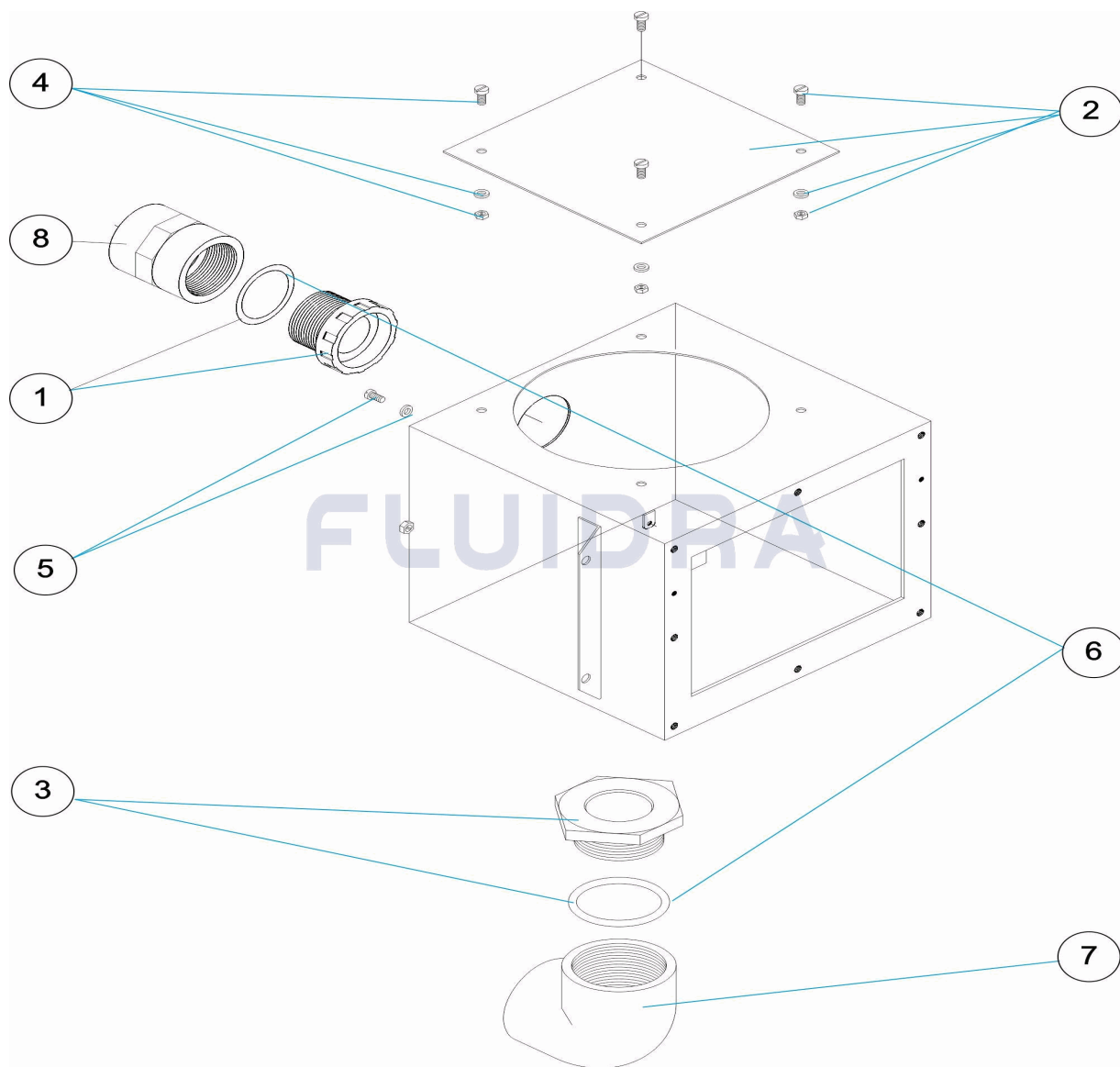

ESPAÑOL

POS	CODIGO	DESCRIPCION	CANTIDAD	POS	CODIGO	DESCRIPCION	CANTIDAD
1	4402013901	REBOSADERO SKIMMER INOX A-202	5	4401090402	TOMA DE TIERRA		
2	4402013201	TAPA SKIMMER INOX.	6	4402013205	CJTO. JUNTAS		
3	4402013203	TERMINAL ROSCA EXTERIOR 2"	7	01733	CODO MIXTO D. 63-2"		
4	4402013204	TORNILLOS Y TUERCAS DIN-85 M5X8	8	01893	MANGUITO UNION MIXTO D. 50 - 1 1/2"		

CODE 07610

DESCRIPTION: SKIMMER A-202

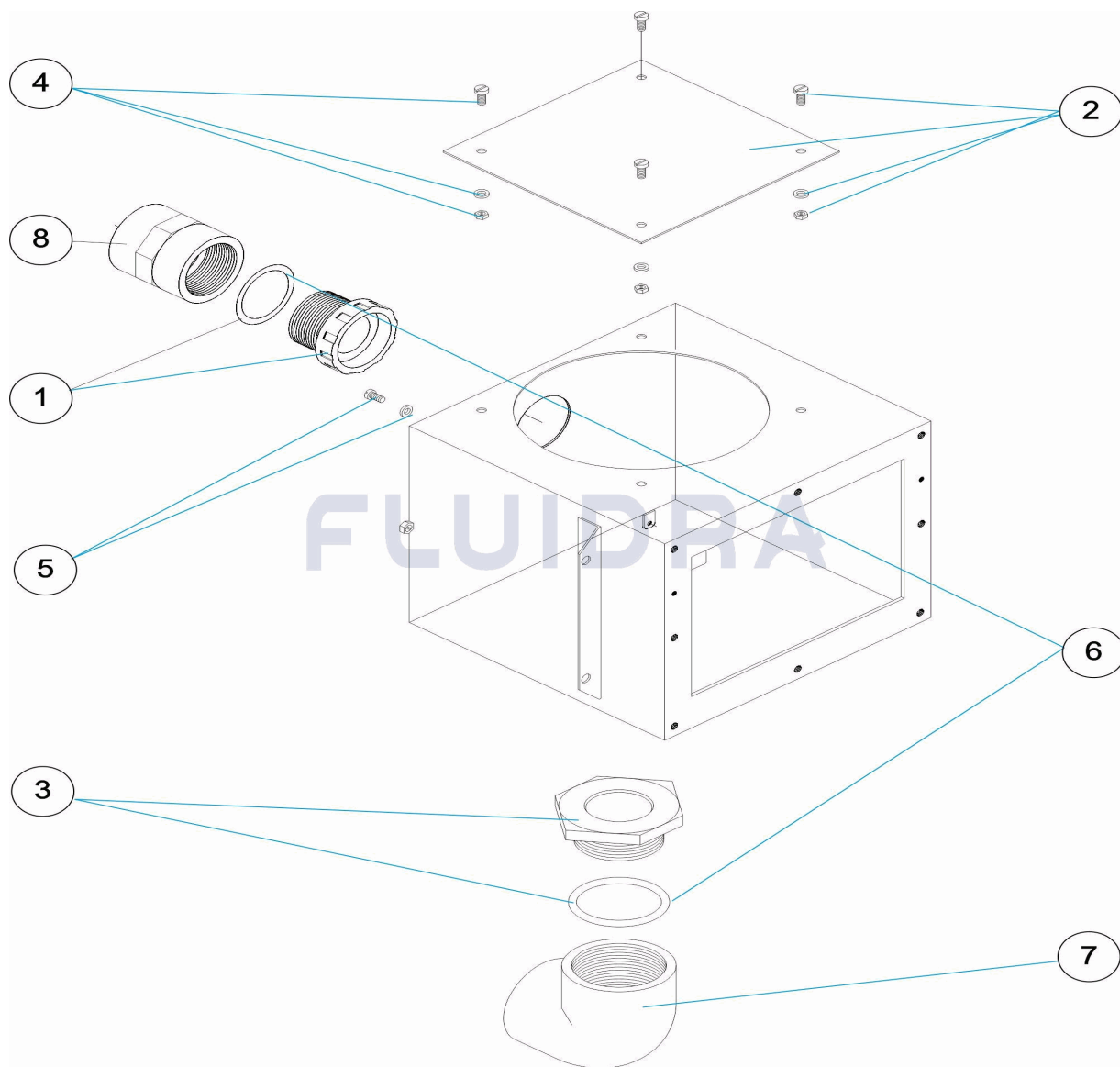

FRANCAIS

POS	CODE	DESCRIPTION	QUANTITE	POS	CODE	DESCRIPTION	QUANTITE
1	4402013901	TROP PLEIN SKIMMER INOX A-202	5	4401090402	PRISE DE TERRE		
2	4402013201	COUVERCLE DE SKIMMER INOX	6	4402013205	ENSEMBLE JOINTS		
3	4402013203	ECROU AVEC PAS DE VIS EXTERIEUR 2"	7	01733	COUDE MIXTE D. 63 - 2"		
4	4402013204	VIS ET RONDELLES	8	01893	MANCHON PVC MIX D.50X1 1/2"		

CODE **07610**

DESCRIPTION: **SKIMMER A-202**

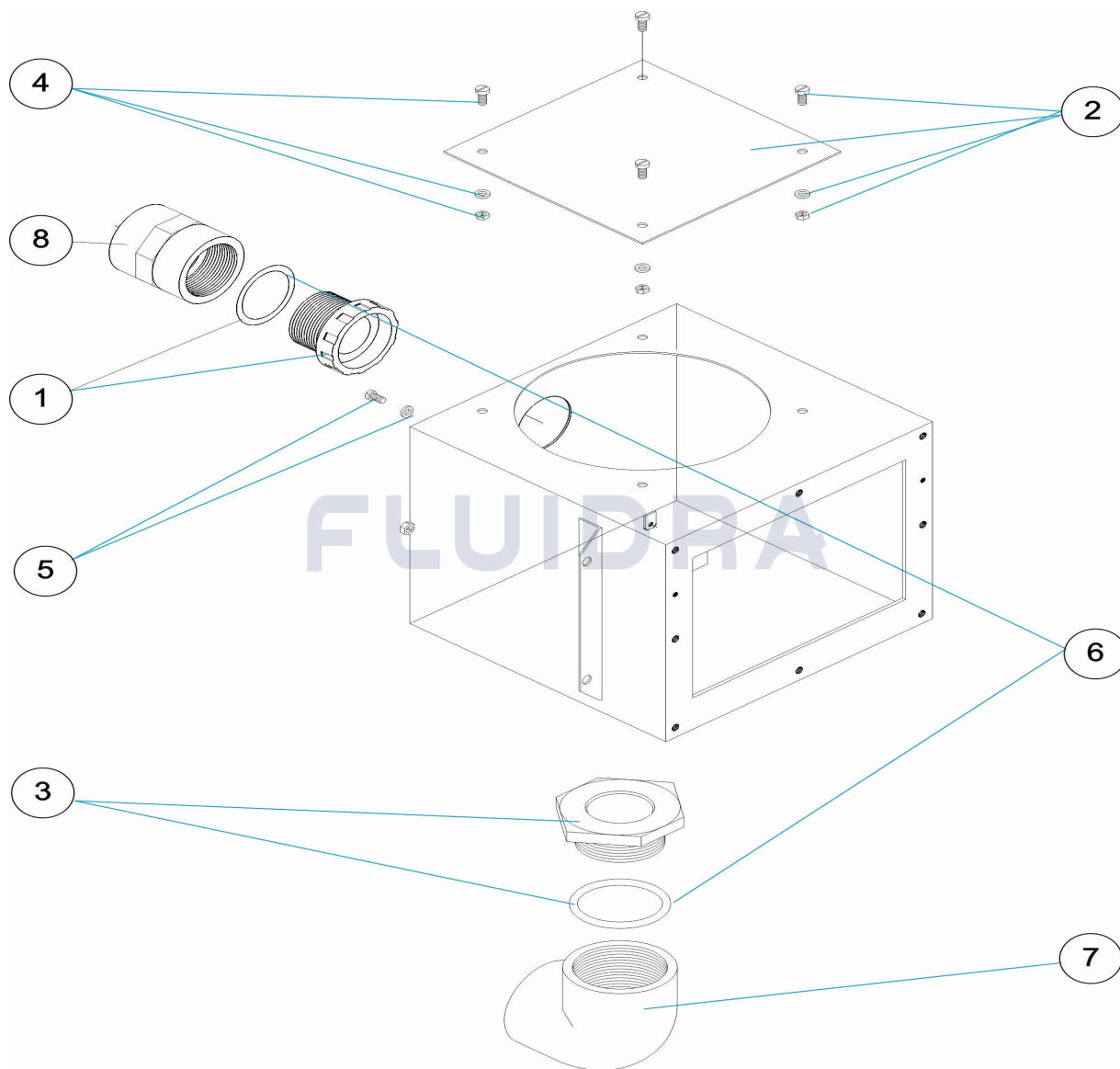

ENGLISH

POS	CODE	DESCRIPTION	QUANTITY	POS	CODE	DESCRIPTION	QUANTITY
1	4402013901	S. S. SKIMMER OVERFLOW A-202		5	4401090402	EARTH CONNECTION	
2	4402013201	SKIMMER COVER WITH SCREWS		6	4402013205	GASKET ASSEMBLY	
3	4402013203	NIPPLE		7	01733	ELBOW D. 63 - 2"	
4	4402013204	SCREWS AND NUTS DIN-85 M5X8		8	01893	ADAPTADOR SOCKET D50 X 1 1/2"	

CODICE **07610**

DESCRIZIONE: **SKIMMER A-202**

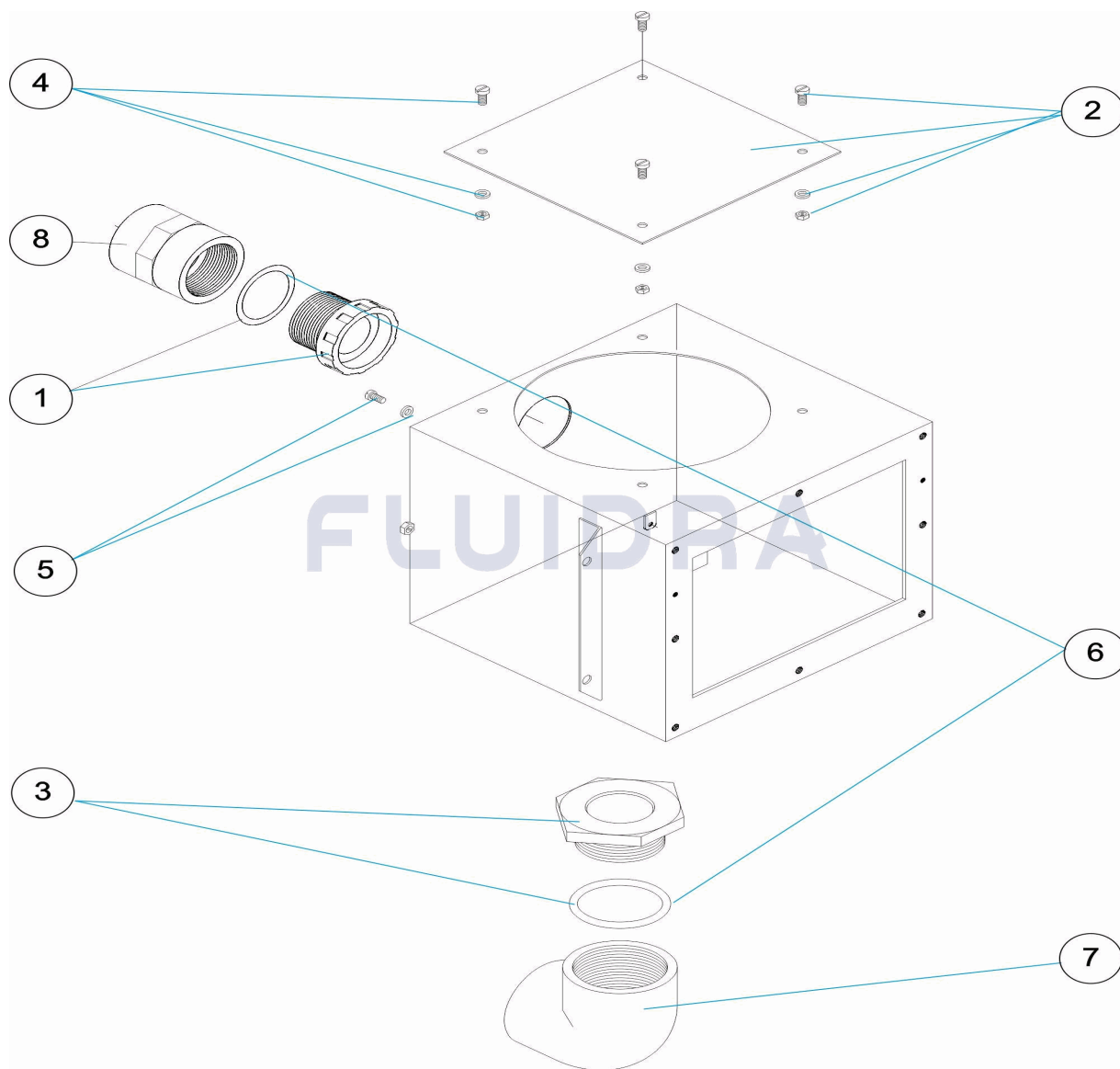

ITALIANO

POS	CODICE	DESCRIZIONE	QUANTITA'	POS	CODICE	DESCRIZIONE	QUANTITA'
1	4402013901	TROPPO PIENO SKIMMER INOX A-202	5	4401090402	PRESA A TERRA		
2	4402013201	COPERCHIO SKIMMER INOX	6	4402013205	GRUPPO GUARNIZIONI		
3	4402013203	TERMINALE FILETTO ESTERNO	7	01733	GOMITO MISTO D.63-2"		
4	4402013204	VITI E GHIERA DIN-85 M5X8	8	01893	MANICOTTO MISTO INCOLLAGGIO E FILET		

CODE **07610**

BESCHREIBUNG: **SKIMMER A-202**

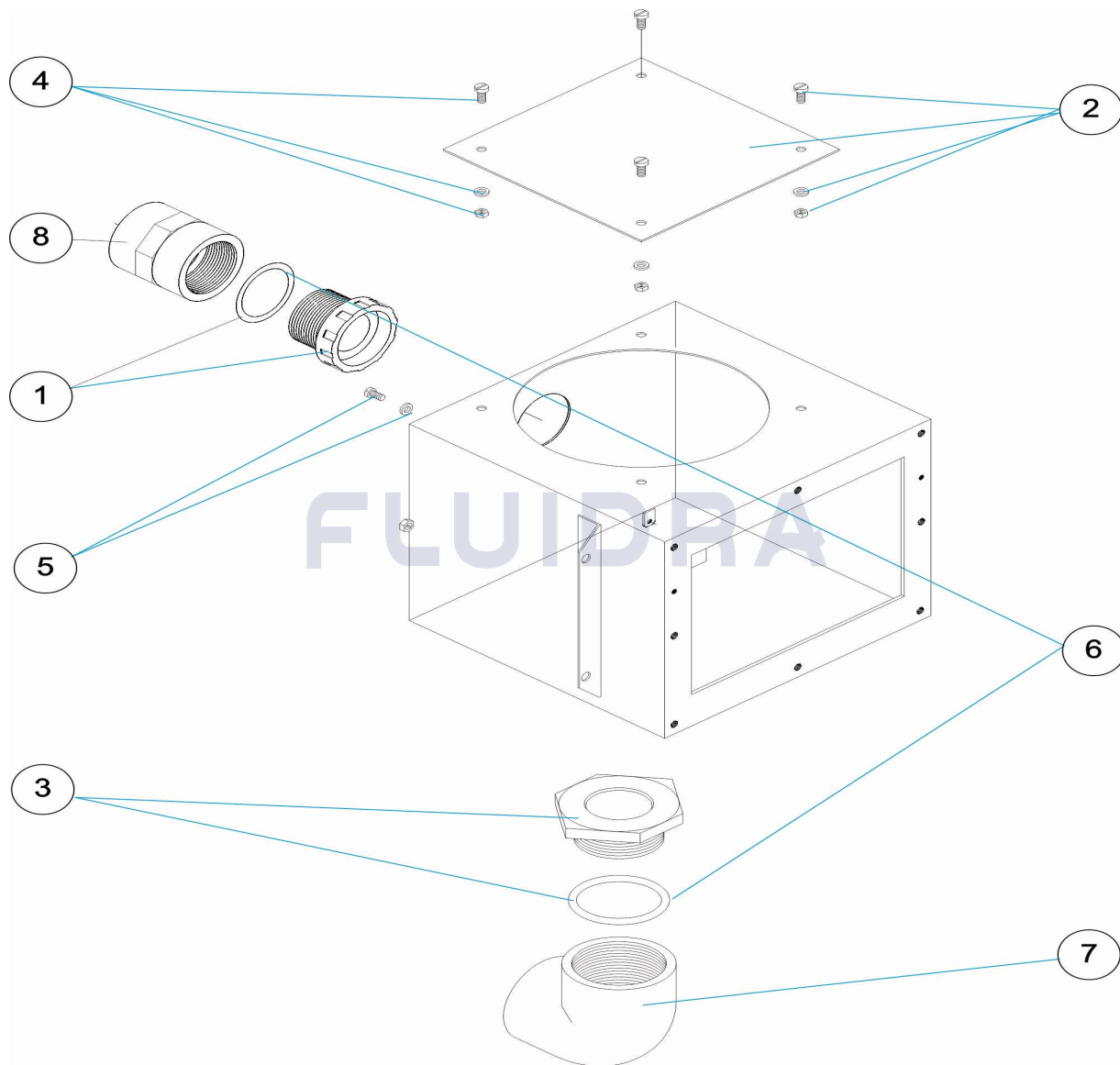

DEUTSCH

POS	CODE	BESCHREIBUNG	MENGE	POS	CODE	BESCHREIBUNG	MENGE
1	4402013901	AUFSATZ SKIMMER EDELSTAHL A-202		5	4401090402	ERDUNG	
2	4402013201	SKIMMERABDECKUNG EDELSTAHL		6	4402013205	DICHTUNGENSATZ	
3	4402013203	ANSCHLUSS GEWINDE AUSSEN 2"		7	01733	WINKEL KOMBI D. 63 - 2"	
4	4402013204	SCHRAUBEN UND MUTTERN DIN-85 M5 X		8	01893	NIPPEL VERBINDUNG KOMBI D. 50 - 1 1/2"	

CODIGO **07610**

DESCRIÇÃO: **SKIMMER A-202**

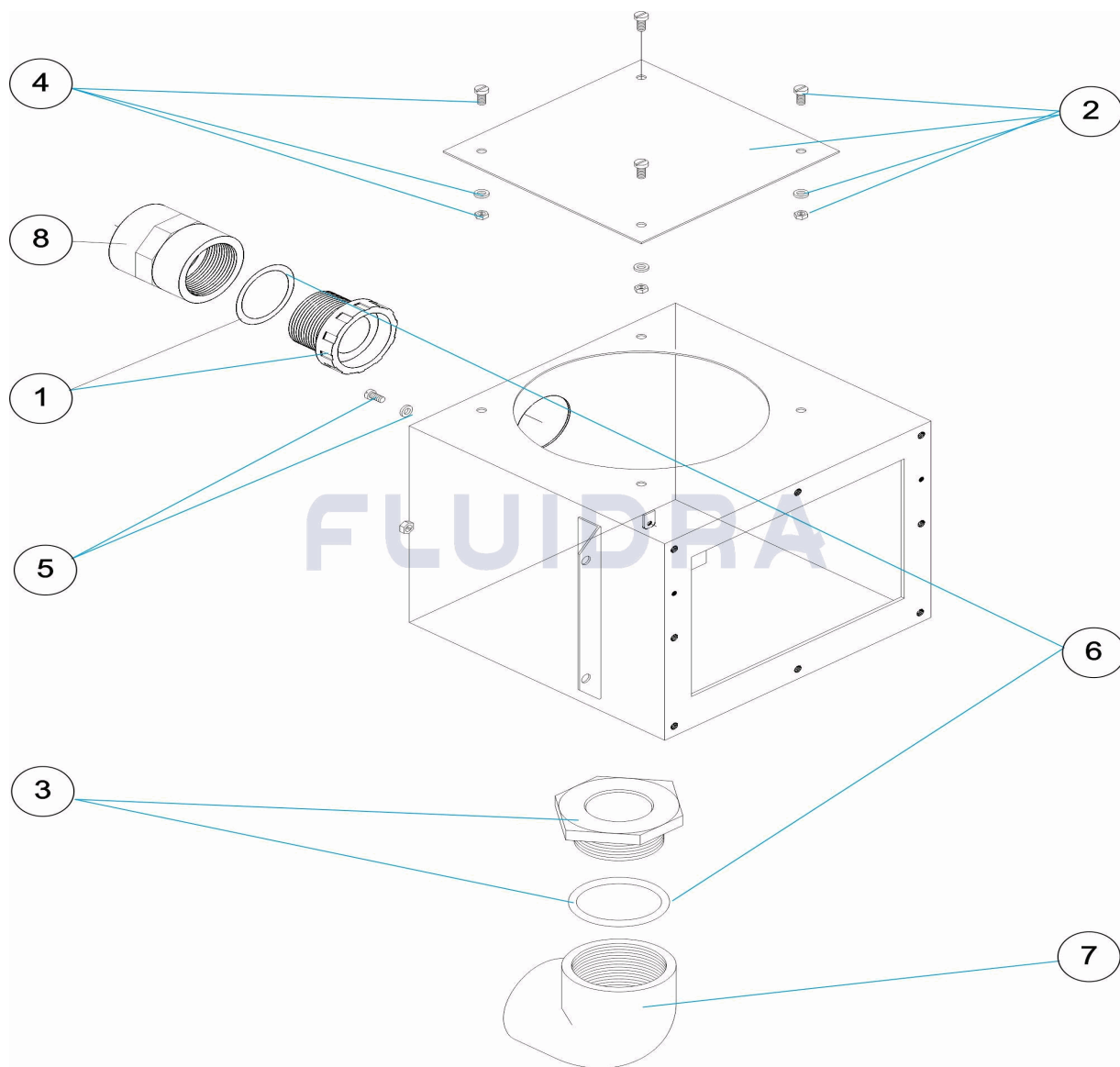

PORTUGUES

POS	CODIGO	DESCRIÇÃO	JANTIDADE	POS	CODIGO	DESCRIÇÃO	JANTIDADE
1	4402013901	CALEIRA SKIMMER INOX A-202	5	4401090402	LIGAÇÃO A TERRA		
2	4402013201	TAMPA SKIMMER INOX	6	4402013205	CONJUNTO JUNTAS		
3	4402013203	TERMINAL ROSCA EXTERIOR 2"	7	01733	JOELHO MISTO D. 63 - 2"		
4	4402013204	PARAFUSOS E PORCAS DIN-85 M5X8	8	01893	UNIAO TRANSIÇÃO FEMEA D 50X1 1/2"		