

CODIGO **16332, 16333**

DESCRIPCION: **PULSADOR PISCINA HORMIGON Y LINER**

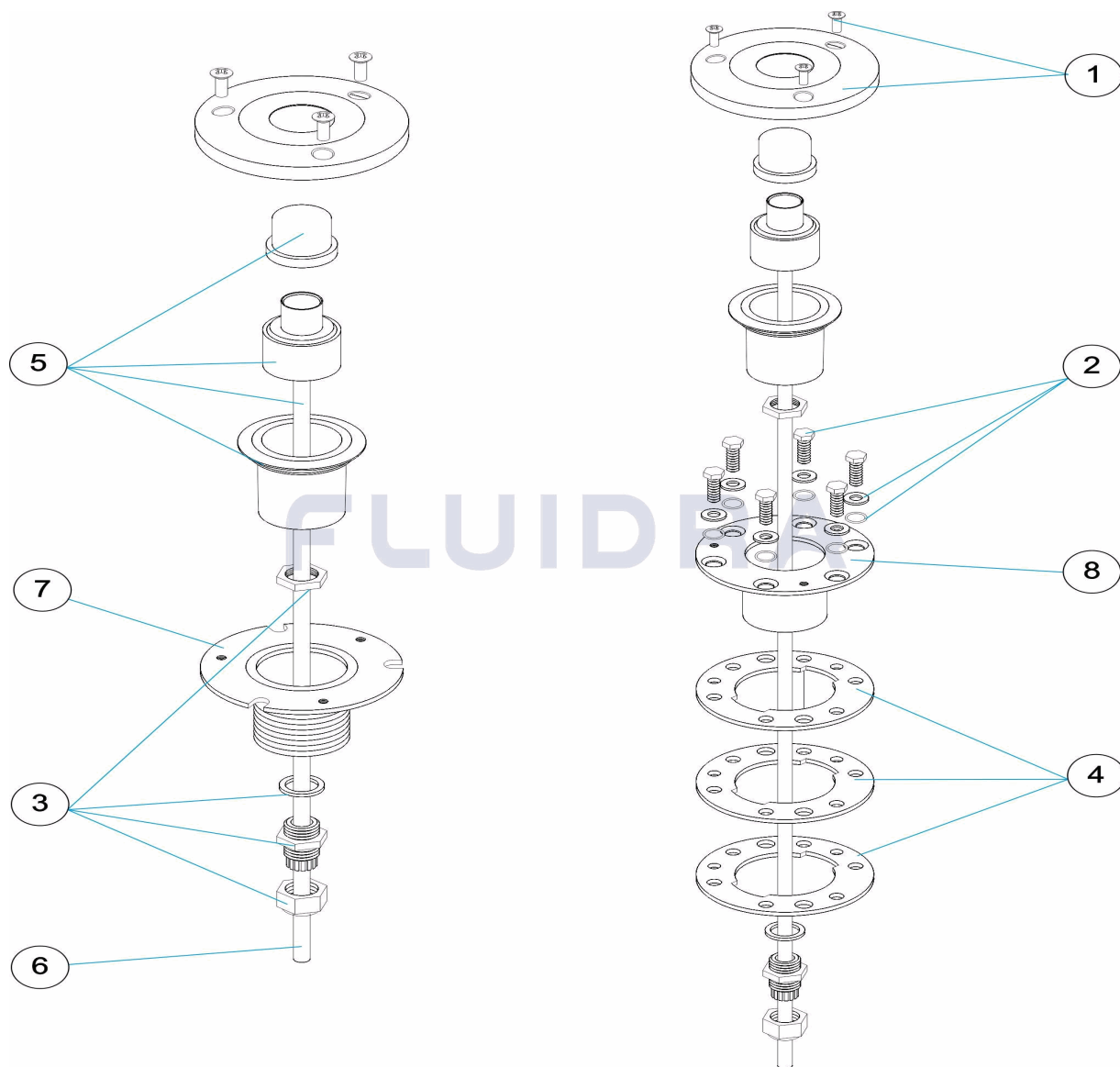

ESPAÑOL

| POS | CODIGO | DESCRIPCION | CANTIDAD | POS | CODIGO | DESCRIPCION | CANTIDAD |
|-----|--------------|-------------------------------|----------|-----|--------------|----------------------------------|----------|
| 1 | 4402050301 | TAPETA PULSADOR | | 5 | 4402050119 | PULSADOR COMPLETO | |
| 2 | * 4402050302 | TORNILLOS FIJACION BASE LINER | | 6 | 00241R0404 | CONDUCTO MANIOBRA X MTS. | |
| 3 | * 4402050303 | CJTO. PRENSAESTOPAS | | 7 | * 16332R0100 | CUERPO PULSADOR PISCINA HORMIGON | |
| 4 | * 4402050304 | JUNTAS BOQUILLA | | 8 | * 16333R0100 | CUERPO PULSADOR PISCINA LINER | |

CODIGO 16332, 16333

DESCRIPCION: PULSADOR PISCINA HORMIGON Y LINER

OBSERVACIONES

| POS | CODIGO | OBSERVACIONES |
|-----|--------------|---------------|
| 2 | * 4402050302 | PARA: 16333 |
| 3 | * 4402050303 | PARA: 16332 |
| 4 | * 4402050304 | PARA: 16333 |
| 7 | * 16332R0100 | PARA: 16332 |
| 8 | * 16333R0100 | PARA: 16333 |

CODE 16332, 16333

DESCRIPTION: BOUTON-POUSOIR PISCINE BÉTON ET LINER

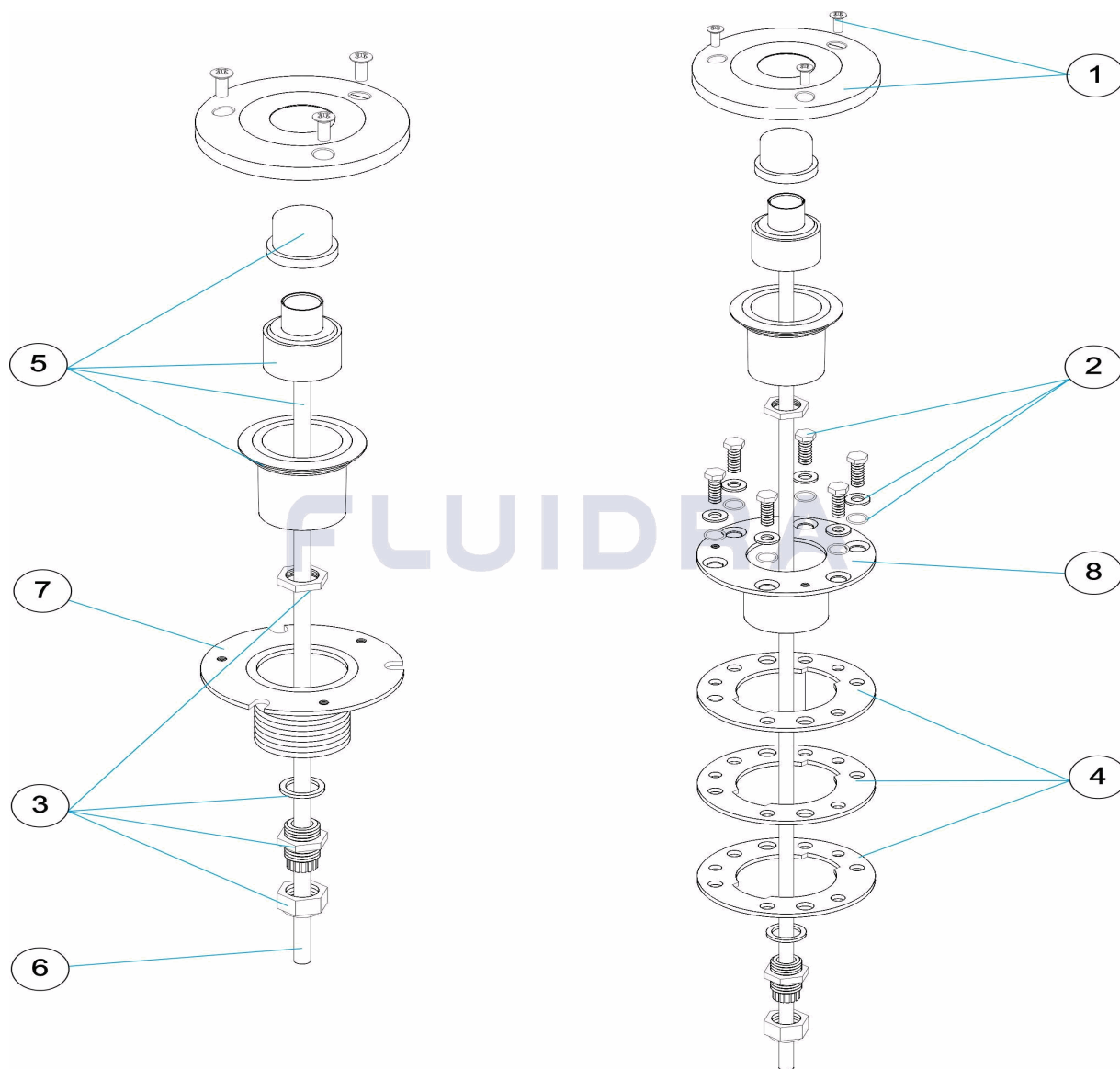

FRANCAIS

| POS | CODE | DESCRIPTION | QUANTITE | POS | CODE | DESCRIPTION | QUANTITE |
|-----|--------------|-------------------------|----------|-----|--------------|----------------------------------|----------|
| 1 | 4402050301 | CACHE BOUTON POUSSOIR | | 5 | 4402050119 | BOUTON POUSSOIR | |
| 2 | * 4402050302 | VIS FIXATION BASE LINER | | 6 | 00241R0404 | TUBE CONDUCTEUR MANOEUVRE X MTS. | |
| 3 | * 4402050303 | ENS. PRESSE ETOUPE | | 7 | * 16332R0100 | BASE BOUTON PUSOIR 16332 | |
| 4 | * 4402050304 | JOINTS BUSE | | 8 | * 16333R0100 | BASE BOUTON PUSOIR 16333 | |

CODE **16332, 16333**

DESCRIPTION: **BOUTON-POUSOIR PISCINE BÉTON ET LINER**

OBSERVATIONS

| POS | CODE | OBSERVATIONS |
|-----|--------------|--------------|
| 2 | * 4402050302 | POUR: 16333 |
| 3 | * 4402050303 | POUR: 16332 |
| 4 | * 4402050304 | POUR: 16333 |
| 7 | * 16332R0100 | POUR: 16332 |
| 8 | * 16333R0100 | POUR: 16333 |

CODE **16332, 16333**

DESCRIPTION: **POOL SWITCH CONCRETE AND LINER**

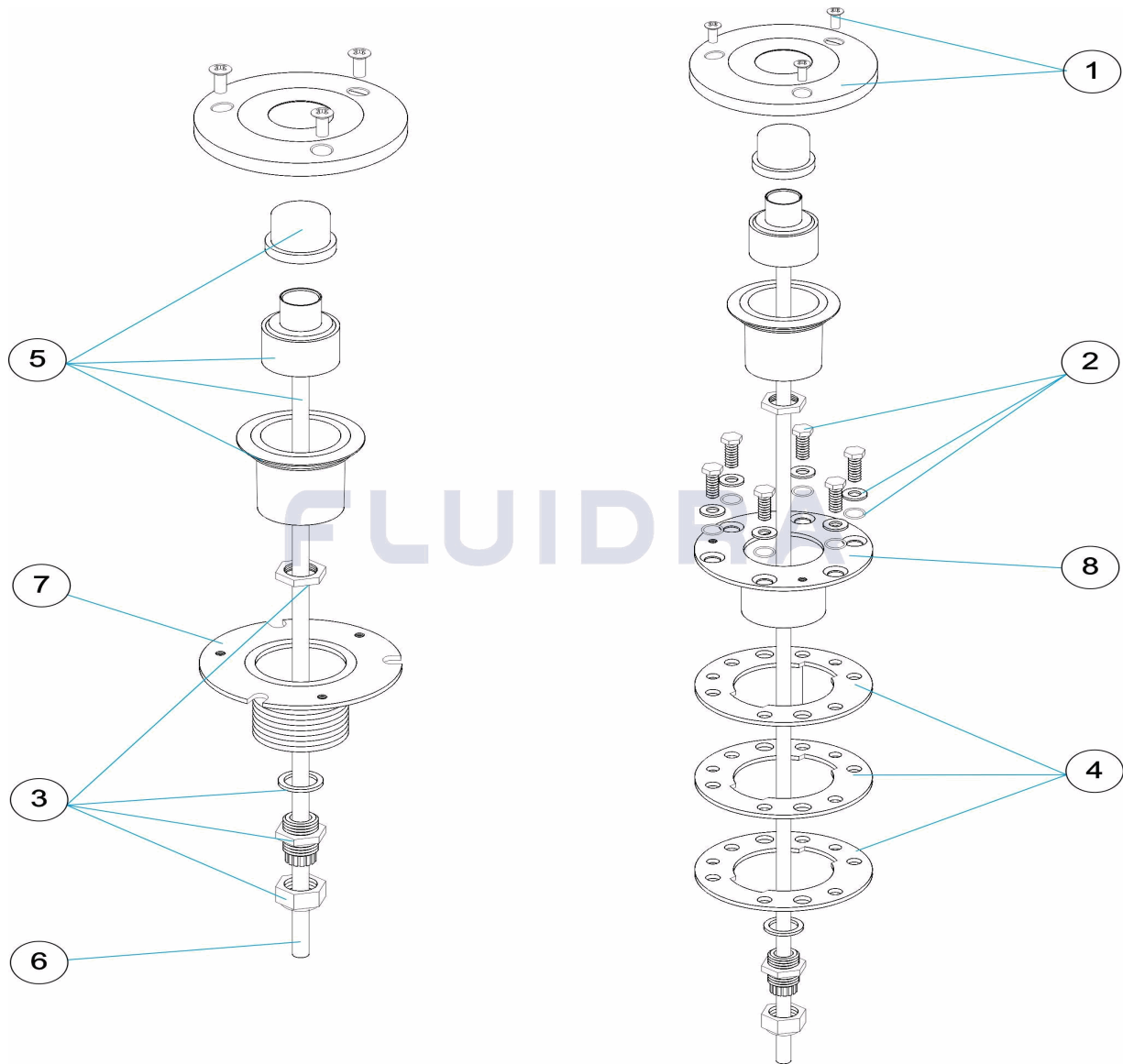

ENGLISH

| POS | CODE | DESCRIPTION | QUANTITY | POS | CODE | DESCRIPTION | QUANTITY |
|-----|--------------|------------------------------|----------|-----|--------------|------------------|----------|
| 1 | 4402050301 | ESCUTCHEON FOR SWITCH | | 5 | 4402050119 | COMPLETE SWITCH | |
| 2 | * 4402050302 | FIXING SCREWS FOR LINER BASE | | 6 | 00241R0404 | PVC PIPE X MTS. | |
| 3 | * 4402050303 | GLAND SEAL ASSY. | | 7 | * 16332R0100 | PUSH-BUTTON BASE | |
| 4 | * 4402050304 | SWITCH GASKETS | | 8 | * 16333R0100 | PUSH-BUTTON BASE | |

CODE **16332, 16333**

DESCRIPTION: **POOL SWITCH CONCRETE AND LINER**

OBSERVATIONS

| POS | CODE | OBSERVATIONS |
|-----|--------------|--------------|
| 2 | * 4402050302 | FOR: 16333 |
| 3 | * 4402050303 | FOR: 16332 |
| 4 | * 4402050304 | FOR: 16333 |
| 7 | * 16332R0100 | FOR: 16332 |
| 8 | * 16333R0100 | FOR: 16333 |

CODICE **16332, 16333**

DESCRIZIONE: **PULSANTE PISCINA CEMENTO E LINER**

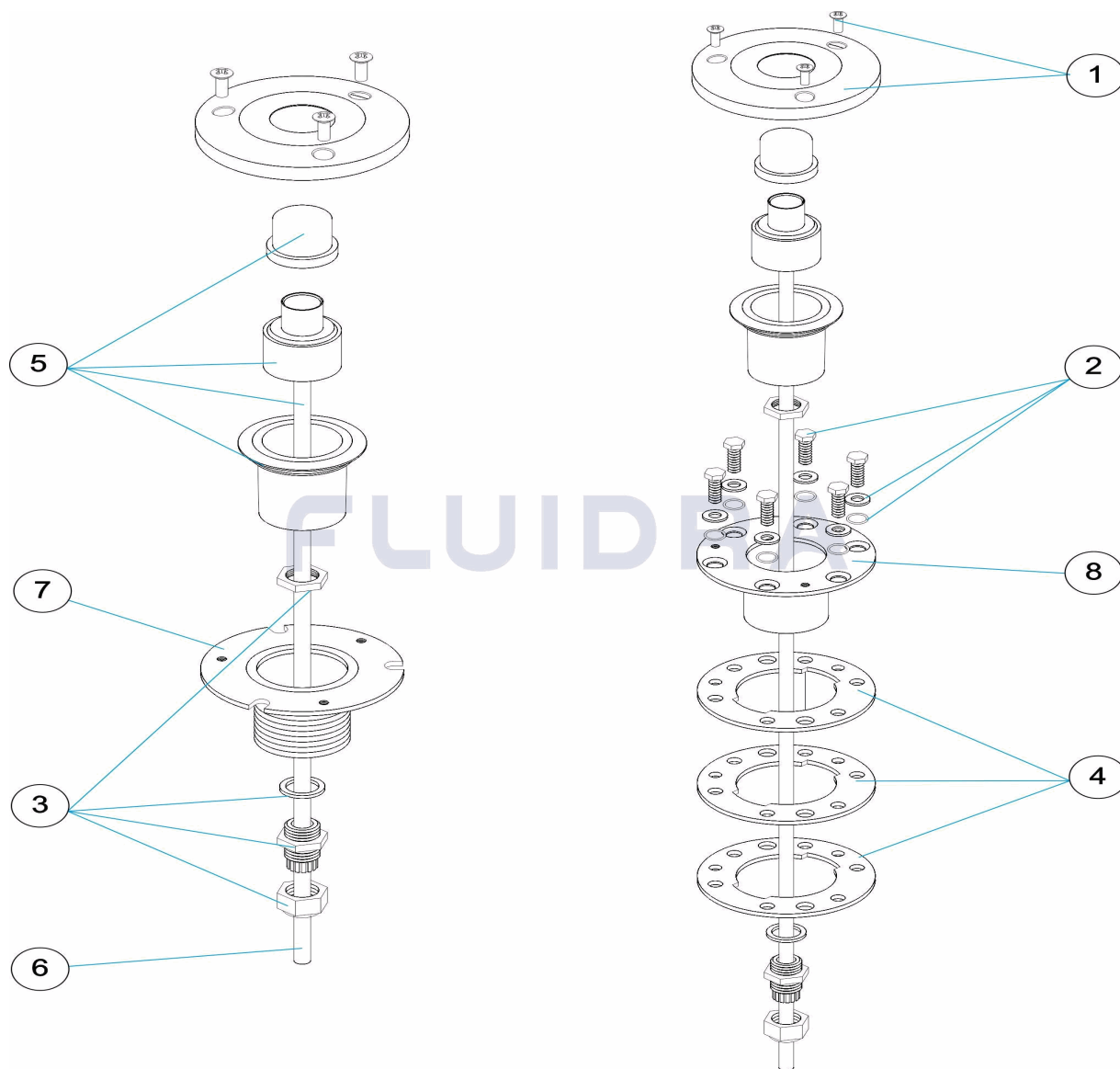

ITALIANO

| POS | CODICE | DESCRIZIONE | QUANTITA' | POS | CODICE | DESCRIZIONE | QUANTITA' |
|-----|--------------|---------------------------|-----------|-----|--------------|--------------------------------|-----------|
| 1 | 4402050301 | COPERCHIO PULSANTE | | 5 | 4402050119 | PULSANTE COMPLETO | |
| 2 | * 4402050302 | VITI FISSAGGIO BASE LINER | | 6 | 00241R0404 | QUADRO MANOVRA X MTS 5 M | |
| 3 | * 4402050303 | KIT PRESSACAVI | | 7 | * 16332R0100 | CORPO PULSANTE PISCINA CEMENTO | |
| 4 | * 4402050304 | GUARNIZIONI BOCCHETTA | | 8 | * 16333R0100 | CORPO PULSANTE PISCINA LINER | |

CODICE 16332, 16333

DESCRIZIONE: PULSANTE PISCINA CEMENTO E LINER

OSSERVAZIONI

| POS | CODICE | OSSERVAZIONI |
|-----|--------------|--------------|
| 2 | * 4402050302 | PER: 16333 |
| 3 | * 4402050303 | PER: 16332 |
| 4 | * 4402050304 | PER: 16333 |
| 7 | * 16332R0100 | PER: 16332 |
| 8 | * 16333R0100 | PER: 16333 |

CODE **16332, 16333**

BESCHREIBUNG: **DRUCKTASTER BETONBECKEN UND FOLIE**

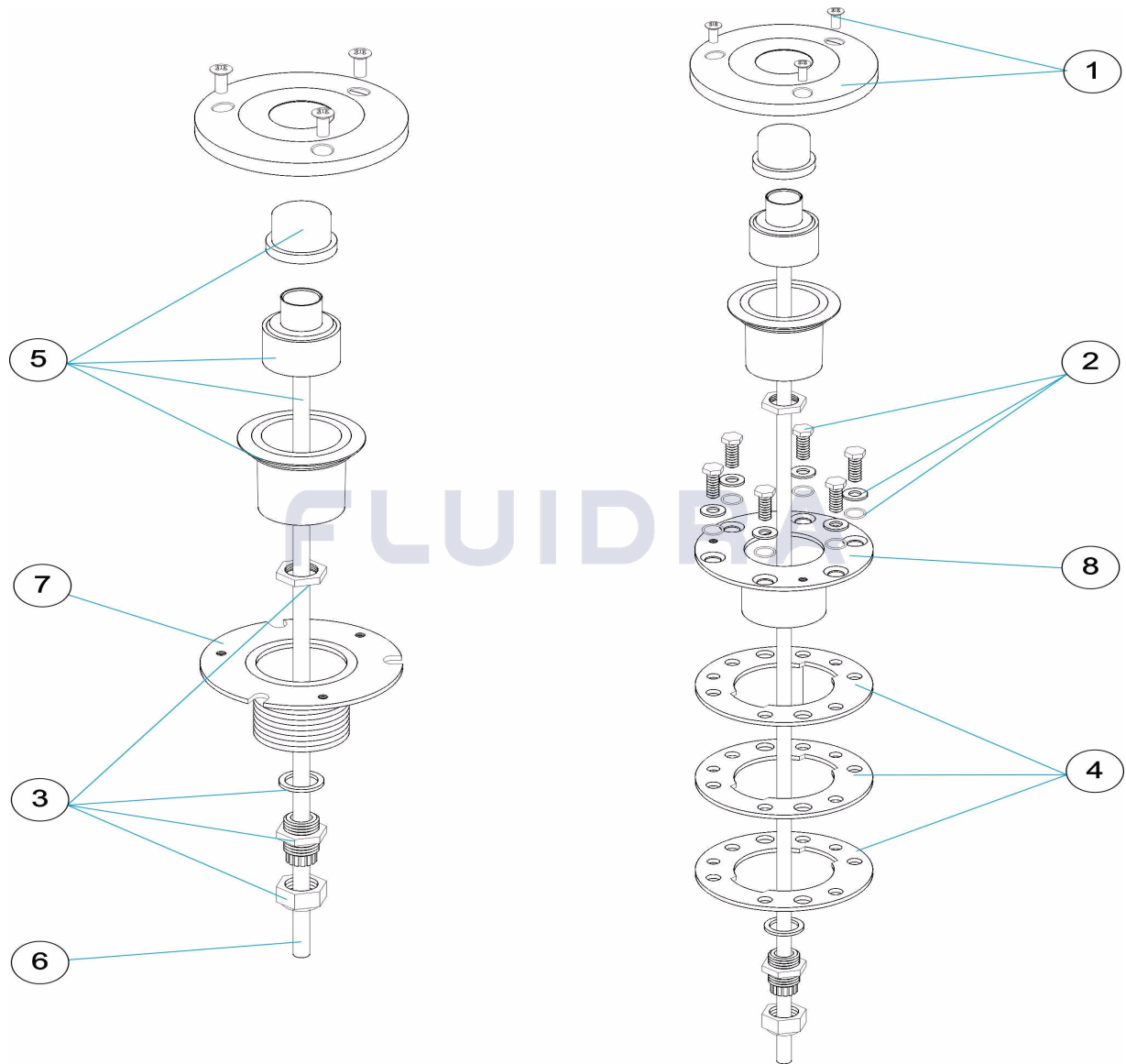

DEUTSCH

| POS | CODE | BESCHREIBUNG | MENGE | POS | CODE | BESCHREIBUNG | MENGE |
|-----|--------------|-----------------------------|-------|-----|--------------|----------------------------------|-------|
| 1 | 4402050301 | ABSCHLUSSPLATTE DRUCKTASTER | | 5 | 4402050119 | DRUCKTASTER KOMPLETT | |
| 2 | * 4402050302 | FIXIERSCHRAUBEN BASIS FOLIE | | 6 | 00241R0404 | HILFSSCHLAUCH X M | |
| 3 | * 4402050303 | SET QUETSCHVERSCHRAUBUNG | | 7 | * 16332R0100 | GEHÄUSE DRUCKTASTER BETONBECKEN | |
| 4 | * 4402050304 | DICHTUNGEN DÜSE | | 8 | * 16333R0100 | GEHÄUSE DRUCKTASTER FOLIENBECKEN | |

CODE **16332, 16333**

BESCHREIBUNG: **DRUCKTASTER BETONBECKEN UND FOLIE**

HINWEISE

| POS | CODE | HINWEISE |
|-----|--------------|------------|
| 2 | * 4402050302 | FÜR: 16333 |
| 3 | * 4402050303 | FÜR: 16332 |
| 4 | * 4402050304 | FÜR: 16333 |
| 7 | * 16332R0100 | FÜR: 16332 |
| 8 | * 16333R0100 | FÜR: 16333 |

CODIGO **16332, 16333**

DESCRIÇÃO: **TORNEIRA PISCINA BETÃO E LINER**

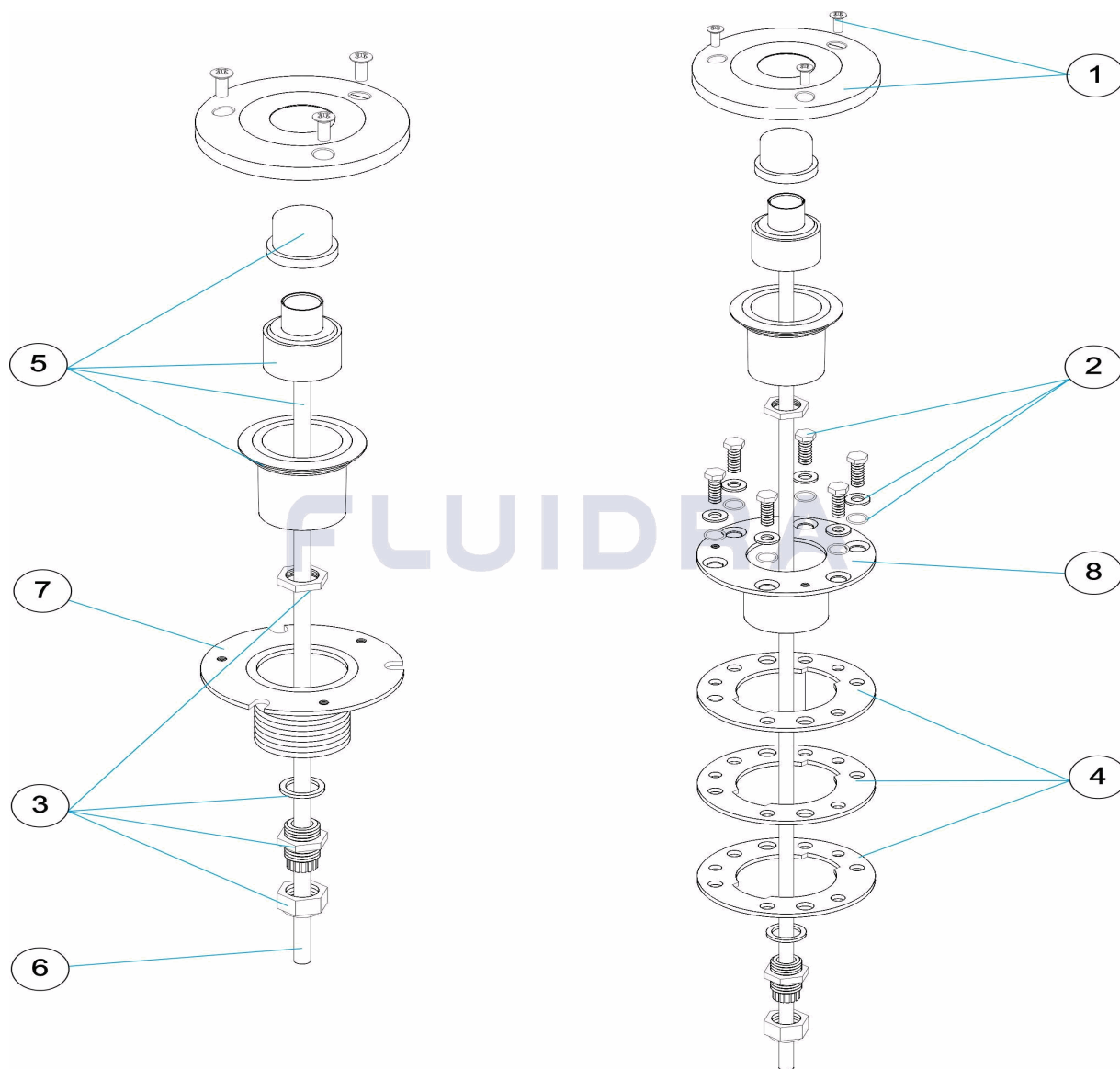

PORTUGUES

| POS | CODIGO | DESCRIÇÃO | JANTIDADE | POS | CODIGO | DESCRIÇÃO | JANTIDADE |
|-----|--------------|------------------------------------|-----------|-----|--------------|------------------------------|-----------|
| 1 | 4402050301 | PROTECÇÃO PULSADOR | | 5 | 4402050119 | PURSÁTIL COMPLETO | |
| 2 | * 4402050302 | PARAFUSOS DE FIXAÇÃO DA BASE LINER | | 6 | 00241R0404 | TUBO DE MANOBRA X MTS. | |
| 3 | * 4402050303 | CONJ.CAIXA DE VEDAÇÃO | | 7 | * 16332R0100 | CORPO PULSADOR PISCINA BETÃO | |
| 4 | * 4402050304 | JUNTAS DA BOCA | | 8 | * 16333R0100 | CORPO PULSADOR PISCINA LINER | |

CODIGO **16332, 16333**

DESCRIÇÃO: **TORNEIRA PISCINA BETÃO E LINER**

OBSERVAÇÕES

| POS | CODIGO | OBSERVAÇÕES |
|-----|--------------|-------------|
| 2 | * 4402050302 | PARA: 16333 |
| 3 | * 4402050303 | PARA: 16332 |
| 4 | * 4402050304 | PARA: 16333 |
| 7 | * 16332R0100 | PARA: 16332 |
| 8 | * 16333R0100 | PARA: 16333 |