

CODIGO **27354, 27355, 27356, 27357, 27358, 32464**

DESCRIPCION: **EQUIPOS AUTOMATICOS DE REGULACION Y CONTROL**

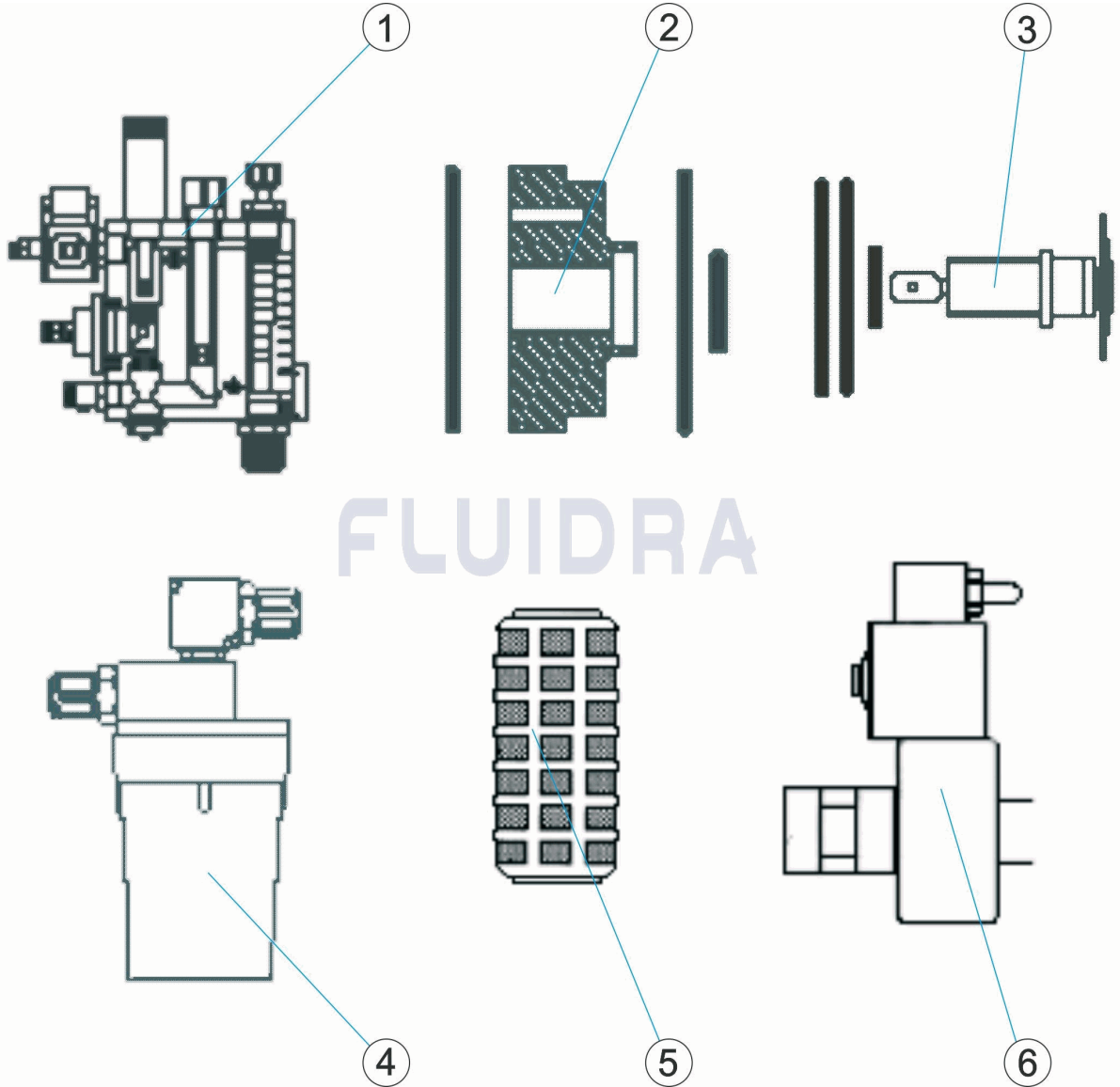

ESPAÑOL

POS	CODIGO	DESCRIPCION	CANTIDAD	POS	CODIGO	DESCRIPCION	CANTIDAD
1	57142R0005	PROBETA PH CLORINA	7	57144R0100	CENTRALITA KONTROL 800 CL		
1	57144R0000	PROVETA CL	7	57143R0100	CENTRALITA KONTROL 800 PH-RX-CL		
1	57141R0000	PROVETA PH - REDOX	7	27358R0002	CENTRALITA PR-75 AT		
2	27354R0014	ELECTRODO DE CU	8	56109R0005	SENSOR PH 0-14		
3	27354R0005	ELECTRODO PT	9	27883R0009	PORTASONDAS EN PVC MAXIMA TEM		
4	27354R0006	VASO PORTAFILTRO	10	70948	SOLUCION TAMPON PH 7		
5	27354R0019	FILTRO LAVABLE	11	70947	SOLUCION TAMPON PH 4		
6	27354R0009	ELECTROVALVULA SERIE KONTROL	12	70950	SOLUCION TAMPON RX 465MV		
7	27354R0004	CENTRALITA PR 95	13	56109R0006	SENSOR ORP		

CODE **27354, 27355, 27356, 27357, 27358, 32464**

DESCRIPTION: **DISPOSITIFS AUTOMATIQUES DE RÉGULATION ET CONTRÔLE**

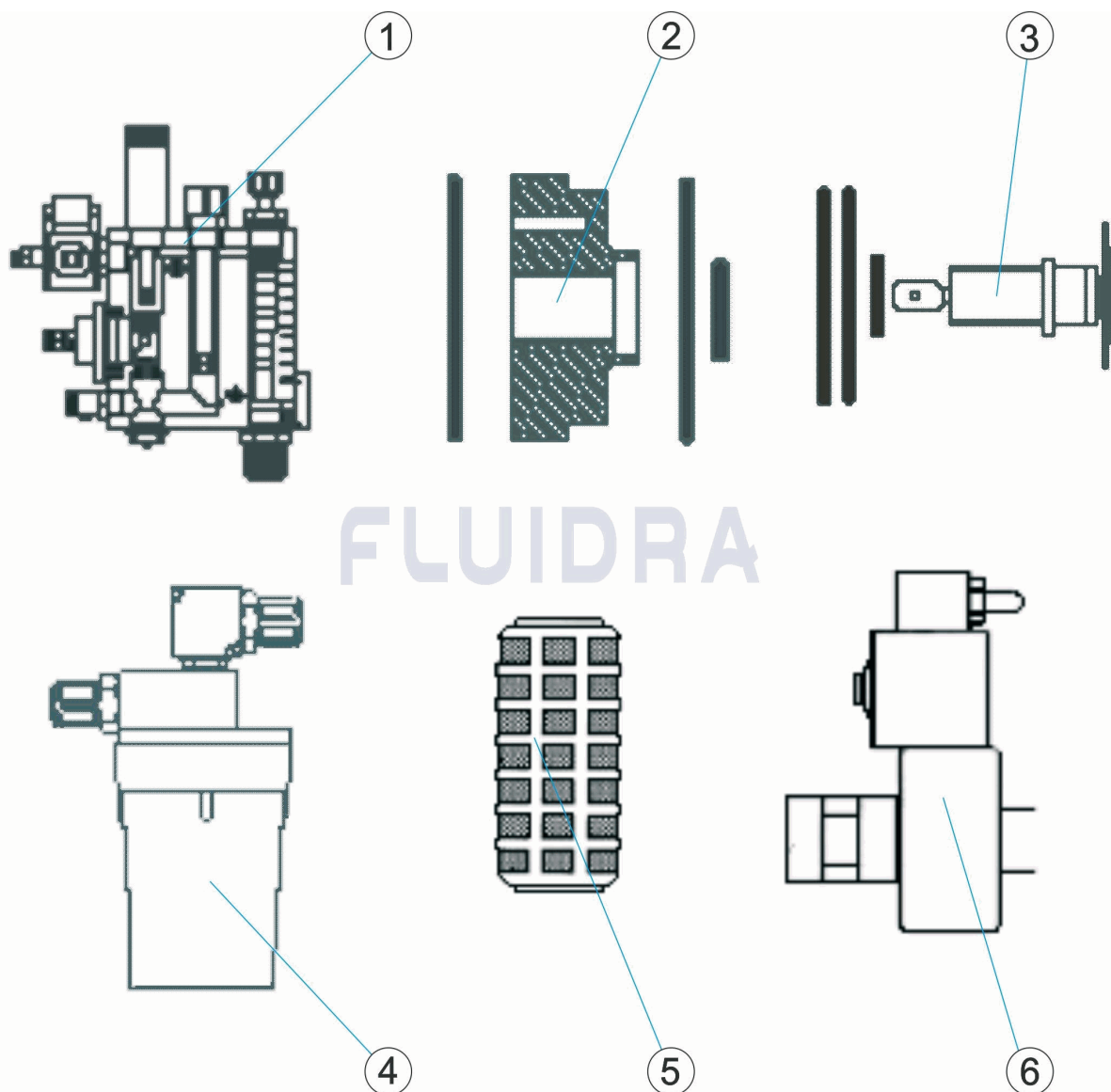

FRANCAIS

POS	CODE	DESCRIPTION	QUANTITE	POS	CODE	DESCRIPTION	QUANTITE
1	57142R0005	ÉPROUVETTE PH CHLORE		7	57144R0100	BOÎTIER DE COMMANDE KONTROL 800 CL	
1	57144R0000	CYLINDRE CL		7	57143R0100	BOÎTIER DE COMMANDE KONTROL 800 PH	
1	57141R0000	CYLINDRE PH-RX		7	27358R0002	TABEAU DE COMMANDES PR-75 AT	
2	27354R0014	ÉLECTRODE EN CU		8	56109R0005	SONDE PH 0-14	
3	27354R0005	ÉLECTRODE PT		9	27883R0009	SUPPORT ELECTRODE	
4	27354R0006	VASE PORTE-FILTRE		10	70948	TAMPON PH 7	
5	27354R0019	FILTRE LAVABLE		11	70947	TAMPON PH 4	
6	27354R0009	ÉLECTROVANNE SÉRIE KONTROL		12	70950	TAMPON RX 465MV	
7	27354R0004	TABEAU DE COMMANDES PR 95		13	56109R0006	SONDE ORP	

CODE **27354, 27355, 27356, 27357, 27358, 32464**

DESCRIPTION: **AUTOMATIC REGULATION AND CONTROL EQUIPMENT**

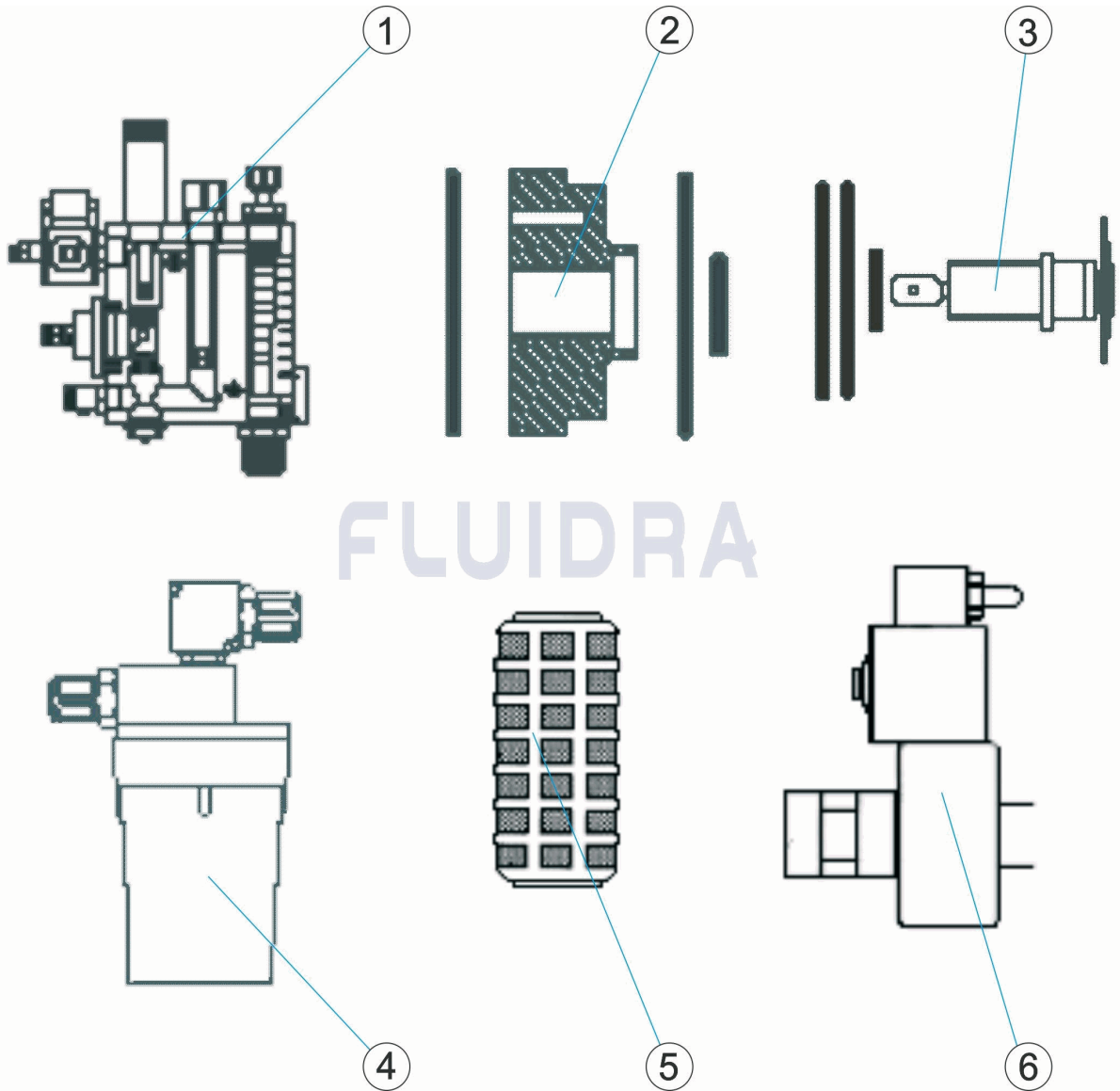

ENGLISH

POS	CODE	DESCRIPTION	QUANTITY	POS	CODE	DESCRIPTION	QUANTITY
1	57142R0005	PH AND CHLORINE PROBE HOLDER		7	57144R0100	KONTROL 800 CL ASTRAL	
1	57144R0000	MODULAR PROBE HOLDERPH AND CL		7	57143R0100	KONTROL 800 PH-RX-CL ASTRAL	
1	57141R0000	MODULAR PROBE HOLDER PH AND REDO		7	27358R0002	CONTROL BOARD PR-75 AT	
2	27354R0014	CU ELECTRODE		8	56109R0005	PH SENSOR 0-14	
3	27354R0005	PT ELECTRODE		9	27883R0009	ELECTRODE HOLDER	
4	27354R0006	FILTER HOLDER CUP		10	70948	CALIBRATION SOLUTION PH 7	
5	27354R0019	WASHABLE FILTER		11	70947	CALIBRATION SOLUTION PH 4	
6	27354R0009	KONTROL SERIES ELECTROVALVE		12	70950	CALIBRATION SOLUTION RX 465MV	
7	27354R0004	CONTROL BOARD PR 95		13	56109R0006	ORP SENSOR	

CODICE 27354, 27355, 27356, 27357, 27358, 32464

DESCRIZIONE: ATTREZZATURA AUTOMATICA DI REGOLAZIONE E CONTROLLO

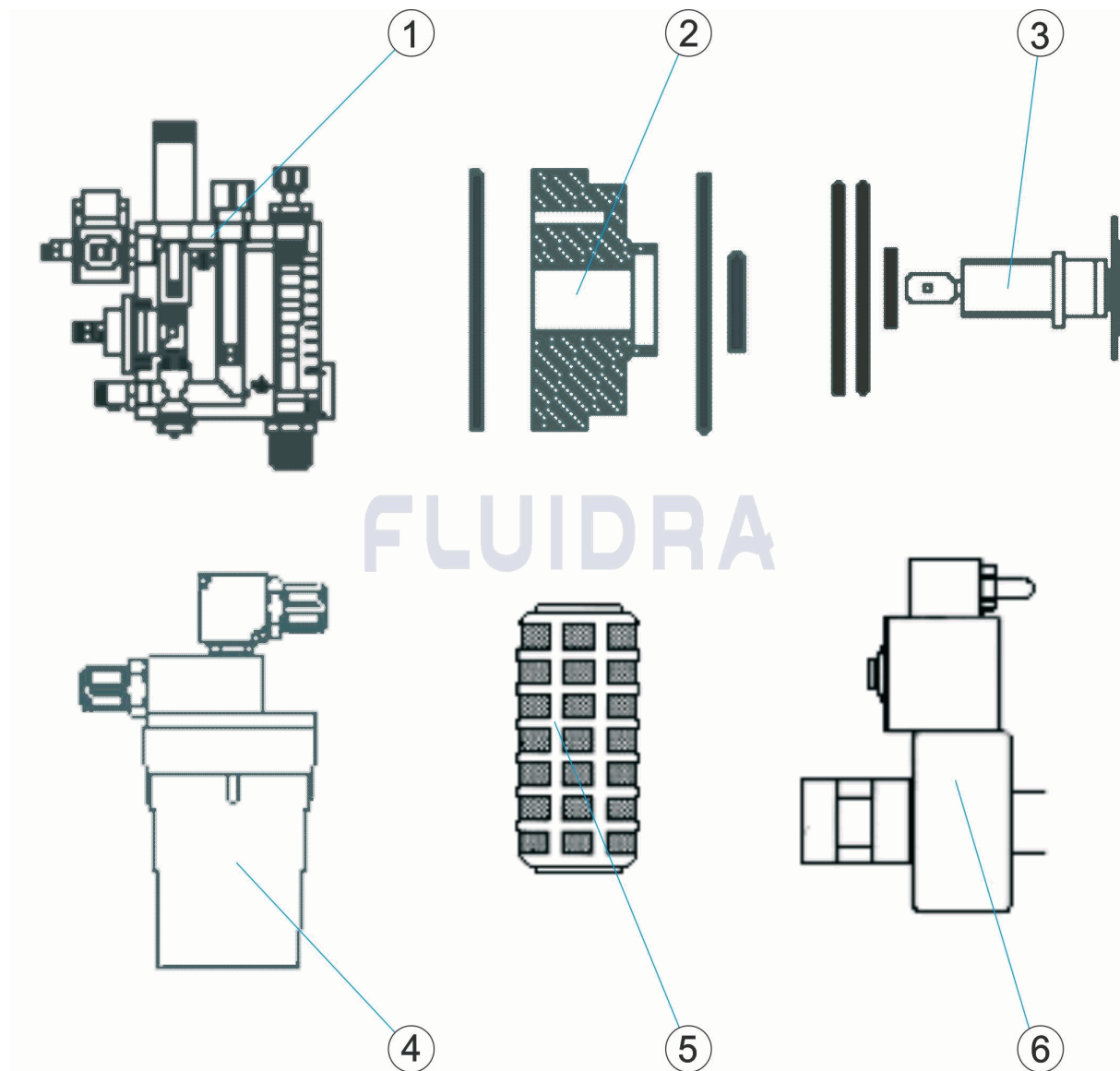

ITALIANO

POS	CODICE	DESCRIZIONE	QUANTITA'	POS	CODICE	DESCRIZIONE	QUANTITA'
1	57142R0005	PROVETTA PH CLORO		7	57144R0100	CENTRALINA KONTROL 800 CL	
1	57144R0000	CILINDRO CL		7	57143R0100	CENTRALINA KONTROL 800 PH-CL-RX	
1	57141R0000	CILINDRO PH-RX		7	27358R0002	CENTRALINA PR-75 AT	
2	27354R0014	ELETTRODO DI CU		8	56109R0005	SONDA PH 0-14	
3	27354R0005	ELETTRODO PT		9	27883R0009	SUPPORTO ELETTRODO	
4	27354R0006	VASO PORTAFILTRO		10	70948	SOLUCIONE TAMPONE PH 7	
5	27354R0019	FILTRO LAVABILE		11	70947	SOLUCIONE TAMPONE PH 4	
6	27354R0009	ELETTROVALVOLA SERIE KONTROL		12	70950	SOLUCIONE TAMPONE RX 465MV	
7	27354R0004	CENTRALINA PR 95		13	56109R0006	SONDA ORP	

CODE **27354, 27355, 27356, 27357, 27358, 32464**

BESCHREIBUNG: **GERÄTE ZUR AUTOMATISCHEN REGELUNG UND STEUERUNG**

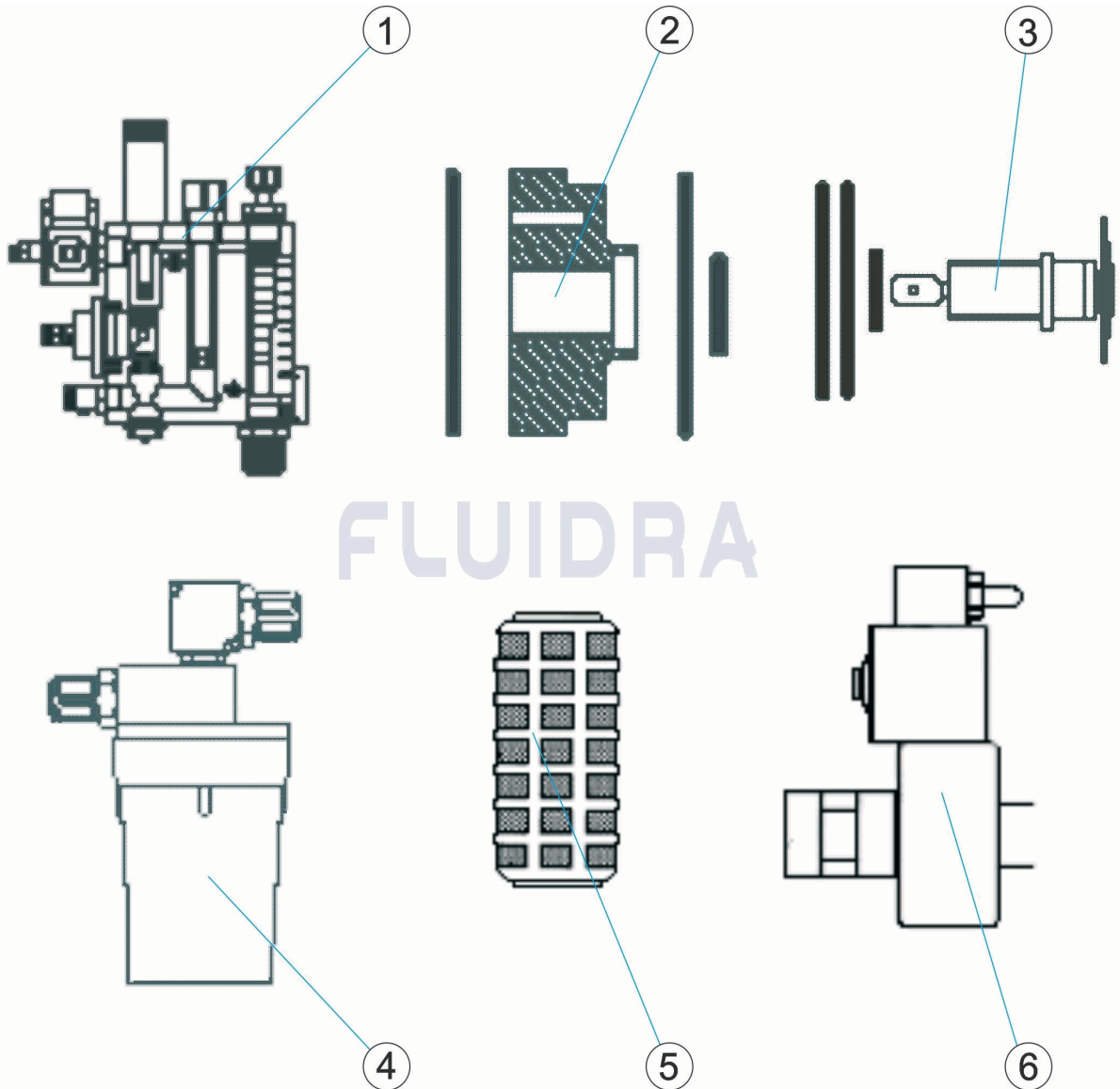

DEUTSCH

POS	CODE	BESCHREIBUNG	MENGE	POS	CODE	BESCHREIBUNG	MENGE
1	57142R0005	PRÜFSTAB PH CHOLR		7	57144R0100	STEUERUNG KONTROL 800 CL	
1	57144R0000	PRÜFSTAB CL		7	57143R0100	STEUERUNG KONTROL 800 PH-RX-CL	
1	57141R0000	PRÜFSTAB PH-REDOX		7	27358R0002	STEUERUNG PR-75 AT	
2	27354R0014	ELEKTRODE CU		8	56109R0005	PH-MESSER 0-14	
3	27354R0005	ELEKTRODE PT		9	27883R0009	SONDENHALTERUNG AUS PVC MAXIMA TE	
4	27354R0006	FILTERGEHÄUSE		10	70948	PUFFERLÖSUNG PH 7	
5	27354R0019	FILTER WASCHBAR		11	70947	PUFFERLÖSUNG PH 4	
6	27354R0009	ELEKTROVENTIL SERIE KONTROL		12	70950	PUFFERLÖSUNG RX 465MV	
7	27354R0004	STEUERUNG PR 95		13	56109R0006	ORP-MESSER	

CODIGO 27354, 27355, 27356, 27357, 27358, 32464

DESCRICÃO: EQUIPAMENTOS AUTOMÁTICOS DE REGULAÇÃO E CONTROLO

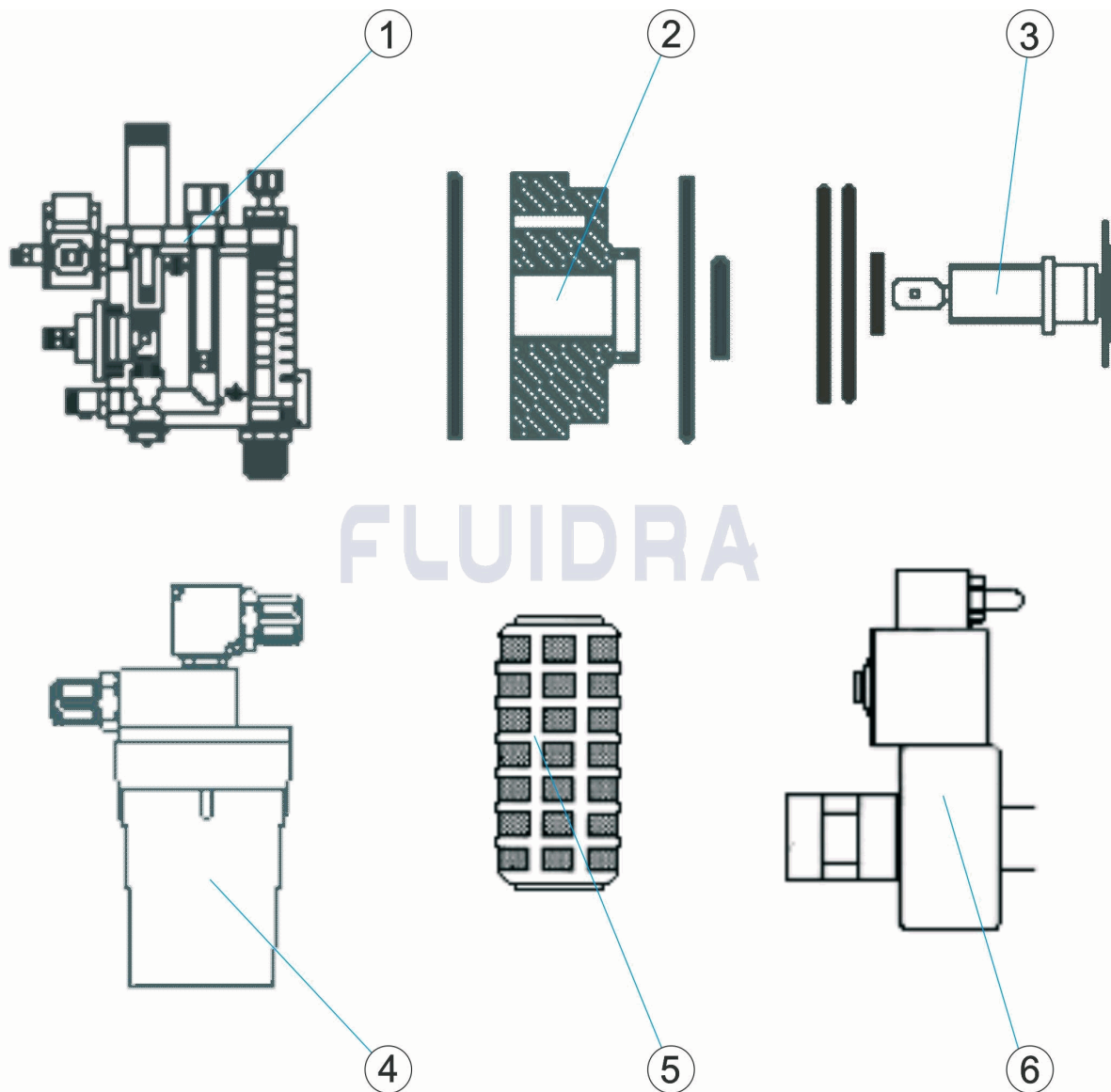

FLUIDRA

PORTUGUES

POS	CODIGO	DESCRICÃO	JANTIDADE	POS	CODIGO	DESCRICÃO	JANTIDADE
1	57142R0005	PROVETA PH CLORO		7	57144R0100	UNIDADE DE CONTROLO CENTRAL KONTR	
1	57144R0000	CILINDRO CL		7	57143R0100	UNIDADE DE CONTROLO CENTRAL KONTR	
1	57141R0000	CILINDRO PH-RX		7	27358R0002	CENTRAL DE COCOMANDO PR 75 AT	
2	27354R0014	ELÉCTRODO DE CU		8	56109R0005	SONDA PH 0-14	
3	27354R0005	ELÉCTRODO PT		9	27883R0009	SUPORTE ELECTRODO	
4	27354R0006	COPO PORTA-FILTRO		10	70948	SOLUÇÃO TAMPÃO PH 7	
5	27354R0019	FILTRO LAVÁVEL		11	70947	SOLUÇÃO TAMPÃO PH 4	
6	27354R0009	ELECTROVÁLVULA SÉRIE KONTRON		12	70950	SOLUÇÃO TAMPÃO RX 465MV	
7	27354R0004	CENTRAL DE COCOMANDO PR 95		13	56109R0006	SONDA ORP	