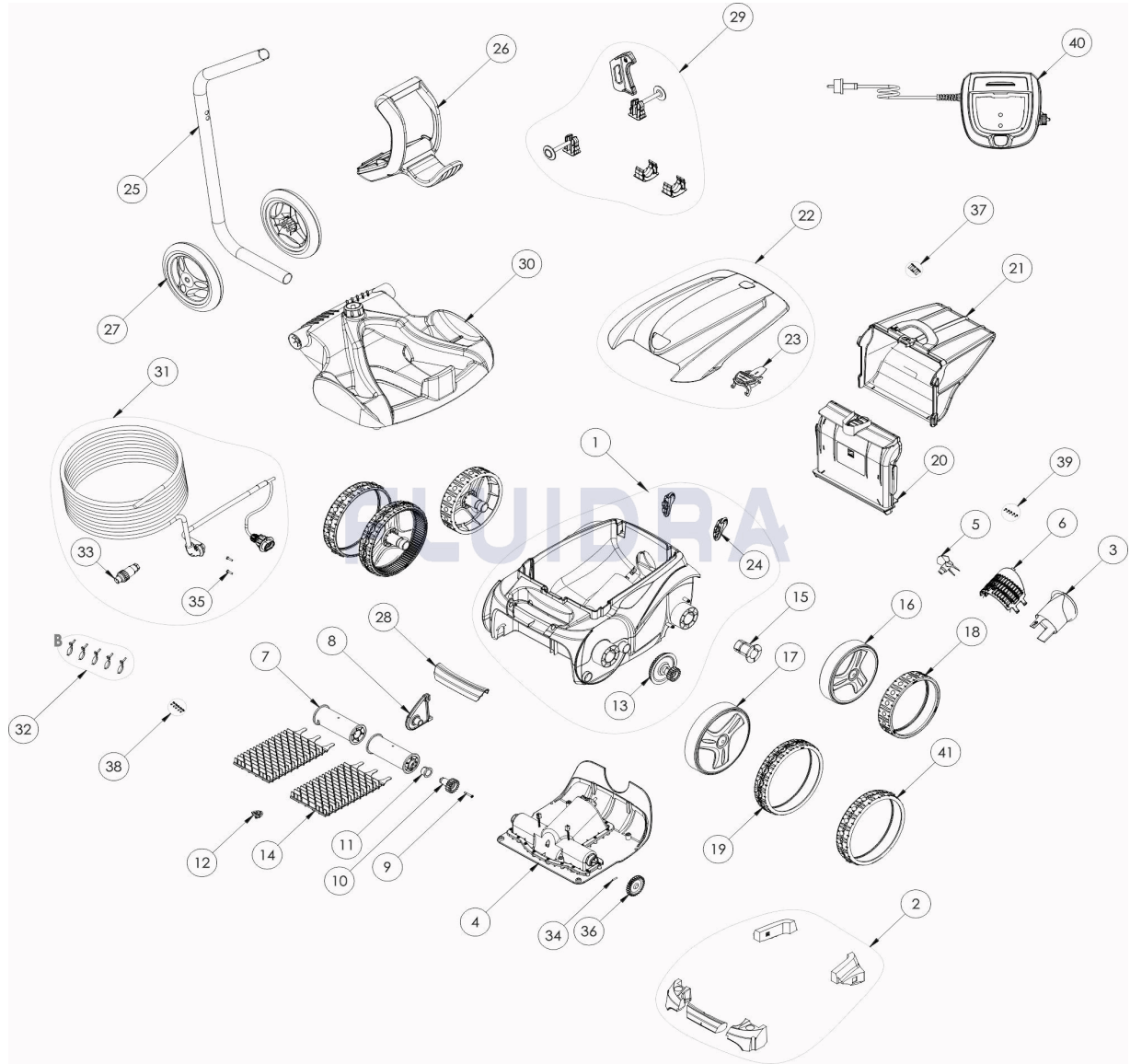

CODIGO **WR000072**

 DESCRIPCION: **OV 3450**

ESPAÑOL

| POS | CODIGO | DESCRIPCION | CANTIDAD | POS | CODIGO | DESCRIPCION | CANTIDAD |
|-----|----------|-----------------------------------|----------|-----|----------|------------------------------------|----------|
| 1 | R0589102 | CUERPO COMPLETO 2WD II GRIS | 1 | 16 | R0636102 | LLANTA PEQUEÑA GRIS ZODIAC | 1 |
| 2 | R0539700 | FLOTADOR | 1 | 17 | R0636003 | LLANTA GRANDE GRIS ZODIAC | 1 |
| 3 | R0517500 | CANALIZADOR DE FLUJO | 1 | 18 | R0636300 | CUBIERTA DE RUEDA TRASERA NEGRA ZO | 1 |
| 4 | R0637800 | BLOQUE MOTOR TIPO A | 1 | 19 | R0636201 | CUBIERTA GD NEGRA ZODIAC | 1 |
| 5 | R0517000 | HÉLICE | 1 | 20 | R0517700 | SOPORTE FILTRO | 1 |
| 6 | R0517600 | MALLA PROTECCIÓN | 1 | 21 | R0636600 | FILTRO RESIDUOS FINOS 100µ V | 1 |
| 7 | R0517400 | RODILLO PORTACEPILLOS (Pack 2 UN) | 1 | 22 | R0713600 | TAPA DELANTERA GRIS PMS7712 | 1 |
| 8 | R0518702 | SOPORTE CENTRAL RODILLOS GRIS | 1 | 23 | R0638701 | CIERRE TAPA PMS7712 | 1 |
| 9 | R0638900 | TORNILLO 4*25 MM (Pack 5 UN) | 1 | 24 | R0518100 | PARACHOQUES CON RUEDAS (Pack 2 UN) | 1 |
| 10 | R0639000 | PIÑÓN 17 DIENTES (Pack 2 UN) | 1 | 25 | R0565200 | TUBO CARRO DE TRANSPORTE | 1 |
| 11 | R0639100 | CASQUILLO EXTERIOR (Pack 2 UN) | 1 | 26 | R0565000 | EMPUÑADURA CARRO DE TRANSPORTE | 1 |
| 12 | R0519000 | RAMPA | 1 | 27 | R0565100 | RUEDAS CARRO DE TRANSPORTE (Pack 2 | 1 |
| 13 | R0517200 | CJTO. TRANSMISIÓN | 1 | 28 | R0540402 | EMPUÑADURA GRIS | 1 |

CODIGO **WR000072**DESCRIPCION: **OV 3450**

| | | | | | | | |
|----|----------|-------------------------------------|---|----|----------|----------------------------------|---|
| 14 | R0635903 | CEPILLOS ZODIAC (Pack 2 UN) | 1 | 29 | R0564900 | KIT ACCESORIOS CARRO | 1 |
| 15 | R0636700 | CASQUILLO COJINETE RUEDA ZODIAC | 1 | 30 | R0564800 | BASE CARRO DE TRANSPORTE | 1 |
| 31 | R0516800 | CABLE FLOTANTE 18M | 1 | 36 | R0518800 | PIÑÓN 27 DIENTES (Pack 2 UN) | 1 |
| 32 | R0567900 | ABRAZADERAS CABLE FLOTANTE (Pack 5 | 1 | 37 | R0516700 | TORNILLO 4*12 MM (PACK DE 5 UN.) | 1 |
| 33 | R0565600 | CONECTOR DE CABLE 4 PINS | 1 | 38 | R0639200 | TORNILLO 2.9*9.5 MM (Pack 5 UN) | 1 |
| 34 | R0567800 | CLIP FIJADOR 3*16 MM (Pack 5 UN) | 1 | 39 | R0564500 | TORNILLO 2,2*6,5 MM (5 UN.) | 1 |
| 35 | R0608500 | TORNILLO 4*16 MM (PACK DE 5 UN | 1 | 40 | R0713300 | UNIDAD DE CONTROL TIPO 9V | 1 |

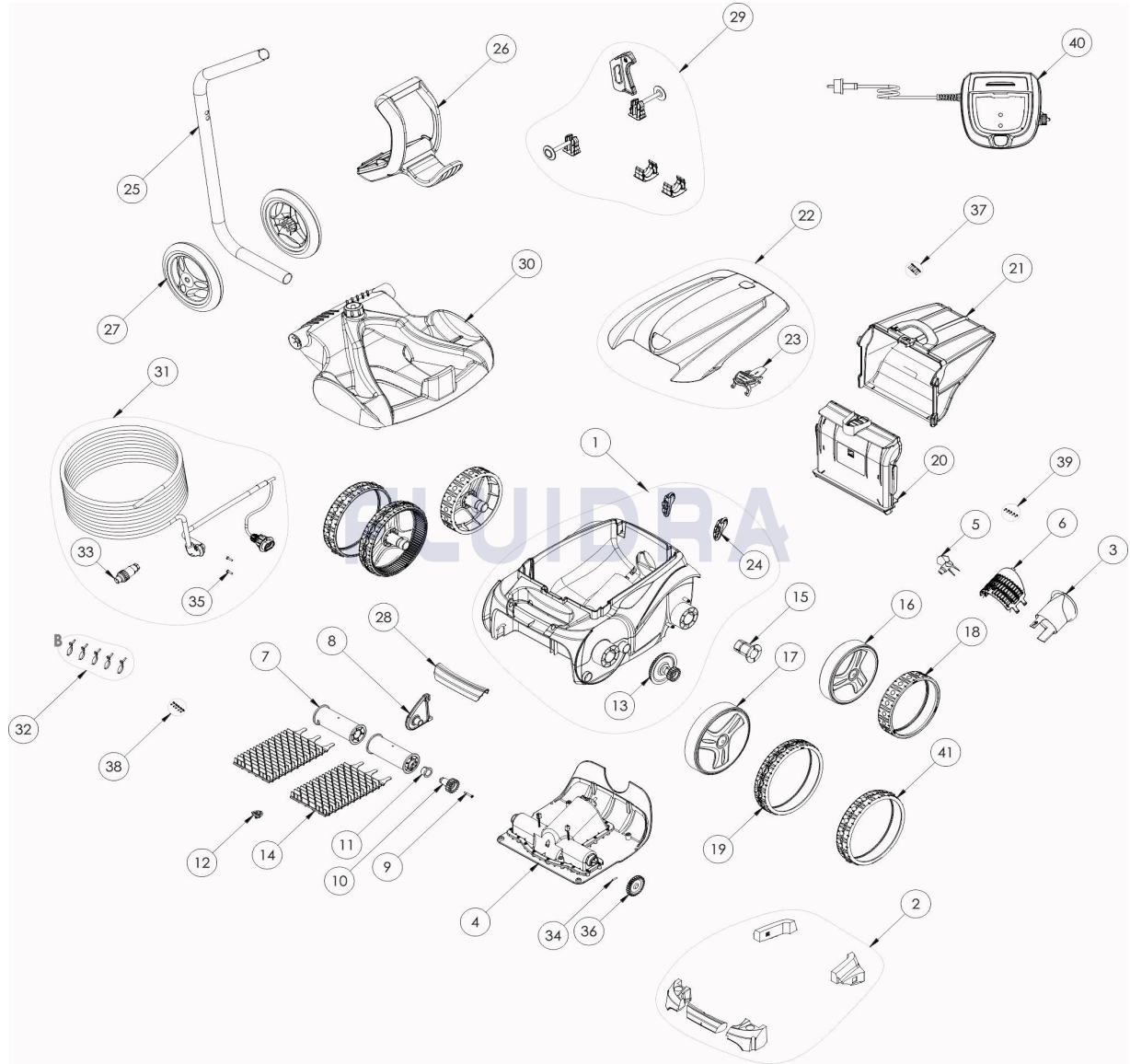
CODE **WR000072**

 DESCRIPTION: **OV 3450**

FRANCAIS

| POS | CODE | DESCRIPTION | QUANTITE | POS | CODE | DESCRIPTION | QUANTITE |
|-----|----------|--------------------------|----------|-----|----------|---------------------------|----------|
| 1 | R0589102 | COQUE CPLTE 2WD II GRISE | 1 | 16 | R0636102 | JANTE PETITE GRISE ZODIAC | 1 |
| 2 | R0539700 | FLOTTEUR COMPLET | 1 | 17 | R0636003 | JANTE GDE GRISE ZODIAC | 1 |
| 3 | R0517500 | GUIDE FLUX | 1 | 18 | R0636300 | BANDAGE ARR NOIR ZODIAC | 1 |
| 4 | R0637800 | BLOC MOTEUR TYPE A | 1 | 19 | R0636201 | BANDAGE GD NOIR ZODIAC | 1 |
| 5 | R0517000 | HELICE V | 1 | 20 | R0517700 | SUPPORT FILTRE V | 1 |
| 6 | R0517600 | GRILLE MOTEUR | 1 | 21 | R0636600 | FILTRE DEBRIS FIN 100µ V | 1 |
| 7 | R0517400 | SUPPORT BROSE (* 2) | 1 | 22 | R0713600 | TRAPPE GRISE PMS7712 | 1 |
| 8 | R0518702 | PONTET BROSE GRIS | 1 | 23 | R0638701 | VERROU TRAPPE PMS7712 | 1 |
| 9 | R0638900 | VIS 4*25 MM (*5) | 1 | 24 | R0518100 | BUMPER A ROULETTE(*2) | 1 |
| 10 | R0639000 | PIGNON 17 DENTS (*2) | 1 | 25 | R0565200 | TUBE CHARIOT | 1 |
| 11 | R0639100 | PALIER EXTERIEUR (*2) | 1 | 26 | R0565000 | POIGNEE CHARIOT | 1 |
| 12 | R0519000 | RAMPE | 1 | 27 | R0565100 | ROUES CHARIOT (*2) | 1 |
| 13 | R0517200 | TRANSMISSION | 1 | 28 | R0540402 | POIGNEE GRISE | 1 |

CODE **WR000072**DESCRIPTION: **OV 3450**

| | | | | | | | |
|----|----------|-------------------------------------|---|----|----------|---------------------------|---|
| 14 | R0635903 | BROSSE TYPE 1 PMS7712 ZODIAC (*2) | 1 | 29 | R0564900 | PIECES ACCESSOIRE CHARIOT | 1 |
| 15 | R0636700 | PALIER ROUE ZODIAC | 1 | 30 | R0564800 | EMBASE CHARIOT | 1 |
| 31 | R0516800 | CABLE FLOTTANT 18M | 1 | 36 | R0518800 | PIGNON 27 DENTS (*2) | 1 |
| 32 | R0567900 | LIEN SERRAGE CABLE FLOTT (*5) | 1 | 37 | R0516700 | VIS 4*12 MM (X5) | 1 |
| 33 | R0565600 | CONNECTEUR 4 PTS | 1 | 38 | R0639200 | VIS 2.9*9.5 MM (*5) | 1 |
| 34 | R0567800 | GOUPILLE 3*16 MM (*5) | 1 | 39 | R0564500 | VIS 2,2*6,5 MM (X5) | 1 |
| 35 | R0608500 | VIS 4*16 MM A4 (*5) | 1 | 40 | R0713300 | COFFRET COMMANDE TYPE 9V | 1 |

CODE **WR000072**

DESCRIPTION: **OV 3450**

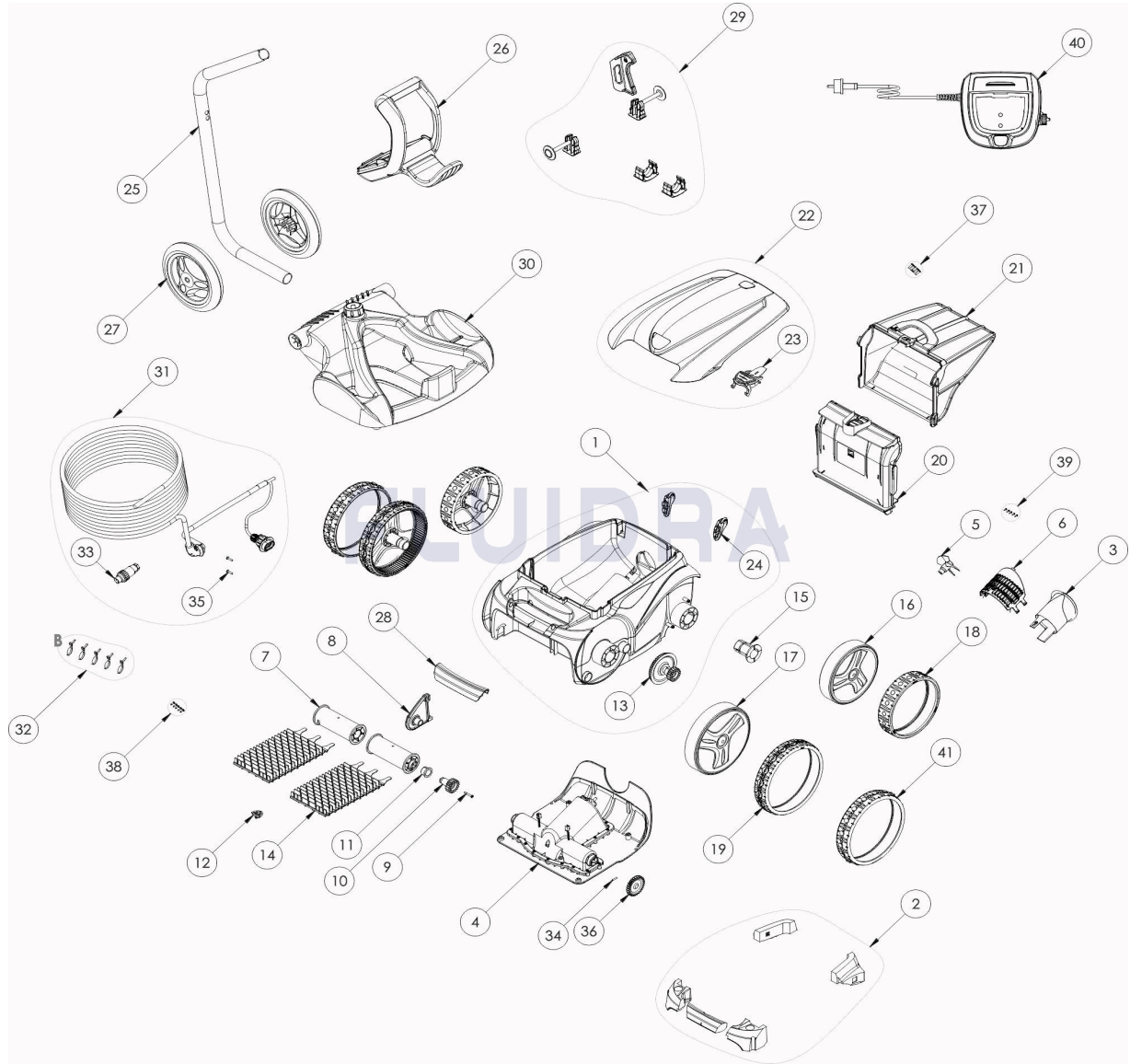

ENGLISH

| POS | CODE | DESCRIPTION | QUANTITY | POS | CODE | DESCRIPTION | QUANTITY |
|-----|----------|--------------------------|----------|-----|----------|--------------------------|----------|
| 1 | R0589102 | MAIN BODY 2WD II GREY | 1 | 16 | R0636102 | RIM REAR GREY ZODIAC | 1 |
| 2 | R0539700 | FLOAT | 1 | 17 | R0636003 | RIM LARGE GREY ZODIAC | 1 |
| 3 | R0517500 | FLOW OUTLET | 1 | 18 | R0636300 | TIRE REAR BLACK ZODIAC | 1 |
| 4 | R0637800 | MOTOR BLOCK TYPE A | 1 | 19 | R0636201 | TIRE LARGE BLACK ZODIAC | 1 |
| 5 | R0517000 | PROPELLER | 1 | 20 | R0517700 | FILTER CANISTER SUPPORT | 1 |
| 6 | R0517600 | MOTOR SCREEN | 1 | 21 | R0636600 | FINE FILTER V | 1 |
| 7 | R0517400 | BRUSH ROLLER | 1 | 22 | R0713600 | COVER GREY PMS7712 | 1 |
| 8 | R0518702 | ROLLER SUPPORT GREY | 1 | 23 | R0638701 | COVER LATCH GRIP PMS7712 | 1 |
| 9 | R0638900 | SCREW 4*25 MM (SET OF 5) | 1 | 24 | R0518100 | ROLLER (SET OF 2) | 1 |
| 10 | R0639000 | 17 GEAR (*2) | 1 | 25 | R0565200 | TROLLEY TUBE | 1 |
| 11 | R0639100 | OUTER BEARING (*2) | 1 | 26 | R0565000 | TROLLEY HANDLE | 1 |
| 12 | R0519000 | RAMPE | 1 | 27 | R0565100 | TROLLEY WHEELS (*2) | 1 |
| 13 | R0517200 | TRANSMISSION | 1 | 28 | R0540402 | HANDLE GREY | 1 |

CODE **WR000072**DESCRIPTION: **OV 3450**

| | | | | | | | |
|----|----------|----------------------------------|---|----|----------|-----------------------------|---|
| 14 | R0635903 | BRUSH TYPE 1 PMS7712 ZODIAC (*2) | 1 | 29 | R0564900 | TROLLEY ACCESSORIES | 1 |
| 15 | R0636700 | WHEEL BUSHING ZODIAC | 1 | 30 | R0564800 | TROLLEY BASE | 1 |
| 31 | R0516800 | FLOATING CABLE 18M | 1 | 36 | R0518800 | DRIVE GEAR (SET OF 2) | 1 |
| 32 | R0567900 | FLOATING CABLE CLAMP (SET OF 5) | 1 | 37 | R0516700 | SCREWS 4*12 MM (X5) | 1 |
| 33 | R0565600 | FLOATING CABLE PLUG | 1 | 38 | R0639200 | SCREW 2.9*9.5 MM (SET OF 5) | 1 |
| 34 | R0567800 | MOTOR BLOCK SHAFT PIN (SET OF 5) | 1 | 39 | R0564500 | SCREWS 2,2*6,5 MM (X5) | 1 |
| 35 | R0608500 | SCREW 4*16MM (set of 5) | 1 | 40 | R0713300 | CONTROL UNIT TYPE 9V | 1 |

CODICE **WR000072**

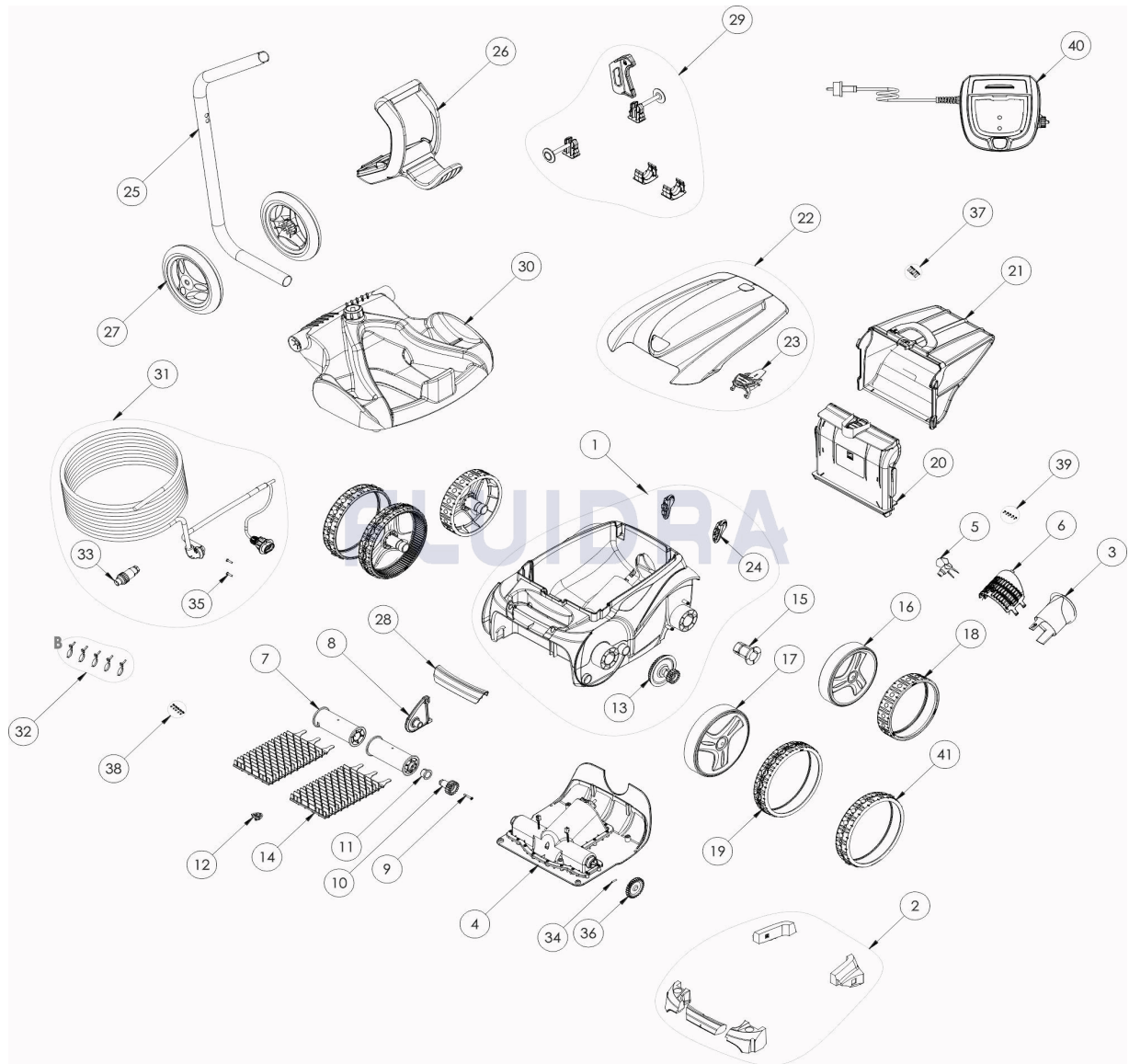
 DESCRIZIONE: **OV 3450**

ITALIANO

| POS | CODICE | DESCRIZIONE | QUANTITA' | POS | CODICE | DESCRIZIONE | QUANTITA' |
|-----|----------|-------------------------------|-----------|-----|----------|----------------------------------|-----------|
| 1 | R0589102 | SCOCCA COMPLETA 2WD II GRIGIA | 1 | 16 | R0636102 | CERCHIO PICCOLO GRIGIO ZODIAC | 1 |
| 2 | R0539700 | FLOTTANTE COMPLETO | 1 | 17 | R0636003 | CERCHIO GRANDE GRIGIO ZODIAC | 1 |
| 3 | R0517500 | GUIDA FLUSSO | 1 | 18 | R0636300 | GOMMA POSTERIORE NERA ZODIAC | 1 |
| 4 | R0637800 | BLOCCO MOTORE TIPO A | 1 | 19 | R0636201 | GOMMA GRANDE NERA ZODIAC | 1 |
| 5 | R0517000 | ELICA | 1 | 20 | R0517700 | SUPPORTO FILTRO V | 1 |
| 6 | R0517600 | GRIGLIA | 1 | 21 | R0636600 | FILTRO DETRITI SOTTILI | 1 |
| 7 | R0517400 | SUPPORTO SPAZZOLA (*2) | 1 | 22 | R0713600 | PORTELLO GRIGIA PMS7712 | 1 |
| 8 | R0518702 | PONTICELLO SPAZZOLA GRIGIA | 1 | 23 | R0638701 | BLOCCO IMPUGNATURA COPERCHIO PMS | 1 |
| 9 | R0638900 | VITE 4*25 MM (*5) | 1 | 24 | R0518100 | PARAURTI A ROTELLA (*2) | 1 |
| 10 | R0639000 | KIT 2 PIGNONE 17 DENTI | 1 | 25 | R0565200 | TUBO CARRELLO | 1 |
| 11 | R0639100 | CUSCINETTO ESTERIORE (*2) | 1 | 26 | R0565000 | MANIGLIA CARRELLO | 1 |
| 12 | R0519000 | RAMPE | 1 | 27 | R0565100 | RUOTE CARRELLO (*2) | 1 |
| 13 | R0517200 | TRASMISSIONE | 1 | 28 | R0540402 | MANIGLIA GRIGIA | 1 |

CODICE **WR000072**DESCRIZIONE: **OV 3450**

| | | | | | | | |
|----|----------|-------------------------------------|---|----|----------|--------------------------|---|
| 14 | R0635903 | SPAZZOLA TIPO 1 PMS7712 ZODIAC (*2) | 1 | 29 | R0564900 | PEZZI ACCESSORI CARRELLO | 1 |
| 15 | R0636700 | CUSCINETTO RUOTA ZODIAC | 1 | 30 | R0564800 | BASE CARRELLO | 1 |
| 31 | R0516800 | CAVO GALLEGGIANTE 18M | 1 | 36 | R0518800 | KIT 2 PIGNONE 27 DENTI | 1 |
| 32 | R0567900 | SET 5 PINZE PER FLOTTANTI | 1 | 37 | R0516700 | VITE 4*12 MM (*5) | 1 |
| 33 | R0565600 | CONNETTORE CAVO | 1 | 38 | R0639200 | KIT 5 VITI 2.9*9.5 MM | 1 |
| 34 | R0567800 | COPIGLIA 3*16 MM (*5) | 1 | 39 | R0564500 | VITE 2.2*6,5 MM (*5) | 1 |
| 35 | R0608500 | VITE 4*16 MM A4 (*5) | 1 | 40 | R0713300 | QUADRO COMANDI TIPO 9V | 1 |

CODE **WR000072**

 BESCHREIBUNG: **OV 3450**



DEUTSCH

| POS | CODE | BESCHREIBUNG | MENGE | POS | CODE | BESCHREIBUNG | MENGE |
|-----|----------|---|-------|-----|----------|--|-------|
| 1 | R0589102 | GEHÄUSE, GRAU (2WD) II | 1 | 16 | R0636102 | FELGE KLEIN, HINTEN, GRAU | 1 |
| 2 | R0539700 | SCHWIMMKÖRPER, KOMPLET EC | 1 | 17 | R0636003 | FELGE GROß, VORNE, GRAU | 1 |
| 3 | R0517500 | STRÖMUNGSDÜSE | 1 | 18 | R0636300 | HINTERREIFEN SCHWARZ | 1 |
| 4 | R0637800 | MOTORBLOCK TYP A | 1 | 19 | R0636201 | REIFEN GROß SCHWARZ | 1 |
| 5 | R0517000 | TURBINE | 1 | 20 | R0517700 | DECKEL FILTERKORB | 1 |
| 6 | R0517600 | SCHUTZGITTER | 1 | 21 | R0636600 | FILTER FEIN 100µ | 1 |
| 7 | R0517400 | BÜRSTENWALZE (SET mit 2 Stk.) | 1 | 22 | R0713600 | GEHÄUSEDECKEL GRAU PMS7712 | 1 |
| 8 | R0518702 | BÜRSTENANKER, GRAU | 1 | 23 | R0638701 | GEHÄUSERIGEL, PMS7712 | 1 |
| 9 | R0638900 | SCHRAUBE 4 * 25 MM, A2 (SET mit 5 Stk.) | 1 | 24 | R0518100 | STOSSFÄNGER MIT ROLLER (SET mit 2 Stk) | 1 |
| 10 | R0639000 | ZAHNRAD 17 ZÄHNE (SET mit 2 Stk.) | 1 | 25 | R0565200 | STANDROHR FÜR CADDY | 1 |
| 11 | R0639100 | ZAHNRADBÜCHSE (SET mit 2 Stk.) | 1 | 26 | R0565000 | HANDGRIFF CADDY | 1 |
| 12 | R0519000 | ABLEITRAMPE | 1 | 27 | R0565100 | RÄDER CADDY (SET mit 2 Stk.) | 1 |
| 13 | R0517200 | GETRIEBE | 1 | 28 | R0540402 | GRIFFSTÜCK GRAU | 1 |

CODE **WR000072**BESCHREIBUNG: **OV 3450**

| | | | | | | | |
|----|----------|---|---|----|----------|--|---|
| 14 | R0635903 | BÜRSTEN TYP 1 PMS7712 (SET mit 2 Stk.) | 1 | 29 | R0564900 | ZUBEHÖR CADDY | 1 |
| 15 | R0636700 | RADBUCHSE EC | 1 | 30 | R0564800 | BODENPLATTE CADDY | 1 |
| 31 | R0516800 | SCHWIMMKABEL KOMPLETT 18M | 1 | 36 | R0518800 | ZAHNRAD 27 ZÄHNE (SET mit 2 Stk.) | 1 |
| 32 | R0567900 | KLEMME FÜR SCHWIMMKABEL (SET mit 5 | 1 | 37 | R0516700 | SCHRAUBE 4 * 12 MM(SET mit 5 Stk.) | 1 |
| 33 | R0565600 | SCHWIMMKABEL STECKER (4 PTS) | 1 | 38 | R0639200 | ZYLINDERKOPFSCHRAUBE 2,9 * 9,5 MM (SI | 1 |
| 34 | R0567800 | SPLINT FÜR KREUZZAPFENANTRIEB (SET | 1 | 39 | R0564500 | SCHRAUBE 2,2 * 6,5 MM (SET mit 5 Stk.) | 1 |
| 35 | R0608500 | SCHRAUBE 4 * 16 MM, A4 (SET mit 5 Stk.) | 1 | 40 | R0713300 | STEUERBOX TYP 9V | 1 |

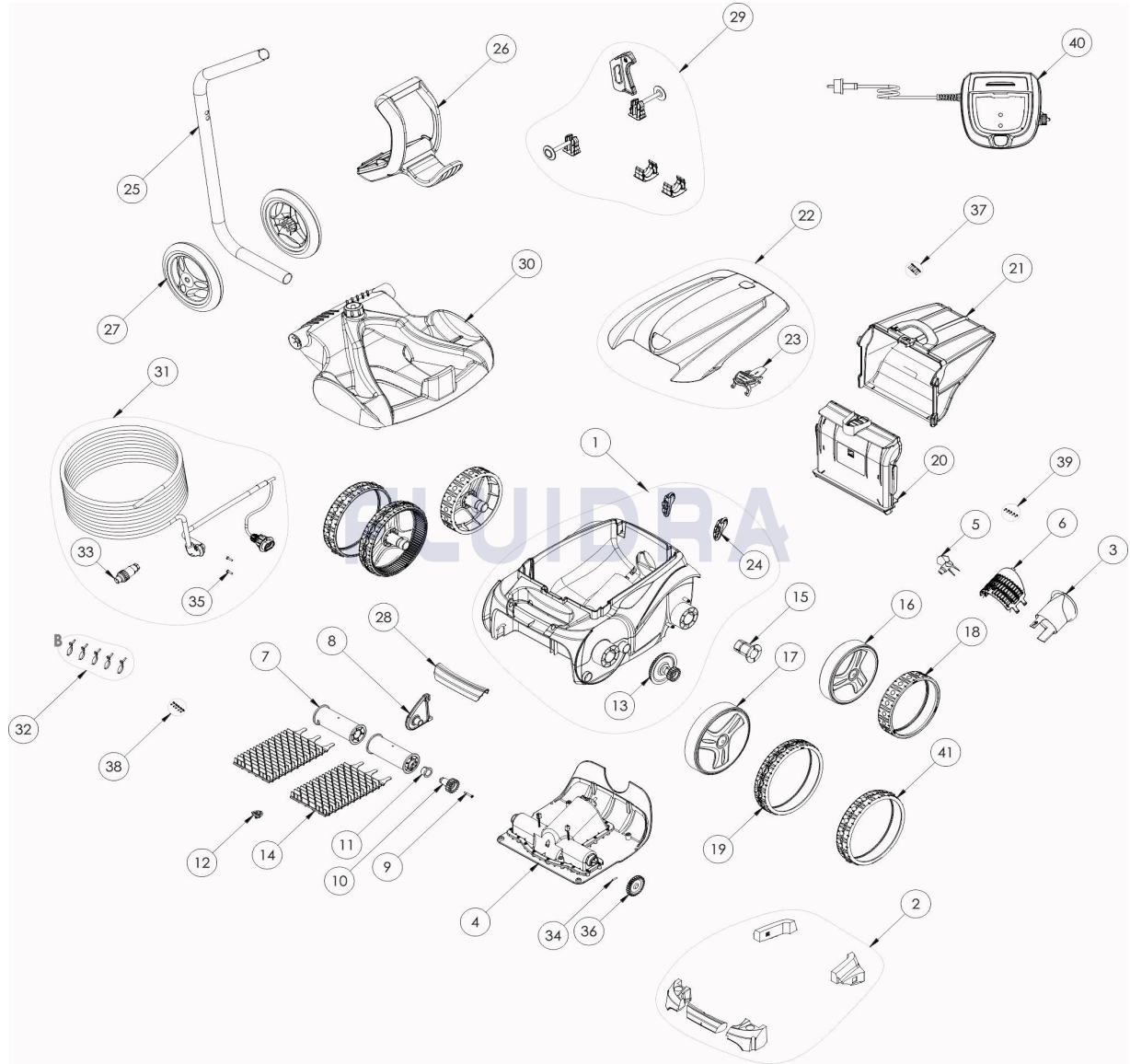
CODIGO **WR000072**

 DESCRIÇÃO: **OV 3450**

PORTUGUES

| POS | CODIGO | DESCRIÇÃO | JANTIDADE | POS | CODIGO | DESCRIÇÃO | JANTIDADE |
|-----|----------|------------------------------------|-----------|-----|----------|------------------------------------|-----------|
| 1 | R0589102 | ESTRUTURA COMPLETA 2WD II CINZENTA | 1 | 16 | R0636102 | ARO PEQUENO CINZENTO ZODIAC | 1 |
| 2 | R0539700 | FLUTUADOR | 1 | 17 | R0636003 | ARO GRANDE CINZA ZODIAC | 1 |
| 3 | R0517500 | CANALIZADOR DE FLUXO | 1 | 18 | R0636300 | CAPA DE RODA TRASEIRAPRETA ZODIAC | 1 |
| 4 | R0637800 | BLOCO MOTOR TIPO A | 1 | 19 | R0636201 | CAPA GD PRETA ZODIAC | 1 |
| 5 | R0517000 | HÉLICE | 1 | 20 | R0517700 | SUPORTE FILTRO | 1 |
| 6 | R0517600 | TELA PROTECÇÃO | 1 | 21 | R0636600 | FILTRO RESIDUOS FINOS 100µ V | 1 |
| 7 | R0517400 | ROLO PORTA-ESCOVAS (Pack 2 UN) | 1 | 22 | R0713600 | TAMPA DIANTEIRA CINZENTA PMS7712 | 1 |
| 8 | R0518702 | SUPORTE CENTRAL ESCOVAS CINZAS | 1 | 23 | R0638701 | FECHO DA TAMPA PMS7712 | 1 |
| 9 | R0638900 | PARAFUSO 4*25 MM (Pack 5 UN) | 1 | 24 | R0518100 | PÁRA-CHOQUES CON RODAS (Pack 2 UN) | 1 |
| 10 | R0639000 | RODA DENTADA 17 DENTES (Pack 2 UN) | 1 | 25 | R0565200 | TUBO CARRO DE TRANSPORTE | 1 |
| 11 | R0639100 | TAMPA EXTERIOR (Pack 2 UN) | 1 | 26 | R0565000 | PEGA CARRO DE TRANSPORTE | 1 |
| 12 | R0519000 | RAMPA | 1 | 27 | R0565100 | RODAS CARRO DE TRANSPORTE | 1 |
| 13 | R0517200 | CJTO. TRANSMISSÃO | 1 | 28 | R0540402 | PEGA CINZENTA | 1 |

CODIGO **WR000072**DESCRIÇÃO: **OV 3450**

| | | | | | | | |
|----|----------|----------------------------------|---|----|----------|------------------------------------|---|
| 14 | R0635903 | ESCOVAS ZODIAC (Pack 2 UN) | 1 | 29 | R0564900 | KIT ACCESÓRIOS CARRO | 1 |
| 15 | R0636700 | TAMPA DO ROLAMENTO DA RODA | 1 | 30 | R0564800 | BASE CARRO DE TRANSPORTE | 1 |
| 31 | R0516800 | CABO FLUTUANTE 18M | 1 | 36 | R0518800 | RODA DENTADA 27 DENTES (Pack 2 UN) | 1 |
| 32 | R0567900 | ABRAÇADEIRA CABO FLUTUANTE | 1 | 37 | R0516700 | PARAFUSO 4*12 MM (Pack 5 UN) | 1 |
| 33 | R0565600 | LIGAÇÃO DE CABO 4 PINS | 1 | 38 | R0639200 | PARAFUSO 2.9*9.5 MM (Pack 5 UN) | 1 |
| 34 | R0567800 | CLIP FIXADOR 3*16 MM (Pack 5 UN) | 1 | 39 | R0564500 | PARAFUSO 2.2*6,5mm (Pack 5 UN) | 1 |
| 35 | R0608500 | PARAFUSO 4*16 MM A4 (Pack 5 UN) | 1 | 40 | R0713300 | UNIDADE DE CONTROLO TIPO 9V | 1 |