

CODIGO **52718**

DESCRIPCION: **DUCHA ANGEL CON GRIFO LAVAPIES**

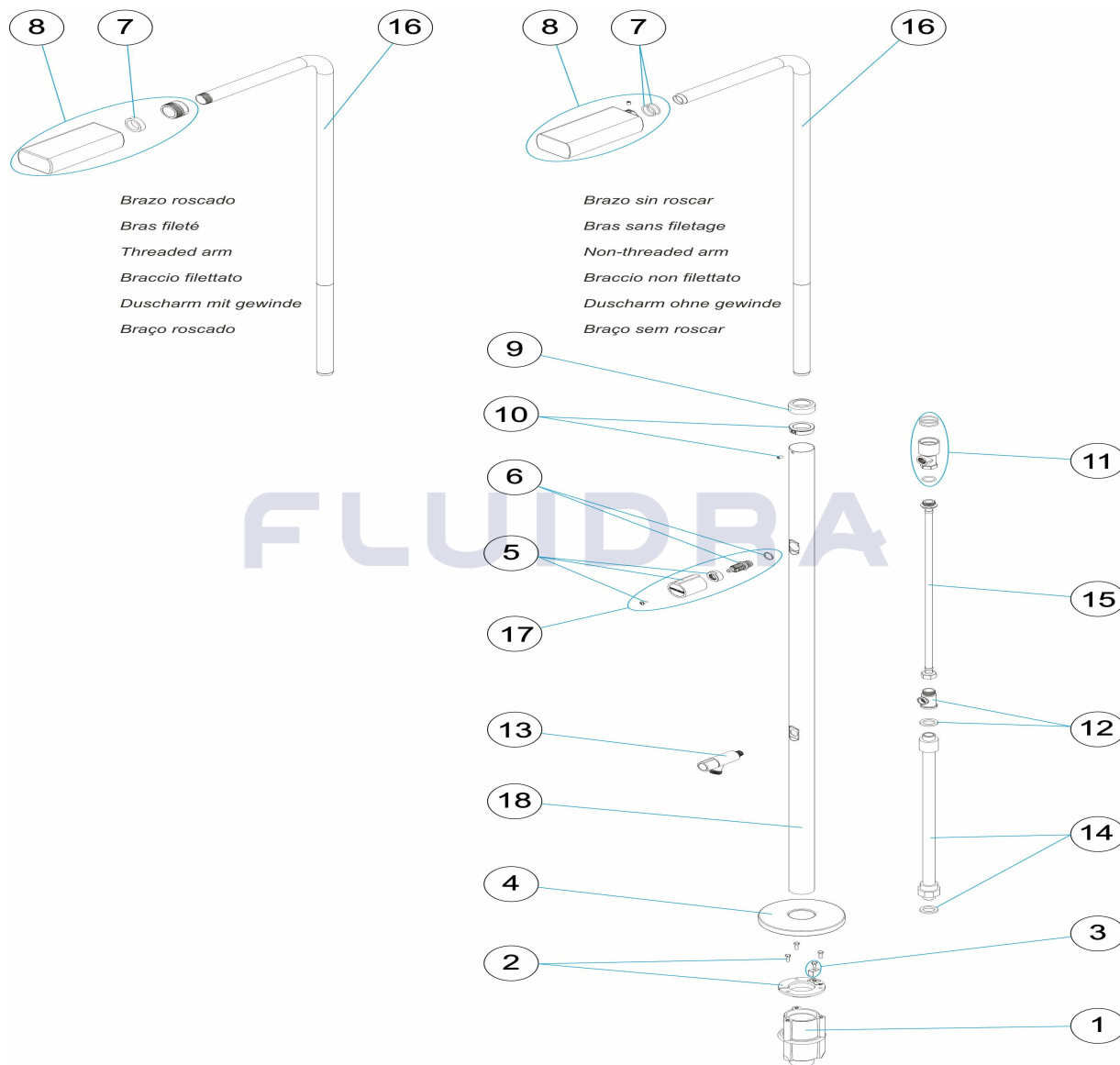

ESPAÑOL

| POS | CODIGO | DESCRIPCION | CANTIDAD | POS | CODIGO | DESCRIPCION | CANTIDAD |
|-----|--------------|-----------------------------------|----------|-----|--------------|---------------------------------------|----------|
| 1 | 4401040109 | CUERPO ANCLAJE DUCHA | | 10 | 4401040022 | ANILLO FIJACION | |
| 2 | 4401040108 | FIJACION ANCLAJE DUCHA 43 | | 11 | 4401040023 | CUERPO VALVULA | |
| 3 | 4401040903 | TOMA DE TIERRA | | 12 | 4401040049 | TE 1/2" M.-1/4" H.-1/2" H " | |
| 4 | 4401040017 | TAPETA INFERIOR DUCHA D. 43 | | 13 | 4401040050 | GRIFO LAVAPIES | |
| 5 | 4401040018 | POMO CILINDRICO | | 14 | 4401040212 | TUBO INFERIOR 1/2' | |
| 6 | 4401040019 | EJE VALVULA | | 15 | 4401040048 | LATIGUILLO 1/2" M - 1/2" H L=550 MM " | |
| 7 | * 4401040021 | JUNTA BRAZO D. 40 | | 16 | * 4401040024 | BRAZO DUCHA ROSCADO | |
| 7 | * 4401040266 | JUEGO DE 2 JUNTAS TÓRICAS | | 16 | * 4401040267 | BRAZO DUCHA | |
| 8 | * 4401040020 | ROCIADOR RECTANGULAR ROSCADO | | 17 | 4401040047 | CJTO. POMO DUCHA | |
| 8 | * 4401040226 | ROCIADOR RECTANGULAR CON TORNILLI | | 18 | 52718R0003 | TUBO EXTERIOR D. 43 LAVAPIES | |
| 9 | 4401040106 | TAPETA EMBELLECEDORA SUPERIOR 43 | | | | | |

CODIGO 52718

DESCRIPCION: DUCHA ANGEL CON GRIFO LAVAPIES

OBSERVACIONES

| POS | CODIGO | OBSERVACIONES |
|-----|--------------|------------------------|
| 7 | * 4401040021 | PARA: THREADED ARM |
| 7 | * 4401040266 | PARA: NON-THREADED ARM |
| 8 | * 4401040020 | PARA: THREADED ARM |
| 8 | * 4401040226 | PARA: NON-THREADED ARM |
| 16 | * 4401040024 | PARA: THREADED ARM |
| 16 | * 4401040267 | PARA: NON-THREADED ARM |

CODE 52718

DESCRIPTION: DOUCHE ANGEL LAVE-PIEDS

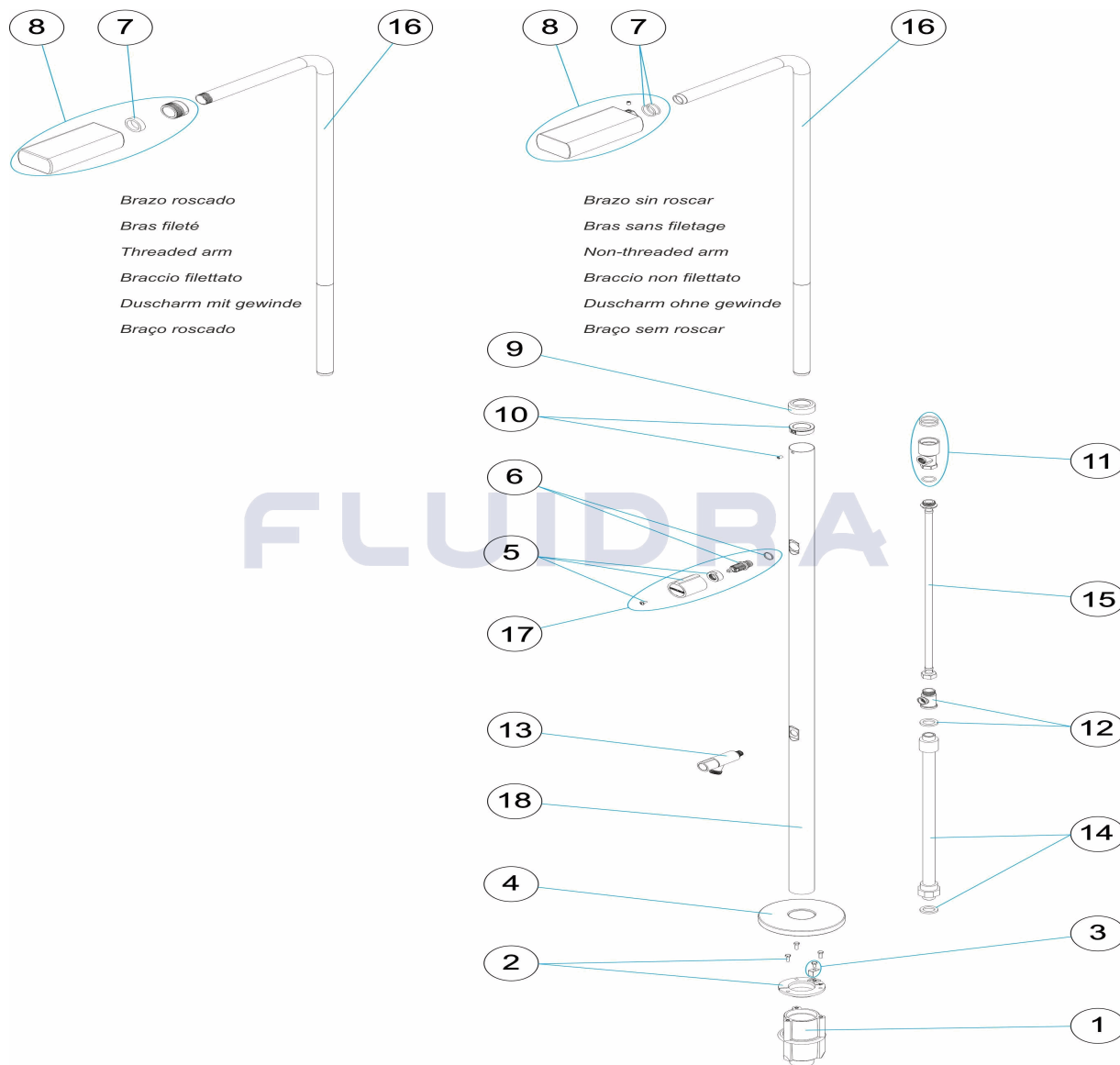

FRANCAIS

| POS | CODE | DESCRIPTION | QUANTITE | POS | CODE | DESCRIPTION | QUANTITE |
|-----|--------------|-------------------------------------|----------|-----|--------------|----------------------------------|----------|
| 1 | 4401040109 | CORPS D'ANCRAGE DE DOUCHE | | 10 | 4401040022 | ANNEAU FIXATION | |
| 2 | 4401040108 | 1/2 ENCRAGE SUPERIEUR AVEC PRISE DE | | 11 | 4401040023 | TE ROBINET DE DOUCHE | |
| 3 | 4401040903 | PRISE DE TERRE | | 12 | 4401040049 | TE 1/2" M.-1/4" H.-1/2" H " | |
| 4 | 4401040017 | CACHE INFERIEUR DOUCHE D. 43 | | 13 | 4401040050 | ROBINET RINCE PIEDS | |
| 5 | 4401040018 | POMMEAU CYLINDRIQUE | | 14 | 4401040212 | TUBE INFÉRIEUR 1/2' | |
| 6 | 4401040019 | AXE VANNE | | 15 | 4401040048 | TUYAU 1/2" M - 1/2" H L=550 MM " | |
| 7 | * 4401040021 | JOINT BRAS D. 40 | | 16 | * 4401040024 | BRAS DE DOUCHE FILETÉ | |
| 7 | * 4401040266 | SET DE 2 JOINTS TORIQUES | | 16 | * 4401040267 | BRAS DE DOUCHE | |
| 8 | * 4401040020 | JET RECTANGULAIRE FILETÉ | | 17 | 4401040047 | ENSEMBLE POMMEAU | |
| 8 | * 4401040226 | JET RECTANGULAIRE AVEC VIS SANS TÊT | | 18 | 52718R0003 | TUBE EXTERIEUR D.43 | |
| 9 | 4401040106 | ENJOLIVEUR SUPERIEUR 43 | | | | | |

CODE **52718**

DESCRIPTION: **DOUCHE ANGEL LAVE-PIEDS**

OBSERVATIONS

| POS | CODE | OBSERVATIONS |
|-----|--------------|------------------------|
| 7 | * 4401040021 | POUR: THREADED ARM |
| 7 | * 4401040266 | POUR: NON-THREADED ARM |
| 8 | * 4401040020 | POUR: THREADED ARM |
| 8 | * 4401040226 | POUR: NON-THREADED ARM |
| 16 | * 4401040024 | POUR: THREADED ARM |
| 16 | * 4401040267 | POUR: NON-THREADED ARM |

CODE **52718**

DESCRIPTION: **ANGEL SHOWER WITH FOOTWASH TAP**

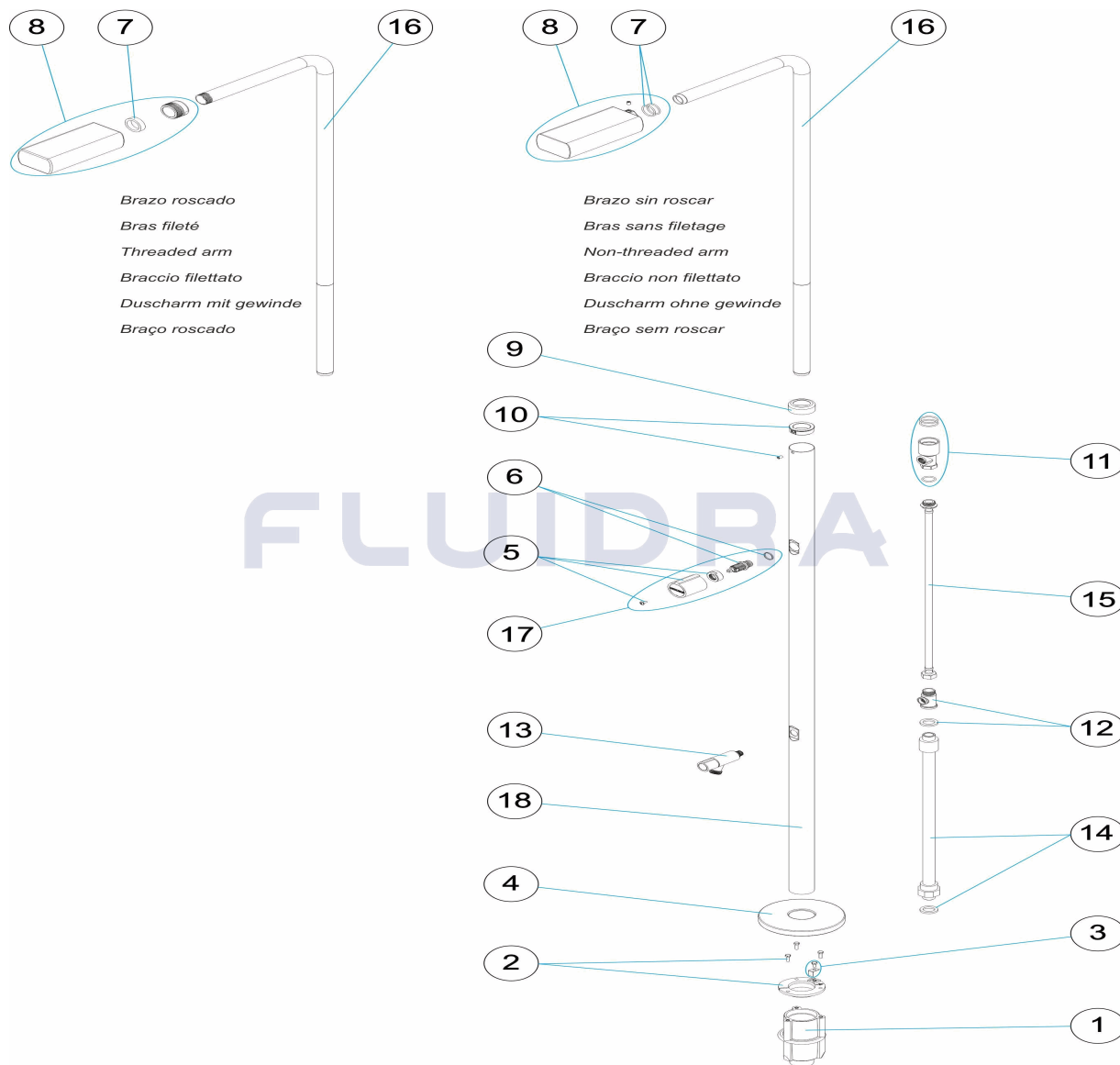

ENGLISH

| POS | CODE | DESCRIPTION | QUANTITY | POS | CODE | DESCRIPTION | QUANTITY |
|-----|--------------|-----------------------------------|----------|-----|--------------|--|----------|
| 1 | 4401040109 | SHOWER ANCHORING FIXTURE | | 10 | 4401040022 | SHOE RING | |
| 2 | 4401040108 | SHOWER ANCHOR D 43 | | 11 | 4401040023 | VALVE SOCKET | |
| 3 | 4401040903 | EARTH CONNECTION | | 12 | 4401040049 | 1/2" M.-1/4" H.-1/2" H. 'TE' " | |
| 4 | 4401040017 | D. 43 LOWER SHOWER COVER | | 13 | 4401040050 | FOOTBATH TAP | |
| 5 | 4401040018 | CYLINDRICAL KNOB | | 14 | 4401040212 | 1/2' BOTTOM PIPE | |
| 6 | 4401040019 | VALVE SHAFT | | 15 | 4401040048 | FLEXIBLE HOSE 1/2" M - 1/2" H L=550 MM ' | |
| 7 | * 4401040021 | D. 40 ARM JOINT | | 16 | * 4401040024 | THREADED SHOWER ARM | |
| 7 | * 4401040266 | SET OF 2 O-RINGS | | 16 | * 4401040267 | SHOWER ARM | |
| 8 | * 4401040020 | THREADED RECTANGULAR NOZZLE | | 17 | 4401040047 | KNOB | |
| 8 | * 4401040226 | RECTANGULAR NOZZLE WITH SET SCREV | | 18 | 52718R0003 | TUBE EXTERNAL 43MM | |
| 9 | 4401040106 | TOP ESCUTCHEON PLATE 43 | | | | | |

CODE **52718**

DESCRIPTION: **ANGEL SHOWER WITH FOOTWASH TAP**

OBSERVATIONS

| POS | CODE | OBSERVATIONS |
|-----|--------------|-----------------------|
| 7 | * 4401040021 | FOR: THREADED ARM |
| 7 | * 4401040266 | FOR: NON-THREADED ARM |
| 8 | * 4401040020 | FOR: THREADED ARM |
| 8 | * 4401040226 | FOR: NON-THREADED ARM |
| 16 | * 4401040024 | FOR: THREADED ARM |
| 16 | * 4401040267 | FOR: NON-THREADED ARM |

CODICE **52718**

DESCRIZIONE: **DOCCIA ANGEL LAVAPIEDI**

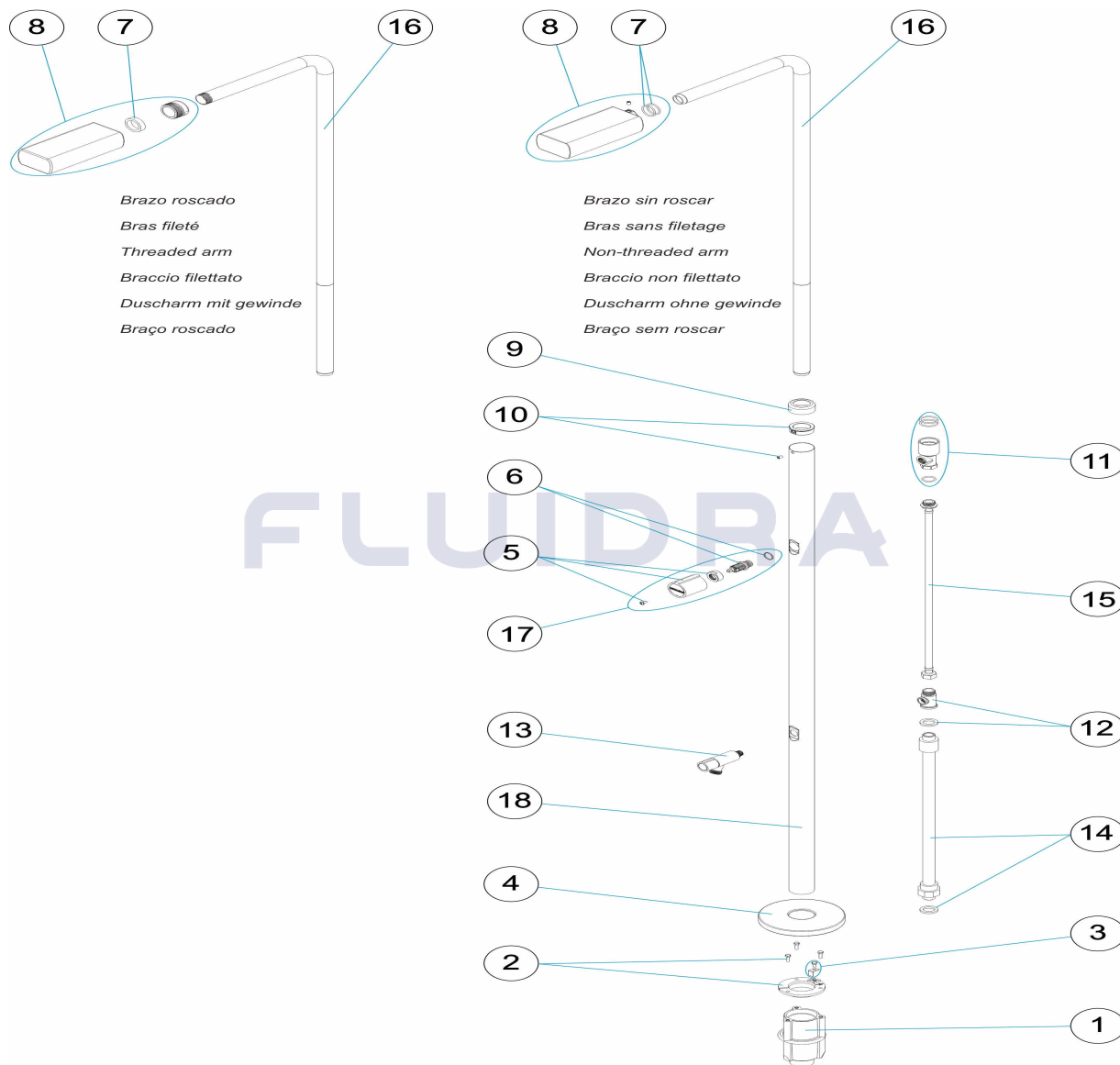

Bravo roscado
Bras fileté
Threaded arm
Braccio filettato
Duscharm mit gewinde
Braço roscado

Bravo sin roscar
Bras sans filetage
Non-threaded arm
Braccio non filettato
Duscharm ohne gewinde
Braço sem roscar

ITALIANO

| POS | CODICE | DESCRIZIONE | QUANTITA' | POS | CODICE | DESCRIZIONE | QUANTITA' |
|-----|--------------|-----------------------------------|-----------|-----|--------------|-------------------------------------|-----------|
| 1 | 4401040109 | CORPO ANCORAGGIO DOCCIA | | 10 | 4401040022 | ANELLO FISSAGGIO | |
| 2 | 4401040108 | FISSAGGIO ANCORAGGIO DOCCIA D 43 | | 11 | 4401040023 | CORPO VALVOLA | |
| 3 | 4401040903 | PRESA A TERRA | | 12 | 4401040049 | T' 1/2" M.-1/4" H.-1/2" H " | |
| 4 | 4401040017 | COPERTURA INFERIORE DOCCIA D. 43 | | 13 | 4401040050 | RUBINETTO LAVAPIEDI | |
| 5 | 4401040018 | POMELLO CICLINDRICO | | 14 | 4401040212 | TUBO INFERIORE 1/2' | |
| 6 | 4401040019 | ASSE VALVOLA | | 15 | 4401040048 | SPINOTTO 1/2" M - 1/2" H L=550 MM " | |
| 7 | * 4401040021 | GIUNTURA BRACCIO D. 40 | | 16 | * 4401040024 | BRACCIO DOCCIA FILETTATO | |
| 7 | * 4401040266 | SET DI 2 GIUNTA TORICA | | 16 | * 4401040267 | BRACCIO DOCCIA | |
| 8 | * 4401040020 | SPRUZZATORE RETTANGOLARE FILETTAT | | 17 | 4401040047 | SET MANOPOLA | |
| 8 | * 4401040226 | SPRUZZATORE RETTANGOLARE VITE PRI | | 18 | 52718R0003 | TUBO ESTERNO D.43 | |
| 9 | 4401040106 | COPRIFLANGIA 43 | | | | | |

CODICE **52718**

DESCRIZIONE: **DOCCIA ANGEL LAVAPIEDI**

OSSERVAZIONI

| POS | CODICE | OSSERVAZIONI |
|-----|--------------|-----------------------|
| 7 | * 4401040021 | PER: THREADED ARM |
| 7 | * 4401040266 | PER: NON-THREADED ARM |
| 8 | * 4401040020 | PER: THREADED ARM |
| 8 | * 4401040226 | PER: NON-THREADED ARM |
| 16 | * 4401040024 | PER: THREADED ARM |
| 16 | * 4401040267 | PER: NON-THREADED ARM |

CODE **52718**

BESCHREIBUNG: **DUSCHE ANGEL WASSERHAHN FUSSDUSCHE**

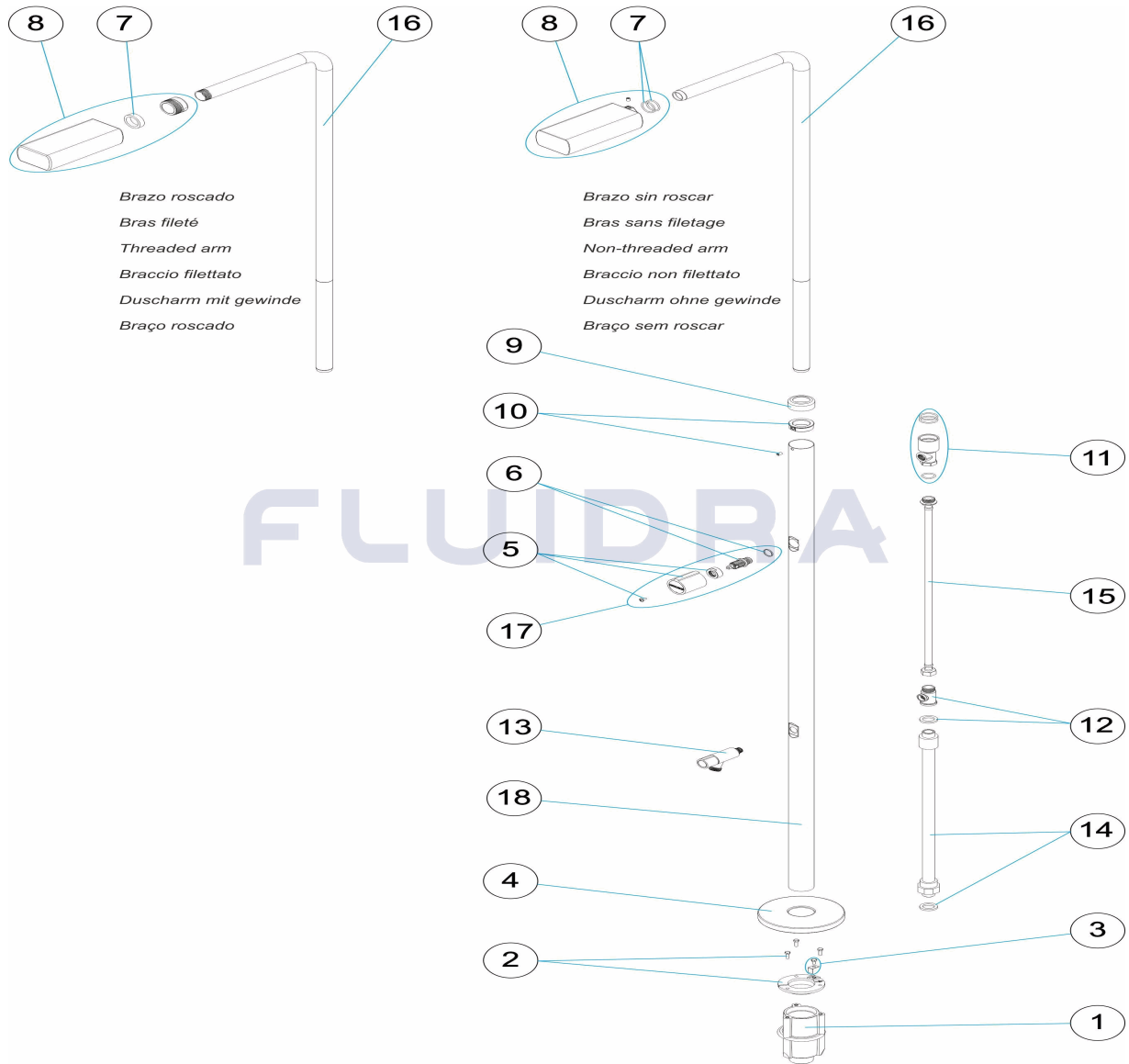

DEUTSCH

| POS | CODE | BESCHREIBUNG | MENGE | POS | CODE | BESCHREIBUNG | MENGE |
|-----|--------------|------------------------------------|-------|-----|--------------|--|-------|
| 1 | 4401040109 | VERANKERUNG DUSCHEINHEIT | | 10 | 4401040022 | FIXIERRING | |
| 2 | 4401040108 | FIXIERUNG DUSCHVERANKERUNG 43 | | 11 | 4401040023 | GEHÄUSE VENTIL | |
| 3 | 4401040903 | ERDUNG | | 12 | 4401040049 | T-STÜCK 1/2" NIPPEL - 1/4" MUFFE - 1/2" ML | |
| 4 | 4401040017 | ABSCHLUSSPLATTE UNTEN DUSCHE D. 4' | | 13 | 4401040050 | WASSERHAHN FUSSDUSCHE | |
| 5 | 4401040018 | DREHGRIFF ZYLINDRISCH | | 14 | 4401040212 | ROHR UNTEN 1/2' | |
| 6 | 4401040019 | VENTILACHSE | | 15 | 4401040048 | SCHLAUCHLEITUNG 1/2" NIPPEL - 1/2" MUF | |
| 7 | * 4401040021 | DICHTUNG ARM D. 40 | | 16 | * 4401040024 | DUSCHARM MIT GEWINDE | |
| 7 | * 4401040266 | SET 2 O-RINGE | | 16 | * 4401040267 | DUSCHARM | |
| 8 | * 4401040020 | DUSCHKOPF RECHTECKIG MIT GEWINDE | | 17 | 4401040047 | SET DREHGRIFF DUSCHE | |
| 8 | * 4401040226 | DUSCHKOPF RECHTECKIG MIT MADENSC | | 18 | 52718R0003 | AUSSENROHR D. 43 FUSSDUSCHE | |
| 9 | 4401040106 | DEKO-ABSCHLUSSRING OBEN 43 | | | | | |

CODE **52718**

BESCHREIBUNG: **DUSCHE ANGEL WASSERHAHN FUSSDUSCHE**

HINWEISE

| POS | CODE | HINWEISE |
|-----|--------------|-----------------------|
| 7 | * 4401040021 | FÜR: THREADED ARM |
| 7 | * 4401040266 | FÜR: NON-THREADED ARM |
| 8 | * 4401040020 | FÜR: THREADED ARM |
| 8 | * 4401040226 | FÜR: NON-THREADED ARM |
| 16 | * 4401040024 | FÜR: THREADED ARM |
| 16 | * 4401040267 | FÜR: NON-THREADED ARM |

CODIGO **52718**

DESCRIÇÃO: **DUCHE ANGEL LAVA-PÉS**

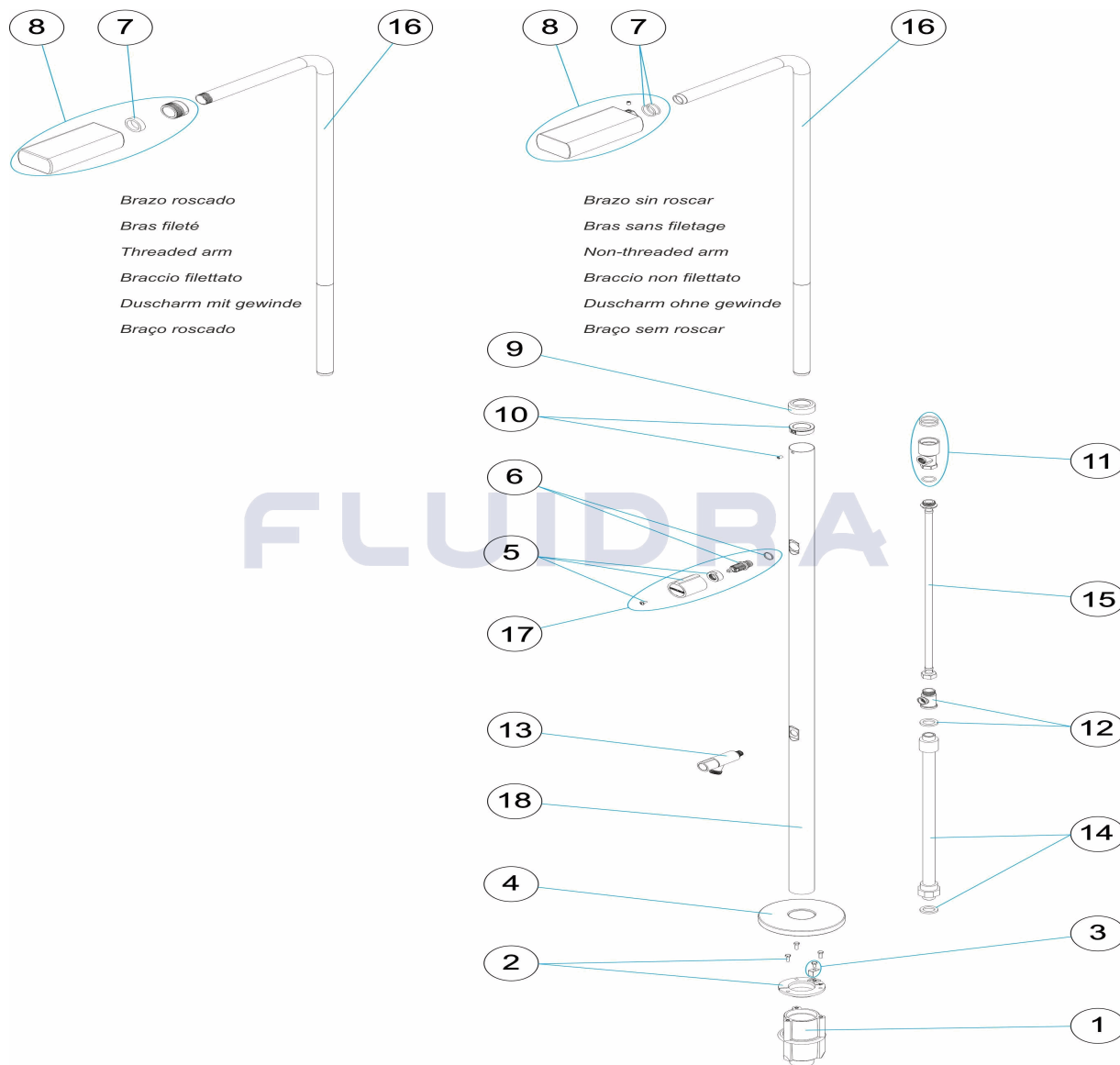

PORTUGUES

| POS | CODIGO | DESCRIÇÃO | JANTIDADE | POS | CODIGO | DESCRIÇÃO | JANTIDADE |
|-----|--------------|-------------------------------------|-----------|-----|--------------|----------------------------------|-----------|
| 1 | 4401040109 | CORPO ÂNCORA CHUVEIRO | | 10 | 4401040022 | ANEL DE FIXAÇÃO | |
| 2 | 4401040108 | FIXAÇÃO ÂNCORA CHUVEIRO D 43 | | 11 | 4401040023 | CORPO VÁLVULA | |
| 3 | 4401040903 | LIGAÇÃO A TERRA | | 12 | 4401040049 | TÊ 1/2" M.-1/4" H.-1/2" H " | |
| 4 | 4401040017 | PLACA ESTANQUE INFERIOR DUCHE D. 43 | | 13 | 4401040050 | TORNEIRA LAVA-PÉS | |
| 5 | 4401040018 | MAÇANETA CILÍNDRICA | | 14 | 4401040212 | TUBO INFERIOR 1/2" | |
| 6 | 4401040019 | EIXO VÁLVULA | | 15 | 4401040048 | MANGA 1/2" M - 1/2" H L=550 MM " | |
| 7 | * 4401040021 | JUNTA BRAÇO D. 40 | | 16 | * 4401040024 | BRAÇO CHUVEIRO ROSCADO | |
| 7 | * 4401040266 | CONJUNTO DE 2 JUNTAS TORICAS | | 16 | * 4401040267 | BRAÇO CHUVEIRO | |
| 8 | * 4401040020 | DIFUSOR RETANGULAR ROSCADO | | 17 | 4401040047 | CJTO. PUXADOR | |
| 8 | * 4401040226 | DIFUSOR RETANGULAR COM PARAFUSO I | | 18 | 52718R0003 | TUBO EXTERIOR D. 43 | |
| 9 | 4401040106 | ANTIDERRAPANTE | | | | | |

CODIGO 52718

DESCRIÇÃO: DUCHE ANGEL LAVA-PÉS

OBSERVAÇÕES

| POS | CODIGO | OBSERVAÇÕES |
|-----|--------------|------------------------|
| 7 | * 4401040021 | PARA: THREADED ARM |
| 7 | * 4401040266 | PARA: NON-THREADED ARM |
| 8 | * 4401040020 | PARA: THREADED ARM |
| 8 | * 4401040226 | PARA: NON-THREADED ARM |
| 16 | * 4401040024 | PARA: THREADED ARM |
| 16 | * 4401040267 | PARA: NON-THREADED ARM |